

NEW MEXICO REGISTRATION COMMISSION
WELL LOCATION AND ACREAGE DEDICATION PLAT

Form 1-72
Revised 1-1-78
File 11-1-1978

AMENDED

All distances must be from the outer boundaries of the Section

Operator Brazos Petroleum Co.		Lease Holcomb 18 Fed.		Well No. 1
Unit Letter C	Section 18	Township 9 South	Range 38 East	County Lea
Actual Footage Location of Well: 1980 feet from the West line and 760 feet from the north line				
Ground Level Elev. 3976.0	Producing Formation San Andres	Pool Sawyer	Dedicated Acreage: 160 40 Acres	

1. Outline the acreage dedicated to the subject well by colored pencil or hachure marks on the plat below.
2. If more than one lease is dedicated to the well, outline each and identify the ownership thereof (both as to working interest and royalty).
3. If more than one lease of different ownership is dedicated to the well, have the interests of all owners been consolidated by communitization, unitization, force-pooling, etc?

☐ Yes ☐ No If answer is "yes," type of consolidation _____

If answer is "no," list the owners and tract descriptions which have actually been consolidated. (Use reverse side of this form if necessary.) _____

No allowable will be assigned to the well until all interests have been consolidated (by communitization, unitization, forced-pooling, or otherwise) or until a non-standard unit, eliminating such interests, has been approved by the Commission.

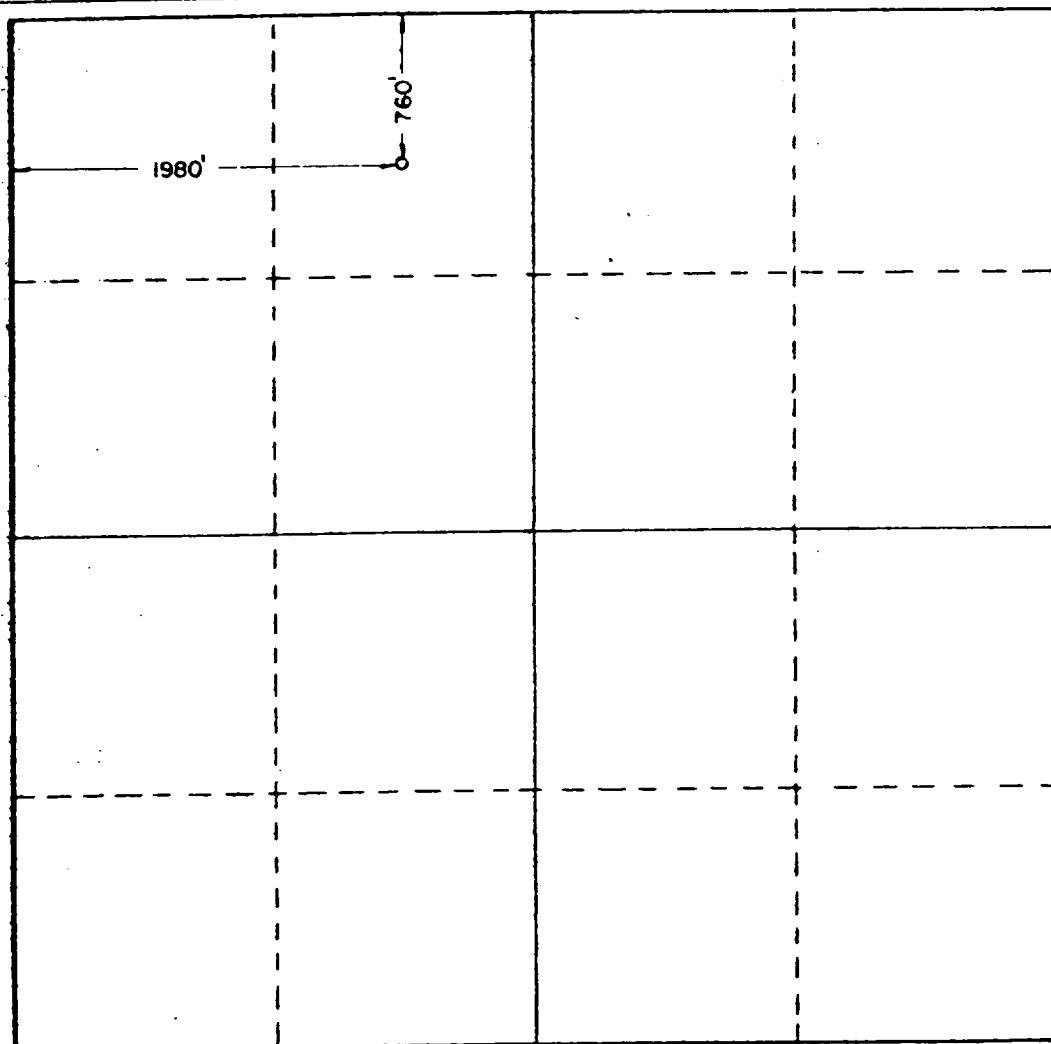

CERTIFICATION

I hereby certify that the information contained herein is true and complete to the best of my knowledge and belief.

Walter Brown

Name
Joe T. James
Position
Agent
Company
Brazos Petroleum Co.

Date
November 11, 1980

I hereby certify that the well location shown on this plat was plotted from field notes of actual surveys made by me or under my supervision and that the same is true and correct to the best of my knowledge and belief.

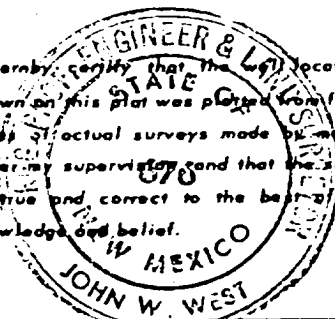

Date Surveyed
Oct. 24, 1980

Registered Professional Engineer and/or Land Surveyor

John W. West

Certificate No. **JOHN W. WEST 678**
PATRICK A. ROMERO 6868
Ronald J. Eldon 3239

