

30-025-27252

NO. OF COPIES RECEIVED	
DISTRIBUTION	
SANTA FE	
FILE	
U.S.G.S.	
LAND OFFICE	
OPERATOR	

## NEW MEXICO OIL CONSERVATION COMMISSION

Form C-101  
Revised 1-1-65

5A. Indicate Type of Lease	
STATE <input checked="" type="checkbox"/>	FEE <input type="checkbox"/>
5. State Oil & Gas Lease No.	
LG - 0269	
7. Unit Agreement Name	
8. Farm or Lease Name	
Inbe State	
9. Well No.	
1	
10. Field and Pool, or Wildcat	
Inbe/Bagley-Wolfcamp/Penn	
12. County	
Lea	
19. Proposed Depth	19A. Formation
10,400'	Wolfcamp-Penn
20. Rotary or C.T.	
Rotary	
21. Elevations (Show whether DF, RT, etc.)	21A. Kind & Status Plug. Bond
4230.8 GL	Blanket renewed & updated
21B. Drilling Contractor	22. Approx. Date Work will start
Warton Drilling Co.	March 30, 1981

## APPLICATION FOR PERMIT TO DRILL, DEEPEN, OR PLUG BACK

1a. Type of Work	
b. Type of Well	
DRILL <input checked="" type="checkbox"/>	DEEPEN <input type="checkbox"/>
OIL WELL <input checked="" type="checkbox"/>	GAS WELL <input type="checkbox"/>
OTHER <input type="checkbox"/>	
2. Name of Operator	
Texas Oil & Gas Corp.	
3. Address of Operator	
900 Wilco Building, Midland, Texas 79701	
4. Location of Well	
UNIT LETTER B	LOCATED 660 FEET FROM THE North LINE
AND 1980 FEET FROM THE East	LINE OF SEC. 14 TWP. 11-S RGE. 33-E NMPM
5. State Oil & Gas Lease No.	
LG - 0269	
6. Farm or Lease Name	
Inbe State	
7. Unit Agreement Name	
8. Field and Pool, or Wildcat	
Inbe/Bagley-Wolfcamp/Penn	
9. Well No.	
1	
10. County	
Lea	
11. Proposed Depth	
10,400'	
12. Formation	
Wolfcamp-Penn	
13. Rotary or C.T.	
Rotary	
14. Elevations (Show whether DF, RT, etc.)	
4230.8 GL	
15. Kind & Status Plug. Bond	
Blanket renewed & updated	
16. Drilling Contractor	
Warton Drilling Co.	
17. Approx. Date Work will start	
March 30, 1981	

## PROPOSED CASING AND CEMENT PROGRAM

SIZE OF HOLE	SIZE OF CASING	WEIGHT PER FOOT	SETTING DEPTH	SACKS OF CEMENT	EST. TOP
14 3/4"	11 3/4"	42#	375'	275	Surface
11"	8 5/8"	24# & 28#	3800'	1075	Surface
7 7/8"	4 1/2"	10.5 & 11.6#	10,300'	As determined by caliper	Cover pay zones

1. Drill 14 3/4" hole to 375' w/FW spud mud & set 11 3/4" 42# H-40 ST&C csg. Cmt to surf.
2. Drill out with 11" bit using FW. Drill to approx 3800' and set 2200' 8 5/8" 24# K-55 and 1600' 8 5/8" 28# S-80 ST&C csg. Cmt to surface.
3. Drill out with 7 7/8" bit and water. Drill to Wolfcamp at approx 8500'. Bring weight up to 9.8# using brine water.
4. Drill to Penn at approx 9450'. Mud up with salt get and drispac for 10#, 35-45 Vis, 5 cc WL. Drill to TD of 10,400'.
5. Run OH logs and caliper.
6. DST as required.
7. Run 4 1/2" 10.5 and 11.6# K-55 ST&C csg and complete through perforations.

APPROVAL VALID FOR 180 DAYS  
 PERMIT EXPIRES 7/30/81  
 UNLESS DRILLING UNDERWAY

IN ABOVE SPACE DESCRIBE PROPOSED PROGRAM: IF PROPOSAL IS TO DEEPEN OR PLUG BACK, GIVE DATA ON PRESENT PRODUCTIVE ZONE AND PROPOSED NEW PRODUCTIVE ZONE. GIVE BLOWOUT PREVENTER PROGRAM, IF ANY.

I hereby certify that the information above is true and complete to the best of my knowledge and belief.

Signed Carl Bird (Carl Bird) Title Drilling Engineer Date 1-22-81

(This space for State Use)

APPROVED BY [Signature] TITLE SUPERVISOR DATE JAN 30 1981

CONDITIONS OF APPROVAL, IF ANY:

**NEW MEXICO OIL CONSERVATION COMMISSION**  
**WE LOCATION AND ACREAGE DEDICATION PLAT**

Form C-102  
 Supersedes C-128  
 Effective 1-1-65

All distances must be from the outer boundaries of the Section.

Operator <b>Texas Oil &amp; Gas Co.</b>			Lease <b>Inbe State</b>			Well No. <b>1</b>
Unit Letter <b>B</b>	Section <b>14</b>	Township <b>11S</b>	Range <b>33E</b>	County <b>Lea</b>		
Actual Footage Location of Well: <b>660</b> feet from the <b>North</b> line and <b>1980</b> feet from the <b>East</b> line						
Ground Level Elev. <b>4230.8'</b>	Producing Formation <b>Wolfcamp/Penn</b>		Pool <b>Inbe/Bagley - Wolfcamp/Penn</b>		Dedicated Acreage: <b>160</b> Acres	

1. Outline the acreage dedicated to the subject well by colored pencil or hachure marks on the plat below. *M.B. Bird (Carl Bird)*

2. If more than one lease is dedicated to the well, outline each and identify the ownership thereof (both as to working interest and royalty).

3. If more than one lease of different ownership is dedicated to the well, have the interests of all owners been consolidated by communitization, unitization, force-pooling, etc?

☒ Yes    ☐ No    If answer is "yes," type of consolidation Partial consolidation of State leases.

If answer is "no," list the owners and tract descriptions which have actually been consolidated. (Use reverse side of this form if necessary.) \_\_\_\_\_

No allowable will be assigned to the well until all interests have been consolidated (by communitization, unitization, forced-pooling, or otherwise) or until a non-standard unit, eliminating such interests, has been approved by the Commission.

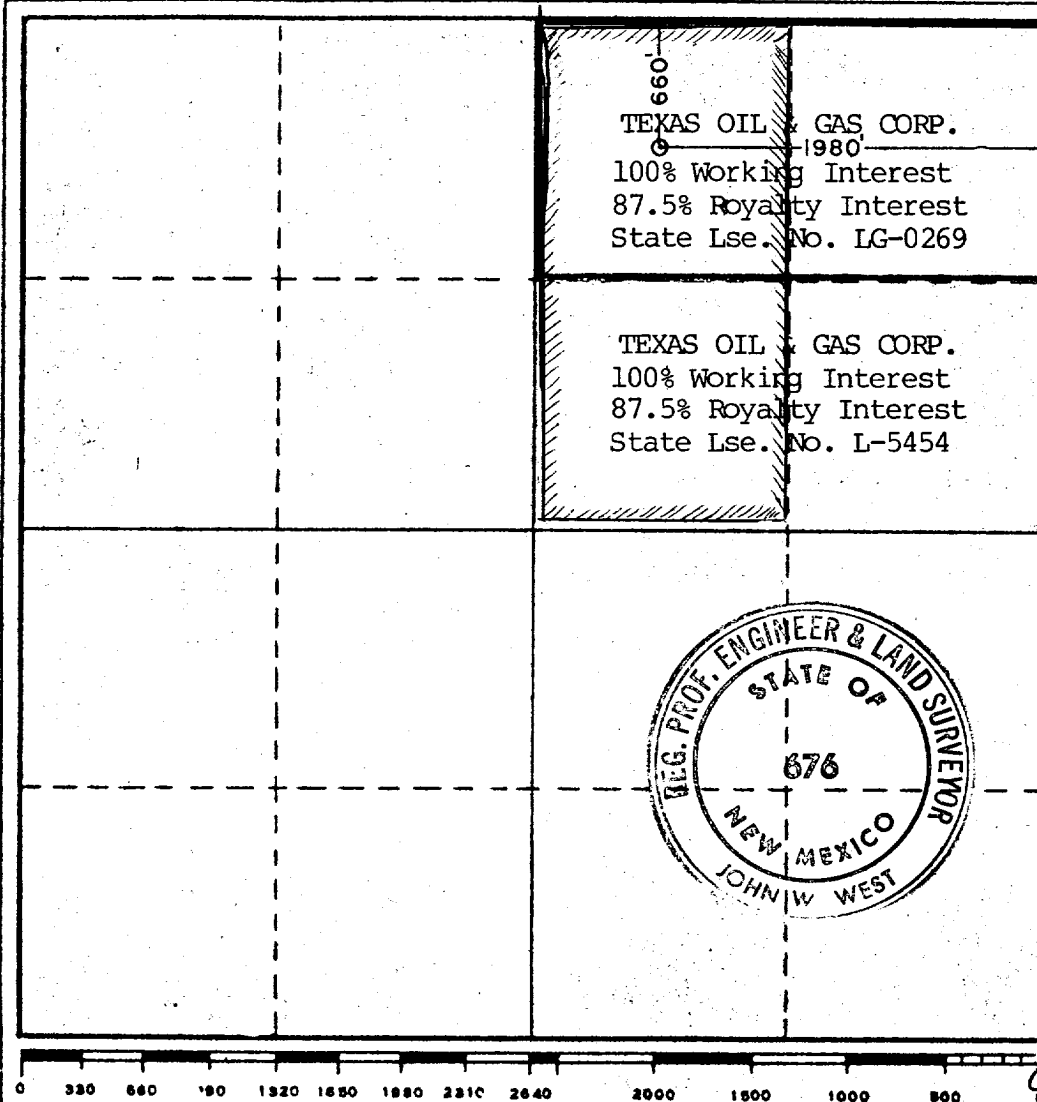

<b>CERTIFICATION</b>	
I hereby certify that the information contained herein is true and complete to the best of my knowledge and belief.	
Name	<i>Carl Bird</i> (Carl Bird)
Position	<b>Drilling Engineer</b>
Company	<b>Texas Oil &amp; Gas Corp.</b>
Date	<b>January 28, 1981</b>
I hereby certify that the well location shown on this plat was plotted from field notes of actual surveys made by me or under my supervision, and that the same is true and correct to the best of my knowledge and belief.	
Date Surveyed	<b>December 10, 1980</b>
Registered Professional Engineer and/or Land Surveyor	
<i>John W. West</i>	
Certificate No.	<b>JOHN W. WEST 676</b> <b>PATRICK A. ROMERO 6663</b> <b>Ronald J. Eidson 3239</b>

RECEIVED

JAN 29 1981

OIL CONSERVATION DIV

3000 lb. WP BOP  
 12" Shaffer Type B Hydraulic BOP 3000 PSI  
 10" GK Hydrill 3000 WP  
 80 Gallon - 5 Station Koomey Accumulator  
 3000 lb. WP Choke Manifold

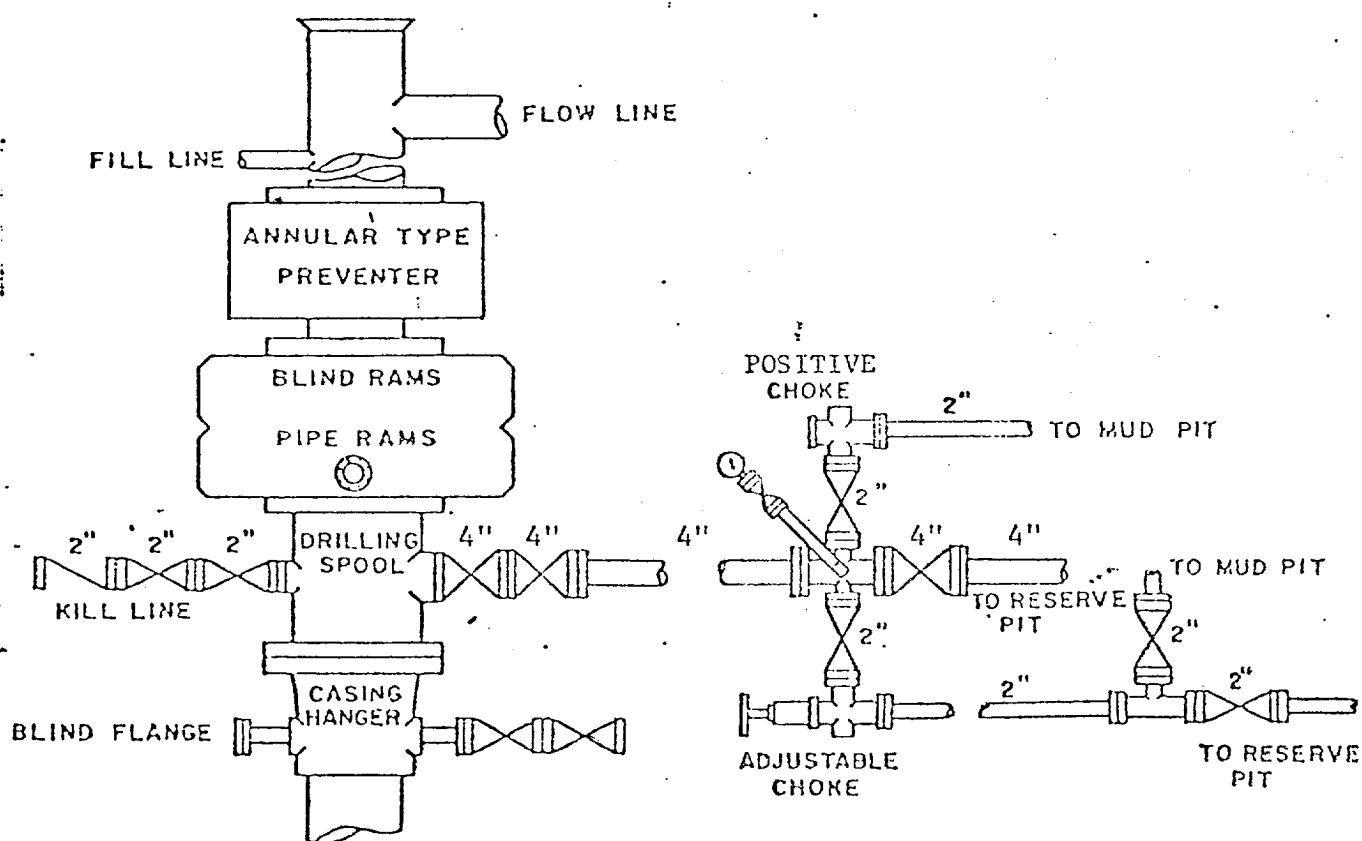

BLOWOUT PREVENTOR SKETCH

RECEIVED

JAN 23 1981

OIL CONSERVATION DIV

413