

30-025-27276

NO. OF COPIES RECEIVED		
DISTRIBUTION		
SANTA FE		
FILE		
U.S.G.S.		
LAND OFFICE		
OPERATOR		

NEW MEXICO OIL CONSERVATION COMMISSION

Form C-101
Revised 1-1-65

5A. Indicate Type of Lease
STATE <input checked="" type="checkbox"/> FEE <input type="checkbox"/>
5. State Oil & Gas Lease No.
V-18

APPLICATION FOR PERMIT TO DRILL, DEEPEN, OR PLUG BACK

1a. Type of Work		7. Unit Agreement Name	
b. Type of Well DRILL <input checked="" type="checkbox"/> DEEPEN <input type="checkbox"/> PLUG BACK <input type="checkbox"/> OIL WELL <input checked="" type="checkbox"/> GAS WELL <input type="checkbox"/> OTHER <input type="checkbox"/> SINGLE ZONE <input checked="" type="checkbox"/> MULTIPLE ZONE <input type="checkbox"/>		8. Farm or Lease Name Susco State 27 State	
2. Name of Operator Southern Union Exploration Company of Texas		9. Well No. #1	
3. Address of Operator 1217 Main Street, Dallas, Texas 75202		10. Field and Pool or Wildcat Bagley - Bough "C"	
4. Location of Well UNIT LETTER <u>E</u> LOCATED <u>660'</u> FEET FROM THE <u>West</u> LINE AND <u>1980</u> FEET FROM THE <u>North</u> LINE OF SEC. <u>27</u> TWP. <u>10S</u> RGE. <u>33E</u> NMPM		12. County Lea	
19. Proposed Depth 10,000'		19A. Formation Bough "C"	
20. Rotary or C.T. Rotary		21. Elevations (Show whether DF, RT, etc.) 4194.1 GR	
21A. Kind & Status Plug. Bond		21B. Drilling Contractor Unknown	
22. Approx. Date Work will start February 15, 1981			

23.

PROPOSED CASING AND CEMENT PROGRAM

SIZE OF HOLE	SIZE OF CASING	WEIGHT PER FOOT	SETTING DEPTH	SACKS OF CEMENT	EST. TOP
17-1/2"	13-3/8"	48#	400'	Circulate	-
12-1/4"	8-5/8"	24# & 32#	4000'	2100	Surface
7-7/8"	5-1/2"	15.5# & 17#	10,000'	1000	4000'

BOP equipment will be used in accordance with New Mexico state rules and will be adequate for the area.

See attached BOP Sketch.

APPROVAL VALID FOR 180 DAYS
PERMIT EXPIRES 8/23/81
UNLESS DRILLING UNDERWAY

IN ABOVE SPACE DESCRIBE PROPOSED PROGRAM; IF PROPOSAL IS TO DEEPEN OR PLUG BACK, GIVE DATA ON PRESENT PRODUCTIVE ZONE AND PROPOSED NEW PRODUCTIVE ZONE. GIVE BLOWOUT PREVENTER PROGRAM, IF ANY.

I hereby certify that the information above is true and complete to the best of my knowledge and belief.

Signed Ronald W. Smith Title Drilling & Production Engineer Date February 10, 1981

(This space for State Use)

APPROVED BY Mary Subler TITLE SUPERVISOR DISTRICT DATE 8/23/81

CONDITIONS OF APPROVAL, IF ANY:

NEW MEXICO OIL CONSERVATION COMMISSION
WELL LOCATION AND ACREAGE DEDICATION PLAT

Form C-102
Supersedes C-128
Effective 1-1-65

All distances must be from the outer boundaries of the Section

Southern Un Expl Co of TX

Lease

SUSCO

State 27

Well No.

1

E

27

Township

10

South

Range

33

East

County

Lea

Large Location of Well:

1980

feet from the

north

line and

660

feet from the

west

line

4194.1

Producing Formation

Bough "C"

Pool

Bagley

Estimated Acreage

40 80 20

- Outline the acreage dedicated to the subject well by colored pencil or hatchure marks on the plat below.
- If more than one lease is dedicated to the well, outline each and identify the ownership thereof (both as to working interest and royalty).
- If more than one lease of different ownership is dedicated to the well, have the interests of all owners been consolidated by communitization, unitization, force-pooling, etc?

☐ Yes ☐ No If answer is "yes," type of consolidation _____

If answer is "no," list the owners and tract descriptions which have actually been consolidated. (Use reverse side of this form if necessary.) _____

No allowable will be assigned to the well until all interests have been consolidated (by communitization, unitization, forced-pooling, or otherwise) or until a non-standard unit, eliminating such interests, has been approved by the Commission.

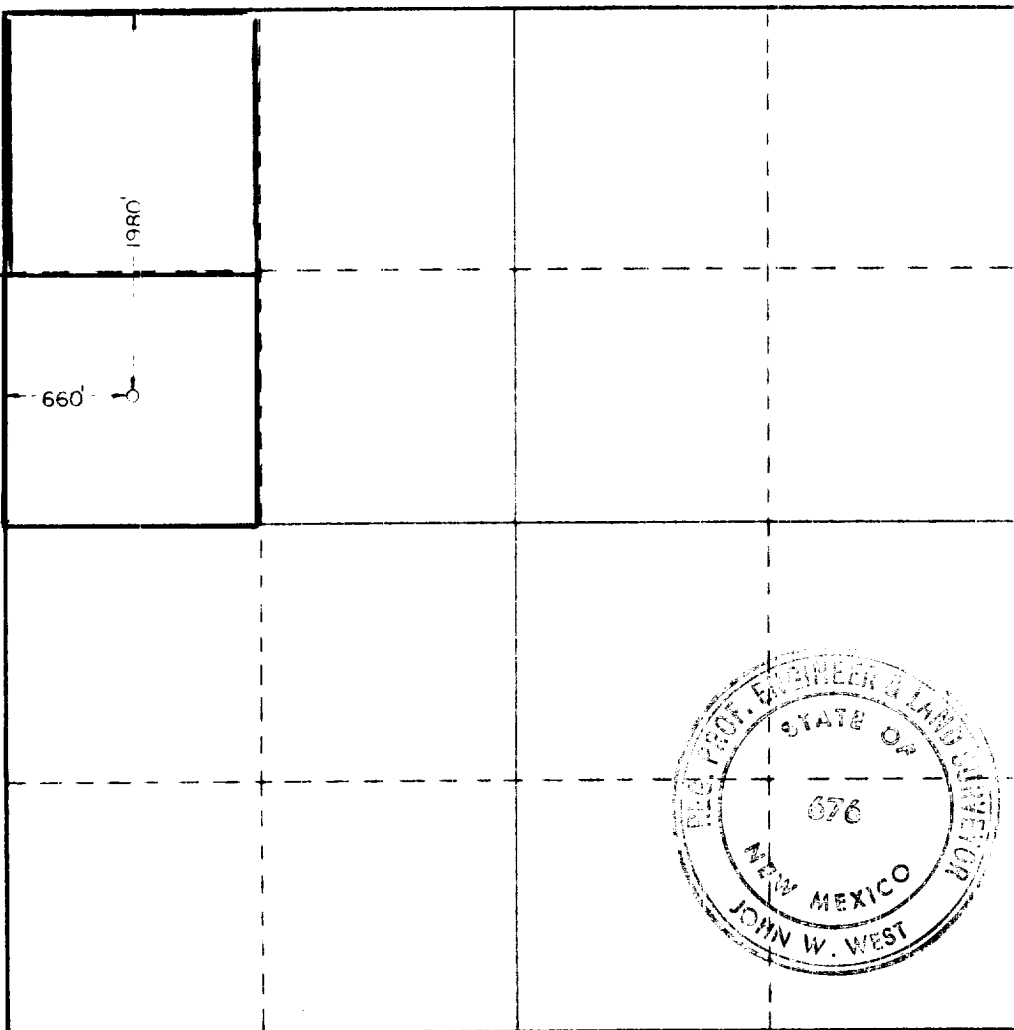

CERTIFICATION

I hereby certify that the information contained herein is true and complete to the best of my knowledge and belief.

Ronald M. Sentz
Name

Ronald M. Sentz

Position

Drilling & Production Eng.

Company

Southern Un Expl Co of TX

Date

February 10, 1981

I hereby certify that the well location shown on this plat was plotted from field notes of actual surveys made by me or under my supervision, and that the same is true and correct to the best of my knowledge and belief.

Date Surveyed

2-4-81

Registered Professional Engineer and/or Land Surveyor

John W. West
Certificate No. JOHN W. WEST 676
PATRICK A. ROMERO 6863
Ronald J. Eidson 3239

130 660 90 1320 1680 1980 2310 2640 2000 1600 1000 600 0

RECEIVED

FEB 16 1981

OIL CONSERVATION DIV.



7 station Koomey Accumulator

1 - Koomey Remote Stand

5000 WP Manifold

1-100 Shaeffer Double BOP 900 Series, 3000 WP

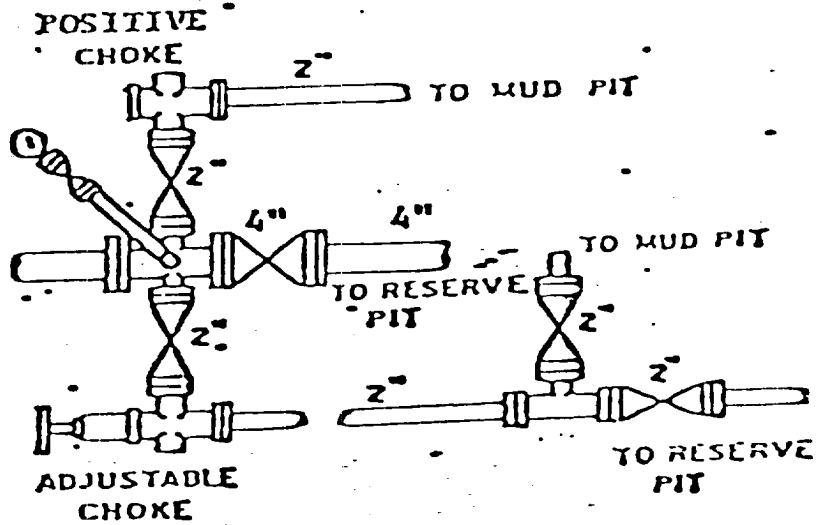
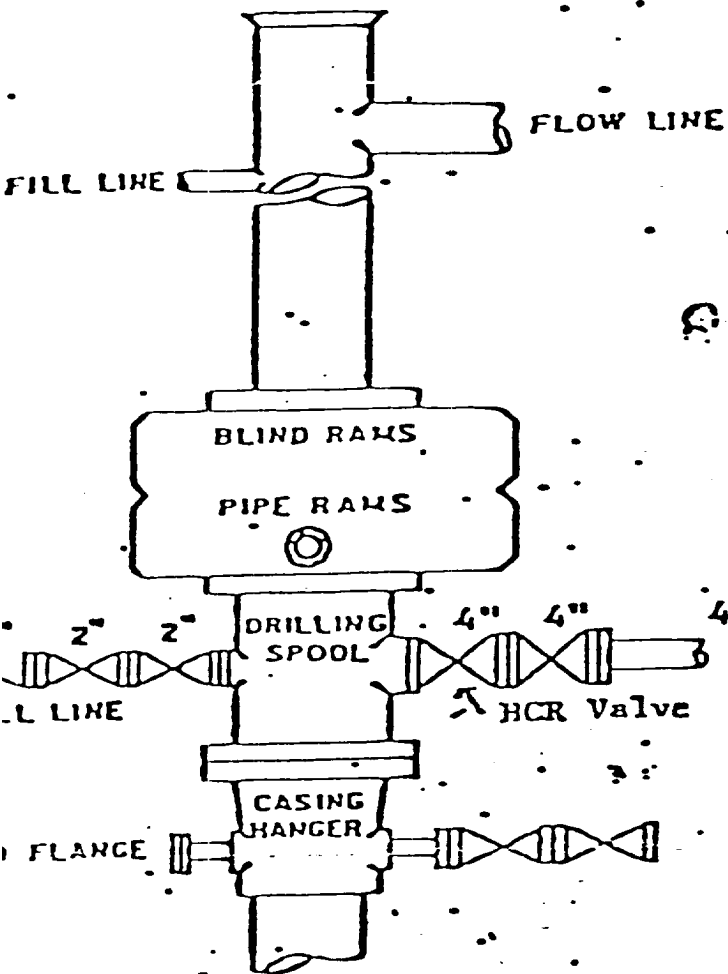

BOP Sketch
Southern Union Exploration Co.
Susco State 27 #1
660' FWL and 1980' FNL
Section 27, T10S, R33E

RECEIVED

FEB 16 1981

OIL CONSERVATION DIV.

173