

NO. OF COPIES RECEIVED	
DISTRIBUTION	
SANTA FE	
FILE	
U.S.G.S.	
LAND OFFICE	
OPERATOR	

NEW MEXICO OIL CONSERVATION COMMISSION

30-025-27278

Form C-101
Revised 1-1-65

5A. Indicate Type of Lease	
STATE <input checked="" type="checkbox"/>	FEE <input type="checkbox"/>
5. State Oil & Gas Lease No.	
V-17	

APPLICATION FOR PERMIT TO DRILL, DEEPEN, OR PLUG BACK

1a. Type of Work		7. Unit Agreement Name	
b. Type of Well OIL WELL <input checked="" type="checkbox"/> GAS WELL <input type="checkbox"/> OTHER <input type="checkbox"/> DRILL <input checked="" type="checkbox"/> DEEPEN <input type="checkbox"/> PLUG BACK <input type="checkbox"/>		8. Farm or Lease Name	
2. Name of Operator		9. Well No.	
Southern Union Exploration Company of Texas		#1	
3. Address of Operator		10. Field and Pool, or Wildcat	
1217 Main Street, Dallas, Texas 75202		Bagley - Bough "C"	
4. Location of Well		12. County	
UNIT LETTER M LOCATED 660 FEET FROM THE South LINE		Lea	
AND 660 FEET FROM THE West LINE OF SEC. 36 TWP. 10S RGE. 33E NMPM			
19. Proposed Depth		19A. Formation	
10,000'		Bough "C"	
20. Rotary or C.T.		Rotary	
21. Elevations (Show whether DF, RT, etc.)		22. Approx. Date Work will start	
4195.3 GR		February 15, 1981	

23. PROPOSED CASING AND CEMENT PROGRAM

SIZE OF HOLE	SIZE OF CASING	WEIGHT PER FOOT	SETTING DEPTH	SACKS OF CEMENT	EST. TOP
17-1/2"	13-3/8"	48#	400'	Circulate	-
12-1/4"	8-5/8"	24# & 32#	4000'	2100	Surface
7-7/8"	5-1/2"	15.5# & 17#	10,000'	1000	4000'

BOP equipment will be used in accordance with New Mexico state rules and will be adequate for the area.

See attached BOP Sketch.

APPROVAL VALID FOR 180 DAYS
PERMIT EXPIRES 8/20/81
UNLESS DRILLING UNDERWAY

IN ABOVE SPACE DESCRIBE PROPOSED PROGRAM: IF PROPOSAL IS TO DEEPEN OR PLUG BACK, GIVE DATA ON PRESENT PRODUCTIVE ZONE AND PROPOSED NEW PRODUCTIVE ZONE. GIVE BLOWOUT PREVENTER PROGRAM, IF ANY.

I hereby certify that the information above is true and complete to the best of my knowledge and belief.

Signed Ronald C. Gault Title Drilling & Production Engineer Date February 10, 1981

(This space for State Use)

APPROVED BY [Signature] TITLE SUPERVISOR DATE 8/20/81

CONDITIONS OF APPROVAL, IF ANY:

**MEXICO OIL CONSERVATION COMMISSION
WELL LOCATION AND ACREAGE DEDICATION PLAT**

Form C-102
Supersedes C-128
Effective 1-1-65

All distances must be from the outer boundaries of the Section

Operator Southern Un Expl Co of TX Southern Union Exploration Co.			Lease Susco		State 36 <i>State</i>	Well No. 1
Grid Letter M	Section 36	Township 10 South	Range 33 East	County Lea		

Grid Location of Well:

660		feet from the south	line and	660	feet from the west	line
Spot Elev 4195.3	Producing Formation Bough "C"		Pool Bagley	Dedicated Acreage 40.80 RS		Acres

1. Outline the acreage dedicated to the subject well by colored pencil or hachure marks on the plat below.
2. If more than one lease is dedicated to the well, outline each and identify the ownership thereof (both as to working interest and royalty).
3. If more than one lease of different ownership is dedicated to the well, have the interests of all owners been consolidated by communitization, unitization, force-pooling, etc?

☐ Yes ☐ No If answer is "yes," type of consolidation _____

If answer is "no," list the owners and tract descriptions which have actually been consolidated (Use reverse side of this form if necessary.) _____

No allowable will be assigned to the well until all interests have been consolidated (by communitization, unitization, forced-pooling, or otherwise) or until a non-standard unit, eliminating such interests, has been approved by the Commission.

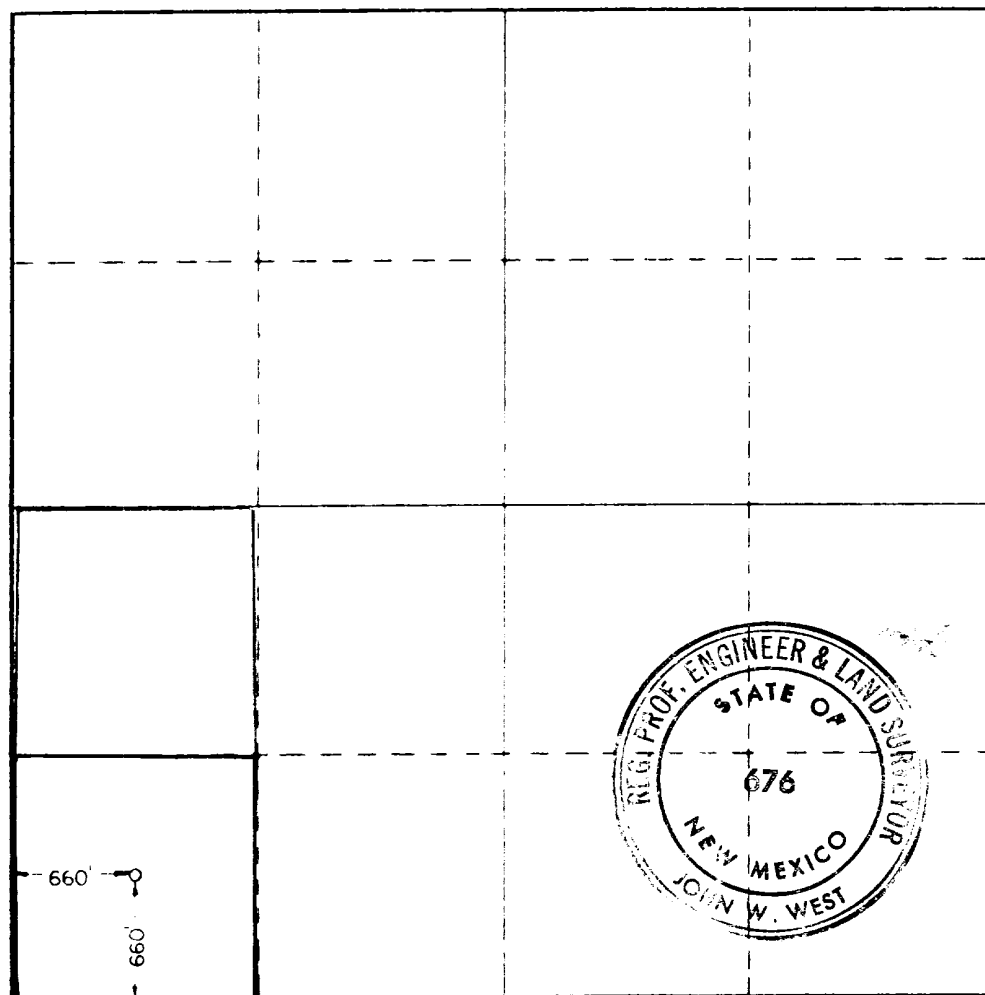

CERTIFICATION

I hereby certify that the information contained herein is true and complete to the best of my knowledge and belief.

Ronald M. Sentz
Name

Ronald M. Sentz

Position

Drilling & Production Eng.

Company

Southern Un Expl Co of TX

Date

February 10, 1981

I hereby certify that the well location shown on this plat was plotted from field notes of actual surveys made by me or under my supervision, and that the same is true and correct to the best of my knowledge and belief.

Date Surveyed

1-31-81

Registered Professional Engineer and/or Land Surveyor

John W. West

Certificate No.	JOHN W. WEST	676
	PATRICK A. ROMERO	6663
	Ronald J. Eidson	3239

660' FSL and 660' FWL
Section 36, T10S, R33E

1 - 7 station Koomey Accumulator

1 - Koomey Remote Stand

1 - 5000 HP Manifold

1 - 100 Shaeffer Double BOP 900 Series, 3000 HP

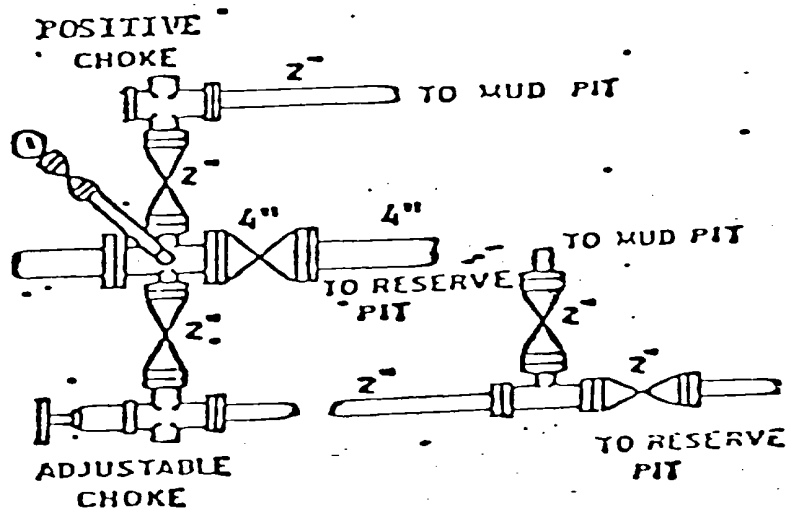
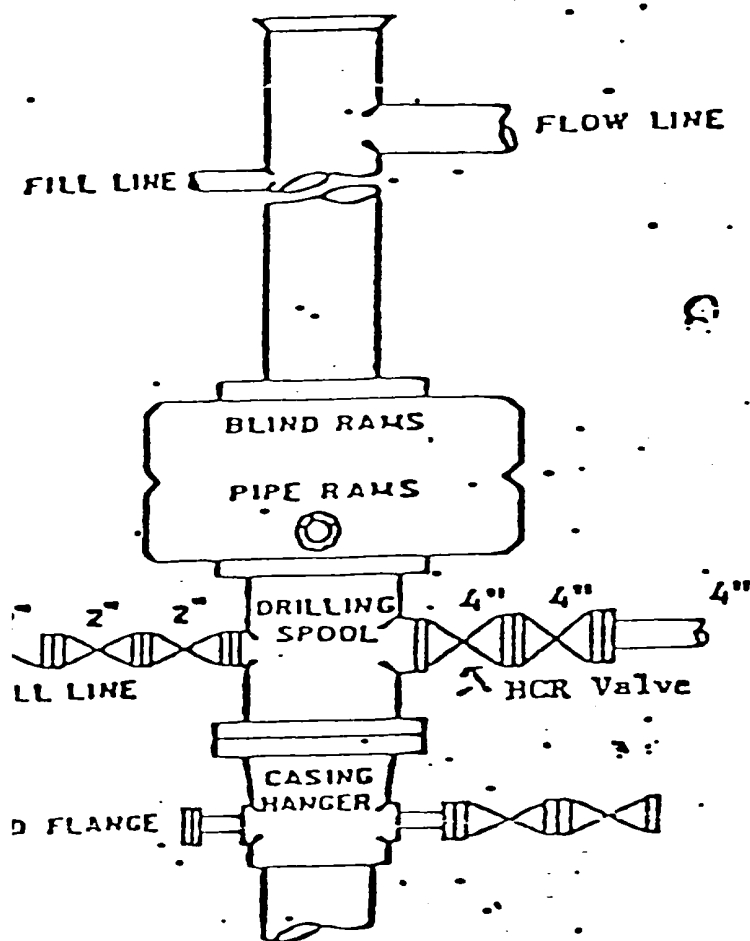

BOP Sketch
Southern Union Exploration Co.
Susco State 36 #1
660' FSL and 660' FWL
Section 36, T10S, R33E