

DISTRICT I
P.O. Box 1980, Hobbs, NM 88240

DISTRICT II
P.O. Drawer DD, Artesia, NM 88210

DISTRICT III
1000 Rio Brazos Rd., Aztec, NM 87410

OIL CONSERVATION DIVISION

P.O. Box 2088
Santa Fe, New Mexico 87504-2088

WELL API NO.

30-025-27349

5. Indicate Type of Lease

STATE ☒

FEE ☐

6. State Oil & Gas Lease No.

VA-172

SUNDRY NOTICES AND REPORTS ON WELLS

(DO NOT USE THIS FORM FOR PROPOSALS TO DRILL OR TO DEEPEN OR PLUG BACK TO A
DIFFERENT RESERVOIR. USE "APPLICATION FOR PERMIT"
(FORM C-101) FOR SUCH PROPOSALS.)

7. Lease Name or Unit Agreement Name

Mission AMV State

8. Well No.

1

9. Pool name or Wildcat

Vada Penn

1. Type of Well:

OIL
WELL ☒

GAS
WELL ☐

OTHER RE-ENTRY

2. Name of Operator

YATES PETROLEUM CORPORATION

3. Address of Operator

105 South 4th St., Artesia, NM 88210

4. Well Location

Unit Letter K : 2086 Feet From The South Line and 1874 Feet From The West Line

Section 30 Township 10S Range 34E NMPM Lea County

10. Elevation (Show whether DF, RKB, RT, GR, etc.)

4231.4' GR

11.

Check Appropriate Box to Indicate Nature of Notice, Report, or Other Data

NOTICE OF INTENTION TO:

SUBSEQUENT REPORT OF:

PERFORM REMEDIAL WORK ☐

PLUG AND ABANDON ☐

REMEDIAL WORK ☐

ALTERING CASING ☐

TEMPORARILY ABANDON ☐

CHANGE PLANS ☐

COMMENCE DRILLING OPNS. ☐

PLUG AND ABANDONMENT ☐

PULL OR ALTER CASING ☐

CASING TEST AND CEMENT JOB ☐

OTHER: ☐

OTHER: ☐

12. Describe Proposed or Completed Operations (Clearly state all pertinent details, and give pertinent dates, including estimated date of starting any proposed work) SEE RULE 1103.

Abo zone tested non-productive. Propose to test well in Bough "C", "B" and "A" as follows;
Bough "C" - 9958-9967' w/20 shots. Acidize w/2000 gals 15% NEFE.
Bough "B" - 9899-9925' w/26 shots. Acidize w/2500 gals 15% NEFE.
Bough "A" - 9847-9850' w/8 shots. Acidize w/1000 gals 15% NEFE.

Verbal permission obtained from Evelyn Downs, NMOCD, Hobbs, NM to test Bough zones, 4-26-93.

I hereby certify that the information above is true and complete to the best of my knowledge and belief.

SIGNATURE Juanita Goodlett

TITLE Production Supervisor

DATE 4-26-93

TYPE OR PRINT NAME

Juanita Goodlett

TELEPHONE NO. 505/748-1471

(This space for State Use)

ORIGINAL SIGNED BY JERRY SEXTON
DISTRICT SUPERVISOR

APPROVED BY

TITLE

DATE

APR 29 1993

CONDITIONS OF APPROVAL, IF ANY:

Submit to Appropriate
District Office
State Lease - 4 copies
Fee Lease - 3 copies

State of New Mexico
Energy, Minerals and Natural Resources Department

Form C-102
Revised 1-1-89

OIL CONSERVATION DIVISION

DISTRICT I
P.O. Box 1980, Hobbs, NM 88240

P.O. Box 2088
Santa Fe, New Mexico 87504-2088

DISTRICT II
P.O. Drawer DD, Artesia, NM 88210

DISTRICT III
1000 Rio Brazos Rd., Aztec, NM 87410

WELL LOCATION AND ACREAGE DEDICATION PLAT

All Distances must be from the outer boundaries of the section

Operator YATES PETROLEUM CORPORATION			Lease Mission AMV State		Well No. 1
Unit Letter K	Section 30	Township 10S	Range 34E	NMPM	County Lea
Actual Footage Location of Well: 2086 feet from the South line and 1874 feet from the West line					
Ground level Elev. 4231' GR	Producing Formation Bough		Pool Vada Penn		Dedicated Acreage: 160 Acres

1. Outline the acreage dedicated to the subject well by colored pencil or hatchure marks on the plat below.

2. If more than one lease is dedicated to the well, outline each and identify the ownership thereof (both as to working interest and royalty).

3. If more than one lease of different ownership is dedicated to the well, have the interest of all owners been consolidated by communitization, unitization, force-pooling, etc.?

☐ Yes ☐ No If answer is "yes" type of consolidation _____

If answer is "no" list the owners and tract descriptions which have actually been consolidated. (Use reverse side of this form if necessary.) _____

No allowable will be assigned to the well until all interests have been consolidated (by communitization, unitization, forced-pooling, or otherwise) or until a non-standard unit, eliminating such interest, has been approved by the Division.

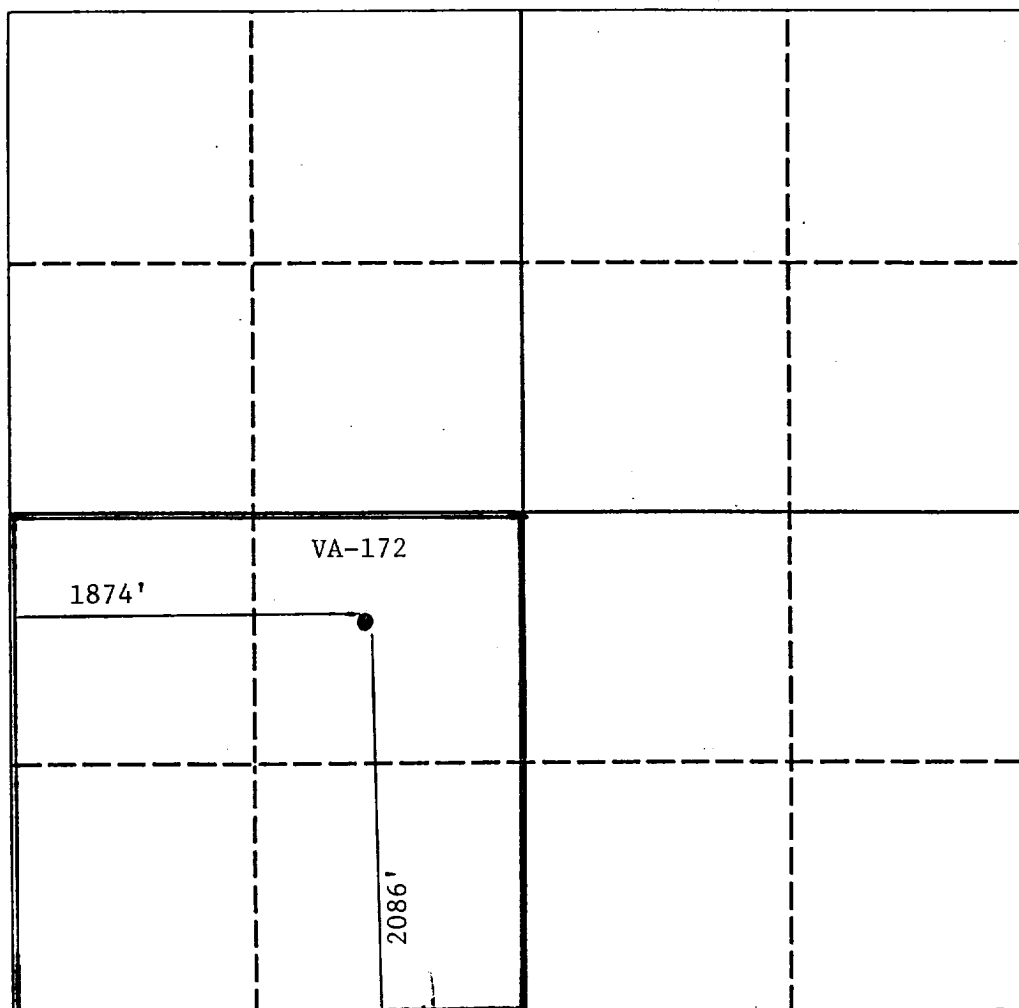

0 330 660 990 1320 1650 1980 2310 2640 2000 1500 1000 500 0

OPERATOR CERTIFICATION

I hereby certify that the information contained herein is true and complete to the best of my knowledge and belief.

Signature

Printed Name

JUANITA GOODLETT

Position

PRODUCTION SUPERVISOR

Company

YATES PETROLEUM CORPORATION

Date

4-26-93

SURVEYOR CERTIFICATION

I hereby certify that the well location shown on this plat was plotted from field notes of actual surveys made by me or under my supervision, and that the same is true and correct to the best of my knowledge and belief.

Date Surveyed

Refer to original plat

Signature & Seal of
Professional Surveyor

Certificate No.