

30-025-27388

NO. OF COPIES RECEIVED	
DISTRIBUTION	
SANTA FE	
FILE	
U.S.G.S.	
LAND OFFICE	
OPERATOR	

NEW MEXICO OIL CONSERVATION COMMISSION

Form C-101
Revised 1-1-65

5A. Indicate Type of Lease STATE <input type="checkbox"/> FEE <input checked="" type="checkbox"/>
5. State Oil & Gas Lease No. N/A
7. Unit Agreement Name
8. Farm or Lease Name Southland Farrar "C"
9. Well No. 1
10. Field and Pool, or Wildcat Inbe-Pennsylvanian Oil Pool
12. County Lea
19. Proposed Depth 10,200'
19A. Formation Pennsylvanian
20. Rotary or C.T. rotary
21. Elevations (Show whether DF, RT, etc.) 4217.2' Gr.
21A. Kind & Status Plug. Bond Blanket bond-active
21B. Drilling Contractor Moranco Drilling Co.
22. Approx. Date Work will start 5-15-81

APPLICATION FOR PERMIT TO DRILL, DEEPEN, OR PLUG BACK

1a. Type of Work	DRILL <input checked="" type="checkbox"/> DEEPEN <input type="checkbox"/> PLUG BACK <input type="checkbox"/>
b. Type of Well	OIL WELL <input checked="" type="checkbox"/> GAS WELL <input type="checkbox"/> OTHER <input type="checkbox"/> SINGLE ZONE <input checked="" type="checkbox"/> MULTIPLE ZONE <input type="checkbox"/>
2. Name of Operator	Wainoco Oil & Gas Company
3. Address of Operator	1200 Smith, Suite 1500, Houston, Texas 77002
4. Location of Well	UNIT LETTER <u>D</u> LOCATED <u>660</u> FEET FROM THE <u>north</u> LINE AND <u>660</u> FEET FROM THE <u>west</u> LINE OF SEC. <u>13</u> TWP. <u>11-S</u> RGE. <u>33-E</u> NMPM
11. Elevations (Show whether DF, RT, etc.)	4217.2' Gr.
21A. Kind & Status Plug. Bond	Blanket bond-active
21B. Drilling Contractor	Moranco Drilling Co.
22. Approx. Date Work will start	5-15-81

PROPOSED CASING AND CEMENT PROGRAM

SIZE OF HOLE	SIZE OF CASING	WEIGHT PER FOOT	SETTING DEPTH	SACKS OF CEMENT	EST. TOP
17-1/2"	13-3/8"	48#	400'	400	surface
12-1/4"	8-5/8"	24#	4000'	1600	surface
7-7/8"	5-1/2"	17#	10200'	2200	8000'

Drill 17-1/2" hole to 400'. Set 13-3/8" surface casing and cement to surface with 400 sx.
 Drill 12-1/4" hole to 4000'. Set 8-5/8" intermediate casing and cement to surface with 1600
 sx. Drill 7-7/8" hole to TD of approximately 10200'. If productive, set 5-1/2" production
 string at TD and cement with 2200 sx. Top of cement estimated to be approximately 8000'.
 Primary objective - Pennsylvanian Oil Pool. BOP information attached.

APPROVAL VALID FOR 180 DAYS
 PERMIT EXPIRES 11/1/81
 UNLESS DRILLING UNDERWAY

IN ABOVE SPACE DESCRIBE PROPOSED PROGRAM: IF PROPOSAL IS TO DEEPEN OR PLUG BACK, GIVE DATA ON PRESENT PRODUCTIVE ZONE AND PROPOSED NEW PRODUCTIVE ZONE. GIVE BLOWOUT PREVENTER PROGRAM, IF ANY.

hereby certify that the information above is true and complete to the best of my knowledge and belief.

Signed Paul Budic Title Regulatory Coordinator Date 4-22-81

(This space for State Use)

APPROVED BY Lesho H. Clements TITLE Oil & Gas Inspector DATE MAY 1981

CONDITIONS OF APPROVAL, IF ANY:

MEXICO OIL CONSERVATION COMMISSION
WELL LOCATION AND ACREAGE DEDICATION PLAT

Form C-102
Supersedes C-128
Effective 1-1-65

All distances must be from the outer boundaries of the Section.

Operator Wainoco Oil & Gas Company			Lease Wainoco-Southland Farrar "C"		Well No. 1
Unit Letter D	Section 13	Township 11 South	Range 33 East	County Lea	
Actual Footage Location of Well: 660 feet from the North line and 660 feet from the West line					
Ground Level Elev. 4217.2'	Producing Formation Pennsylvanian		Pool Inbe-Pennsylvanian Oil Pool		Dedicated Acreage: 80 Acres

1. Outline the acreage dedicated to the subject well by colored pencil or hatchure marks on the plat below.
2. If more than one lease is dedicated to the well, outline each and identify the ownership thereof (both as to working interest and royalty). One lease
3. If more than one lease of different ownership is dedicated to the well, have the interests of all owners been consolidated by communitization, unitization, force-pooling, etc? N/A

☐ Yes ☐ No If answer is "yes," type of consolidation _____

If answer is "no," list the owners and tract descriptions which have actually been consolidated. (Use reverse side of this form if necessary.) _____

No allowable will be assigned to the well until all interests have been consolidated (by communitization, unitization, forced-pooling, or otherwise) or until a non-standard unit, eliminating such interests, has been approved by the Commission.

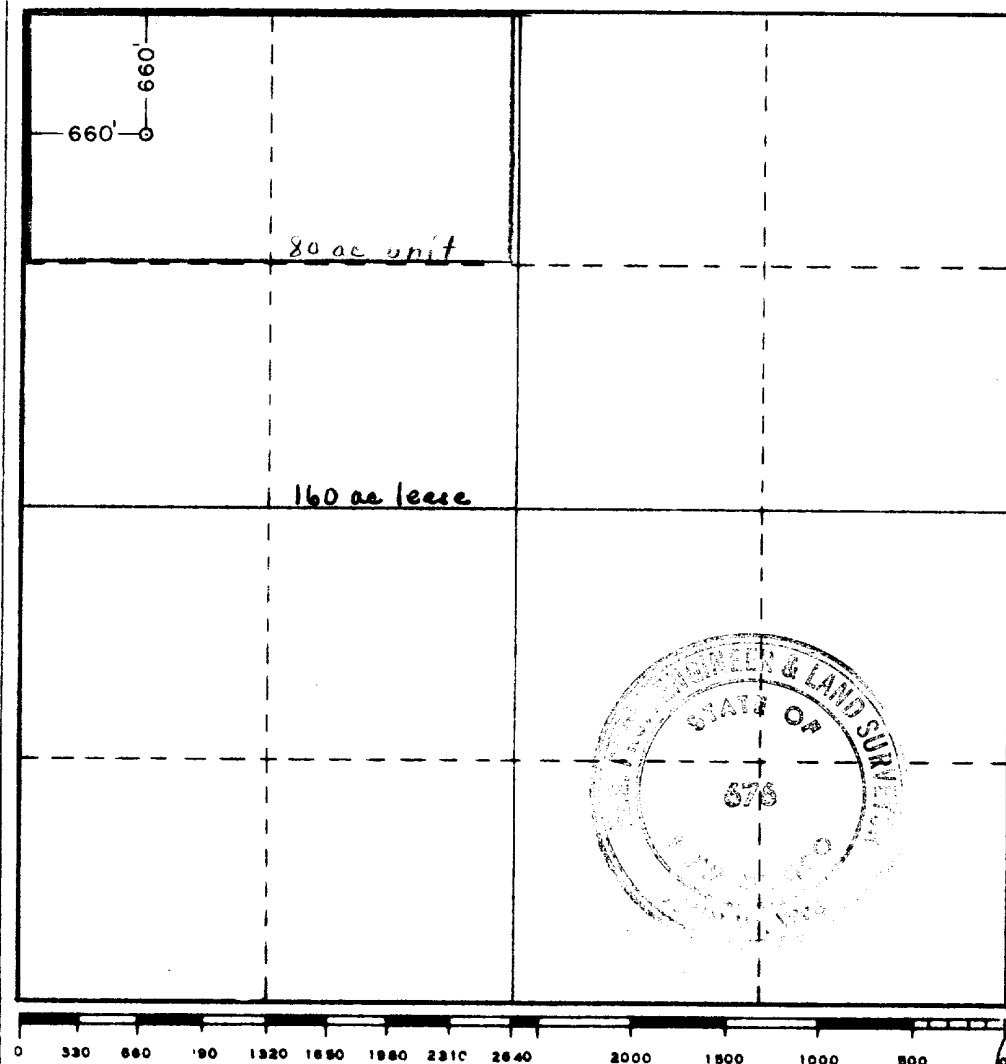

CERTIFICATION

I hereby certify that the information contained herein is true and complete to the best of my knowledge and belief.

Pat Budro

Name
Pat Budro
Position
Regulatory Coordinator
Company
Wainoco Oil & Gas Company

Date
4-16-81

I hereby certify that the well location shown on this plat was plotted from field notes of actual surveys made by me or under my supervision, and that the same is true and correct to the best of my knowledge and belief.

Date Surveyed
April 6, 1981

Registered Professional Engineer and/or Land Surveyor

John W. West

Certificate No. **JOHN W. WEST 676**
PATRICK A. ROMERO 6468
Ronald J. Eidson 3239

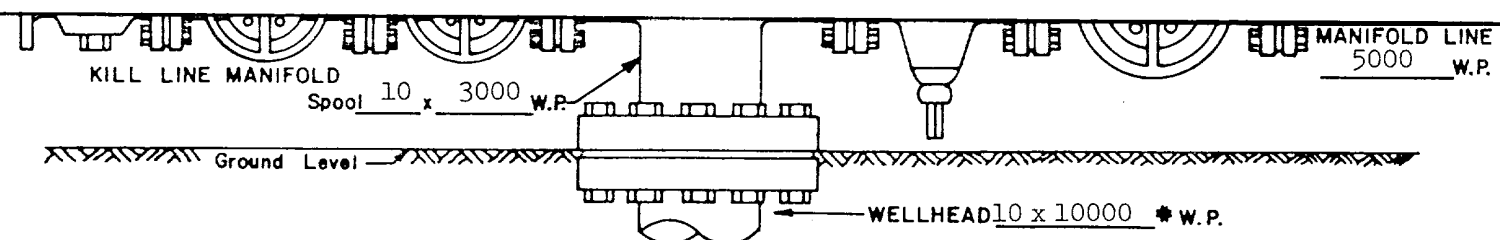

Fill blanks with applicable information. If not applicable, enter "N.A." or cross-out item shown. Enter other pertinent information below.

COMPANY Wainoco Oil & Gas Company WELL NAME Southland Farrar "C" #1

LOCATION 660' FNL and 660' FWL of Sec. 13, T11S, R33E, Lea County, New Mexico

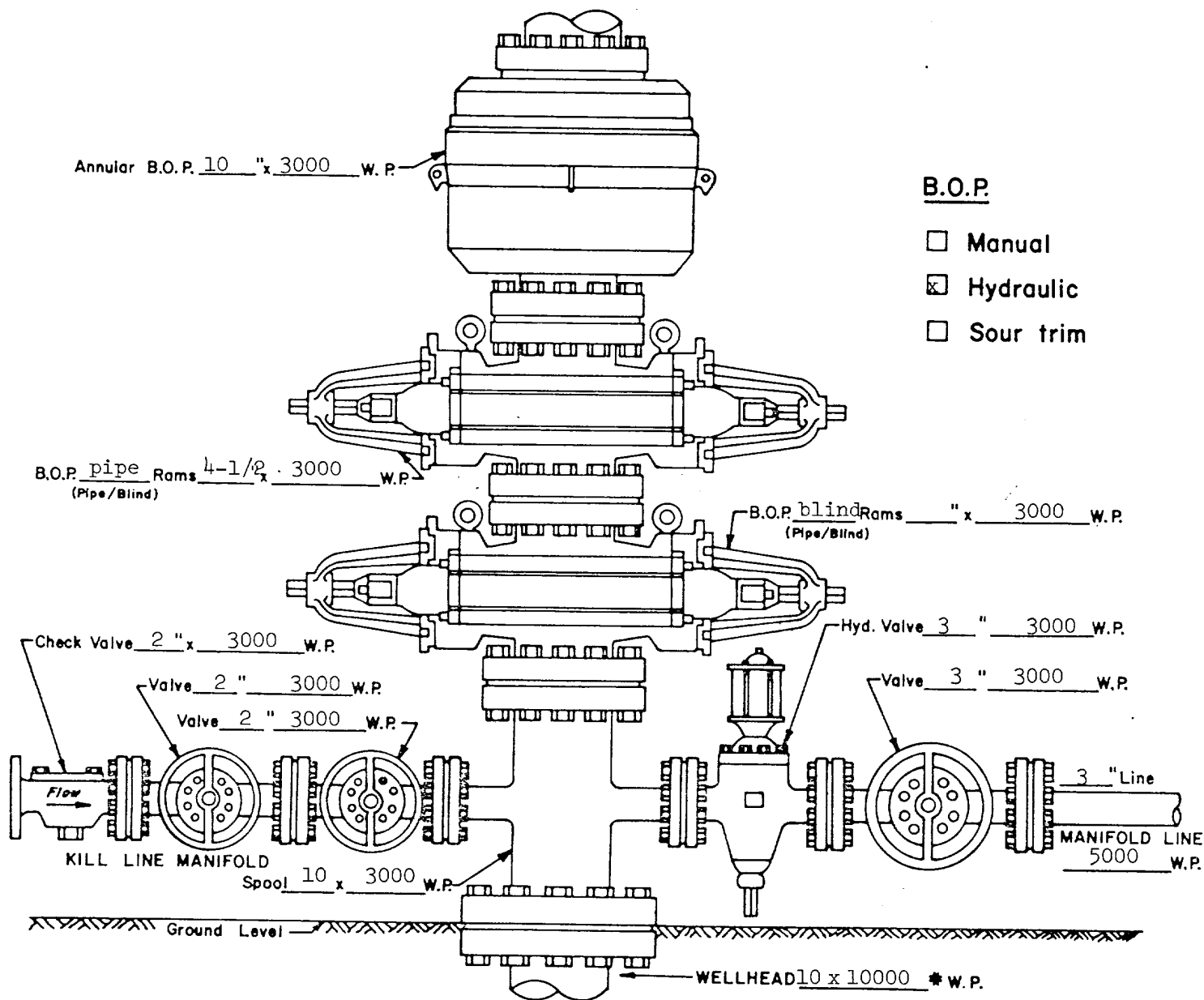

B.O.P.

- ☐ Manual
- ☒ Hydraulic
- ☐ Sour trim

Fill blanks with applicable information. If not applicable, enter "N.A." or cross-out item shown. Enter other pertinent information below.
