

DISTRIBUTION		
STATE		
FILE		
U.S.G.S.		
LAND OFFICE		
OPERATOR		

NEW MEXICO OIL CONSERVATION COMMISSION

Form C-101 30-000-0 1118
Revised 1-1-65

5A. Indicate Type of Lease
STATE <input checked="" type="checkbox"/> FEE <input type="checkbox"/>
5. State Oil & Gas Lease No.
L-6428

APPLICATION FOR PERMIT TO DRILL, DEEPEN, OR PLUG BACK

1a. Type of Work	DRILL <input checked="" type="checkbox"/> DEEPEN <input type="checkbox"/> PLUG BACK <input type="checkbox"/>	7. Unit Agreement Name
b. Type of Well	OIL WELL <input checked="" type="checkbox"/> GAS WELL <input type="checkbox"/> OTHER <input type="checkbox"/> SINGLE ZONE <input checked="" type="checkbox"/> MULTIPLE ZONE <input type="checkbox"/>	8. Farm or Lease Name
2. Name of Operator	M.C. & Dale Gandy	9. Well No.
3. Address of Operator	P.O. Box 827, Tatum, New Mexico 88267	10. Field and Pool, or Wildcat
4. Location of Well	UNIT LETTER <u>EJ</u> LOCATED <u>1650</u> FEET FROM THE <u>North</u> LINE AND <u>1980</u> FEET FROM THE <u>West</u> LINE OF SEC. <u>18</u> TWP. <u>10S</u> RGE. <u>37E</u> NMPM	12. County
11. Elevations (Show whether DF, RT, etc.)	3974.3 GL	19. Proposed Depth
21A. Kind & Status Plug. Bond	Applied For	19A. Formation
21B. Drilling Contractor	Lynnco Drlg. Co.	20. Rotary or C.T.
22. Approx. Date Work will start	Feb. 7, 1982	

23. PROPOSED CASING AND CEMENT PROGRAM

SIZE OF HOLE	SIZE OF CASING	WEIGHT PER FOOT	SETTING DEPTH	SACKS OF CEMENT	EST. TOP
12-1/4	8-5/8	24	450 ±	325	Surf
7-7/8	4-1/2	10.5	5000 ±	1000	Surf

Plans are to circulate cement to surface on both strings.
Shaffer Type B Double series 900 BOP will Be Used, Schematics attached.

APPROVAL VALID FOR 180 DAYS
PERMIT EXPIRES 7/27/82
UNLESS DRILLING UNDERWAY

IN ABOVE SPACE DESCRIBE PROPOSED PROGRAM: IF PROPOSAL IS TO DEEPEN OR PLUG BACK, GIVE DATA ON PRESENT PRODUCTIVE ZONE AND PROPOSED NEW PRODUCTIVE ZONE. GIVE BLOWOUT PREVENTER PROGRAM, IF ANY.

I hereby certify that the information above is true and complete to the best of my knowledge and belief.

Signed [Signature] Title Basin Oil Consultants, Inc. Date 1-20-82

(This space for State Use)

Orig. Signed by

Les Clements

APPROVED BY Oil & Gas Insp.

TITLE

DATE

CONDITIONS OF APPROVAL, IF ANY:

NEW MEXICO OIL CONSERVATION COMMISSION
WELL LOCATION AND ACREAGE DEDICATION PLAT

Form C-102
 Supersedes C-128
 Effective 1-1-65

All distances must be from the outer boundaries of the Section

Operator M.C. & DALE GANDY OIL COMPANY		Lease Wiser State		Well No. 7	
Section 18	Township 10 South	Range 37 East	County Lea		

Actual Footage Location of Well:
 1650 feet from the North line and 1980 feet from the West line

Ground Level Elev. 3974.3'	Producing Formation San Andres	Pool East Crossroads San Andres	Dedicated Acreage: 40 Acres
--------------------------------------	--	---	---------------------------------------

1. Outline the acreage dedicated to the subject well by colored pencil or hatchure marks on the plat below.
2. If more than one lease is dedicated to the well, outline each and identify the ownership thereof (both as to working interest and royalty).
3. If more than one lease of different ownership is dedicated to the well, have the interests of all owners been consolidated by communitization, unitization, force-pooling, etc?

☐ Yes ☐ No If answer is "yes," type of consolidation _____

If answer is "no," list the owners and tract descriptions which have actually been consolidated. (Use reverse side of this form if necessary.) _____

No allowable will be assigned to the well until all interests have been consolidated (by communitization, unitization, forced-pooling, or otherwise) or until a non-standard unit, eliminating such interests, has been approved by the Commission.

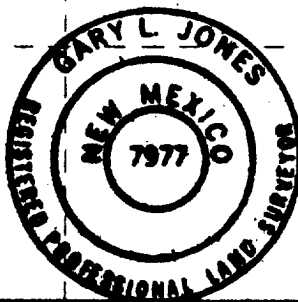
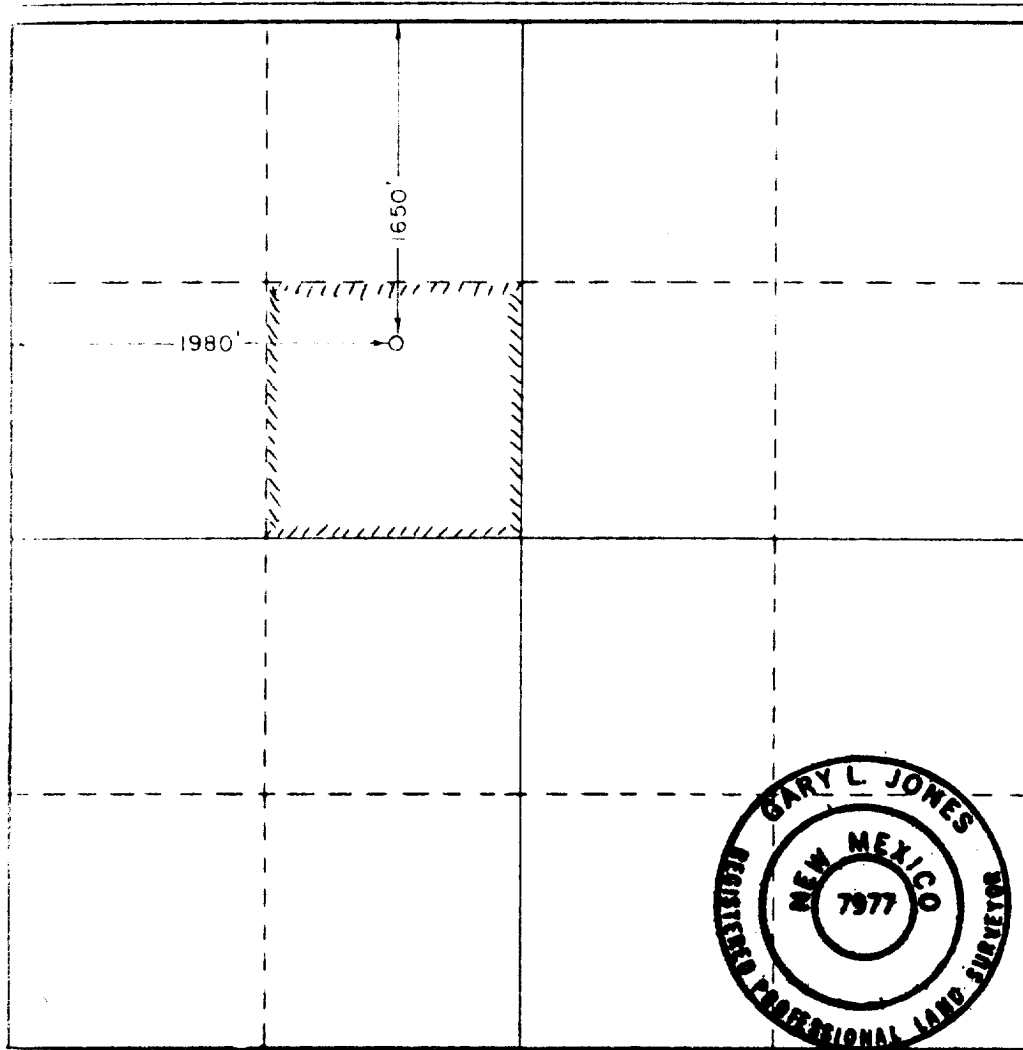

CERTIFICATION

I hereby certify that the information contained herein is true and complete to the best of my knowledge and belief

Basin Oil Consultants

Position
M.C. & Dale Gandy Oil Co.

Company
January 20, 1982

Date

I hereby certify that the well location shown on this plat was plotted from field notes of actual surveys made by me or under my supervision, and that the same is true and correct to the best of my knowledge and belief.

Date Surveyed

1/15/82

Registered Professional Engineer and/or Land Surveyor

Certificate No.

7977

330 660 990 1320 1650 1980 2310 2640 2970 3300 3630 3960 4290 4620 4950 5280 5610 5940 6270 6600

BLOWOUT PREVENTER HOOK-UP

2000 PSI WORKING PRESSURE

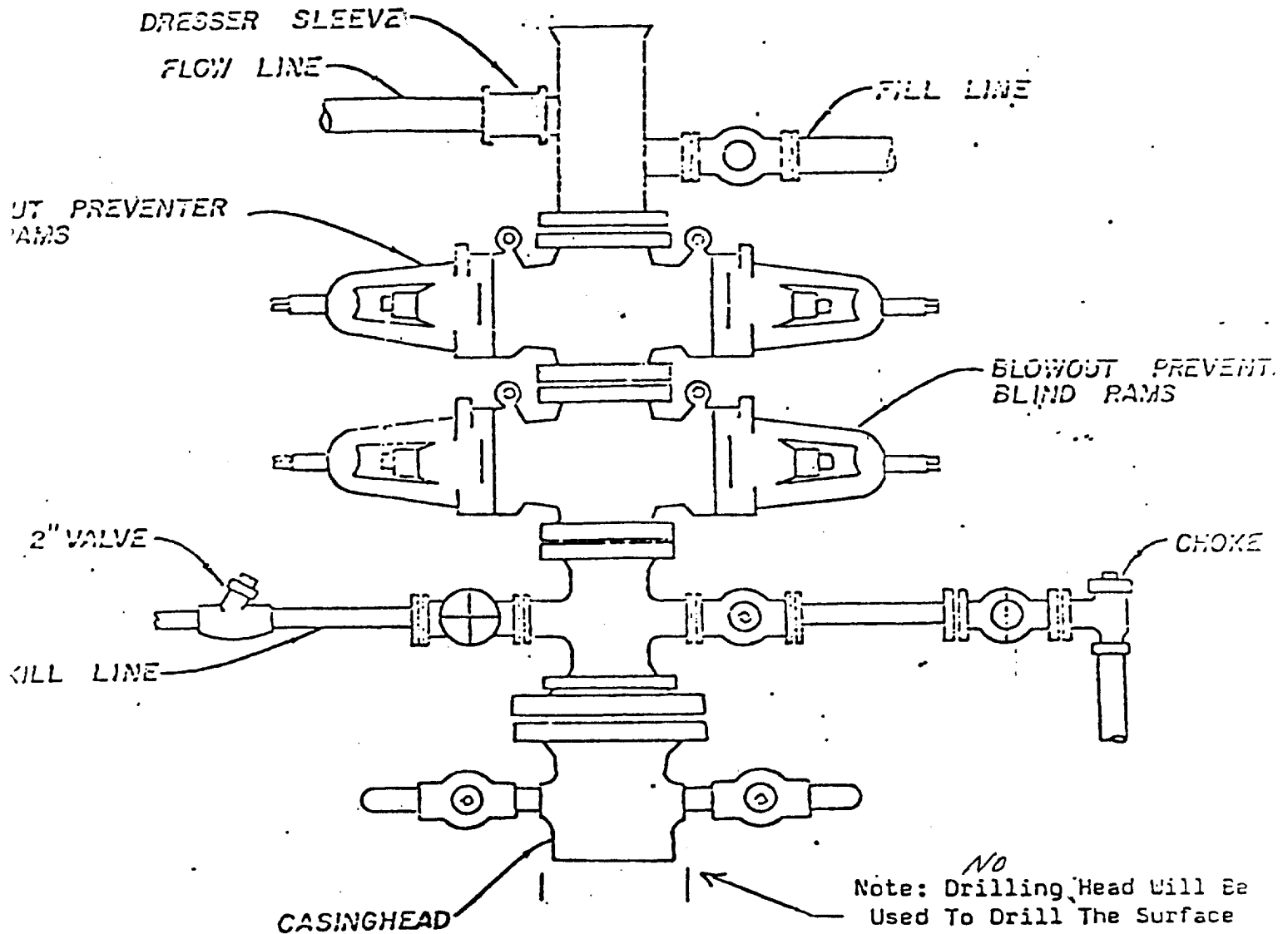

M.C. & Dale Gandy Oil Co.
Wiser State, Well No.2

1650 FNL And 1980 FWL, Sec 18, T10S-R37E
Lea County, New Mexico