

STATE OF NEW MEXICO
ENERGY AND MINERALS DEPARTMENT

OIL CONSERVATION DIVISION
P. O. BOX 2088
SANTA FE, NEW MEXICO 87501

Form C-101
Revised 10-1-78

NO. OF COPIES RECEIVED	
DISTRIBUTION	
SANTA FE	
FILE	
U.S.G.S.	
LAND OFFICE	
OPERATOR	

5A. Indicate Type of Lease
STATE ☒ FEDERAL ☐
5. State Oil & Gas Lease No.
K-169

APPLICATION FOR PERMIT TO DRILL, DEEPEN, OR PLUG BACK

1a. Type of Work DRILL <input type="checkbox"/> DEEPEN <input type="checkbox"/> PLUG BACK <input type="checkbox"/>		7. Unit Agreement Name
b. Type of Well OIL WELL <input checked="" type="checkbox"/> GAS WELL <input type="checkbox"/> OTHER <input type="checkbox"/> SINGLE ZONE <input checked="" type="checkbox"/> MULTIPLE ZONE <input type="checkbox"/>		8. Farm or Lease Name PATTON
2. Name of Operator NRM PETROLEUM CORPORATION		9. Well No. 1
3. Address of Operator 900 BUILDING OF THE SOUTHWEST, MIDLAND, TEXAS 79701		10. Field and Pool, or Wildcat WILDCAT
4. Location of Well UNIT LETTER <u>L</u> LOCATED <u>1980</u> FEET FROM THE <u>SOUTH</u> LINE AND <u>660</u> FEET FROM THE <u>WEST</u> LINE OF SEC. <u>5</u> TWP. <u>9 S.</u> RGE. <u>32 E.</u> NMPM		12. County LEA
19. Proposed Depth 9600'		19A. Formation PENNSYLVANIAN
20. Rotary or C.T. ROTARY		
21. Elevations (Show whether DF, RT, etc.) 4413 GR	21A. Kind & Status Plug. Bond BLANKET	21B. Drilling Contractor NOT SELECTED
22. Approx. Date Work will start MAY 3, 1982		

23.

PROPOSED CASING AND CEMENT PROGRAM

SIZE OF HOLE	SIZE OF CASING	WEIGHT PER FOOT	SETTING DEPTH	SACKS OF CEMENT	EST. TOP
17-1/2"	12-3/4"	40#	400'	400	SURFACE
11"	8-5/8"	32#	4200'	900	SURFACE
7-7/8"	4-1/2"	11.6#	9600'	400	8300'

BOP STACK WILL CONSIST OF A DOUBLE RAM, SERIES 1500 PREVENTER AND HYDRILL.

BOP SKETCH IS ATTACHED.

APPROVAL VALID FOR 180 DAYS
PERMIT EXPIRES 10/26/82
UNLESS DRILLING UNDERWAY

IN ABOVE SPACE DESCRIBE PROPOSED PROGRAM; IF PROPOSAL IS TO DEEPEN OR PLUG BACK, GIVE DATA ON PRESENT PRODUCTIVE ZONE AND PROPOSED NEW PRODUCTIVE ZONE. GIVE BLOWOUT PREVENTER PROGRAM, IF ANY.

I hereby certify that the information above is true and complete to the best of my knowledge and belief.

Signed Arthur R. Brown Title AGENT Date APRIL 23, 1982
(This space for State Use)

ORIGINAL SIGNED BY

APPROVED BY JERRY SEXTON TITLE DATE APR 26 1982
CONDITIONS OF APPROVAL, IF ANY:

MEXICO OIL CONSERVATION COMMISSION
WELL LOCATION AND ACREAGE DEDICATION PLAT

Form C-102
 Supersedes C-128
 Effective 1-1-65

All distances must be from the outer boundaries of the Section.

Operator N R M PETROLEUM CORP.			Lease PATTON		Well No. 1
Unit Letter L	Section 5	Township 9 SOUTH	Range 32 EAST	County LEA	
Actual Footage Location of Well: 1980 feet from the SOUTH line and 660 feet from the WEST line					
Ground Level Elev. 4413.0	Producing Formation PENNSYLVANIAN		Pool WILDCAT		Dedicated Acreage: 40 Acres

1. Outline the acreage dedicated to the subject well by colored pencil or hatchure marks on the plat below.
2. If more than one lease is dedicated to the well, outline each and identify the ownership thereof (both as to working interest and royalty)
3. If more than one lease of different ownership is dedicated to the well, have the interests of all owners been consolidated by communitization, unitization, force-pooling, etc?

☐ Yes ☐ No If answer is "yes," type of consolidation _____

If answer is "no," list the owners and tract descriptions which have actually been consolidated. (Use reverse side of this form if necessary.) _____

No allowable will be assigned to the well until all interests have been consolidated (by communitization, unitization, forced-pooling, or otherwise) or until a non-standard unit, eliminating such interests, has been approved by the Commission.

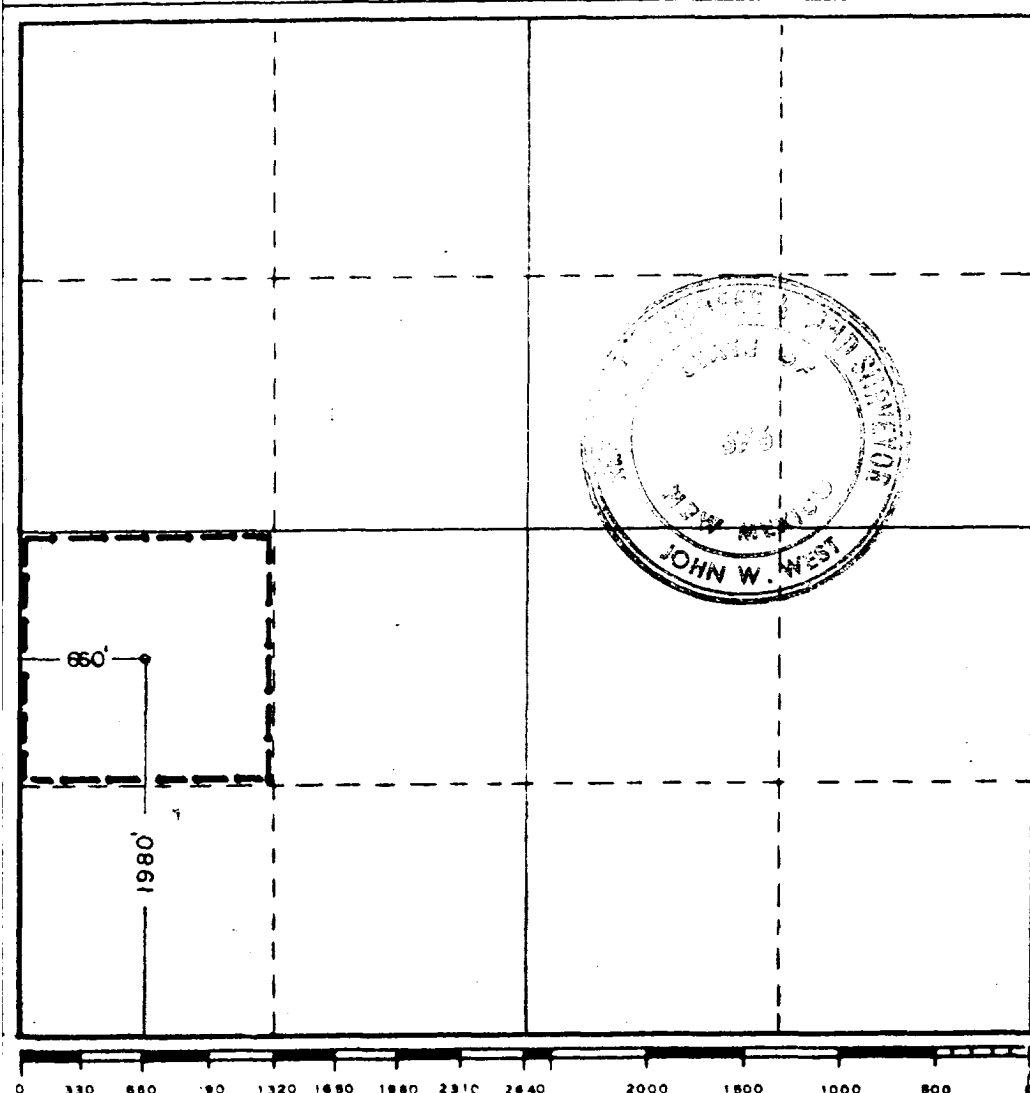

CERTIFICATION

I hereby certify that the information contained herein is true and complete to the best of my knowledge and belief.

Arthur R. Brown
 Arthur R. Brown

Position

Agent for

Company

NRM PETROLEUM CORPORATION

Date

APRIL 23, 1982

I hereby certify that the well location shown on this plat was plotted from field notes of actual surveys made by me or under my supervision, and that the same is true and correct to the best of my knowledge and belief.

Date Surveyed

4-20-82

Registered Professional Engineer
 and/or Land Surveyor

John W. West

Certificate No. **JOHN W. WEST 878**
PATRICK A. ROMERO 8883
Ronald J. Eidson 3239

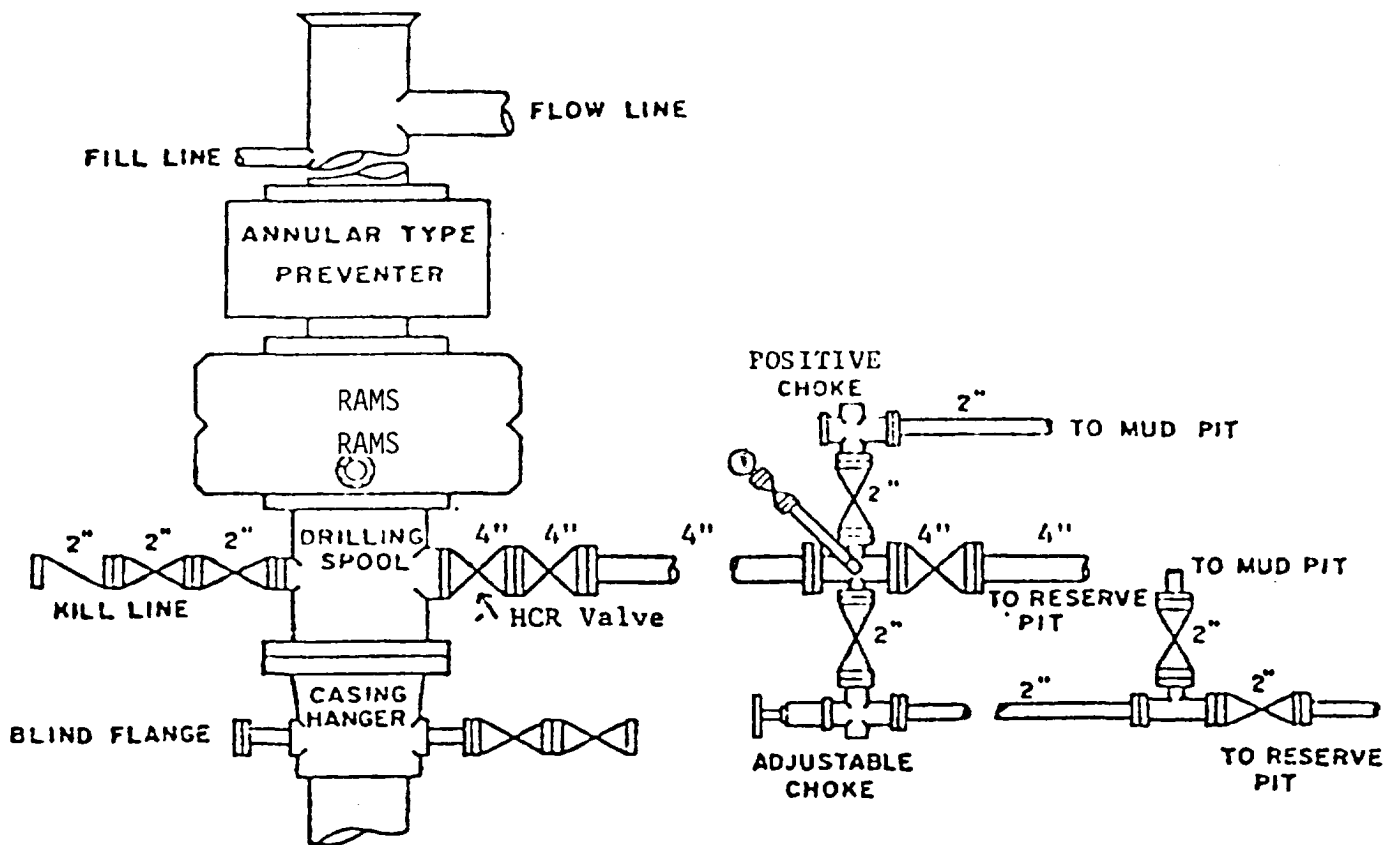

BOP STACK

5000 PSI WORKING PRESSURE

BOP ARRANGEMENT