

## OIL CONSERVATION DIVISION

P. O. BOX 2088

Form C-102  
Revised 10-1-79STATE OF NEW MEXICO  
ENERGY AND MINERALS DEPARTMENT

SANTA FE, NEW MEXICO 87501

All distances must be from the outer boundaries of the Section.

Operator <b>Coastal Oil &amp; Gas Corp.</b>			Lease <b>Gonzales Federal</b>		Well No. <b>9</b>
Unit Letter <b>0</b>	Section <b>31</b>	Township <b>9-South</b>	Range <b>33 East</b>	County <b>Lea</b>	
Actual Footage Location of Well:					
<b>760</b> feet from the <b>South</b> line and		<b>1980</b> feet from the <b>East</b> line			
Ground Level Elev. <b>4220</b>	Producing Formation <b>San Andres</b>	Pool <b>Flying "M" (SA)</b>		Dedicated Acreage: <b>80</b> Acres	

1. Outline the acreage dedicated to the subject well by colored pencil or hatchure marks on the plat below.
2. If more than one lease is dedicated to the well, outline each and identify the ownership thereof (both as to working interest and royalty).
3. If more than one lease of different ownership is dedicated to the well, have the interests of all owners been consolidated by communitization, unitization, force-pooling, etc?

☐ Yes ☐ No If answer is "yes," type of consolidation \_\_\_\_\_

If answer is "no," list the owners and tract descriptions which have actually been consolidated. (Use reverse side of this form if necessary.) \_\_\_\_\_

No allowable will be assigned to the well until all interests have been consolidated (by communitization, unitization, forced-pooling, or otherwise) or until a non-standard unit, eliminating such interests, has been approved by the Division.

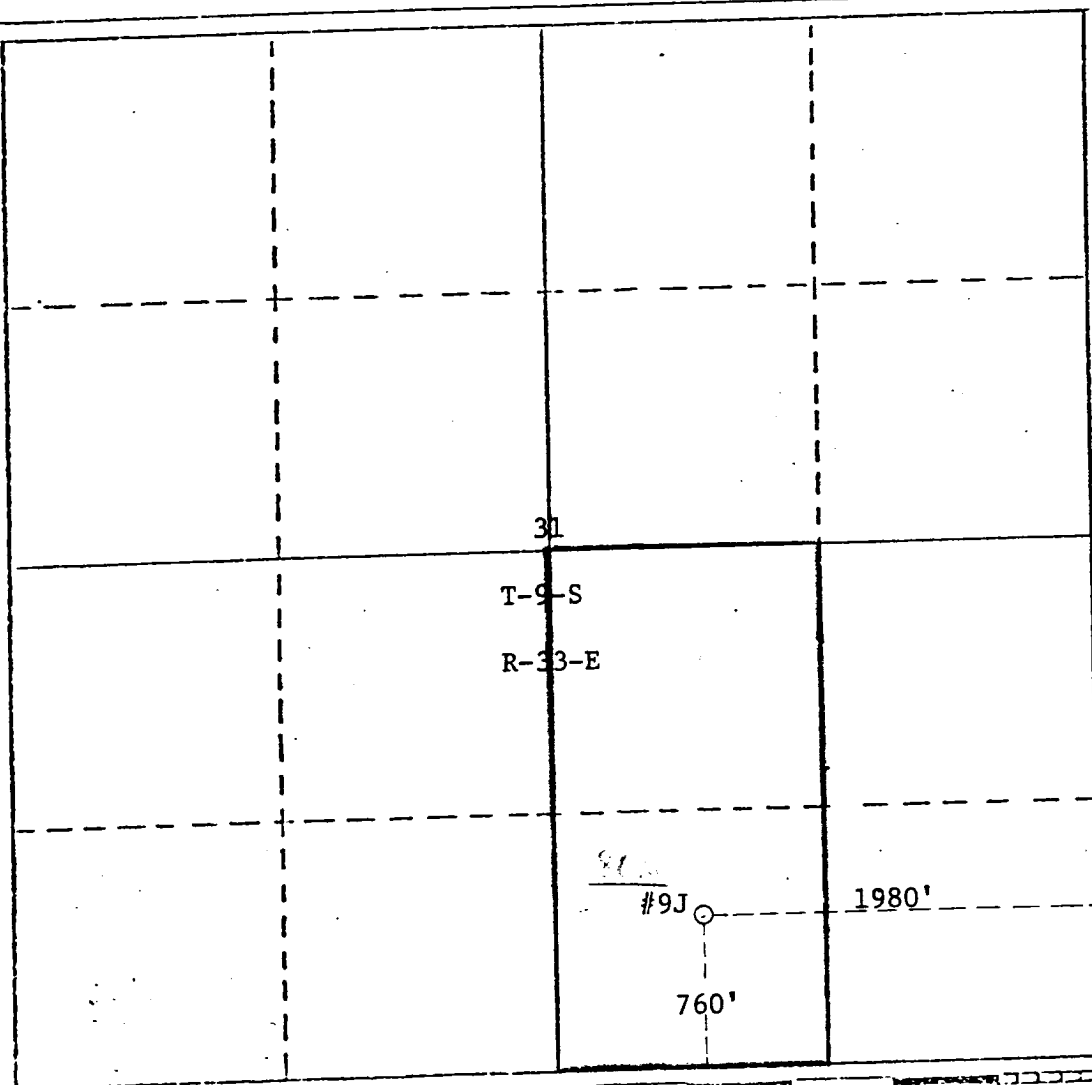

## CERTIFICATION

I hereby certify that the information contained herein is true and complete to the best of my knowledge and belief.

Name

Tom C. Young

Position

Drilling Manager

Company

Coastal Oil &amp; Gas Corp.

Date

September 20, 1982

I hereby certify that the well location shown on this plat was plotted from field notes of actual survey made by me or under my supervision, and that the same is true and correct to the best of my knowledge and belief.

September 18, 1982

Date Surveyed

Registered Professional Engineer  
and/or Land Surveyor

3959

Certificate No.