

STATE OF NEW MEXICO  
ENERGY AND MINERALS DEPARTMENT

OIL CONSERVATION DIVISION  
P.O. BOX 2088  
SANTA FE, NEW MEXICO 87501

30-025-28201

Form C-101  
Revised 1-1-65

NO. OF COPIES RECEIVED	
DISTRIBUTION	
SANTA FE	
LE	
S.G.S.	
ND OFFICE	
ERATOR	

5A. Indicate Type of Lease  
STATE ☒ FEE ☐

5. State Oil & Gas Lease No.  
LH-1376

XXXXXXXXXXXXXXXXXXXXXXXXXXXXXXXXXXXX  
XXXXXXXXXXXXXXXXXXXXXXXXXXXXXXXXXXXX

APPLICATION FOR PERMIT TO DRILL, DEEPEN, OR PLUG BACK

TYPE OF WORK  
DRILL ☒ DEEPEN ☐ PLUG BACK ☐  
TYPE OF WELL  
OIL WELL ☒ GAS WELL ☐ OTHER ☐ SINGLE ZONE ☐ MULTIPLE ZONE ☐

7. Unit Agreement Name

8. Farm or Lease Name  
North Mescalero

Name of Operator  
Lead & Stevens, Inc.

9. Well No.  
1

Address of Operator  
P.O. Box 1518, Roswell, NM 88201

10. Field and Pool, or Wildcat  
Wildcat Siluro Devonian

Location of Well  
UNIT LETTER L LOCATED 1980 FEET FROM THE South LINE  
660 FEET FROM THE West LINE OF SEC. 2 TWP. 10S RGE. 32E NMPM

XXXXXXXXXXXXXXXXXXXXXXXXXXXXXXXXXXXX  
XXXXXXXXXXXXXXXXXXXXXXXXXXXXXXXXXXXX  
XXXXXXXXXXXXXXXXXXXXXXXXXXXXXXXXXXXX

XXXXXXXXXXXXXXXXXXXXXXXXXXXXXXXXXXXX  
XXXXXXXXXXXXXXXXXXXXXXXXXXXXXXXXXXXX  
XXXXXXXXXXXXXXXXXXXXXXXXXXXXXXXXXXXX

12. County  
Lea

XXXXXXXXXXXXXXXXXXXXXXXXXXXXXXXXXXXX  
XXXXXXXXXXXXXXXXXXXXXXXXXXXXXXXXXXXX  
XXXXXXXXXXXXXXXXXXXXXXXXXXXXXXXXXXXX

XXXXXXXXXXXXXXXXXXXXXXXXXXXX  
XXXXXXXXXXXXXXXXXXXXXXXXXXXX

19. Proposed Depth  
11,500'

19A. Formation  
Siluro Devonian

20. Rotary or C.T.  
Rotary

Elevations (Show whether DF, RT, etc.)  
4279.1' GR

22. Approx. Date Work will start  
April 28, 1983

21A. Kind & Status Plug Bond  
Statewide

21B. Drilling Contractor  
Sierra Drilg. Co. Rig #2

PROPOSED CASING AND CEMENT PROGRAM

SIZE OF HOLE	SIZE OF CASING	WEIGHT PER FOOT	SETTING DEPTH	SACKS OF CEMENT	EST. TOP
17"	13 3/8"	54.5#	380'	400sx	Circ.
12 1/4" & 11"	8 5/8"	24# & 32#	3500'	1500sx	Circ.
7 7/8"	5 1/2"	17#	11,500'	1000sx	3000'

We propose to drill and test the Siluro Devonian formation. If commercial, 5 1/2" production casing will be run and cemented.

Mud Program: Spud mud to 380', brine & LOM 380' to 3500', drispak, gel, floccula & KCL 3500' to 11,500'.

BOP Program: 5000psi Shaffer Type "LWS", double hydraulic, 90-11S Meico closing unit w/90 gal capacity.

APPROVAL VALID FOR 180 DAYS  
PERMIT EXPIRES 10/21/83  
UNLESS DRILLING UNDERWAY.

ABOVE SPACE DESCRIBE PROPOSED PROGRAM: IF PROPOSAL IS TO DEEPEN OR PLUG BACK, GIVE DATA ON PRESENT PRODUCTIVE ZONE AND PROPOSED NEW PRODUCTIVE ZONE. GIVE BLOWOUT PREVENTER PROGRAM, IF ANY.

I hereby certify that the information above is true and complete to the best of my knowledge and belief.

SIGNED B. Stobbs TITLE Drilling & Production Manager DATE April 19, 1983

(This space for State Use)  
ORIGINAL SIGNED BY JERRY SEXTON  
DISTRICT I SUPERVISOR

APPROVED BY \_\_\_\_\_ TITLE \_\_\_\_\_ DATE APR 21 1983

CONDITIONS OF APPROVAL, IF ANY:

RECEIVED  
APR 20 1983  
C. B.  
HOLDS OFFICE

**NEW MEXICO OIL CONSERVATION COMMISSION  
WELL LOCATION AND ACREAGE DEDICATION PLAT**

Form C-102  
Supersedes C-128  
Effective 1-1-65

All distances must be from the outer boundaries of the Section.

Operator <b>READ &amp; STEVENS</b>			Lease <b>NORTH MESCALERO</b>		Well No. <b>1</b>
Unit Letter <b>L</b>	Section <b>2</b>	Township <b>10 South</b>	Range <b>32 East</b>	County <b>Lea</b>	
Actual Footage Location of Well: <b>1980</b> feet from the <b>South</b> line and <b>660</b> feet from the <b>West</b> line					
Ground Level Elev. <b>4279.1</b>	Producing Formation <b>Siluro Devonian</b>		Pool <b>Wildcat Siluro Devonian</b>		Dedicated Acreage: <b>80 40</b> Acres

1. Outline the acreage dedicated to the subject well by colored pencil or hachure marks on the plat below.
2. If more than one lease is dedicated to the well, outline each and identify the ownership thereof (both as to working interest and royalty).
3. If more than one lease of different ownership is dedicated to the well, have the interests of all owners been consolidated by communitization, unitization, force-pooling, etc?

☐ Yes    ☐ No    If answer is "yes," type of consolidation \_\_\_\_\_

If answer is "no," list the owners and tract descriptions which have actually been consolidated. (Use reverse side of this form if necessary.) \_\_\_\_\_

No allowable will be assigned to the well until all interests have been consolidated (by communitization, unitization, forced-pooling, or otherwise) or until a non-standard unit, eliminating such interests, has been approved by the Commission.

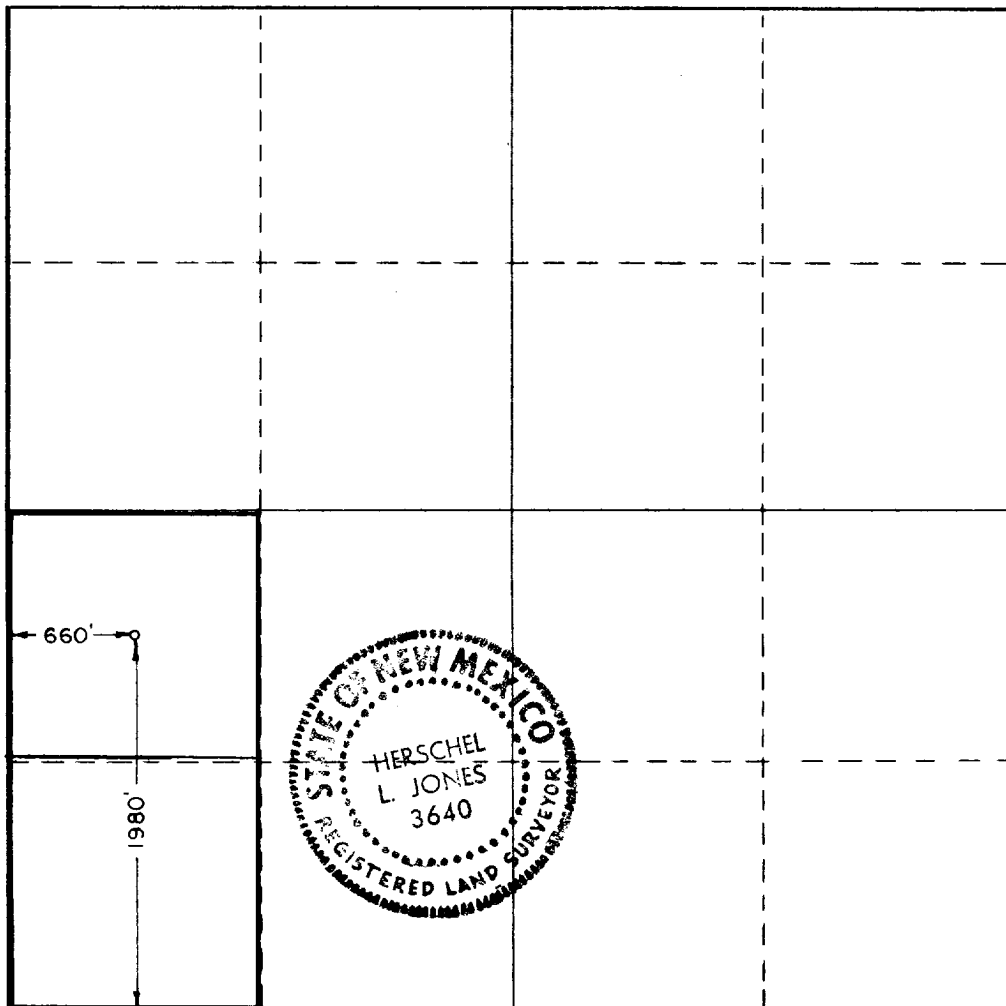

**CERTIFICATION**

*I hereby certify that the information contained herein is true and complete to the best of my knowledge and belief.*

*Susie Russell*

Name  
**Susie Russell**  
Position  
**Authorized Agent**  
Company  
**Read & Stevens, Inc.**

Date  
**April 18, 1983**

*I hereby certify that the well location shown on this plat was plotted from field notes of actual surveys made by me or under my supervision, and that the same is true and correct to the best of my knowledge and belief.*

Date Surveyed  
**4/14/83**

Registered Professional Engineer  
and/or Land Surveyor

*Herschel L. Jones*

Certificate No.  
**3640**

RECEIVED  
APR 20 1983  
O.C.D.  
HONORS OFFICE

11