

R. 31 E.

R. 32 E.

R. 33 E.

SPENCE ENERGY COMPANY

No.1 Cooper
Unit A, Sec.23-9S-32E
Lea County, N.M.

T. 8 S.

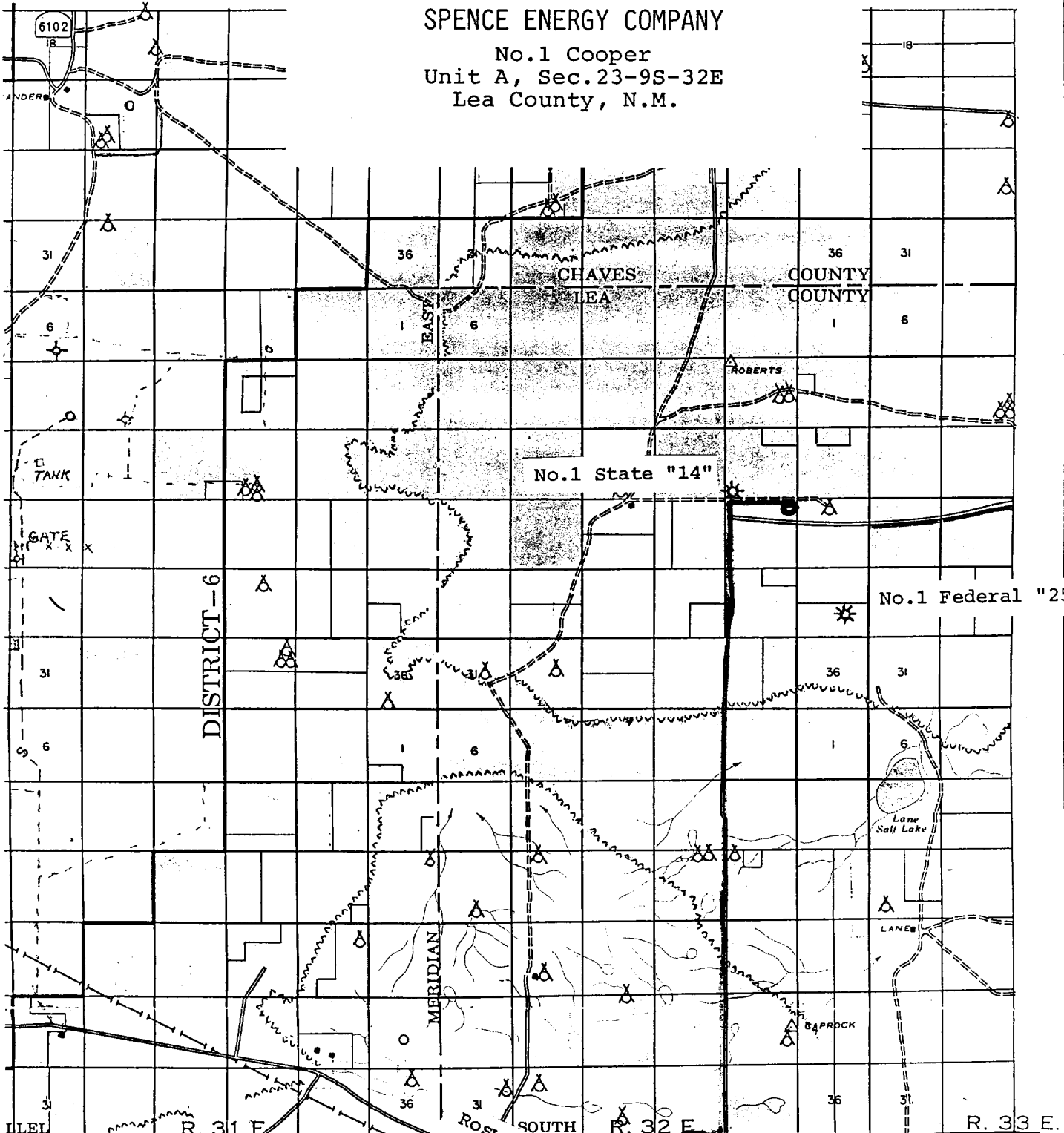

T. 9 S.

T. 10 S.

SE-15

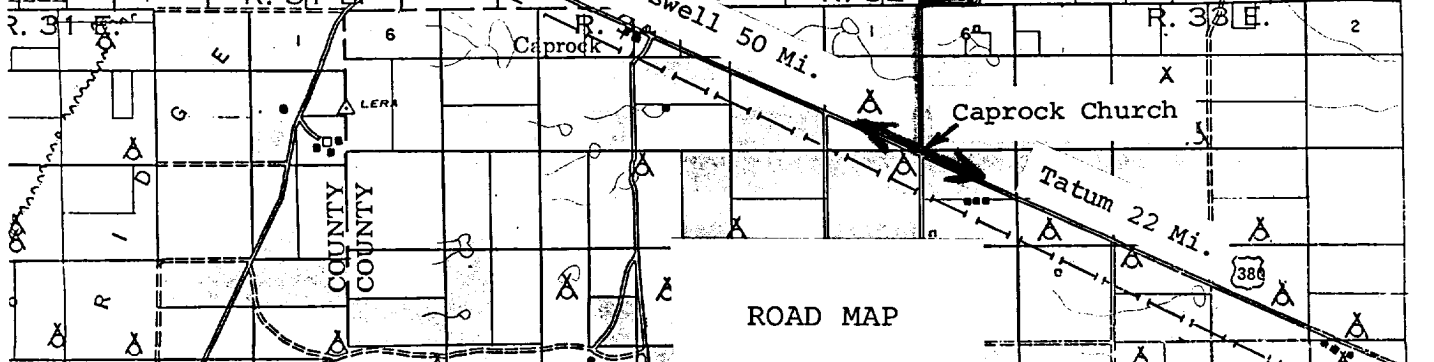

T. 11 S.

ROAD MAP

58/119
A

RECEIVED

OCT 15 1985

G.C.B.
HCBBS OFFICE