

UNITED STATES
DEPARTMENT OF THE INTERIOR
BUREAU OF LAND MANAGEMENT

SUBMIT IN TWO COPIES
(Other instructions on reverse side)

30-025-30464
Form approved.
Budget Bureau No. 1004-0136
Expires August 31, 1985

APPLICATION FOR PERMIT TO DRILL, DEEPEN, OR PLUG BACK

1a. TYPE OF WORK

DRILL ☒

DEEPEN ☐

PLUG BACK ☐

b. TYPE OF WELL

OIL WELL ☒

GAS WELL ☐

OTHER

SINGLE ZONE ☐

MULTIPLE ZONE ☐

2. NAME OF OPERATOR

LAYTON ENTERPRISES, INC.

3. ADDRESS OF OPERATOR

3103 79th St. Lubbock, Texas 79423

4. LOCATION OF WELL (Report location clearly and in accordance with any State requirements.)*

At surface 660' FNL 1430' FWL

At proposed prod. zone Sec 11, T9S, R36 E

Same

14. DISTANCE IN MILES AND DIRECTION FROM NEAREST TOWN OR POST OFFICE*

8 miles E-SE from Milnesand, N.M.

15. DISTANCE FROM PROPOSED*

LOCATION TO NEAREST PROPERTY OR LEASE LINE, FT. 660
(Also to nearest drlg. unit line, if any)

16. NO. OF ACRES IN LEASE

320

17. NO. OF ACRES ASSIGNED TO THIS WELL

80

18. DISTANCE FROM PROPOSED LOCATION*

TO NEAREST WELL, DRILLING, COMPLETED, OR APPLIED FOR, ON THIS LEASE, FT. 3200

19. PROPOSED DEPTH

9800

20. ROTARY OR CABLE TOOLS

Rotary

21. ELEVATIONS (Show whether DF, RT, GR, etc.)

4052 GL

22. APPROX. DATE WORK WILL START*

9-10-88

23.

PROPOSED CASING AND CEMENTING PROGRAM

SIZE OF HOLE	SIZE OF CASING	WEIGHT PER FOOT	SETTING DEPTH	QUANTITY OF CEMENT
17 1/2	13 3/8	54.5	350	350 sx. (Circulated)
12 1/2	8 5/8	32	4150	1400 sx. (Circulated)
7 7/8	5 1/2	20-17	9800	1500 sx.

Propose to drill to approx. 9800' to test Bough C & Intermediate Formation.
See supplemental drilling data for casing & BOP details.
Run 5 1/2" production casing, Perforate favorable zones,
Run tubing and stimulate as necessary.

IN ABOVE SPACE DESCRIBE PROPOSED PROGRAM: If proposal is to deepen or plug back, give data on present productive zone and proposed new productive zone. If proposal is to drill or deepen directionally, give pertinent data on subsurface locations and measured and true vertical depths. Give blowout preventer program, if any.

24.

SIGNED

Donald L. Layton

TITLE

President

DATE

8-8-88

(This space for Federal or State office use)

PERMIT NO.

APPROVAL DATE

APPROVED BY

Orig. Signed by Richard L. Layton

TITLE

DATE

9-9-88

CONDITIONS OF APPROVAL, IF ANY:

*See Instructions On Reverse Side

Title 18 U.S.C. Section 1001, makes it a crime for any person knowingly and willfully to make to any department or agency of the United States any false, fictitious or fraudulent statements or representations as to any matter within its jurisdiction.

RECEIVED
AUG 9 10 01 AM '88
CARTER
ADMIN.

NEW MEXICO OIL CONSERVATION COMMISSION
WE' LOCATION AND ACREAGE DEDICATIO 'LAT

Form C-128
 Supersedes C-128
 Effective 1-1-85

All distances must be from the outer boundaries of the Section.

Operator Layton Enterprises			Lease EL Zorro Federal "C"		Well No. 3 1X
Unit Letter C	Section 11	Township 9S	Range 36E	County Lea	
Actual Footage Location of Well: 660 feet from the North line and 1430 feet from the West line					
Ground Level Elev. 4052	Producing Formation Penn		Pool Allison		Dedicated Acreage: 80 Acres

1. Outline the acreage dedicated to the subject well by colored pencil or hatchure marks on the plat below.
2. If more than one lease is dedicated to the well, outline each and identify the ownership thereof (both as to working interest and royalty).
3. If more than one lease of different ownership is dedicated to the well, have the interests of all owners been consolidated by communitization, unitization, force-pooling, etc?

☐ Yes ☐ No If answer is "yes," type of consolidation _____

If answer is "no," list the owners and tract descriptions which have actually been consolidated. (Use reverse side of this form if necessary.) _____

No allowable will be assigned to the well until all interests have been consolidated (by communitization, unitization, forced-pooling, or otherwise) or until a non-standard unit, eliminating such interests, has been approved by the Commission.

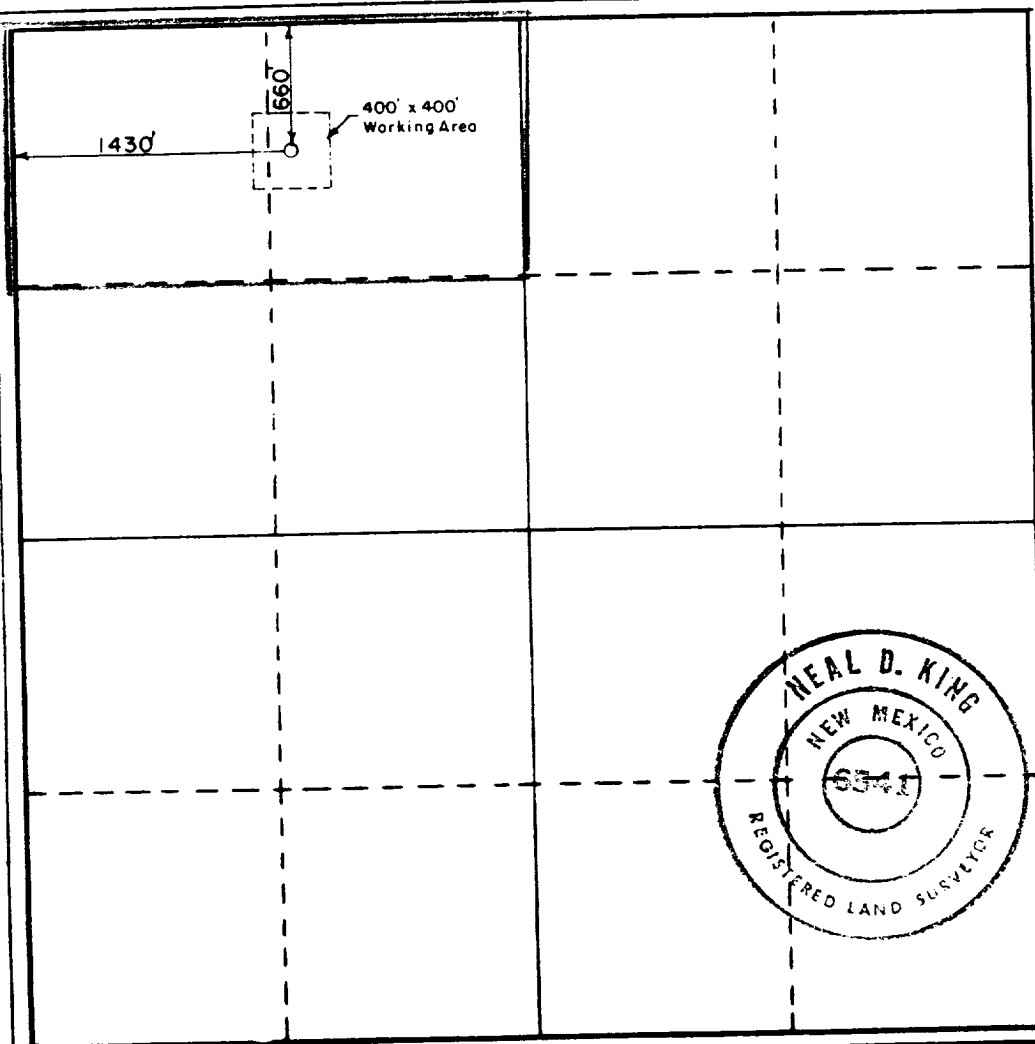

CERTIFICATION

I hereby certify that the information contained herein is true and complete to the best of my knowledge and belief.

Donald R. Layton
 Name

Donald R. Layton

Position
President

Company
LAYTON ENTERPRISES, INC.

Date
8-8-88

I hereby certify that the well location shown on this plat was plotted from field notes of actual surveys made by me or under my supervision, and that the same is true and correct to the best of my knowledge and belief.

Date Surveyed
8-5-88

Registered Professional Engineer and/or Land Surveyor

Neal D. King
 Certificate No.
6541

0 320 640 960 1280 1600 1920 2240 2560 2880 3200 3520 3840 4160 4480 4800 5120 5440 5760 6080 6400

LAYTON ENTERPRISES, INC.
No. 1-X El Zorro "C" Federal
NE¼ NW¼ Sec 11, T9S, R36E
Lea County, N. M.

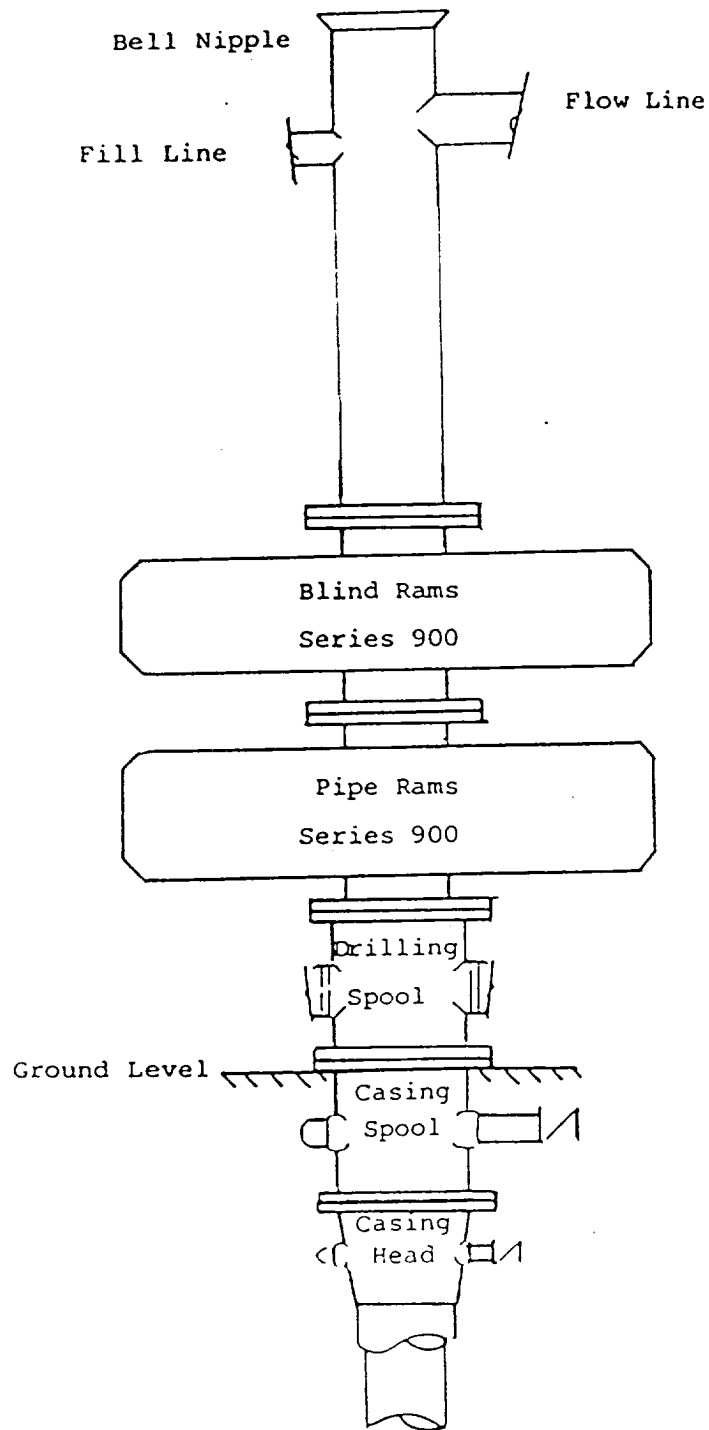

BLOWOUT PREVENTER STACK

3000# WP

EXHIBIT D

88-41-11 8224
173

RECEIVED
SEP 12 1988
OCC
NOBBS OFFICE