

Submit to Appropriate  
District Office  
State Lease - 6 copies  
Fee Lease - 5 copies

State of New Mexico  
Energy, Minerals and Natural Resources Department

Form C-101  
Revised 1-1-89

OIL CONSERVATION DIVISION

DISTRICT I  
P.O. Box 1980, Hobbs, NM 88240

DISTRICT II  
P.O. Drawer DD, Artesia, NM 88210

DISTRICT III  
1000 Rio Brazos Rd., Aztec, NM 87410

P.O. Box 2088  
Santa Fe, New Mexico 87504-2088

API NO. (assigned by OCD on New Wells)	30-025-30700
5. Indicate Type of Lease	STATE <input checked="" type="checkbox"/> FEE <input type="checkbox"/>
6. State Oil & Gas Lease No.	V-1259

APPLICATION FOR PERMIT TO DRILL, DEEPEN, OR PLUG BACK

1a. Type of Work:	DRILL <input type="checkbox"/> RE-ENTER <input type="checkbox"/> DEEPEN <input type="checkbox"/> PLUG BACK <input type="checkbox"/>	7. Lease Name or Unit Agreement Name
b. Type of Well:	OIL WELL <input type="checkbox"/> GAS WELL <input type="checkbox"/> OTHER RECOMPLETE <input type="checkbox"/> SINGLE ZONE <input checked="" type="checkbox"/> MULTIPLE ZONE <input type="checkbox"/>	Woodstock State Unit
2. Name of Operator	YATES PETROLEUM CORPORATION (505) 748-1471	8. Well No.
3. Address of Operator	105 South 4th St., Artesia, NM 88210	1. Undesignated
9. Pool name or Wildcat		Undesignated

4. Well Location	Unit Letter P : 660 Feet From The South Line and 540 Feet From The East Line
Section 5	Township 9S Range 33E NMPM Lea County

10. Proposed Depth	9875'	11. Formation	Abo/Three Brothers	12. Rotary or C.T.	Reverse Unit
13. Elevations (Show whether DF, RT, GR, etc.)	4387.5' GR	14. Kind & Status Plug. Bond	Blanket	15. Drilling Contractor	-
				16. Approx. Date Work will start	When approved

17. PROPOSED CASING AND CEMENT PROGRAM					
SIZE OF HOLE	SIZE OF CASING	WEIGHT PER FOOT	SETTING DEPTH	SACKS OF CEMENT	EST. TOP
12 1/2"	8-5/8"	24#	1873'	950 (in place)	
7-7/8"	5 1/2"	20 & 17#	9875'	725 (in place)	

Present production is from perfs 9260-9371' Bough A, B & C and is not sufficient to justify a commercial determination. Propose to to recomplate as follows:

- 1) Rig down pumping equipment. Retrieve RBP and set at 9200'±. POH with tubing.
- 2) Perforate Abo 8604-16' w/22 holes.
- 3) Perforate Three Brothers at 9105-19' w/22 holes.
- 4) Treat 9105-9119' w/3000 gals 15% NEFE acid and 25 balls.
- 5) Swab test for one or two days to evaluate zone.
- 6) Move RBP to 8700'±. Spot acid across perfs 8604-8616'. Pull packer to 8550'±. Acidize w/3000 gals 15% NEFE acid and 30 balls.
- 7) Swab test zone.

IN ABOVE SPACE DESCRIBE PROPOSED PROGRAM: IF PROPOSAL IS TO DEEPEN OR PLUG BACK, GIVE DATA ON PRESENT PRODUCTIVE ZONE AND PROPOSED NEW PRODUCTIVE ZONE. GIVE BLOWOUT PREVENTER PROGRAM, IF ANY.

I hereby certify that the information above is true and complete to the best of my knowledge and belief.

SIGNATURE Juanita Goodlett TITLE Production Supervisor DATE 7-9-90  
(505)  
TYPE OR PRINT NAME Juanita Goodlett TELEPHONE NO. 748-1471

(This space for State Use)

APPROVED BY \_\_\_\_\_ TITLE \_\_\_\_\_ DATE \_\_\_\_\_

CONDITIONS OF APPROVAL, IF ANY:

Submit to Appropriate  
District Office  
State Lease - 4 copies  
Fee Lease - 3 copies

State of New Mexico  
Energy, Minerals and Natural Resources Department

Form C-102  
Revised 1-1-89

OIL CONSERVATION DIVISION

P.O. Box 2088  
Santa Fe, New Mexico 87504-2088

DISTRICT I  
P.O. Box 1980, Hobbs, NM 88240

DISTRICT II  
P.O. Drawer DD, Artesia, NM 88210

DISTRICT III  
1000 Rio Brazos Rd., Aztec, NM 87410

WELL LOCATION AND ACREAGE DEDICATION PLAT

All Distances must be from the outer boundaries of the section

Operator YATES PETROLEUM CORPORATION			Lease Woodstock State Unit		Well No. 1
Unit Letter P	Section 5	Township 9S	Range 33E	County NMPM	Lea
Actual Footage Location of Well: 660 feet from the south line and 540 feet from the east line					
Ground level Elev. 4387.5'	Producing Formation Abo/Three Brothers		Pool Undesignated		Dedicated Acreage: 40 Acres

1. Outline the acreage dedicated to the subject well by colored pencil or hatchure marks on the plat below.
2. If more than one lease is dedicated to the well, outline each and identify the ownership thereof (both as to working interest and royalty).
3. If more than one lease of different ownership is dedicated to the well, have the interest of all owners been consolidated by communitization, unitization, force-pooling, etc.?  
☒ Yes ☐ No If answer is "yes" type of consolidation Unitization  
If answer is "no" list the owners and tract descriptions which have actually been consolidated. (Use reverse side of this form if necessary.)  
No allowable will be assigned to the well until all interests have been consolidated (by communitization, unitization, forced-pooling, or otherwise) or until a non-standard unit, eliminating such interest, has been approved by the Division.

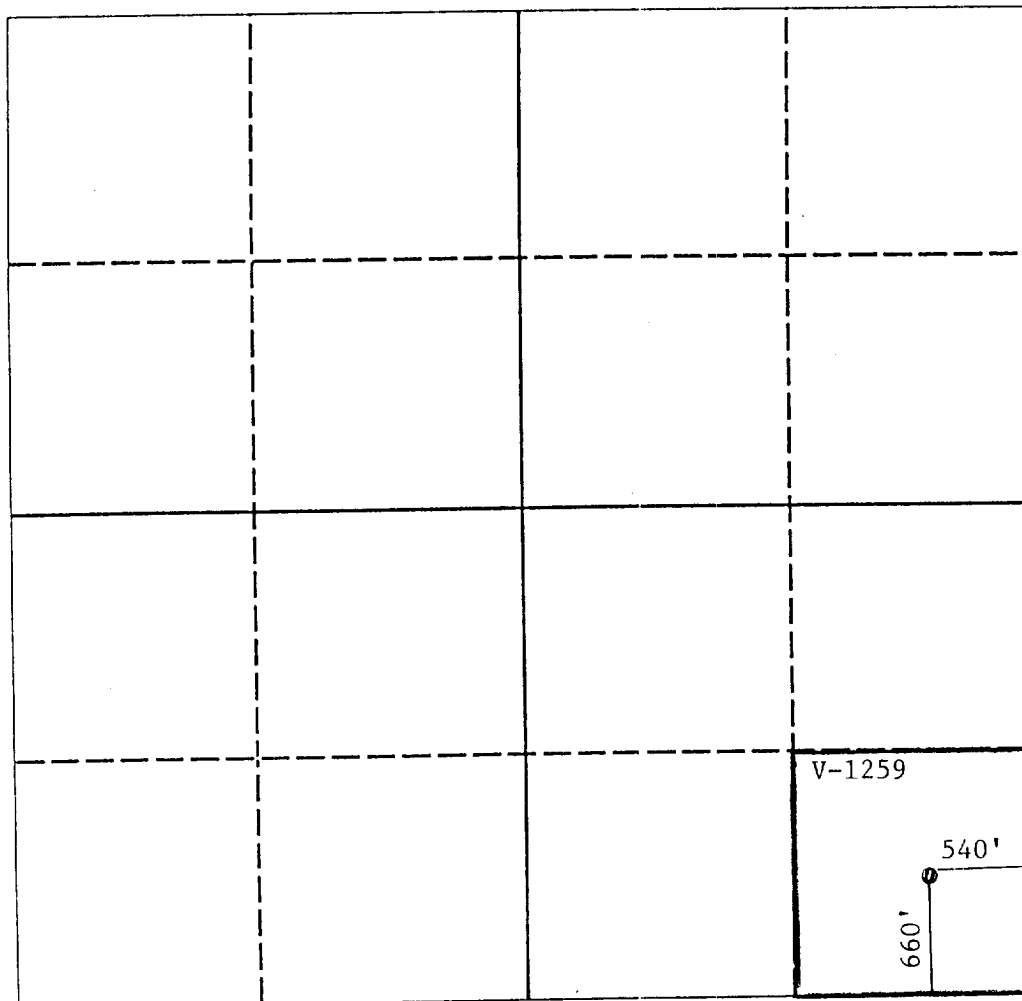

OPERATOR CERTIFICATION

I hereby certify that the information contained herein is true and complete to the best of my knowledge and belief.

Signature

Printed Name

JUANITA GOODLETT

Position

PRODUCTION SUPERVISOR

Company

YATES PETROLEUM CORPORATION

Date

7-9-90

SURVEYOR CERTIFICATION

I hereby certify that the well location shown on this plat was plotted from field notes of actual surveys made by me or under my supervision, and that the same is true and correct to the best of my knowledge and belief.

Date Surveyed

REFER TO ORIGINAL PLAT

Signature & Seal of

Professional Surveyor dated 10-11-89

Certificate No.