

Submit to Appropriate
District Office
State Lease - 4 copies
Fee Lease - 3 copies

State of New Mexico
Energy, Minerals and Natural Resources Department

Form C-102
Revised 1-1-89

OIL CONSERVATION DIVISION

DISTRICT I
P.O. Box 1980, Hobbs, NM 88240

P.O. Box 2088
Santa Fe, New Mexico 87504-2088

DISTRICT II
P.O. Drawer DD, Artesia, NM 88210

DISTRICT III
1000 Rio Brazos Rd., Aztec, NM 87410

WELL LOCATION AND ACREAGE DEDICATION PLAT

All Distances must be from the outer boundaries of the section

Operator NORTH CENTRAL OIL CORPORATION			Lease STATE 13		Well No. 1
Unit Letter F	Section 13	Township 11-SOUTH	Range 37-EAST	County NMPM	LEA
Actual Footage Location of Well: 1720 feet from the NORTH line and 1980 feet from the WEST line					
Ground level Elev. 3922'	Producing Formation Devonian (objective)		Pool wildcat	Dedicated Acreage: 400 40 Acres	

1. Outline the acreage dedicated to the subject well by colored pencil or hatchure marks on the plat below.
2. If more than one lease is dedicated to the well, outline each and identify the ownership thereof (both as to working interest and royalty).
3. If more than one lease of different ownership is dedicated to the well, have the interest of all owners been consolidated by communitization, unitization, force-pooling, etc.?
☐ Yes ☐ No If answer is "yes" type of consolidation _____
If answer is "no" list the owners and tract descriptions which have actually been consolidated. (Use reverse side of this form if necessary.) _____
No allowable will be assigned to the well until all interests have been consolidated (by communitization, unitization, forced-pooling, or otherwise) or until a non-standard unit, eliminating such interest, has been approved by the Division.

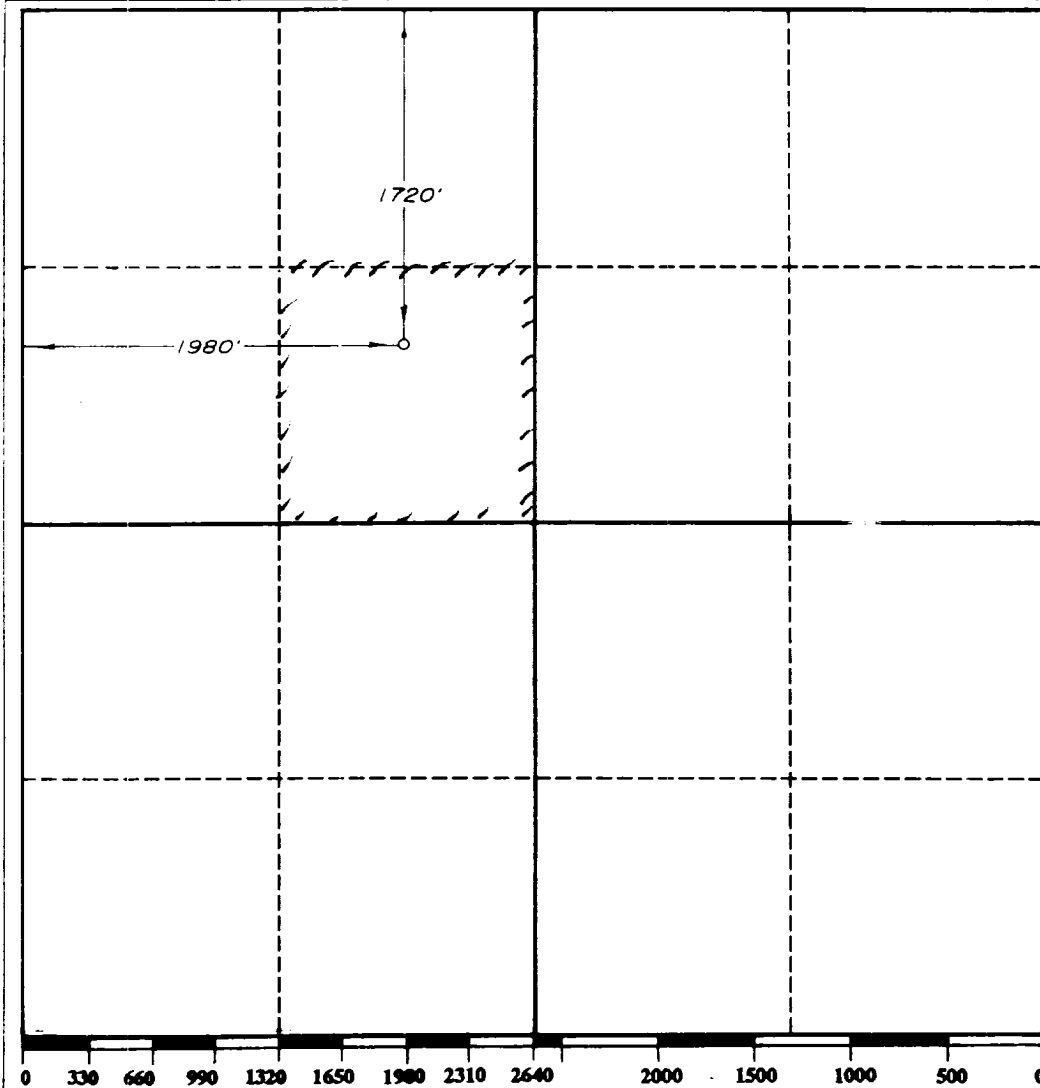

OPERATOR CERTIFICATION

I hereby certify that the information contained herein is true and complete to the best of my knowledge and belief.

Signature
Keith R. Alverson
Printed Name
Keith R. Alverson
Position
Chief of Drlg. Operations
Company
North Central Oil Corp.
Date
5/11/90

SURVEYOR CERTIFICATION

I hereby certify that the well location shown on this plat was plotted from field notes of actual surveys made by me or under my supervision, and that the same is true and correct to the best of my knowledge and belief.

Date Surveyed
MAY 11 1990
Signature & Seal of
Professional Surveyor
V. LYNN BEZNER
NO. 7920
Certificate No.
3091
REGISTERED LAND SURVEYOR
1980

25/13 8054
173

RECEIVED
MAY 14 1990
GCD
AND HIS OFFICE