

Submit to Appropriate
District Office
State Lease - 6 copies
Fee Lease - 5 copies

State of New Mexico
Energy, Minerals and Natural Resources Department

Form C-101
Revised 1-1-89

DISTRICT I
P.O. Box 1980, Hobbs, NM 88240

DISTRICT II
P.O. Drawer DD, Artesia, NM 88210

DISTRICT III
1000 Rio Brazos Rd., Aztec, NM 87410

OIL CONSERVATION DIVISION
P.O. Box 2088
Santa Fe, New Mexico 87504-2088

API NO. (assigned by OCD on New Wells)
30-025-31061
5. Indicate Type of Lease
STATE <input checked="" type="checkbox"/> FEE <input type="checkbox"/>
6. State Oil & Gas Lease No.
L-332

APPLICATION FOR PERMIT TO DRILL, DEEPEN, OR PLUG BACK					
1a. Type of Work:					
DRILL <input checked="" type="checkbox"/> RE-ENTER <input type="checkbox"/> DEEPEN <input type="checkbox"/> PLUG BACK <input type="checkbox"/>					
b. Type of Well:					
OIL WELL <input checked="" type="checkbox"/> GAS WELL <input type="checkbox"/> OTHER <input type="checkbox"/>					
SINGLE ZONE <input checked="" type="checkbox"/> MULTIPLE ZONE <input type="checkbox"/>					
2. Name of Operator			8. Well No.		
BTA Oil Producers			3		
3. Address of Operator			9. Pool name or Wildcat		
104 S. Pecos, Midland, TX 79701			Lane (San Andres)		
4. Well Location					
Unit Letter G : 1980 Feet From The North Line and 1980 Feet From The East Line					
Section 36 Township 9S Range 33E NMPM Lea County					
10. Proposed Depth		11. Formation		12. Rotary or C.T.	
5000		San Andres		Rotary	
13. Elevations (Show whether DF, RT, GR, etc.)		14. Kind & Status Plug. Bond		15. Drilling Contractor	
4278' GR		Blanket		Norton Drlg Co	
16. Approx. Date Work will start					
12-3-90					
17. PROPOSED CASING AND CEMENT PROGRAM					
SIZE OF HOLE	SIZE OF CASING	WEIGHT PER FOOT	SETTING DEPTH	SACKS OF CEMENT	EST. TOP
12-1/4	8-5/8	24	500	400 sx	Surface
7-7/8	5-1/2	15.5	5000	1000 sx	Surface

BOP Sketch attached - 3000 psi

There are no producing wells in this quarter-quarter section.

IN ABOVE SPACE DESCRIBE PROPOSED PROGRAM: IF PROPOSAL IS TO DEEPEN OR PLUG BACK, GIVE DATA ON PRESENT PRODUCTIVE ZONE AND PROPOSED NEW PRODUCTIVE ZONE. GIVE BLOWOUT PREVENTER PROGRAM, IF ANY.

I hereby certify that the information above is true and complete to the best of my knowledge and belief.

SIGNATURE Dorothy Houghton TITLE Regulatory Administrator DATE 11-9-90

TYPE OR PRINT NAME Dorothy Houghton TELEPHONE NO 915-682-3753

(This space for State Use)

ORIGINAL WORKED IN SECTION
DISTRICT I SUPERVISOR

NOV 18 1990

APPROVED BY _____ TITLE _____ DATE _____

CONDITIONS OF APPROVAL, IF ANY:

Permit Expires 6 Months From Approval
Date 11/18/90

Submit to Appropriate
District Office
State Lease - 4 copies
Fee Lease - 3 copies

State of New Mexico
Energy, Minerals and Natural Resources Department

Form C-102
Revised 1-1-89

OIL CONSERVATION DIVISION

DISTRICT I
P.O. Box 1980, Hobbs, NM 88240

P.O. Box 2088
Santa Fe, New Mexico 87504-2088

DISTRICT II
P.O. Drawer DD, Artesia, NM 88210

DISTRICT III
1000 Rio Brazos Rd., Aztec, NM 87410

WELL LOCATION AND ACREAGE DEDICATION PLAT

All Distances must be from the outer boundaries of the section

Operator BTA OIL PRODUCERS			Lease 6822 LTD SUNRAY "A"		Well No. 3
Unit Letter G	Section 36	Township 9-SOUTH	Range 33-EAST	County NMPM LEA	
Actual Footage Location of Well: 1980 feet from the NORTH line and 1980 feet from the EAST line					
Ground level Elev. 4278	Producing Formation San Andres		Pool Lane	Dedicated Acreage: 40 Acres	

1. Outline the acreage dedicated to the subject well by colored pencil or hatchure marks on the plat below
2. If more than one lease is dedicated to the well, outline each and identify the ownership thereof (both as to working interest and royalty).
3. If more than one lease of different ownership is dedicated to the well, have the interest of all owners been consolidated by communitization, unitization, force-pooling, etc.?
☐ Yes ☐ No If answer is "yes" type of consolidation _____
If answer is "no" list the owners and tract descriptions which have actually been consolidated. (Use reverse side of this form if necessary). _____
No allowable will be assigned to the well until all interests have been consolidated (by communitization, unitization, forced-pooling, or otherwise) or until a non-standard unit, eliminating such interest, has been approved by the Division.

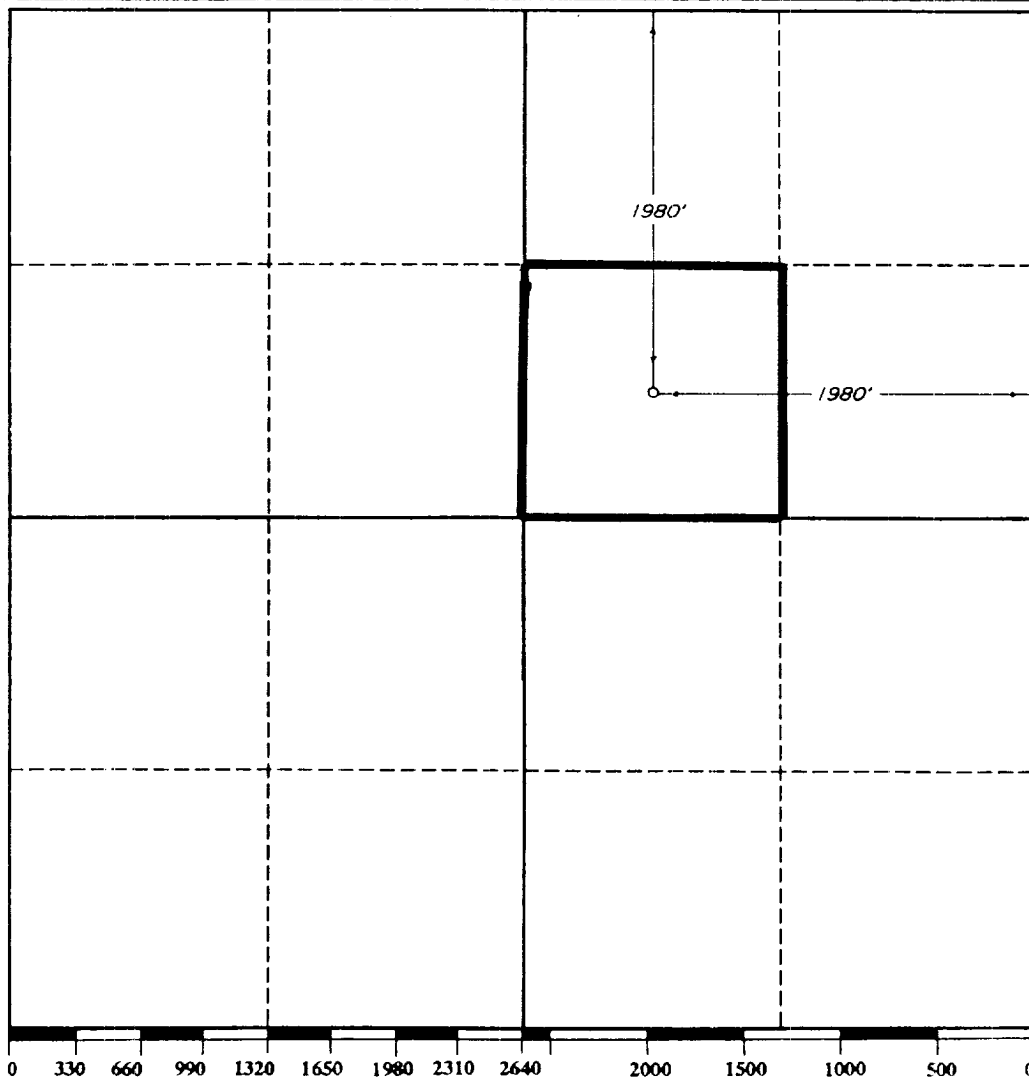

OPERATOR CERTIFICATION

I hereby certify that the information contained herein is true and complete to the best of my knowledge and belief

Signature
Dorothy Houghton
Printed Name
Dorothy Houghton
Position
Regulatory Administrator
Company
BTA Oil Producers
Date
11-9-90

SURVEYOR CERTIFICATION

I hereby certify that the well location shown on this plat was plotted from field notes of actual surveys made by me or under my supervision, and that the same is true and correct to the best of my knowledge and belief

Date Surveyed
NOVEMBER 9, 1990
Signature of Professional Surveyor
V. LYNN BEZNER
NO. 7920
Certificate No.
V. LYNN BEZNER, R.L.S. # 7920

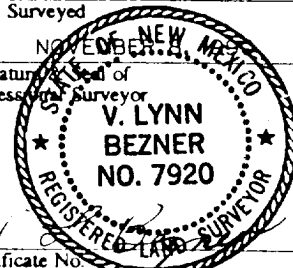

B T A O I L P R O D U C E R S

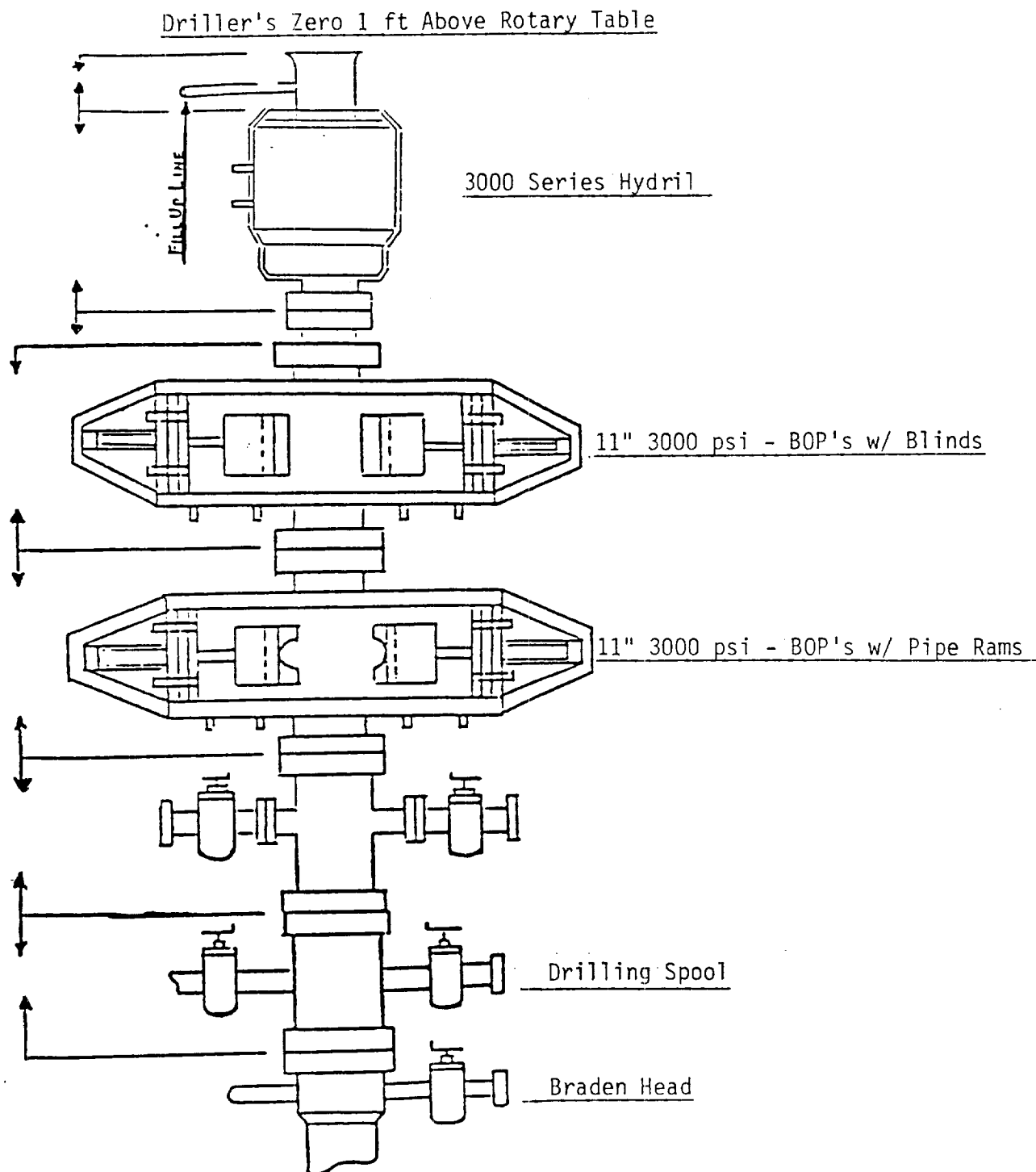

Sunray -A-, 6822 Ltd.
Well #3
Sec. 36, T9S, R33E
Lea Co., N. M.