

UNITED STATES
DEPARTMENT OF THE INTERIOR
BUREAU OF LAND MANAGEMENT

APPLICATION FOR PERMIT TO DRILL, DEEPEN, OR PLUG BACK

1a. TYPE OF WORK

DRILL ☒

DEEPEN ☐

PLUG BACK ☐

b. TYPE OF WELL

OIL WELL ☒

GAS WELL ☐

OTHER

SINGLE ZONE ☐

MULTIPLE ZONE ☐

2. NAME OF OPERATOR

Davcro, Inc.

3. ADDRESS OF OPERATOR

2124 Broadway

Lubbock, Texas 79701

4. LOCATION OF WELL (Report location clearly and in accordance with any State requirements.)

At surface

660' FNL & 660' FEL

At proposed prod. zone

Same

A

14. DISTANCE IN MILES AND DIRECTION FROM NEAREST TOWN OR POST OFFICE*

30 miles northeast of Tatum, NM

19. DISTANCE FROM PROPOSED*

LOCATION TO NEAREST
PROPERTY OR LEASE LINE, FT.
(Also to nearest drlg. unit line, if any)

660'

16. NO. OF ACRES IN LEASE

320

17. NO. OF ACRES ASSIGNED
TO THIS WELL

40

18. DISTANCE FROM PROPOSED LOCATION*

TO NEAREST WELL, DRILLING, COMPLETED,
OR APPLIED FOR, ON THIS LEASE, FT.

1867'

19. PROPOSED DEPTH

5025'

20. ROTARY OR CABLE TOOLS

Rotary

21. ELEVATIONS (Show whether DF, RT, GR, etc.)

3940' GL

22. APPROX. DATE WORK WILL START*

January 2, 1992

23.

PROPOSED CASING AND CEMENTING PROGRAM

SIZE OF HOLE	SIZE OF CASING	WEIGHT PER FOOT	SETTING DEPTH	QUANTITY OF CEMENT
12 1/4"	8 5/8"	24#	1350'	250 sx "C" circulated
7 7/8"	5 1/2"	15.5#	5025'	1200 sx "C" circulate

Mud Program:

0' - 400': Fresh water spud mud:
400' - 2000': Native mud:
2000' - 5025': Native mud:

Mud Wt.

8.5-9 ppg
8.5-9 ppg
10.5 ppg

Vis.

35-36
35-36
34-35

W/L Control

No W/L cont.
No W/L cont.
W/L cont. 15cc

BOP Program:

A 10" 3000 psi wp Shaffer Series 900 BOP will be installed on the 8 5/8" casing. Casing and BOP will be tested before drilling out with 7 7/8". BOP will be used as a 2000 psi wp system and will be tested daily. See exhibit "E".

IN ABOVE SPACE DESCRIBE PROPOSED PROGRAM: If proposal is to deepen or plug back, give data on present productive zone and proposed new productive zone. If proposal is to drill or deepen directionally, give pertinent data on subsurface locations and measured and true vertical depths. Give blowout preventer program, if any.

24.

SIGNED

[Signature]

Agent for:
TITLE Davcro, Inc.

Nov. 5, 1991
DATE

(This space for Federal or State office use)

PERMIT NO.

APPROVAL DATE

APPROVED BY

TITLE

DATE

12-2-91

CONDITIONS OF APPROVAL, IF ANY:

*See Instructions On Reverse Side

GULF CONSERVATION DIVISION

DISTRICT I
P.O. Box 1980, Hobbs, NM 88240

P.O. Box 2088

Santa Fe, New Mexico 87504-2088

DISTRICT II
P.O. Drawer DD, Artesia, NM 88210

DISTRICT III
1000 Rio Brazos Rd., Aztec, NM 87410

WELL LOCATION AND ACREAGE DEDICATION PLAT

All Distances must be from the outer boundaries of the section

Operator Davcro, Inc.			Lease Gulf Federal		Well No. 4
Unit Letter A	Section 29	Township 9 South	Range 38 East	County Lea	
Actual Footage Location of Well: 660 feet from the North line and 660 feet from the East line					
Ground level Elev. 3940	Producing Formation San Andres	Pool Sawyer Field		Dedicated Acreage: 40 Acres	

1. Outline the acreage dedicated to the subject well by colored pencil or hatchure marks on the plat below.

2. If more than one lease is dedicated to the well, outline each and identify the ownership thereof (both as to working interest and royalty).

3. If more than one lease of different ownership is dedicated to the well, have the interest of all owners been consolidated by communization, unitization, force-pooling, etc.?

☐ Yes ☐ No If answer is "yes" type of consolidation _____

If answer is "no" list the owners and tract descriptions which have actually been consolidated. (Use reverse side of this form if necessary.)

No allowable will be assigned to the well until all interests have been consolidated (by communization, unitization, forced-pooling, or otherwise) or until a non-standard unit, eliminating such interest, has been approved by the Division.

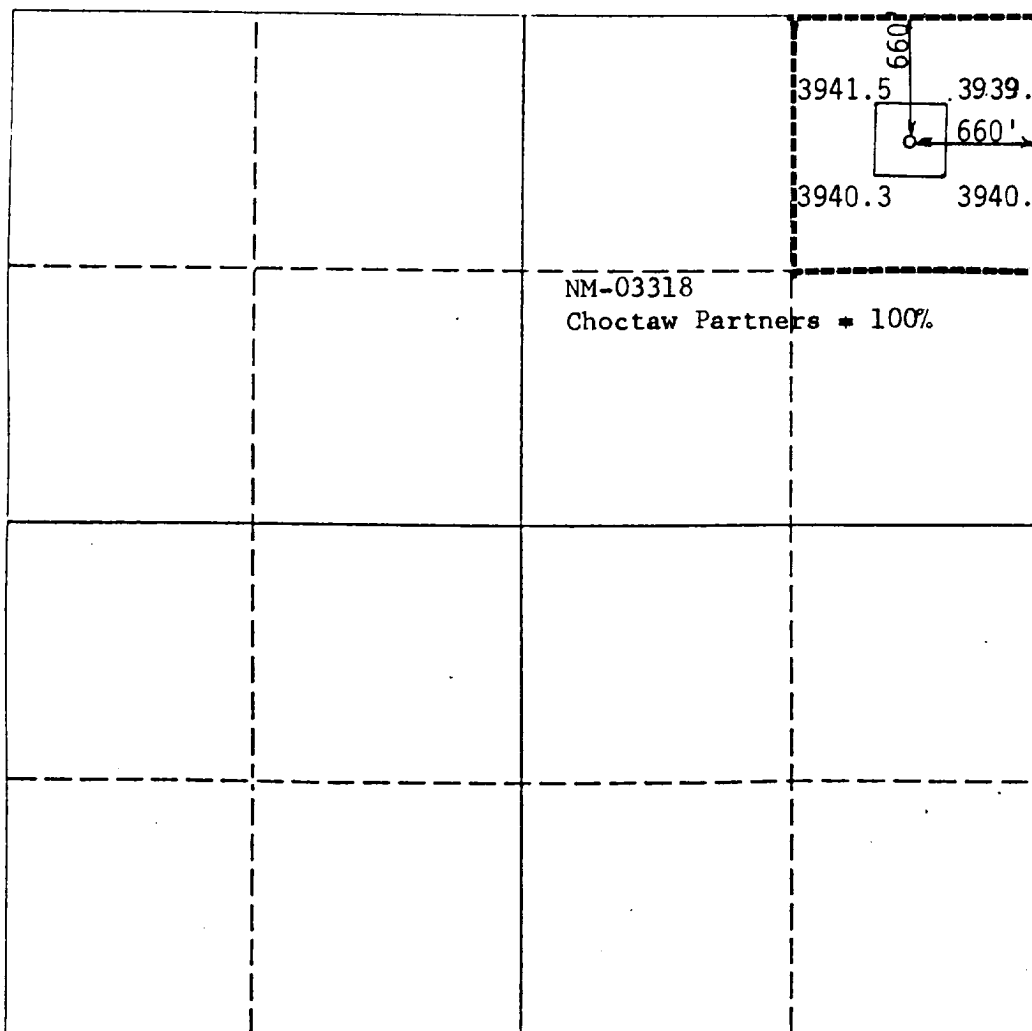

OPERATOR CERTIFICATION

I hereby certify that the information contained herein is true and complete to the best of my knowledge and belief.

Signature

Printed Name

George R. Smith

Position

Agent for:

Company

Davcro, Inc.

Date

November 5, 1991

SURVEYOR CERTIFICATION

I hereby certify that the well location shown on this plat was plotted from field notes of actual surveys made by me or under my supervision, and that the same is true and correct to the best of my knowledge and belief.

Date Surveyed

October 17, 1991

Signature & Seal of Professional Surveyor

Certificate No.
8112

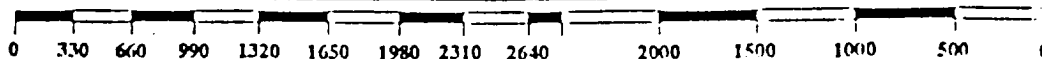
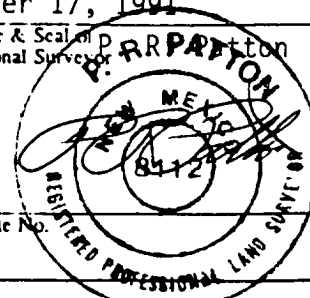

BLOWOUT PREVENTOR ARRANGEMENT

2M SYSTEM

10" SHAFFER TYPE "E", 3000 psi WP

80 GALLON, 4 STATION KOOMEY ACCUMULATOR

3000 psi WP CHOKE MANIFOLD

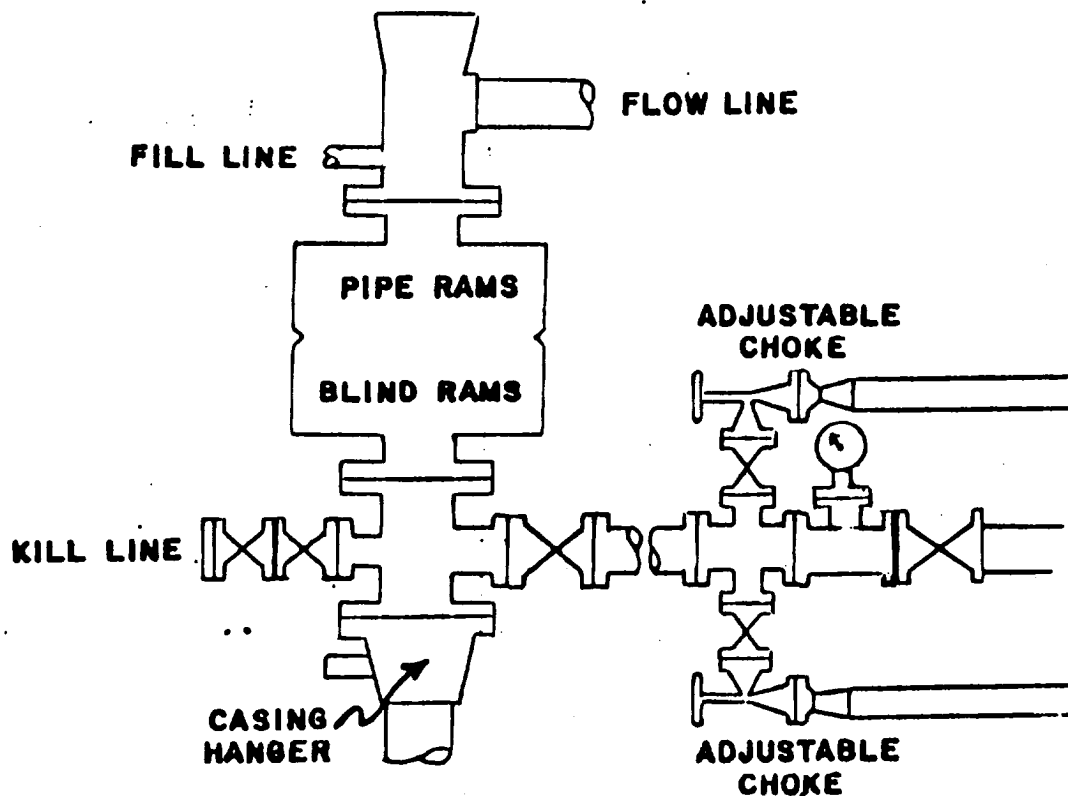

EXHIBIT "E"
DAVCRO, INC.
Gulf Federal, Well No. 4
BOP Specifications