

**OIL CONSERVATION DIVISION**

P.O. Box 2088

Santa Fe, New Mexico 87504-2088

**DISTRICT I**

P.O. Box 1990, Hobbs, NM 88240

**DISTRICT II**

P.O. Drawer 80, Artesia, NM 88210

**DISTRICT III**

1000 Rio Brazos Rd., Aztec, NM 87410

**WELL LOCATION AND ACREAGE DEDICATION PLAT**

All Distances must be from the outer boundaries of the section

Operator I.P. PETROLEUM CO. INC.			Lease STATE		Well No. 1
Unit Letter J	Section 16	Township 9 SOUTH	Range 37 EAST	NMPM	County LEA
Actual Footage Location of Well: 1650 feet from the SOUTH line and 2150 feet from the EAST line					
Ground Level Elev. 3991.8		Producing Formation		Pool	Dedicated Acreage: Acres

1. Outline the acreage dedicated to the subject well by colored pencil or hatchure marks on the plat below.
2. If more than one lease is dedicated to the well, outline each and identify the ownership thereof (both as to working interest and royalty).
3. If more than one lease of different ownership is dedicated to the well, have the interest of all owners been consolidated by communitization, unitization, force-pooling, etc.?

☐ Yes

☒ No

If answer is "yes" type of consolidation

If answer is "no" list of owners and tract descriptions which have actually been consolidated. (Use reverse side of this form necessary.)

No allowable will be assigned to the well unit all interests have been consolidated (by communitization, unitization, forced-pooling, otherwise) or until a non-standard unit, eliminating such interest, has been approved by the Division.

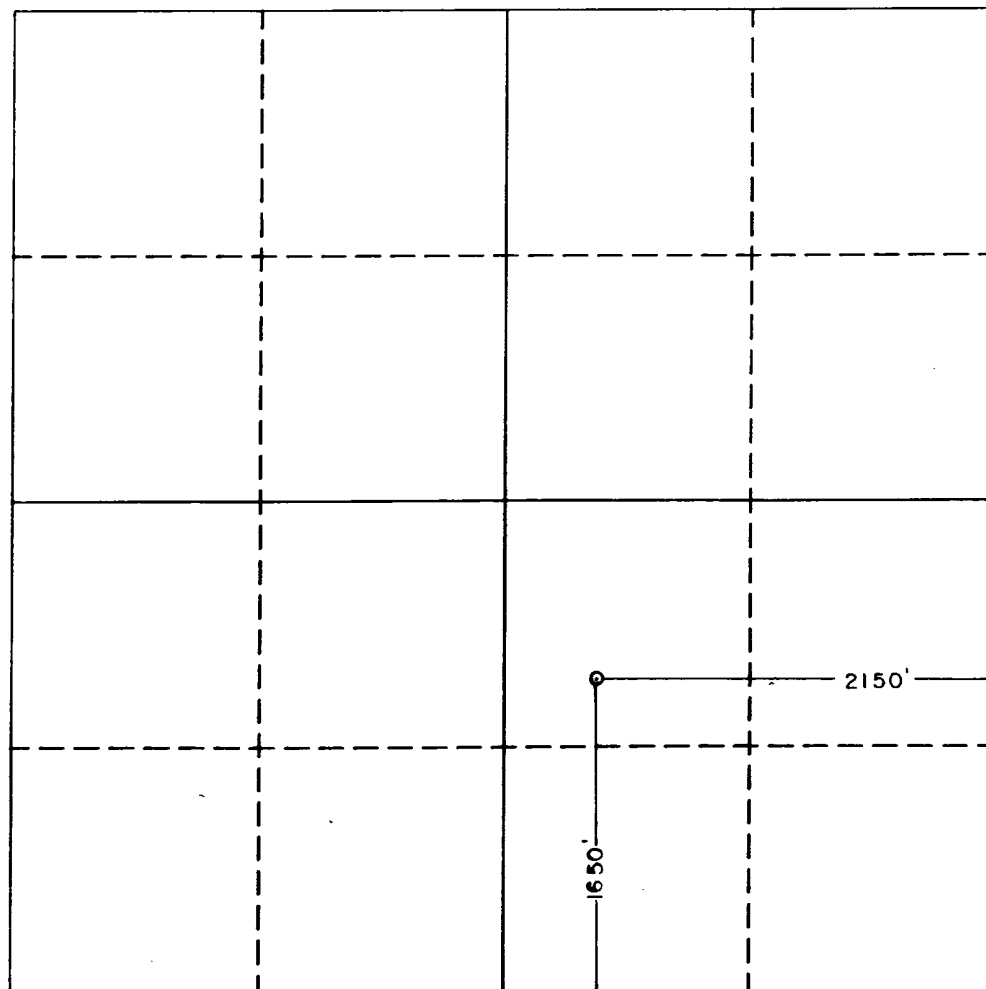

**OPERATOR CERTIFICATION**

I hereby certify the the information contained herein is true and complete to the best of my knowledge and belief.

Signature

*Shirley Ford*

Printed Name

Shirley Ford

Position

Production Tech

Company

IP Petroleum Company, INC

Date

January 24, 1992

**SURVEYOR CERTIFICATION**

I hereby certify that the well location shown on this plat was plotted from field notes of actual surveys made by me or under my supervision, and that the same is true and correct to the best of my knowledge and belief.

Date Surveyed

JAN. 17, 1992

Signature & Seal of  
Professional Surveyor

*GARY L. JONES*  
GARY L. JONES  
NEW MEXICO  
7977  
Certificate No. DONALD E. EDSON, 3839  
GARY L. JONES, 7977

W.O. 92-11-0055

20284-1792

ELF

JAN 27 1992

680  
21305 CNY

**Oxford<sup>®</sup>**

✱ ESSELTE

MADE IN U.S.A.

NO. R753 1/3

•

•

•

•

4/20/98 inject increase 1088 psig  
SWD - 691 2/9/98 San Andres 4223-7694  
PKR 4150' 845 psi