

Submit to Appropriate  
District Office  
State Lease - 6 copies  
Fee Lease - 5 copies

State of New Mexico  
Energy, Minerals and Natural Resources Department

Form C-101  
Revised 1-1-89

OIL CONSERVATION DIVISION

DISTRICT I  
P.O. Box 1980, Hobbs, NM 88240

P.O. Box 2088  
Santa Fe, New Mexico 87504-2088

DISTRICT II  
P.O. Drawer DD, Artesia, NM 88210

DISTRICT III  
1000 Rio Brazos Rd., Aztec, NM 87410

API NO. (assigned by OCD on New Wells) <b>30-005-32029</b>
5. Indicate Type of Lease STATE <input type="checkbox"/> FEE <input checked="" type="checkbox"/>
6. State Oil & Gas Lease No.

APPLICATION FOR PERMIT TO DRILL, DEEPEN, OR PLUG BACK					
1a. Type of Work: DRILL <input checked="" type="checkbox"/> RE-ENTER <input type="checkbox"/> DEEPEN <input type="checkbox"/> PLUG BACK <input type="checkbox"/> b. Type of Well: OIL WELL <input checked="" type="checkbox"/> GAS WELL <input type="checkbox"/> OTHER <input type="checkbox"/> SINGLE ZONE <input checked="" type="checkbox"/> MULTIPLE ZONE <input type="checkbox"/>				7. Lease Name or Unit Agreement Name  Cross	
2. Name of Operator Olsen Energy, Inc.				8. Well No. 1	
3. Address of Operator 16414 San Pedro, Suite 470, San Antonio, TX 78232				9. Pool name or Wildcat <del>West</del> Lane San Andres	
4. Well Location Unit Letter <u>0</u> : <u>500</u> Feet From The <u>South</u> Line and <u>1750</u> Feet From The <u>East</u> Line Section <u>35</u> Township <u>9-S</u> Range <u>33-E</u> NMPM <u>Lea</u> County					
10. Proposed Depth 4900		11. Formation San Andres		12. Rotary or C.T. Rotary	
13. Elevations (Show whether DF, RT, GR, etc.) 4275 Gr		14. Kind & Status Plug. Bond Single well applied for		15. Drilling Contractor Not Selected	
16. Approx. Date Work will start 7-25-93					
17. PROPOSED CASING AND CEMENT PROGRAM					
SIZE OF HOLE	SIZE OF CASING	WEIGHT PER FOOT	SETTING DEPTH	SACKS OF CEMENT	EST. TOP
12 1/4	8-5/8	24	500	300	Circ
7-7/8	4 1/2	9.5 & 10.5	4900	400	3000

1. Drill 12 1/4" hole to 500' with spud mud.
2. Run 8-5/8" casing. Cement w/300 sacks to circ. to surface.
3. Drill 7-7/8" hole to 4900' w/brine water, brine/salt ge/starch mud.
4. Run open hole logs at T.D.
5. If logs indicate production, run 4 1/2" 9.5# & 10.5# casing. Cement w/sufficient cement to bring TOC to 3000'.

Casing must be cemented to top of the salt or brine water. The casing by 100' must be cemented and 100' of the top of the salt.

IN ABOVE SPACE DESCRIBE PROPOSED PROGRAM: IF PROPOSAL IS TO DEEPEN OR PLUG BACK, GIVE DATA ON PRESENT PRODUCTIVE ZONE AND PROPOSED NEW PRODUCTIVE ZONE. GIVE BLOWOUT PREVENTER PROGRAM, IF ANY.

I hereby certify that the information above is true and complete to the best of my knowledge and belief.

SIGNATURE Dick Morton TITLE Drilling/Production Mgr. DATE 6-7-93

TYPE OR PRINT NAME Dick Morton TELEPHONE NO. 210-496-2466

ORIGINAL SIGNATURE OF DISTRICT I SUPERVISOR

APPROVED BY ORIGINAL SIGNED BY JERRY SEXTON TITLE JUL 08 1993

CONDITIONS OF APPROVAL, IF ANY: DISTRICT I SUPERVISOR

Permit Expires 6 Months From Approval  
Date Unless Drilling Underway.

JUN 15 1993  
LCD HOBBS OFFICE

NEW XICO OIL CONSERVATION COMMISSIO  
WELL LOCATION AND ACREAGE DEDICATION PLAT

Form C-102  
Supersedes C-128  
Effective 1-1-65

All distances must be from the outer boundaries of the Section.

Operator <b>Olsen Energy Inc.</b>			Lease <b>Cross</b>		Well No. <b>1</b>
Unit Letter <b>O</b>	Section <b>35</b>	Township <b>9-S</b>	Range <b>33-E</b>	County <b>Lea</b>	
Actual Footage Location of Well: <b>500</b> feet from the <b>South</b> line and <b>1750</b> feet from the <b>East</b> line					
Ground Level Elev. <b>4275</b>	Producing Formation <b>San Andres</b>		Pool <b>Lane San Andres</b>	Dedicated Acreage: <b>40</b> Acres	

1. Outline the acreage dedicated to the subject well by colored pencil or hachure marks on the plat below.
2. If more than one lease is dedicated to the well, outline each and identify the ownership thereof (both as to working interest and royalty).
3. If more than one lease of different ownership is dedicated to the well, have the interests of all owners been consolidated by communitization, unitization, force-pooling, etc?

☐ Yes ☐ No If answer is "yes," type of consolidation \_\_\_\_\_

If answer is "no," list the owners and tract descriptions which have actually been consolidated. (Use reverse side of this form if necessary.) \_\_\_\_\_

No allowable will be assigned to the well until all interests have been consolidated (by communitization, unitization, forced-pooling, or otherwise) or until a non-standard unit, eliminating such interests, has been approved by the Commission.

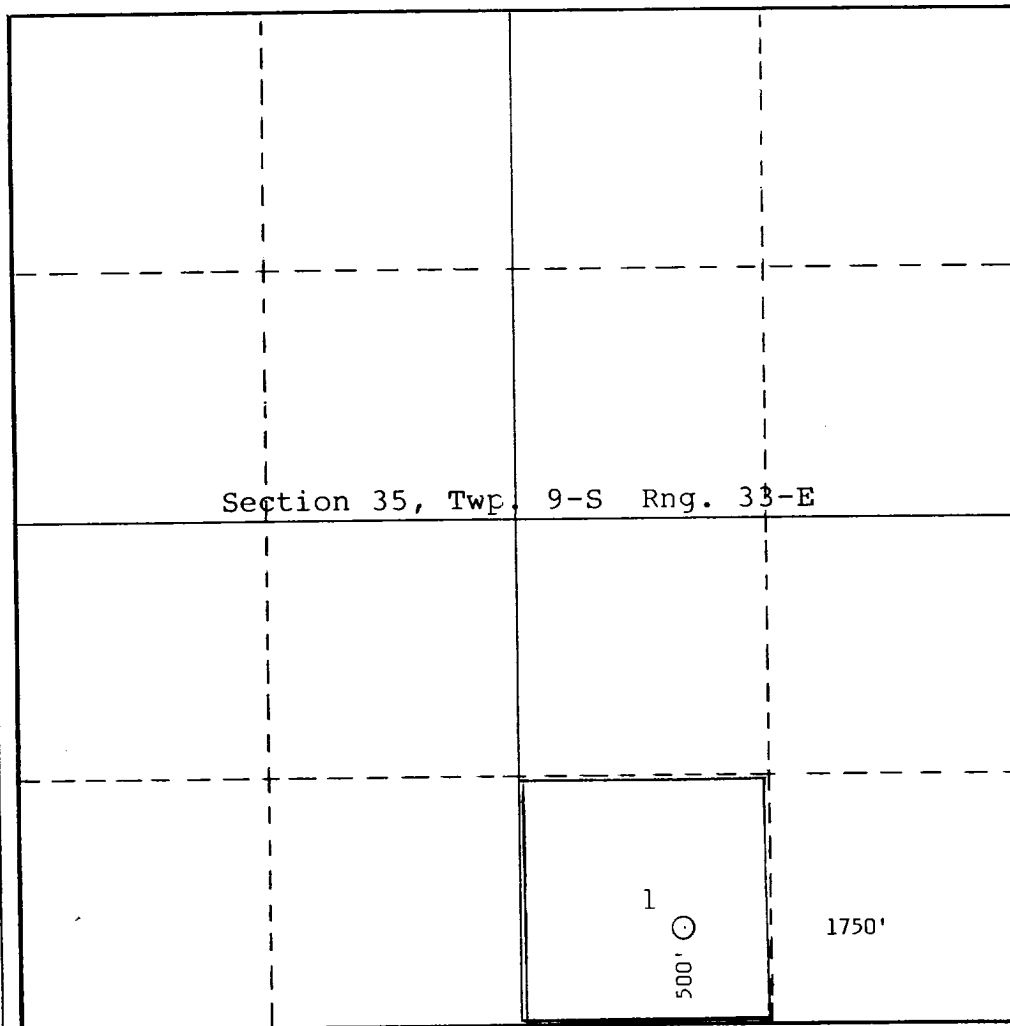

CERTIFICATION

I hereby certify that the information contained herein is true and complete to the best of my knowledge and belief.

*Rick Martin*  
Name

Drilling/Production Mgr.

Position

Olsen Energy, Inc.

Company

June 7, 1993

Date

I hereby certify that the well location shown on this plat was plotted from field notes of actual surveys made by me or under my supervision, and that the same is true and correct to the best of my knowledge and belief.

Date Surveyed

June 3, 1993

Registered Professional Engineer  
and/or Land Surveyor

*Joseph R. Luckin*  
Certificate No.

754

JUN 15 1993

**LCD HOBBS OFFICE**

- 1) 2" SERIES 900 VALVE
- 2) PRESSURE GAUGE ON 2"x2"x2" 900 SERIES TEE
- 3) 2" SERIES 900 X 2" SERIES 900 CROSS
- 4) 2" SERIES 900 POSITIVE CHOKE
- 5) 2" SERIES 900 ADJUSTABLE CHOKE

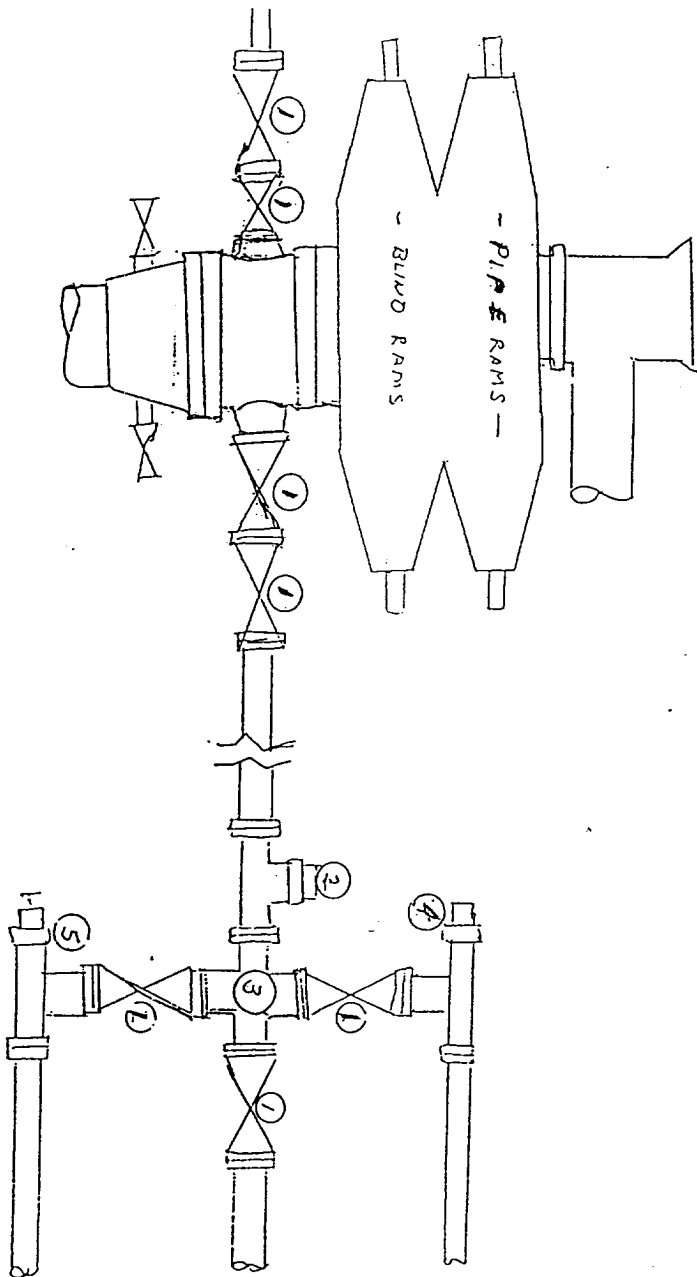

3000 PSI WORKING PRESSURE  
BLOWOUT PREVENTOR HOOK-UP

10-28-83  
10-28-83  
10-28-83

10-28-83

JUN 15 1993  
LCD HOBBS OFFICE