

DISTRICT I
P.O. Box 1980, Hobbs, NM 88241-1980

DISTRICT II
P.O. Drawer DD, Artesia, NM 88211-0719

DISTRICT III
1000 Rio Braxos Rd., Aztec, NM 87410

DISTRICT IV
P.O. Box 2088, Santa Fe, NM 87504-2088

State of New Mexico
Energy, Minerals and Natural Resources Department

Form C-102
Revised February 10, 1994
Submit to Appropriate District Office
State Lease - 4 Copies
Fee Lease - 3 Copies

OIL CONSERVATION DIVISION
P.O. Box 2088
Santa Fe, New Mexico 87504-2088

☒ AMENDED REPORT

WELL LOCATION AND ACREAGE DEDICATION PLAT

| | | |
|----------------------------|---|------------------------------------|
| API Number 30-025-34234 | Pool Code 24620 | Pool Name FLYING "M" SAN ANDRES |
| Property Code 20713 | Property Name FLYING M SAN ANDRES UNIT TRACT 8 | Well Number 2 |
| OGRID No. 21355 | Operator Name SOUTHWEST ROYALTIES INC. | Elevation 4383 |

Surface Location

| | | | | | | | | | |
|--------------------|---------------|-----------------|---------------|---------|-----------------------|---------------------------|-----------------------|------------------------|---------------|
| UL or lot No. K | Section 16 | Township 9 S | Range 33 E | Lot Idn | Feet from the 2000 | North/South line SOUTH | Feet from the 1980 | East/West line WEST | County LEA |
|--------------------|---------------|-----------------|---------------|---------|-----------------------|---------------------------|-----------------------|------------------------|---------------|

Bottom Hole Location If Different From Surface

| | | | | | | | | | |
|---------------|---------|----------|-------|---------|---------------|------------------|---------------|----------------|--------|
| UL or lot No. | Section | Township | Range | Lot Idn | Feet from the | North/South line | Feet from the | East/West line | County |
|---------------|---------|----------|-------|---------|---------------|------------------|---------------|----------------|--------|

| | | | |
|-----------------------|-----------------|--------------------|-----------|
| Dedicated Acres 80 | Joint or Infill | Consolidation Code | Order No. |
|-----------------------|-----------------|--------------------|-----------|

NO ALLOWABLE WILL BE ASSIGNED TO THIS COMPLETION UNTIL ALL INTERESTS HAVE BEEN CONSOLIDATED
OR A NON-STANDARD UNIT HAS BEEN APPROVED BY THE DIVISION

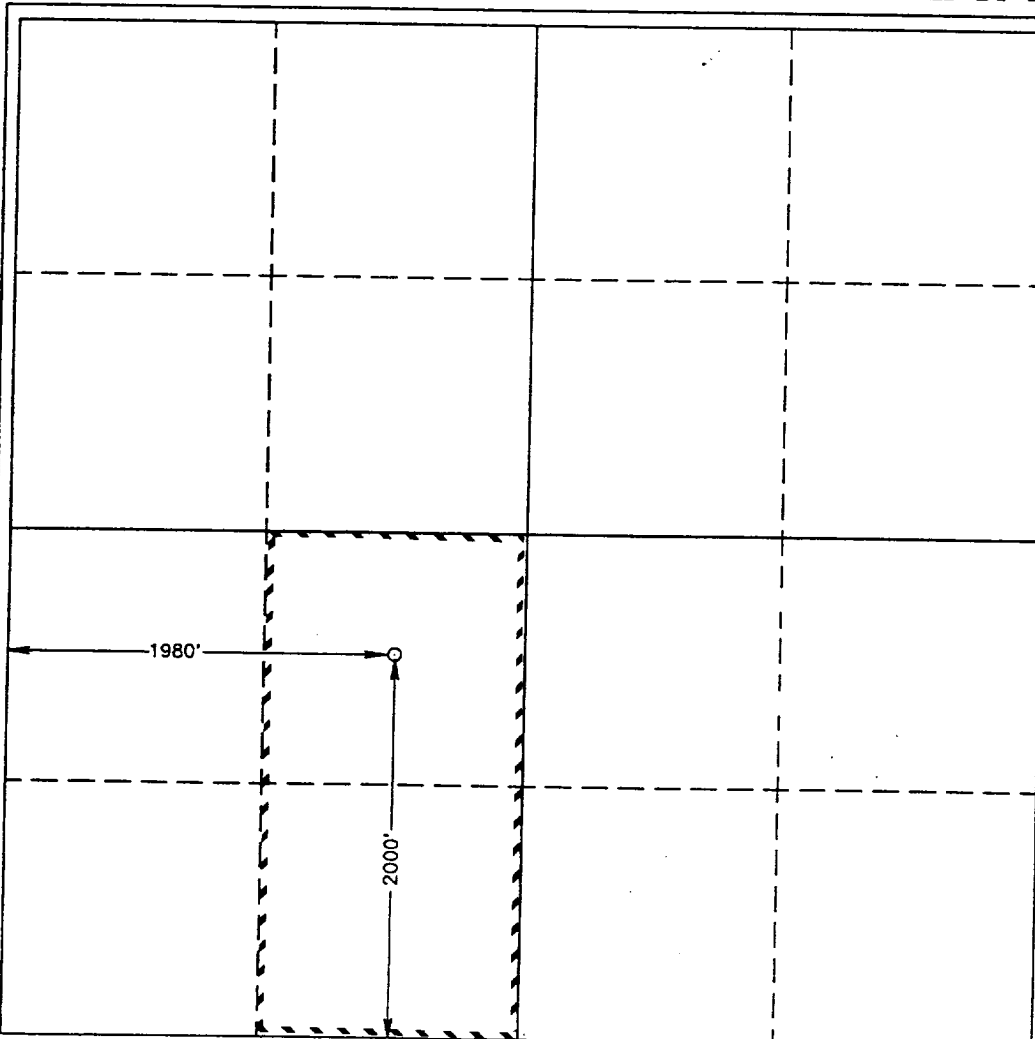

OPERATOR CERTIFICATION

I hereby certify the the information
contained herein is true and complete to the
best of my knowledge and belief.

Joe T. Janica
Signature

Joe T. Janica

Printed Name
Agent

Title
12/11/97

Date

SURVEYOR CERTIFICATION

I hereby certify that the well location shown
on this plat was plotted from field notes of
actual surveys made by me or under my
supervision, and that the same is true and
correct to the best of my belief.

NOVEMBER 21, 1997

Date Surveyed JLP

Signature of Seal of
Professional Surveyor

Ronald E. Edson
12-10-97

W.D. Num. 97-123914

Certificate No. RONALD E. EDSON, 3239
GARY E. EDSON, 12841
RONALD E. EDSON, 12185