

District I
1625 N. French Dr., Hobbs, NM 88240
District II
811 South First, Artesia, NM 88210
District III
1000 Rio Brazos Road, Aztec, NM 87410
District IV
2040 South Pacheco, Santa Fe, NM 87505

State of New Mexico
Energy Minerals and Natural Resources

Form C-101
Revised March 17, 1999

Oil Conservation Division
2040 South Pacheco
Santa Fe, NM 87505

Submit to appropriate District Office
State Lease - 6 Copies
Fee Lease - 5 Copies

☐ AMENDED REPORT

APPLICATION FOR PERMIT TO DRILL, RE-ENTER, DEEPEN, PLUGBACK, OR ADD A ZONE

¹ Operator Name and Address CONCHO OIL & GAS CORP. 110 W. LOUISIAN STE 410 MIDLAND, TX 79701		² OGRID Number 193407
		³ API Number 30-025-35439
³ Property Code 27357	⁵ Property Name Shell State	⁶ Well No. 2

⁷ Surface Location

UL or lot no.	Section	Township	Range	Lot Idn	Feet from the	North/South line	Feet from the	East/West line	County
A	26	10S	32E		660	NORTH	660	EAST	LEA

⁸ Proposed Bottom Hole Location If Different From Surface

UL or lot no.	Section	Township	Range	Lot Idn	Feet from the	North/South line	Feet from the	East/West line	County
⁹ Proposed Pool 1 CUERNO LARGO PENN						¹⁰ Proposed Pool 2			

¹¹ Work Type Code N	¹² Well Type Code O	¹³ Cable/Rotary R	¹⁴ Lease Type Code S	¹⁵ Ground Level Elevation 4295'
¹⁶ Multiple S	¹⁷ Proposed Depth 10,600	¹⁸ Formation PENN	¹⁹ Contractor JW DRLG	²⁰ Spud Date 4/30/01



²¹ Proposed Casing and Cement Program

Hole Size	Casing Size	Casing weight/foot	Setting Depth	Sacks of Cement	Estimated TOC
17-1/2	13-3/8	54.5	400	330	SURF
11	8-5/8	32	3750	865	SURF
7-7/8	5-1/2	17	10600	500	7000

22 Describe the proposed program. If this application is to DEEPEN or PLUG BACK, give the data on the present productive zone and proposed new productive zone. Describe the blowout prevention program, if any. Use additional sheets if necessary.

Concho Oil & Gas Corp. respectfully requests approval to drill the Shell State No. 2 well according to the following procedure:

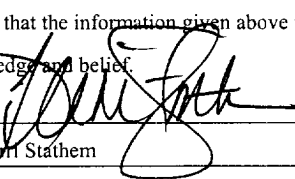
1. Drill 17-1/2" hole to 400' w/ spud mud. Run 400', 13-3/8", 54.5# csg & cmt w/ 330 sx cmt back to surface.
2. NU 5000# BOP w/ annular preventor. Test BOP, annular, choke manifold, & csg to 1500#.
3. Drill 11" hole w/ native brine to 3750'. Run 3750', 8-5/8", 32# csg & cmt w/ 865 sx cmt back to surface.
4. Drill 7-7/8" hole w/ cut brine to 6700'. Mud up & drill to 10600'. Run 5-1/2", 17# csg & cmt w/ 450 sx - est. TOC @ 7000'.

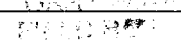
²³ I hereby certify that the information given above is true and complete to the best of my knowledge and belief. Signature:  Printed name: Terri Stathem Title: Production Analyst Date: 3/1/01 Phone: (915) 683-7443		OIL CONSERVATION DIVISION Approved by:  Title:  Approval Date: 3-6-2001 Expiration Date: Conditions of Approval: Attached <input type="checkbox"/>	
---	--	---	--

Permit Expires 1 Year From Approval
Date Unless Drilling Underway

DISTRICT II
P.O. Drawer DD, Artesia, NM 88211-0718

OIL CONSERVATION DIVISION

P.O. Box 2088
Santa Fe, New Mexico 87504-2088

DISTRICT III
1000 Rio Brazos Rd., Aztec, NM 87410

DISTRICT IV
P.O. BOX 2088, SANTA FE, N.M. 87504-2088

WELL LOCATION AND ACREAGE DEDICATION PLAT

☐ AMENDED REPORT

API Number 30-025-35439	Pool Code 14980	Pool Name Cuerno Largo; Penn
Property Code 27357	Property Name SHELL STATE	Well Number 2
OGRID No. 193407	Operator Name CONCHO OIL & GAS Corp.	Elevation 4295'

Surface Location

UL or lot No.	Section	Township	Range	Lot Idn	Feet from the	North/South line	Feet from the	East/West line	County
A	26	10-S	32-E		660	NORTH	660	EAST	LEA

Bottom Hole Location If Different From Surface

UL or lot No.	Section	Township	Range	Lot Idn	Feet from the	North/South line	Feet from the	East/West line	County
---------------	---------	----------	-------	---------	---------------	------------------	---------------	----------------	--------

Dedicated Acres	Joint or Infill	Consolidation Code	Order No.
40			

NO ALLOWABLE WILL BE ASSIGNED TO THIS COMPLETION UNTIL ALL INTERESTS HAVE BEEN CONSOLIDATED
OR A NON-STANDARD UNIT HAS BEEN APPROVED BY THE DIVISION

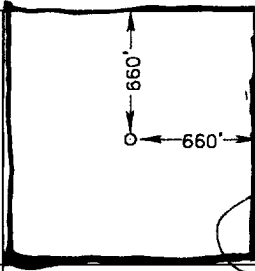
				<p>OPERATOR CERTIFICATION</p> <p><i>I hereby certify the the information contained herein is true and complete to the best of my knowledge and belief.</i></p> <p style="text-align: right;"><i>Terri Stathem</i></p> <p>_____ Signature</p> <p style="text-align: center;">Terri Stathem</p> <p>_____ Printed Name</p> <p style="text-align: center;">Production Analyst</p> <p>_____ Title</p> <p style="text-align: center;">3/1/01</p> <p>_____ Date</p>
				<p>SURVEYOR CERTIFICATION</p> <p><i>I hereby certify that the well location shown on this plat was plotted from field notes of actual surveys made by me or under my supervision, and that the same is true and correct to the best of my belief.</i></p> <p style="text-align: center;">FEBRUARY 16, 2001</p> <p>_____ Date Surveyed</p> <p style="text-align: right;">AWB</p> <p>_____ Signature & Seal of Professional Surveyor</p> <p style="text-align: right;"><i>Ronald J. Eidson</i> 02/21/01</p> <p style="text-align: right;">01-11-0240</p>
				<p>Certificate No. RONALD J. EIDSON 3239 GARY EIDSON 12641</p>

VICINITY MAP

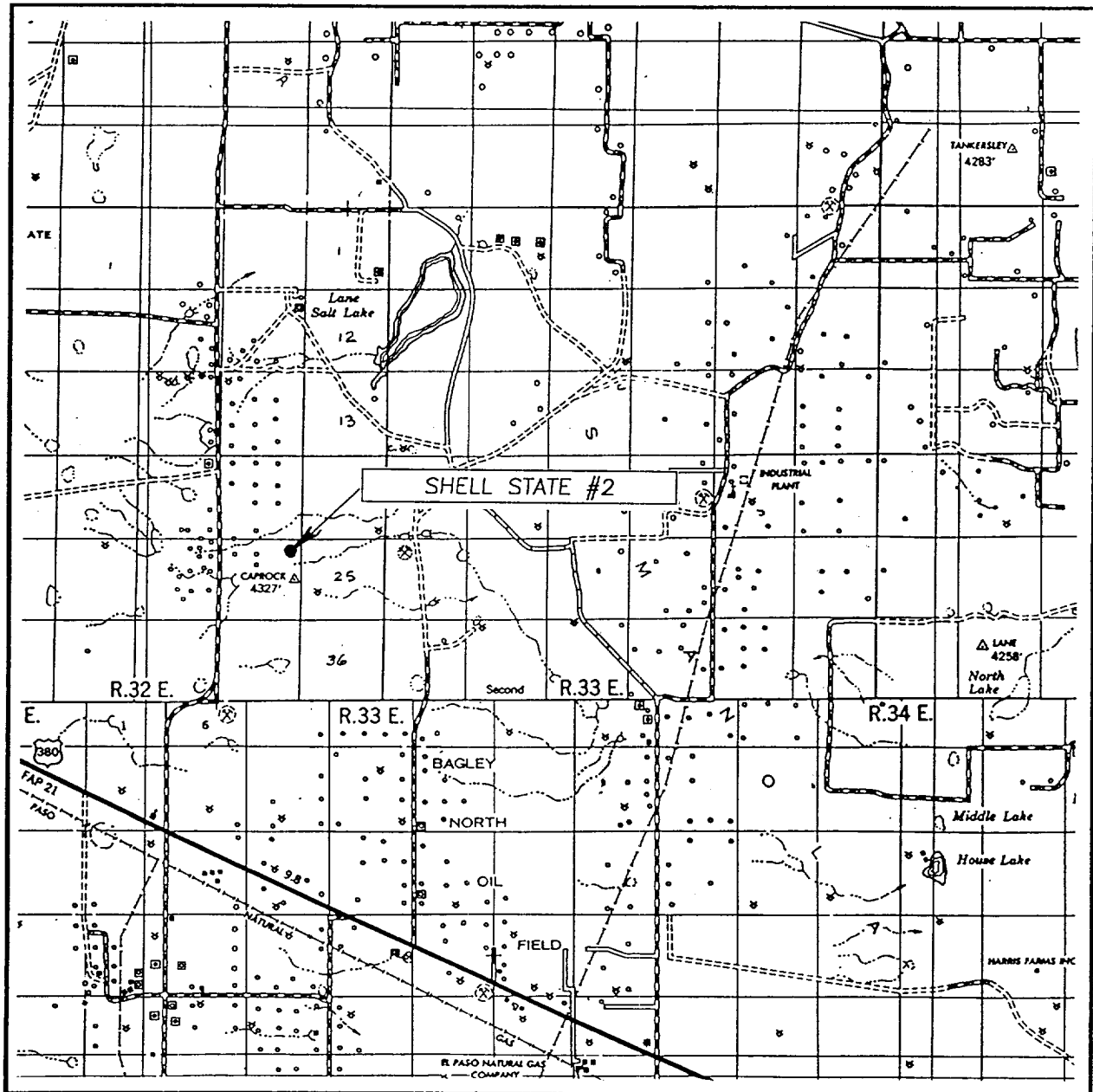

SCALE: 1" = 2 MILES

SEC. 26 TWP. 10-S RGE. 32-E

SURVEY N.M.P.M.

COUNTY LEA

DESCRIPTION 660'FNL & 660'FEL

ELEVATION 4295'

OPERATOR CONCHO OIL & GAS INC.

LEASE SHELL STATE

JOHN WEST SURVEYING
HOBBS, NEW MEXICO
(505) 393-3117