

Submit : Copies To Appropriate District
Office
District I
1625 N. French Dr., Hobbs, NM 88240
District II
811 South First, Artesia, NM 88210
District III
1000 Rio Brazos Rd., Aztec, NM 87410
District IV
2040 South Pacheco, Santa Fe, NM 87505

State of New Mexico
Energy, Minerals and Natural Resources

Form C-103
Revised March 25, 1999

OIL CONSERVATION DIVISION
2040 South Pacheco
Santa Fe, NM 87505

WELL API NO. 30025-35597
5. Indicate Type of Lease STATE <input checked="" type="checkbox"/> FEE <input type="checkbox"/>
6. State Oil & Gas Lease No. V4674
7. Lease Name or Unit Agreement Name: Sundown State
7. Well No. 2
8. Pool name or Wildcat Undes. San Andres

SUNDRY NOTICES AND REPORTS ON WELLS (DO NOT USE THIS FORM FOR PROPOSALS TO DRILL OR TO DEEPEN OR PLUG BACK TO A DIFFERENT RESERVOIR. USE "APPLICATION FOR PERMIT" (FORM C-101) FOR SUCH PROPOSALS.)	
1. Type of Well: Oil Well <input checked="" type="checkbox"/> Gas Well <input type="checkbox"/> Other <input type="checkbox"/> Injection <input type="checkbox"/>	
2. Name of Operator Concho Oil & Gas Corp.	
3. Address of Operator 110 W. Louisiana Ste 410; Midland, Tx 79701	
4. Well Location Unit Letter <u>M</u> : <u>660</u> Feet from the <u>South</u> line and <u>660</u> feet from the <u>West</u> line Section <u>14</u> Township <u>10S</u> Range <u>37E</u> NMPM Lea County	
10. Elevation (Show whether DR, RKB, RT, GR, etc.) 3940 GL	

11. Check Appropriate Box to Indicate Nature of Notice, Report or Other Data	
NOTICE OF INTENTION TO:	SUBSEQUENT REPORT OF:
PERFORM REMEDIAL WORK <input type="checkbox"/> PLUG AND ABANDON <input type="checkbox"/>	REMEDIAL WORK <input type="checkbox"/> ALTERING CASING <input type="checkbox"/>
TEMPORARILY ABANDON <input type="checkbox"/> CHANGE PLANS <input checked="" type="checkbox"/>	COMMENCE DRILLING OPNS. <input type="checkbox"/> PLUG AND ABANDONMENT <input type="checkbox"/>
PULL OR ALTER CASING <input type="checkbox"/> MULTIPLE COMPLETION <input type="checkbox"/>	CASING TEST AND CEMENT JOB <input type="checkbox"/>
OTHER: <input type="checkbox"/>	OTHER: <input type="checkbox"/>

12. Describe proposed or completed operations. (Clearly state all pertinent details, and give pertinent dates, including estimated date of starting any proposed work). SEE RULE 1103. For Multiple Completions: Attach wellbore diagram of proposed completion or recompilation.

Concho Oil & Gas Corp. respectfully requests approval to change the location and the surface casing on the APD for the Sundown State No. 2 well.

Location Change – Amended C102 attached.

Old Location: 500-330 FSL & 330' FWL
NEW Location: 660' FSL & 660' FWL

Surface Casing

Hole Size	Csg Size	Csg Wt/Ft	Depth	Sack of Cement	Estimated TOC
12-1/4	8-5/8	32	350'	380	Surface

I hereby certify that the information above is true and complete to the best of my knowledge and belief.

SIGNATURE Terri Stathem TITLE Production Analyst DATE 10-3-01

Type or print name Terri Stathem Telephone No. 915/683-7443

(This space for State use)

APPROVED BY _____ TITLE _____ DATE _____
Conditions of approval, if any:

DISTRICT I

P.O. Box 1880, Hobbs, NM 88241-1080

State of New Mexico

Energy, Minerals and Natural Resources Department

Form C-102

Revised February 10, 1994

Submit to Appropriate District Office

State Lease - 4 Copies

Fee Lease - 3 Copies

DISTRICT II

P.O. Drawer DD, Artesia, NM 88211-0719

OIL CONSERVATION DIVISION

P.O. Box 2088

Santa Fe, New Mexico 87504-2088

DISTRICT III

1000 Rio Brazos Rd., Aztec, NM 87410

DISTRICT IV

P.O. BOX 2088, SANTA FE, N.M. 87504-2088

WELL LOCATION AND ACREAGE DEDICATION PLAT

AMENDED REPORT

API Number 30025 35597	Pool Code	Pool Name Undes. San Andres
Property Code 28136	Property Name SUNDOWN STATE	Well Number 2
OGRID No. 193407	Operator Name CONCHO OIL & GAS, CORP.	Elevation 3940'

Surface Location

UL or lot No.	Section	Township	Range	Lot Idn	Feet from the	North/South line	Feet from the	East/West line	County
M	14	10-S	37-E		660	SOUTH	660	WEST	LEA

Bottom Hole Location If Different From Surface

UL or lot No.	Section	Township	Range	Lot Idn	Feet from the	North/South line	Feet from the	East/West line	County

Dedicated Acres 40	Joint or Infill	Consolidation Code	Order No.
-----------------------	-----------------	--------------------	-----------

NO ALLOWABLE WILL BE ASSIGNED TO THIS COMPLETION UNTIL ALL INTERESTS HAVE BEEN CONSOLIDATED
OR A NON-STANDARD UNIT HAS BEEN APPROVED BY THE DIVISION

							OPERATOR CERTIFICATION I hereby certify the the information contained herein is true and complete to the best of my knowledge and belief. Signature Terri Stathem Printed Name Production Analyst Title 10/3/01 Date	
							SURVEYOR CERTIFICATION I hereby certify that the well location shown on this plat was plotted from field notes of actual surveys made by me or under my supervision, and that the same is true and correct to the best of my belief. SEPTEMBER 26, 2001 Date Surveyed Signature & Seal Professional Surveyor Certificate No. RONALD S. EDSON 3239 12641	

VICINITY MAP

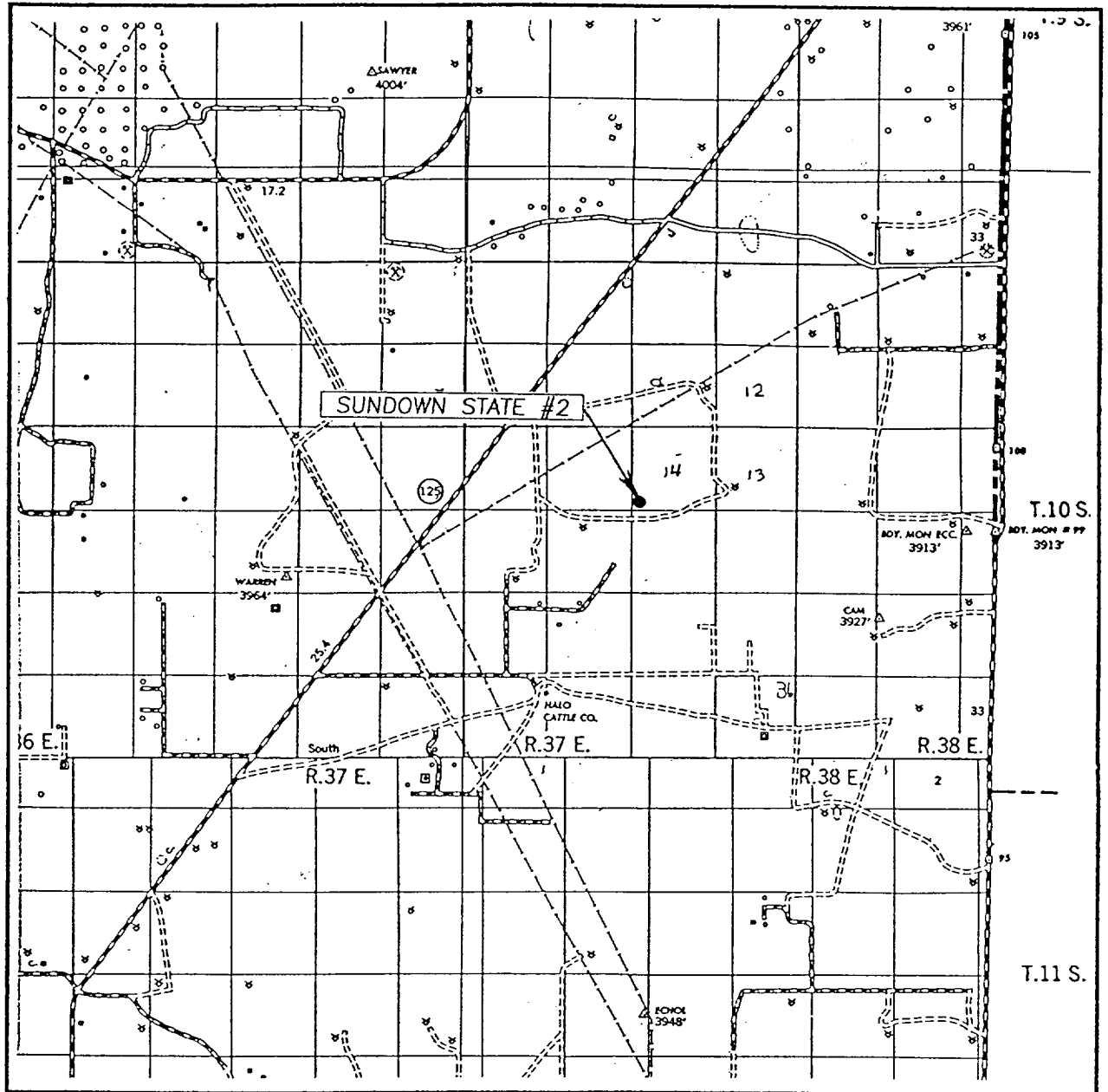

SCALE: 1" = 2 MILES

SEC. 14 TWP. 10-S RGE. 37-E

SURVEY N.M.P.M.

COUNTY LEA

DESCRIPTION 660' FSL & 660' FWL

ELEVATION 3940'

OPERATOR CONCHO OIL & GAS, INC

LEASE SUNDOWN STATE

JOHN WEST SURVEYING
HOBBS, NEW MEXICO
(505) 393-3117

LOCATION VERIFICATION MAP

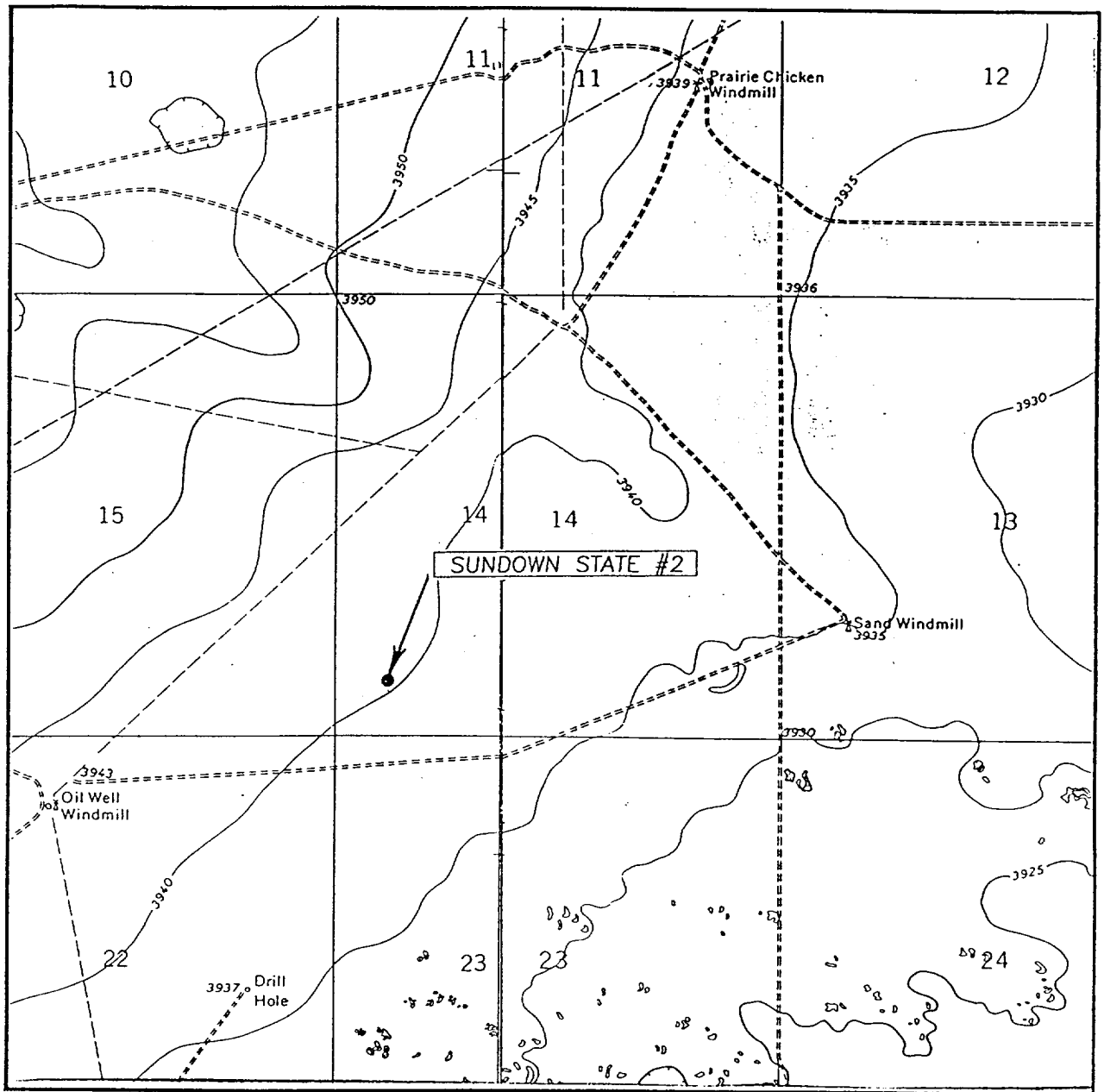

SCALE: 1" = 2000'

CONTOUR INTERVAL: 10'

WALKING CANE RANCH, BRONCO NE, N.M.

SEC. 14 TWP. 10-S RGE. 37-E

SURVEY N.M.P.M.

COUNTY LEA

DESCRIPTION 660' FSL & 660' FWL

ELEVATION 3940'

OPERATOR CONCHO OIL & GAS, INC

LEASE SUNDOWN STATE

U.S.G.S. TOPOGRAPHIC MAP

WALKING CANE RANCH, BRONCO NE, N.M.

JOHN WEST SURVEYING
HOBBS, NEW MEXICO
(505) 393-3117