

NO. 589 OF COP. 18 RECEIVED	
DISTRIBUTION	
SANTA FE	
FILE	
U.S.G.S.	
LAND OFFICE	
TRANSPORTER	OIL GAS
PRODUCTION OFFICE	
OPERATOR	

# NEW MEXICO OIL CONSERVATION COMMISSION

(Form C-104)  
Revised 7/1/57

Santa Fe, New Mexico

## REQUEST FOR (OIL) - (GAS) ALLOWABLE

HOBBES OFFICE

New Well  
Recompletion

This form shall be submitted by the operator before an initial allowable will be assigned to any completed Oil or Gas well. Form C-104 is to be submitted in QUADRUPLICATE to the same District Office to which Form C-101 was sent. The allowable will be assigned effective 7:00 A.M. on date of completion or recompletion, provided this form is filed during calendar month of completion or recompletion. The completion date shall be that date in the case of an oil well when new oil is delivered into the stock tanks. Gas must be reported on 15.025 psia at 60° Fahrenheit.

Midland, Texas

8-18-62

(Place)

(Date)

WE ARE HEREBY REQUESTING AN ALLOWABLE FOR A WELL KNOWN AS:

San Boren

Trans-Mountain Federal Well No. 2

in SE 1/4 SE 1/4

(Company or Operator)

(Lease)

P

Sec. 33

T. 6S

R. 17E

NMPM, Allison Penn

Pool

Unit Letter

Recompletion

County. Date Spudded 7-22-62

Date Drilling Completed 8-2-62

Please indicate location:

D	C	B	A
E	F	G	H
L	K	J	I
M	N	O	P

Elevation 4002.7

Total Depth 9624

PBTD

Top Oil/Gas Pay 9576

Name of Prod. Form. Rough "C"

PRODUCING INTERVAL -

Perforations 9576-9586

Open Hole

Depth Casing Shoe 9624

Depth Tubing 9576

OIL WELL TEST -

Natural Prod. Test: bbls. oil, bbls water in hrs, min. Size

Test After Acid or Fracture Treatment (after recovery of volume of oil equal to volume of load oil used): 235 bbls. oil, 0 bbls water in 24 hrs, 0 min. Size 18/64

GAS WELL TEST -

Natural Prod. Test: MCF/Day; Hours flowed Choke Size

Method of Testing (pitot, back pressure, etc.):

Test After Acid or Fracture Treatment: MCF/Day; Hours flowed

Choke Size Method of Testing:

Acid or Fracture Treatment (Give amounts of materials used, such as acid, water, oil, and sand): 1000 gal. acid

Casing Press. 1000 Tubing Press. 800 Date first new oil run to tanks 8-18-62

Oil Transporter Midland Corporation

Gas Transporter Newberry & Thompson

Remarks:

I hereby certify that the information given above is true and complete to the best of my knowledge.

Approved, 19

San Boren

(Company or Operator)

OIL CONSERVATION COMMISSION

By:

(Signature)

Title:

Agent  
Send Communications regarding well to:

Name:

San Boren

Address:

Box 953, Midland, Texas

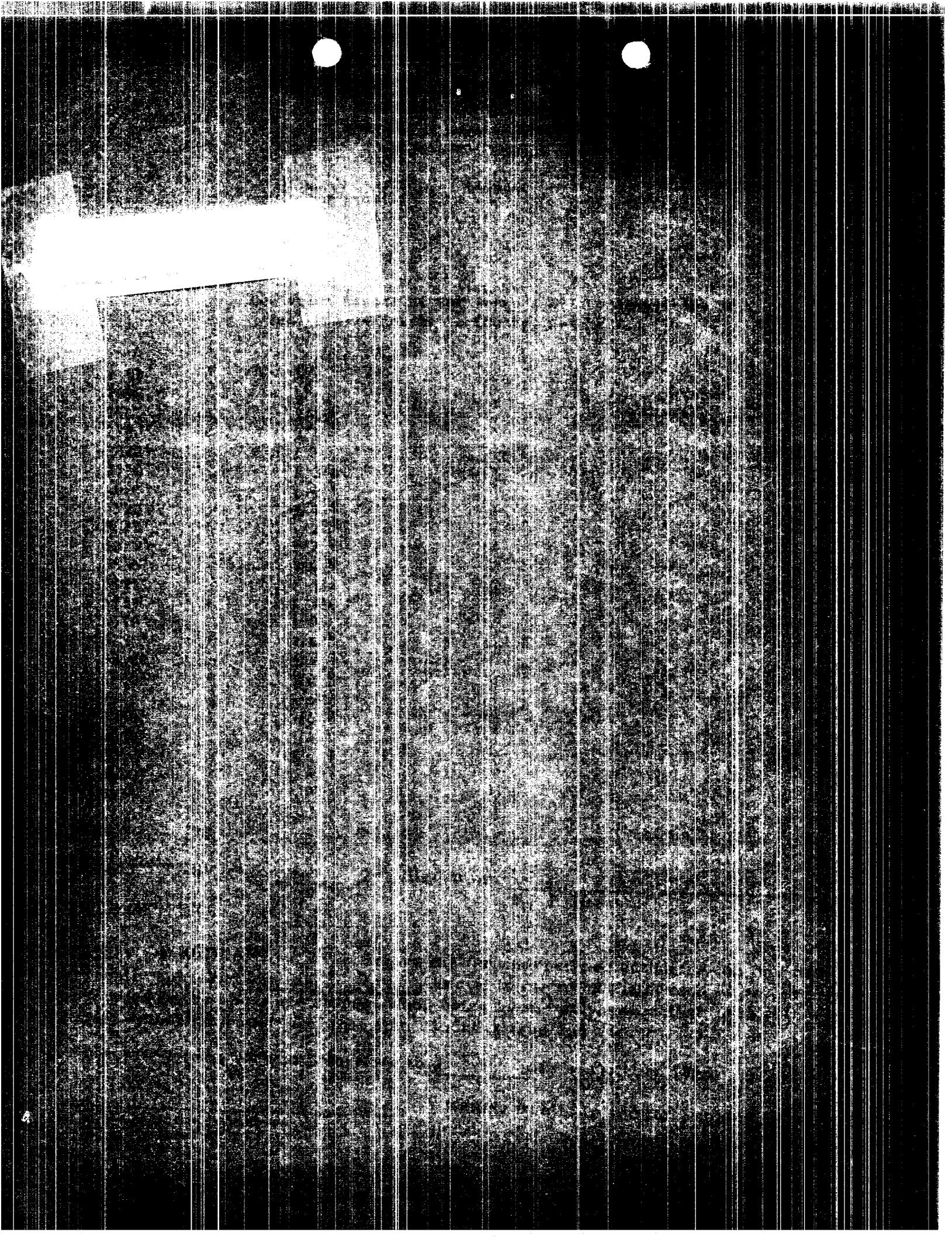



NUMBER OF COPIES RECEIVED	
DISTRIBUTION	
SANTA FE	
FILE	
U.S.G.S.	
LAND OFFICE	
TRANSPORTER	OIL GAS
PRODUCTION OFFICE	
OPERATOR	

**NEW MEXICO OIL CONSERVATION COMMISSION**  
**SANTA FE, NEW MEXICO**  
**CERTIFICATE OF COMPLIANCE AND AUTHORIZATION**  
**TO TRANSPORT OIL AND NATURAL GAS**

**FORM C-110**  
 (Rev. 7-60)

FILE THE ORIGINAL AND 4 COPIES WITH THE APPROPRIATE OFFICE

Company or Operator				Lease		Well No.	
Unit Letter	Section	Township	Range	County			
Pool				Kind of Lease (State, Fed, Fee)			
If well produces oil or condensate give location of tanks		Unit Letter	Section	Township	Range		
Authorized transporter of oil <input type="checkbox"/> or condensate <input type="checkbox"/>				Address (give address to which approved copy of this form is to be sent)			

Is Gas Actually Connected? Yes ☐ No ☐

Authorized transporter of casing head gas <input type="checkbox"/> or dry gas <input type="checkbox"/>	Date Connected	Address (give address to which approved copy of this form is to be sent)
--	----------------	--

If gas is not being sold, give reasons and also explain its present disposition:

**REASON(S) FOR FILING (please check proper box)**

- |  |  |
|--|--|
| New Well <input type="checkbox"/>  | Change in Ownership <input type="checkbox"/> |
| Change in Transporter (check one)  | Other (explain below)                        |
| Oil <input type="checkbox"/> Dry Gas <input type="checkbox"/>                |  |
| Casing head gas <input type="checkbox"/> Condensate <input type="checkbox"/> |  |

Remarks

The undersigned certifies that the Rules and Regulations of the Oil Conservation Commission have been complied with.

Executed this the \_\_\_\_\_ day of \_\_\_\_\_, 19\_\_.

**OIL CONSERVATION COMMISSION**

Approved by

Title

Date

By

Title

Company

Address

Box 650, Midland, Texas



APPROVED

COPY TO C. C. HOBBS

Budget Bureau No. 42-R358.4.  
Approval expires 12-31-60.Form 9-331a  
(Feb. 1951)

JUL 9 1962

(SUBMIT IN TRIPLICATE)

Land Office Santa FeLease No. NM 057004

Unit \_\_\_\_\_

E. W. STANDLEY  
DISTRICT ENGINEER

UNITED STATES

DEPARTMENT OF THE INTERIOR

GEOLOGICAL SURVEY

JUL 9 1962

U. S. GEOLOGICAL SURVEY  
HOBBS, NEW MEXICO

## SUNDRY NOTICES AND REPORTS ON WELLS

NOTICE OF INTENTION TO DRILL	<input checked="" type="checkbox"/>	SUBSEQUENT REPORT OF WATER SHUT-OFF	
NOTICE OF INTENTION TO CHANGE PLANS		SUBSEQUENT REPORT OF SHOOTING OR ACIDIZING	
NOTICE OF INTENTION TO TEST WATER SHUT-OFF		SUBSEQUENT REPORT OF ALTERING CASING	
NOTICE OF INTENTION TO RE-DRILL OR REPAIR WELL		SUBSEQUENT REPORT OF RE-DRILLING OR REPAIR	
NOTICE OF INTENTION TO SHOOT OR ACIDIZE		SUBSEQUENT REPORT OF ABANDONMENT	
NOTICE OF INTENTION TO PULL OR ALTER CASING		SUPPLEMENTARY WELL HISTORY	
NOTICE OF INTENTION TO ABANDON WELL			

(INDICATE ABOVE BY CHECK MARK NATURE OF REPORT, NOTICE, OR OTHER DATA)

July 6, 1962

Well No. 2 Trans- is located Mountain Federal 660 ft. from S line and 660 ft. from E line of sec. 33NW/4 SE/4 33  
( $\frac{1}{4}$  Sec. and Sec. No.)8S  
(Twp.)37E  
(Range)NMPM  
(Meridian)Allison Penn  
(Field)Roosevelt  
(County or Subdivision)New Mexico  
(State or Territory)The elevation of the derrick floor above sea level is 4014.7 ft.

## DETAILS OF WORK

(State names of and expected depths to objective sands; show sizes, weights, and lengths of proposed casings; indicate mudding jobs, cementing points, and all other important proposed work)

We propose to drill to a total depth of approximately 9700 feet with rotary tools and complete in the Bough "C" formation. The casing program will be as follows: 10-3/4 inch 32.75#, H-40 surface casing to be set @ 400 feet and cemented with 400 sacks. Cement will be circulated to surface. 7-5/8 inch 26#, J-55 casing set @ 4250 feet and cemented with 450 sacks cement. 4-1/2 11.60# N-80 casing set @ 9700 feet and cemented with 400 sacks.

I understand that this plan of work must receive approval in writing by the Geological Survey before operations may be commenced.

Company Sam BorenAddress Box 953Midland, TexasBy [Signature]Title Agent

Handwritten notes and markings at the top of the page, including a date "1991" and some illegible text.

Vertical text on the right margin, possibly a page number or reference code.



NUMBER OF COPIES RECEIVED	
DISTRIBUTION	
SANTA FE	
FILE	
U.S.G.S.	
LAND OFFICE	
TRANSPORTER	OIL GAS
PRORATION OFFICE	
OPERATOR	

**NEW MEXICO OIL CONSERVATION COMMISSION**  
**WELL LOCATION AND ACREAGE DEDICATION PLAT**  
 SEE INSTRUCTIONS FOR COMPLETING THIS FORM ON THE REVERSE SIDE

FORM C-128  
Revised 5/1/57

<b>SECTION A</b>				
Operator <b>Sam Boren</b>		Lease <b>Trans-Mountain Federal</b>		Well No. <b>2</b>
Unit Letter <b>P</b>	Section <b>33</b>	Township <b>8S</b>	Range <b>37E</b>	County <b>Roosevelt</b>
Actual Footage Location of Well: <b>660</b> feet from the <b>South</b> line and <b>660</b> feet from the <b>East</b> line				
Ground Level Elev.	Producing Formation <b>Bough "C"</b>	Pool <b>Allison Penn</b>	Dedicated Acreage: <b>80</b> Acres	

1. Is the Operator the only owner in the dedicated acreage outlined on the plat below? YES ☒ NO \_\_\_\_ . ("Owner" means the person who has the right to drill into and to produce from any pool and to appropriate the production either for himself or for himself and another. (65-3-29 (e) NMSA 1935 Comp.)
2. If the answer to question one is "no," have the interests of all the owners been consolidated by communitization agreement or otherwise? YES \_\_\_\_ NO \_\_\_\_ . If answer is "yes," Type of Consolidation \_\_\_\_
3. If the answer to question two is "no," list all the owners and their respective interests below:

Owner	Land Description

**SECTION B**

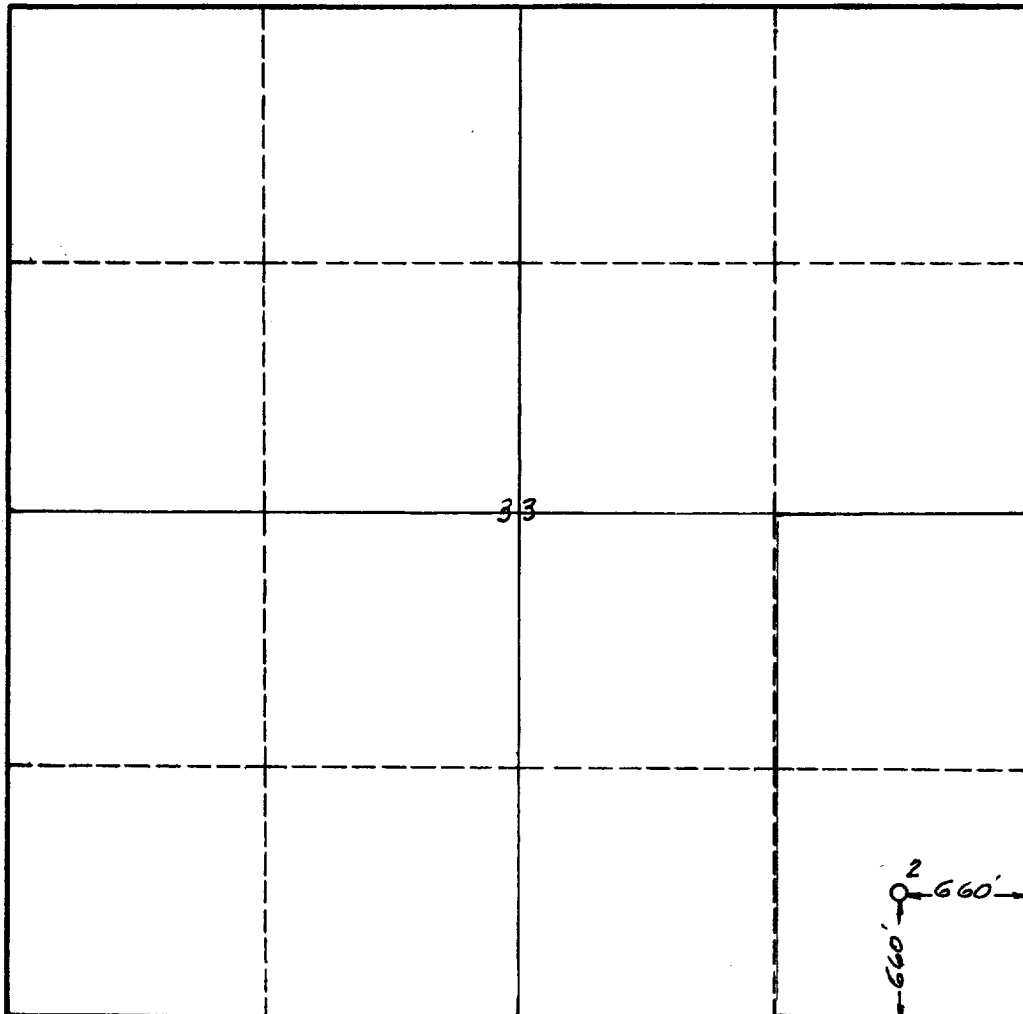

**CERTIFICATION**

I hereby certify that the information in SECTION A above is true and complete to the best of my knowledge and belief.

Name <i>Edward Smith</i>
Position <b>Agent</b>
Company <b>Sam Boren</b>
Date <b>July 6, 1962</b>

I hereby certify that the well location shown on the plat in SECTION B was plotted from field notes of actual surveys made by me or under my supervision, and that the same is true and correct to the best of my knowledge and belief.

Date Surveyed <b>July 6, 1962</b>
Registered Professional Engineer and/or Land Surveyor <i>Wm. E. Shaw</i>
Certificate No. <b>2189</b>

0 330 660 990 1320 1650 1980 2310 2640 2000 1500 1000 500 0



### **INSTRUCTIONS FOR COMPLETION OF FORM C-128**

1. Operator shall furnish and certify to the information called for in Section A.
2. Operator shall outline the dedicated acreage for *both* oil and gas wells on the plat in Section B.
3. A registered professional engineer or land surveyor registered in the State of New Mexico or approved by the Commission shall show on the plat the location of the well and certify this information in the space provided.
4. All distances shown on the plat must be from the outer boundaries of the Section.
5. If additional space is needed for listing owners and their respective interests as required in question 3 of Section A, please use space below.

Pool (A) ALLISON PENN

Operator Sam Boren

Lease Trans Mountain Fed.

Well No. 2 Unit P S 33 T 8 R 37

[illegible]