

NO. OF COPIES RECEIVED	
DISTRIBUTION	
SANTA FE	
FILE	
U.S.G.S.	
LAND OFFICE	
OPERATOR	

# NEW MEXICO OIL CONSERVATION COMMISSION

Form C-101  
Revised 1-1-65

5A. Indicate Type of Lease	
STATE <input type="checkbox"/>	FEE <input checked="" type="checkbox"/>

5. State Oil & Gas Lease No.

## APPLICATION FOR PERMIT TO DRILL, DEEPEN, OR PLUG BACK

1a. Type of Work		7. Unit Agreement Name	
b. Type of Well DRILL <input type="checkbox"/> DEEPEN <input type="checkbox"/> PLUG BACK <input checked="" type="checkbox"/> OIL WELL <input checked="" type="checkbox"/> GAS WELL <input type="checkbox"/> OTHER <input type="checkbox"/> SINGLE ZONE <input checked="" type="checkbox"/> MULTIPLE ZONE <input type="checkbox"/>		8. Farm or Lease Name <b>H. L. Harral</b>	
2. Name of Operator <b>Lane Star Producing Company</b>		9. Well No. <b>1</b>	
3. Address of Operator <b>Box 4815, Midland, Texas 79702</b>		10. Field and Pool, or Wildcat <b>Undesignated</b>	
4. Location of Well UNIT LETTER <b>N</b> LOCATED <b>590</b> FEET FROM THE <b>South</b> LINE AND <b>2,050</b> FEET FROM THE <b>West</b> LINE OF SEC. <b>17</b> TWP. <b>8-8</b> RGE. <b>36-E</b> NMPM		12. County <b>Roosevelt</b>	
19. Proposed Depth <b>4,950'</b>		19A. Formation <b>San Andres</b>	20. Rotary or C.T. <b>Reverse Rotary Unit</b>
21. Elevations (Show whether DF, RT, etc.) <b>Ground 4,129.3'</b>	21A. Kind & Status Plug. Bond <b>In Force</b>	21B. Drilling Contractor <b>Unknown at this date.</b>	22. Approx. Date Work will start <b>January 19, 1965</b>

### 23. PROPOSED CASING AND CEMENT PROGRAM

SIZE OF HOLE	SIZE OF CASING	WEIGHT PER FOOT	SETTING DEPTH	SACKS OF CEMENT	EST. TOP
17-1/2"	13-3/8"	48#	365'	300 (circ.)	In place
11"	8-5/8"	?	4,110'	1100 (circ.)	In place
7-7/8"	4 1/2" Liner	?	3997'-9749'	600	In place

Propose to drill plugs out of 8-5/8" O.D. casing now in place set at 4110' cemented with 1,400 sacks and circulated. Drill plug out of top of 4 1/2" O.D. liner set from 3997' to 9747'. Condition mud in hole, set mechanical bridge plug in 4 1/2" liner at approximate depth of 5,200', perforate 4 holes in liner at approximate depth of 5150'. Set Halliburton Model D.M. cement retainer at approximate depth of 5090'. Pressure up for possible channel job behind 4 1/2" O.D. liner. If so, re-cement. If we cannot break circulation between perforations 5150' and 4000', we will block squeeze perforations 5150' with amount of cement we can get out of bore of hole. After re-cementing or block squeeze has been completed, we will perforate for completion at depth of approximately 4950' and acidize for completion.

This well was originally drilled by Coastal States Oil Company, Abilene, Texas, as their H. L. Harral No. 1 well and completed as a Rough "C" Line producer. It was produced until 1964 when well was plugged and abandoned by Coastal States Oil Company.

IN ABOVE SPACE DESCRIBE PROPOSED PROGRAM: IF PROPOSAL IS TO DEEPEN OR PLUG BACK, GIVE DATA ON PRESENT PRODUCTIVE ZONE AND PROPOSED NEW PRODUCTIVE ZONE. GIVE BLOWOUT PREVENTER PROGRAM, IF ANY.

I hereby certify that the information above is true and complete to the best of my knowledge and belief.

Signed *[Signature]* Title District Production Superintendent Date January 18, 1965

(This space for State Use)

APPROVED BY *[Signature]* TITLE \_\_\_\_\_ DATE \_\_\_\_\_

CONDITIONS OF APPROVAL, IF ANY:

NEW MEXICO OIL CONSERVATION COMMISSION  
WELL LOCATION AND ACREAGE DEDICATION PLAT

FORM C-128  
Revised 5/1/57

SEE INSTRUCTIONS FOR COMPLETING THIS FORM ON THE REVERSE SIDE

SECTION A

Operator LONE STAR PRODUCING COMPANY		Lease H. L. HARRIS		Well No. 1
Unit Letter N	Section 17	Township 8 SOUTH	Range 36 EAST	County ROOSEVELT

Actual Postage Location of Well:

590 feet from the SOUTH line and 2050 feet from the WEST line

Ground Level Elev. 4129.3	Producing Formation San Andres	Pool Undesignated W. West	Dedicated Acreage: 160 40 Acres
------------------------------	-----------------------------------	------------------------------	------------------------------------

1. Is the Operator the only owner in the dedicated acreage outlined on the plat below? YES ☒ NO ☐ ("Owner" means the person who has the right to drill into and to produce from any pool and to appropriate the production either for himself or for himself and another. (65-3-29 (e) NMSA 1955 Comp.)
2. If the answer to question one is "no," have the interests of all the owners been consolidated by communitization agreement or otherwise? YES ☐ NO ☐ . If answer is "yes," Type of Consolidation \_\_\_\_\_
3. If the answer to question two is "no," list all the owners and their respective interests below:

Owner	Land Description

SECTION B

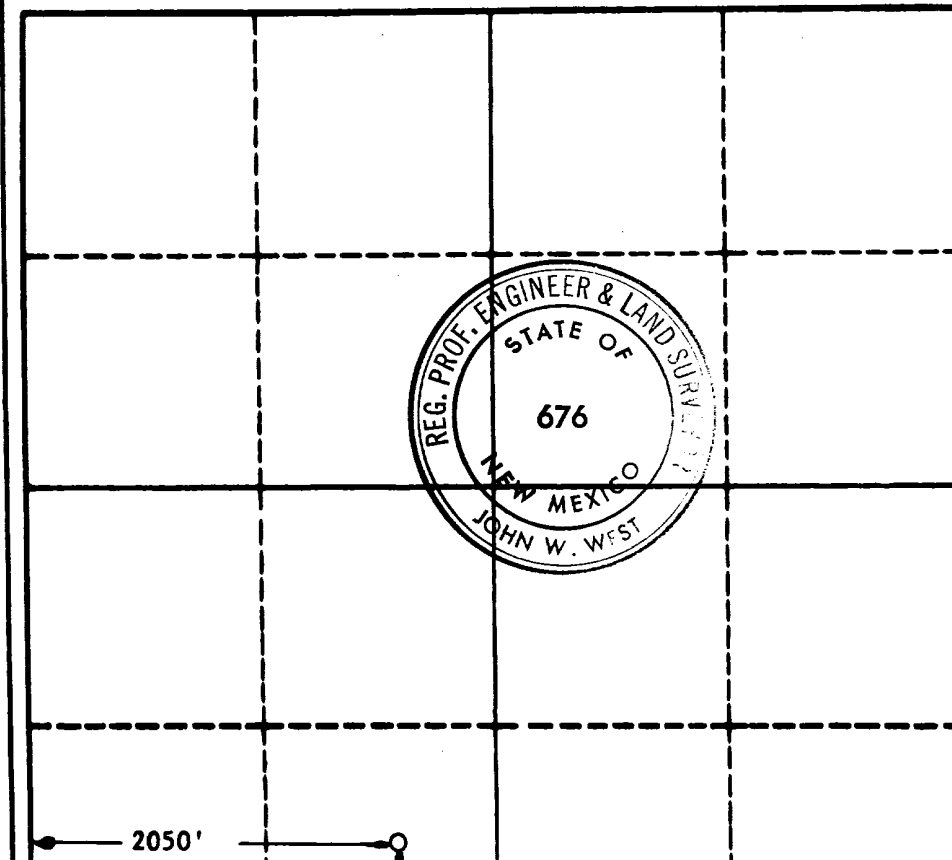

CERTIFICATION

I hereby certify that the information in SECTION A above is true and complete to the best of my knowledge and belief.

Name <i>E. J. Smith</i>
Position <i>Asst. Prod. Supt.</i>
Company <i>Lone Star Producing Co.</i>
Date <i>January 18, 1965</i>

I hereby certify that the well location shown on the plat in SECTION B was plotted from field notes of actual surveys made by me or under my supervision, and that the same is true and correct to the best of my knowledge and belief.

Date Surveyed JAN 18, 1965
-------------------------------

Registered Professional Engineer