

NEW MICO OIL CONSERVATION COMMISSION
Santa Fe, New Mexico

Form C-101
Revised (12/1/55)

NOTICE OF INTENTION TO DRILL

HOBBS OFFICE OCC

Notice must be given to the District Office of the Oil Conservation Commission and approval obtained before drilling or recompletion begins. If changes in the proposed plan are considered advisable, a copy of this notice showing such changes will be returned to the sender. Submit this notice in **QUINTUPLICATE**. One copy will be returned following approval. See additional instructions in Rules and Regulations of the Commission. If State Land submit 6 Copies Attach Form C-128 in triplicate to first 3 copies of form C-101

Midland, Texas

November 26, 1962

(Place)

(Date)

OIL CONSERVATION COMMISSION
SANTA FE, NEW MEXICO

Gentlemen:

You are hereby notified that it is our intention to commence the Drilling of a well to be known as
Robert A. Dean

(Company or Operator)

Luman

2

H

Well No., in The well is

(Lease)

(Unit)

660

East

1980

located feet from the line and feet from the

North

23

-8-S

-34-E

NMPM.

(GIVE LOCATION FROM SECTION LINE) **Milnesand San Andres** Pool, **Roosevelt** County

If State Land the Oil and Gas Lease is No.

If patented land the owner is **N. Setho Luman**

Address **Milnesand, N.M.**

We propose to drill well with drilling equipment as follows: **Rotary rig**

The status of plugging bond is **Blanket Bond approved**

Drilling Contractor **I. W. Lovelady**

ABC Building, Odessa, Texas

We intend to complete this well in the **San Andres**

formation at an approximate depth of **4600** feet.

CASING PROGRAM

We propose to use the following strings of Casing and to cement them as indicated:

Size of Hole	Size of Casing	Weight per Foot	New or Second Hand	Depth	Sacks Cement
10-3/4"	8-5/8"	28#	Used	450'	Circ. to surf.
7-1/8"	5-1/2"	15.5#	Used	4650'	250 sx

If changes in the above plans become advisable we will notify you immediately.

ADDITIONAL INFORMATION (If recompletion give full details of proposed plan of work.)

Approved....., 19.....
Except as follows:

Sincerely yours,

Robert A. Dean

(Company or Operator)

By.....

Agent

Position.....
Send Communications regarding well to

Name **%V. Pickett**

Address **901 Midland Savings Bldg.
Midland, Texas**

OIL CONSERVATION COMMISSION

By.....

NEW MEXICO OIL CONSERVATION COMMISSION

FORM C-128
Revised 5/1/57WELL LOCATION AND ACREAGE DEDICATION PLAT **HOBBS OFFICE OCC**

SEE INSTRUCTIONS FOR COMPLETING THIS FORM ON THE REVERSE SIDE

SECTION A

Operator ROBERT A. DEAN		Lease LUMAN		Well No. 2 10 04	
Unit Letter H	Section 23	Township 8 SOUTH	Range 34 EAST	County ROOSEVELT	
Actual Footage Location of Well: 1980 feet from the NORTH line and 660 feet from the EAST line					
Ground Level Elev. 4247.8	Producing Formation San Andres		Pool Milnesand San Andres	Dedicated Acreage: 40 Acres	

1. Is the Operator the only owner in the dedicated acreage outlined on the plat below? YES XX NO ____ ("Owner" means the person who has the right to drill into and to produce from any pool and to appropriate the production either for himself or for himself and another. 165-3-29 (e) NMSA 1935 (comp).)
2. If the answer to question one is "no," have the interests of all the owners been consolidated by communitization agreement or otherwise? YES ____ NO ____ If answer is "yes," Type of Consolidation ____
3. If the answer to question two is "no," list all the owners and their respective interests below:

Owner	Land Description

SECTION B

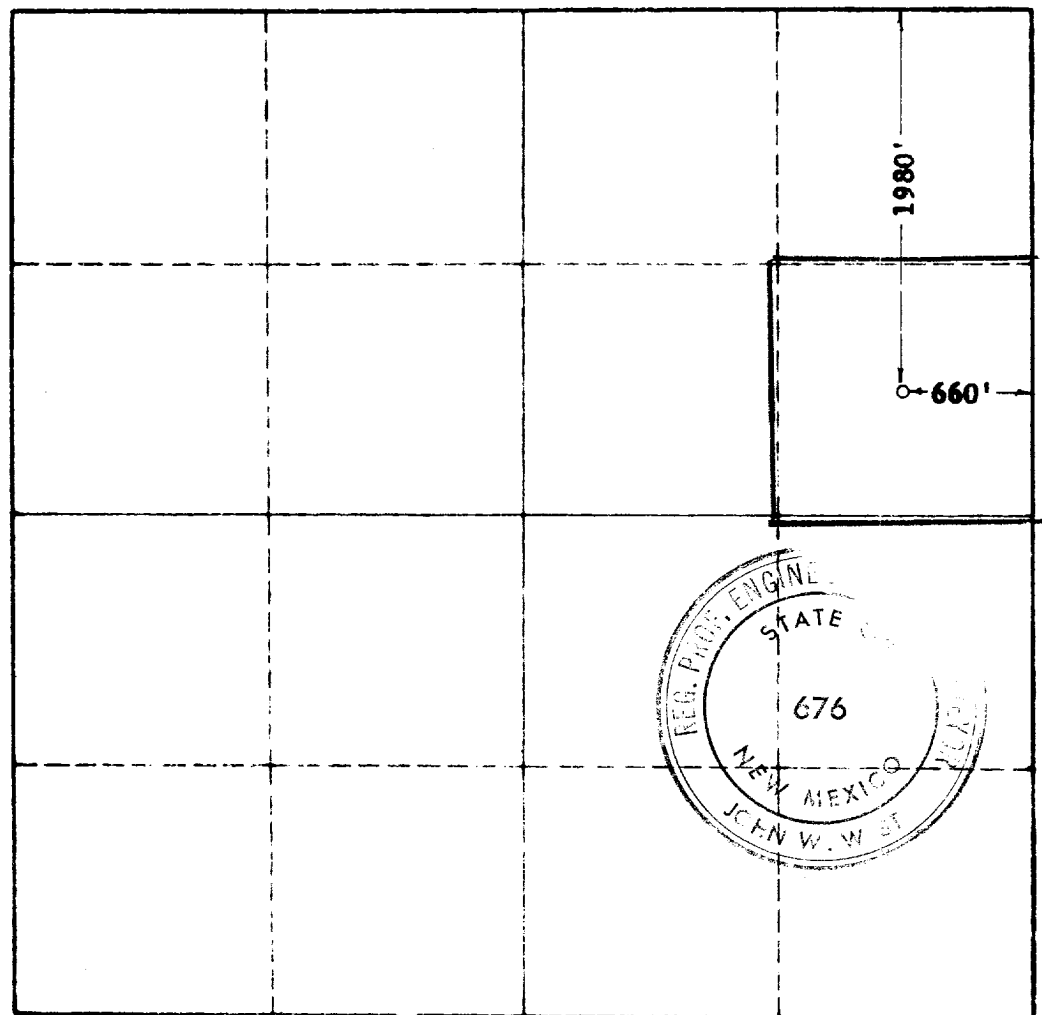

CERTIFICATION

I hereby certify that the information in SECTION A above is true and complete to the best of my knowledge and belief.

Name	Robert A. Dean
Position	Agent
Company	Robert A. Dean
Date	November 26, 1962

I hereby certify that the well location shown on the plat in SECTION B was plotted from field notes of actual surveys made by me or under my supervision, and that the same is true and correct to the best of my knowledge and belief.

Date Surveyed	NOVEMBER 20, 1962
Registered Professional Engineer and/or Land Surveyor, JOHN W. WEST	
Certificate No.	N. M. - P. E. & L. S. NO. 676

0 330 660 990 1320 1650 1980 2310 2640 2000 1500 1000 500 0