

APPROVED

COPY TO O. C. C.

Form 9-381a
(Feb. 1951)

JUN 14 1962

Budget Bureau No. 42-R358.4.
Approval expires 12-31-60.

		X	

(SUBMIT IN TRIPLICATE)

E. W. STANDLEY
DISTRICT ENGINEER UNITED STATES
DEPARTMENT OF THE INTERIOR
GEOLOGICAL SURVEY

Land Office Las CrucesLease No. 062949(a)Unit 1

SUNDRY NOTICES AND REPORTS ON WELLS

NOTICE OF INTENTION TO DRILL.....	X	SUBSEQUENT REPORT OF WATER SHUT-OFF.....	
NOTICE OF INTENTION TO CHANGE PLANS.....		SUBSEQUENT REPORT OF SHOOTING OR ACIDIZING.....	
NOTICE OF INTENTION TO TEST WATER SHUT-OFF.....		SUBSEQUENT REPORT OF ALTERING CASING.....	
NOTICE OF INTENTION TO RE-DRILL OR REPAIR WELL.....		SUBSEQUENT REPORT OF RE-DRILLING OR REPAIR.....	
NOTICE OF INTENTION TO SHOOT OR ACIDIZE.....		SUBSEQUENT REPORT OF ABANDONMENT.....	
NOTICE OF INTENTION TO PULL OR ALTER CASING.....		SUPPLEMENTARY WELL HISTORY.....	
NOTICE OF INTENTION TO ABANDON WELL.....			

(INDICATE ABOVE BY CHECK MARK NATURE OF REPORT, NOTICE, OR OTHER DATA)

June 13, 1962

Ohio-Federal
Well No. #1 is located 560 ft. from N line and 1980 ft. from E line of sec. 27

N. NE c. 27 8-5 34-E N. 1/4
(1/4 Sec. and Sec. No.) (Twp.) (Range) (Meridian)
Wildcat Roosevelt New Mexico
(Field) (County or Subdivision) (State or Territory)

The elevation of the derrick floor above sea level is _____ ft.

DETAILS OF WORK

(State names of and expected depths to objective sands; show sizes, weights, and lengths of proposed casings; indicate mudding jobs, cementing points, and all other important proposed work)

We propose to drill with rotary to a depth of approximately 9700 feet to test the Pennsylvanian (Bough) zones. The proposed pipe program is as follows:

400' - 13-3/8" O.D. cemented with 350 sacks.
4120' - 8-5/8" O.D. cemented with 450 sacks.
9700' - 4-1/2" O.D. cemented with 450 sacks.

It is anticipated that some coring and drill stem testing will be done in the San Andres at 4100-4200' and Pennsylvanian shows will be tested. The well will be completed by perforating the 4 1/2" casing.

I understand that this plan of work must receive approval in writing by the Geological Survey before operations may be commenced.

Company William A. & Edward R. HudsonAddress 302 Carper BuildingArtesia, New MexicoBy Ralph L. GrayTitle Consulting Engineer.

HOBBS OFFICE OCC

NEW MEXICO OIL CONSERVATION COMMISSION
WELL LOCATION AND ACREAGE DEDICATION PLAT

FORM C-128
Revised 5/1/57

SEE INSTRUCTIONS FOR COMPLETING THIS FORM ON THE REVERSE SIDE

SECTION A

Operator WILLIAM A. & EDWARD R. HUDSON			Lease OMEGA FEDERAL		Well No. 1-27
Trk Letter B	Section 27	Township 8 SOUTH	Range 34 EAST	County ROOSEVELT COUNTY	
Actual Footage Location of Well: 1980 feet from the EAST line and 660 feet from the NORTH line					
Ground Level Elev.	Producing Formation Pennsylvanian		Pool Wildcat		Dedicated Acreage: 40 Acres

1. Is the Operator the only owner in the dedicated acreage outlined on the plat below? YES X NO ____ . ("Owner" means the person who has the right to drill into and to produce from any pool and to appropriate the production either for himself or for himself and another. (65-3-29 (e) NMSA 1935 Comp.)
2. If the answer to question one is "no," have the interests of all the owners been consolidated by communitization agreement or otherwise? YES ____ NO ____ . If answer is "yes," Type of Consolidation _____
3. If the answer to question two is "no," list all the owners and their respective interests below:

Owner	Land Description

SECTION B

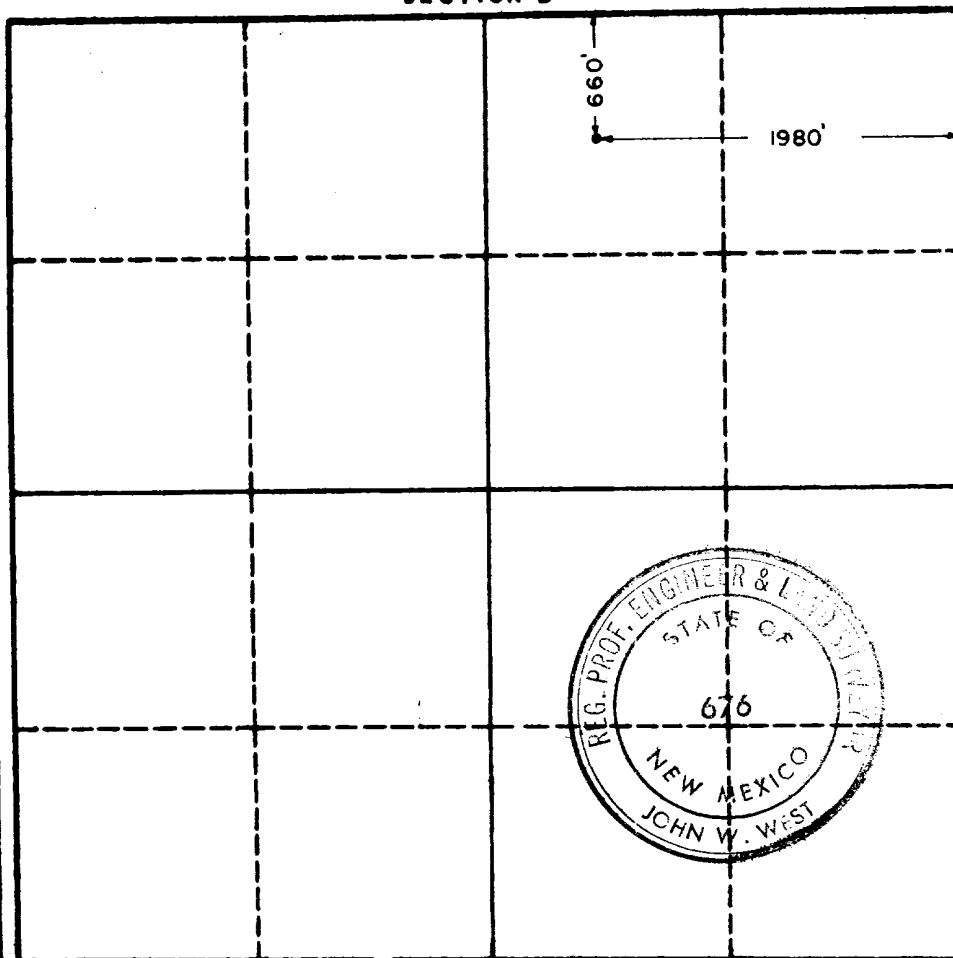

CERTIFICATION

I hereby certify that the information in SECTION A above is true and complete to the best of my knowledge and belief.

Name Ralph L. Gray
Position Consulting Engineer.
Company _____
Date June 11, 1962

I hereby certify that the well location shown on the plat in SECTION B was plotted from field notes of actual surveys made by me or under my supervision, and that the same is true and correct to the best of my knowledge and belief.

Date Surveyed JUNE 8, 1962
Registered Professional Engineer and/or Land Surveyor, JOHN W. WEST
John W. West
Certificate No. N.M. - P.E. & L.S. NO. 676

0 350 650 950 1250 1550 1850 2150 2450 2750 3050 3350 3650