

NEW MEXICO OIL CONSERVATION COMMISSION
WELL LOCATION AND ACREAGE DEDICATION PLAT

FORM C-128
 Revised 5/1/57

SEE INSTRUCTIONS FOR COMPLETING THIS FORM ON THE REVERSE SIDE

SECTION A

Operator Lone Star Producing Co.		Lease Federal - N.M. "B"		Well No. 3
Unit Letter C	Section 28	Township 8 South	Range 36 East	County Roosevelt
Actual Footage Location of Well: 660' feet from the North line and 1,980' feet from the West line				
Ground Level Elev. 4,107.4'	Producing Formation Bough - Lime	Pool S. Prairie Pennsylvanian	Dedicated Acreage: 80 Acres	

1. Is the Operator the only owner in the dedicated acreage outlined on the plat below? YES ☒ NO ☐ "Owner" means the person who has the right to drill into and to produce from any pool and to appropriate the production either for himself or for himself and another. (65-3-29 (e) NMSA 1935 Comp.)
2. If the answer to question one is "no," have the interests of all the owners been consolidated by communitization agreement or otherwise? YES ☐ NO ☐ . If answer is "yes," Type of Consolidation _____
3. If the answer to question two is "no," list all the owners and their respective interests below:

Owner	Land Description

SECTION B

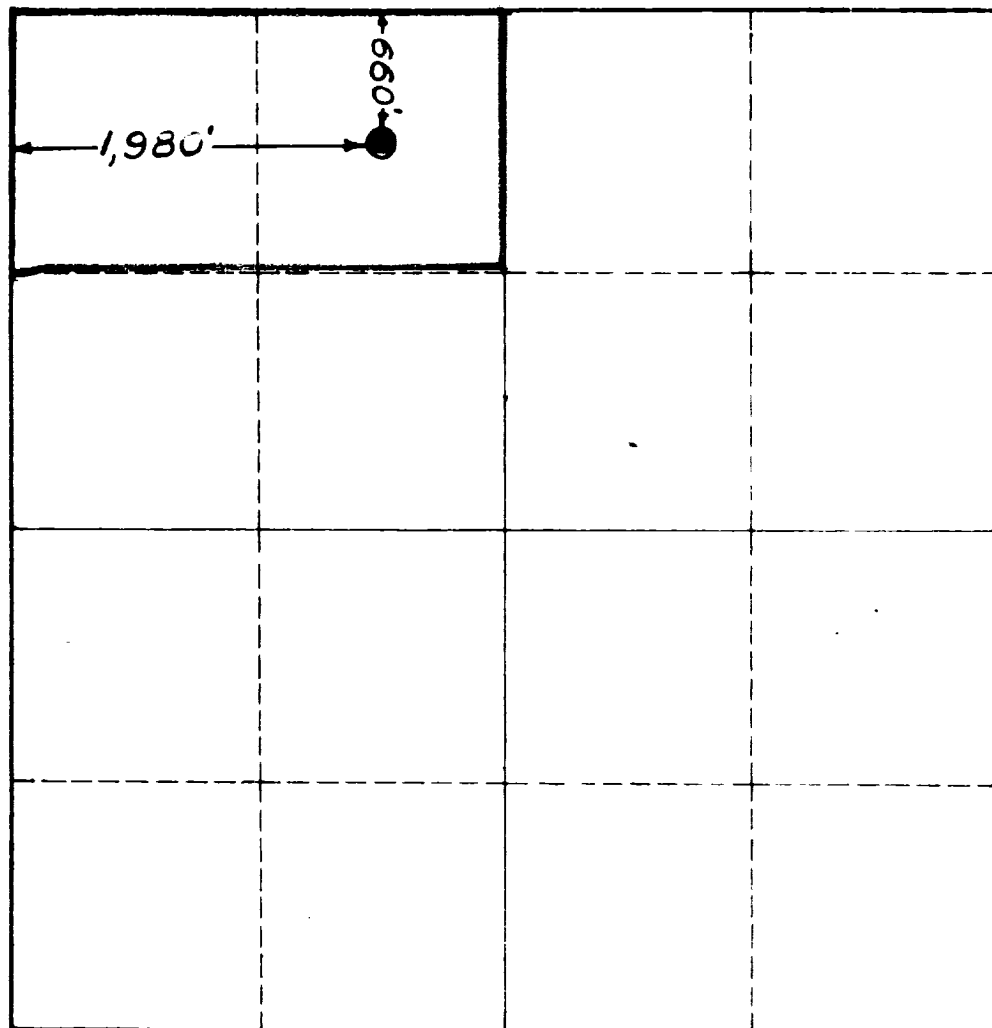

CERTIFICATION

I hereby certify that the information in SECTION A above is true and complete to the best of my knowledge and belief.

Name E. J. Sneed
 Position Dist. Production Supt.
 Company Lone Star Producing Co.
 Date January 7, 1961

I hereby certify that the well location shown on the plat in SECTION B was plotted from field notes or actual surveys made by me or under my supervision, and that the same is true and correct to the best of my knowledge and belief.

Date Surveyed January 7, 1961
 Registered Professional Engineer
 of Land Survey Wayne P. Bright

Certificate No. 3069

0 330 660 990 1320 1650 1980 2310 2640 2000 1500 1000 500 0