

NEW MEXICO OIL CONSERVATION COMMISSION
Santa Fe, New Mexico

Form C-101
Revised (12/1/55)

NOTICE OF INTENTION TO DRILL

Notice must be given to the District Office of the Oil Conservation Commission and approval obtained before drilling or recompletion begins. If changes in the proposed plan are considered advisable, a copy of this notice showing such changes will be returned to the sender. Submit this notice in **QUINTUPPLICATE**. One copy will be returned following approval. See additional instructions in Rules and Regulations of the Commission. If State Land submit 6 Copies Attach Form C- 128 in triplicate to first 3 copies of form C-101

Hobbs, New Mexico

April 22, 1957

(Place)

(Date)

OIL CONSERVATION COMMISSION
SANTA FE, NEW MEXICO

Gentlemen:

You are hereby notified that it is our intention to commence the Drilling of a well to be known as

Magnolia Petroleum Company

(Company or Operator)

A. R. Haley

(Lease)

Well No. **1**, in **P** The well is

(Unit)

located **660** feet from the **South** line and **660** feet from the

East

line of Section **13**, T. **8 S**, R. **34 E**, NMPM.

(GIVE LOCATION FROM SECTION LINE)

Wilkesand Bough

Pool,

Roosevelt

County

If State Land the Oil and Gas Lease is No.

If patented land the owner is **Joseph M. Isaman**

Address **Tatum, New Mexico**

We propose to drill well with drilling equipment as follows: **Rotary only**

The status of plugging bond is **On File**

Drilling Contractor **Magnolia Petroleum Company Rig #20**

Box 633

Midland, Texas

We intend to complete this well in the **Wolfcamp**

formation at an approximate depth of **9600'** feet.

CASING PROGRAM

We propose to use the following strings of Casing and to cement them as indicated:

Size of Hole	Size of Casing	Weight per Foot	New or Second Hand	Depth	Sacks Cement
12 1/4"	10 3/4"	32.75#	New	450'	450
9 5/8"	7 5/8"	24 & 26.4#	New	4850'	2500
6 3/4"	5 1/2" (14 new)	15.50	New	5000'	1500

If changes in the above plans become advisable we will notify you immediately.

ADDITIONAL INFORMATION (If recompletion give full details of proposed plan of work.)

Approved _____, 19____
Except as follows:

OIL CONSERVATION COMMISSION

By

E. Fischer

Sincerely yours,

Magnolia Petroleum Company

(Company or Operator)

By

W. H. Bough

Position

District Superintendent

Send Communications regarding well to

Name

Magnolia Petroleum Company

Address

Box 2406, Hobbs, New Mexico

NEW MEXICO
OIL CONSERVATION COMMISSION
Well Location and/or Gas Proration Plat

Form C-128

Date April 22, 1957

Operator Magnolia Petroleum Company Lease 02 A. R. Haley

Well No. One (1) Section 13 Township 8S Range 34E NMPM

Located 660 Feet From south Line, 660 Feet From east Line,

Roosevelt County, New Mexico. G. L. Elevation _____

Name of Producing Formation _____ Pool Milnesand Bough Dedicated Acreage _____

(Note: All distances must be from outer boundaries of Section)

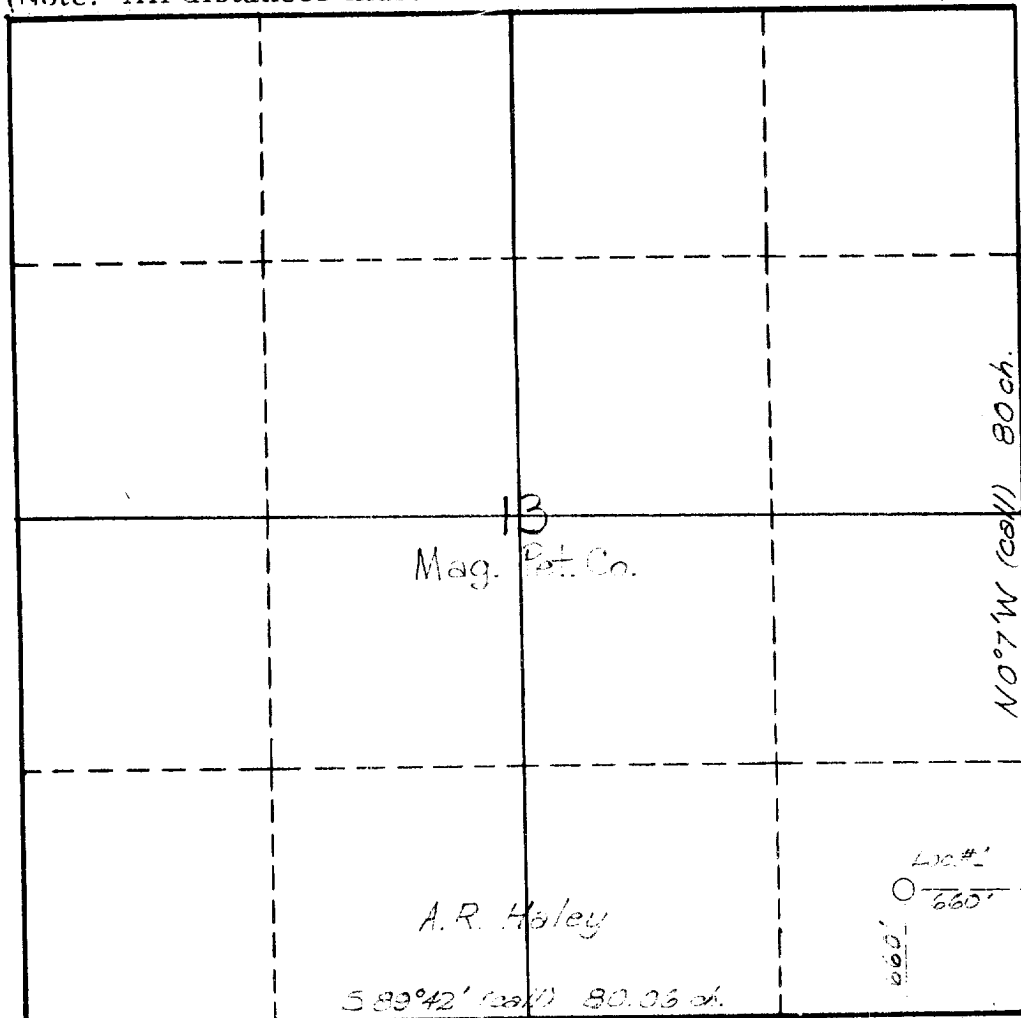

SCALE: 1"=1000'

1. Is this Well a Dual Comp.? Yes No .
2. If the answer to Question 1 is yes, are there any other dually completed wells within the dedicated acreage? Yes No .

This is to certify that the above plat was prepared from field notes of actual surveys made by me or under my supervision and that the same are true and correct to the best of my knowledge and belief.

Name W. D. Grew
Position District Superintendent
Representing Magnolia Petroleum Company
Address Box 2406, Hobbs, New Mexico

Date Surveyed 4-19-57
W. D. Grew
Registered Professional Engineer and/or
Land Surveyor #1415