

COUN ROOSEVELT FIELD *Chaveroo N STATE NM
 OPR YATES PET API 30-041-00145
 NO 1 LEASE Smith "ZJ" MAP
 Sec 11, T7S, R33E CO-ORD
 660 FSL, 660 FWL of Sec 7-2-29 NM
 16 mi SE/Elida Re SPD 4-11-84 Re MP 6-6-84

CSG

13 3/8-323-400 sx
 9 5/8-4415-2850 sx
 7 5/8-933-350 sx (Tieback)
 5 1/2-9301-1275 sx
 2 7/8-8300

WELL CLASS: INITWDX FIN*WDDLSE. CODE

FORMATION	DATUM	FORMATION	DATUM
TD 10,016 (PCMB)		PBD	8610

IP (*Permo-Pennsylvanian) Perfs 8238-8256 P 70 BOPD + 160 BW.
 Pot based on 24 hr test. GOR 271; gty 40

CONTR OPRSELEV 4328 GR SUBS

7-14-84 F.R. 4-2-84 OWWO
 PD 9300 WO (*Permo-Pennsylvanian)
 (Orig. Magnolia Petroleum, 1 Smith, A.K.,
 D&A 12-15-48, OTD 10,016)
 AMEND FIELD & ZONE: Formerly Wildcat
 (Mississippian)
 4-24-84 TD 10,016; PBD 9301; Rng Logs
 DO to 933
 Ran 7 5/8 tieback csg
 DO to 9301
 No DST's
 5-1-84 TD 10,016; PBD 9301; WOCT
 Ran 5 1/2 Csg
 7-9-84 TD 10,016; PBD 8610; Complete
 PB to 8610
 Perf (Bough A) 8238-8256 w/12 shots
 Acid (8238-8256) 2000 gals (15%)

7-2-29 NM

ROOSEVELT
YATES PET

*Chaveroo N
1 Smith "ZJ"
Sec 11, T7S, R33E

NM
Page 2

7-9-84

Continued

*Permo-Pennsylvanian discovery in the
Chaveroo N Field

LOG TOPS: (Not previously reported)
San Andres 4488, Abo 6898, Wolfcamp 7800,
Bough A 8220, Cisco 8468, Canyon 8692,
Mississippian 9317
LOGS RUN: CNL, FDC, DLL

*Denotes changes & additions

7-14-84

COMPLETION ISSUED

9-7-85

RE-ISSUED COMPLETION: Formerly Undesignated, DO
&(Wolfcamp "PK") 7-2-29 NM
IC 30-041-70010-84

All distances must be from the outer boundaries of the Section.

Operator Yates Petroleum Corporation			Lease Smith "ZJ"		Well No. 1
Unit Letter M	Section 11	Township 7 South	Range 33 East	County Roosevelt	
Actual Footage Location of Well: 660 feet from the South line and 660 feet from the West line					
Ground Level Elev. 4328' GL	Producing Formation Wolfcamp		Pool North Chaveroo Permo-Pennsylvanian	Dedicated Acreage: 160 Acres	

1. Outline the acreage dedicated to the subject well by colored pencil or hachure marks on the plat below.
2. If more than one lease is dedicated to the well, outline each and identify the ownership thereof (both as to working interest and royalty).
3. If more than one lease of different ownership is dedicated to the well, have the interests of all owners been consolidated by communitization, unitization, force-pooling, etc?

☐ Yes ☐ No If answer is "yes," type of consolidation _____

If answer is "no," list the owners and tract descriptions which have actually been consolidated. (Use reverse side of this form if necessary.) _____

No allowable will be assigned to the well until all interests have been consolidated (by communitization, unitization, forced-pooling, or otherwise) or until a non-standard unit, eliminating such interests, has been approved by the Division

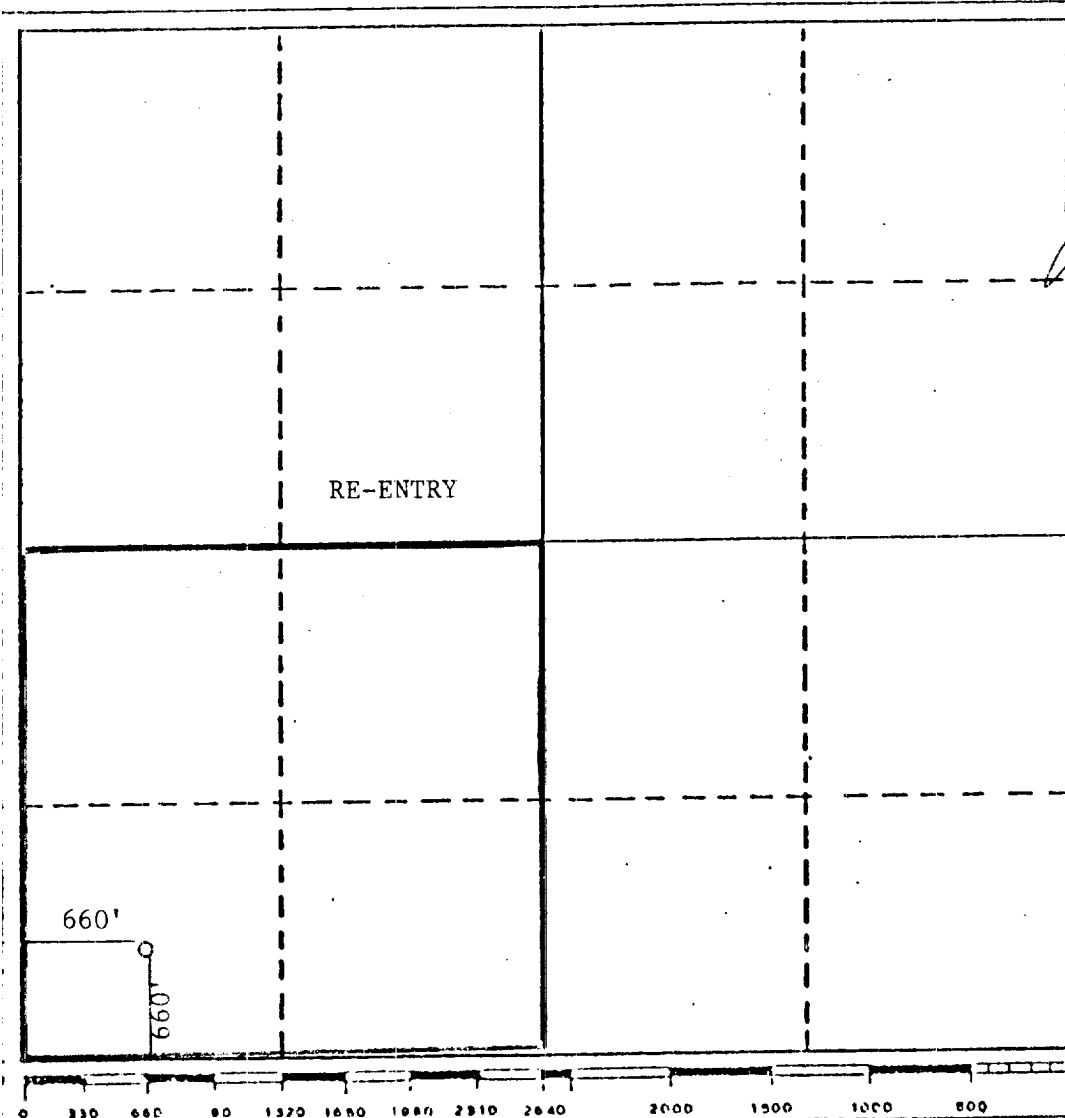

CERTIFICATION

I hereby certify that the information contained herein is true and complete to the best of my knowledge and belief.

Juanita Goodlett
Name
Juanita Goodlett

Position
Production Supervisor

Company
Yates Petroleum Corporation

Date
9-10-84

I hereby certify that the well location shown on this plat was plotted from field notes of actual surveys made by me or under my supervision, and that the same is true and correct to the best of my knowledge and belief.

Refer to original plat

Date Surveyed

Registered Professional Engineer
and/or Land Surveyor

Certificate No.

RECEIVED

SEP 12 1984

G.C.D.
HOBBS OFFICE