

NEW MEXICO OIL CONSERVATION COMMISSION  
Santa Fe, New Mexico

Form C-101  
Revised (12/1/55)

NOTICE OF INTENTION TO DRILL

Notice must be given to the District Office of the Oil Conservation Commission and approval obtained before drilling or recompletion begins. If changes in the proposed plan are considered advisable, a copy of this notice showing such changes will be returned to the sender. Submit this notice in **QUINTUPLICATE**. One copy will be returned following approval. See additional instructions in Rules and Regulations of the Commission. If State Land submit 6 Copies Attach Form C- 128 in triplicate to first 3 copies of form C-101

Roswell, New Mexico

March 9, 1962

(Place)

(Date)

OIL CONSERVATION COMMISSION  
SANTA FE, NEW MEXICO

Gentlemen:

You are hereby notified that it is our intention to commence the Drilling of a well to be known as

**Nearburg & Ingram**

(Company, or Operator)

**LPG**

(Lease)

Well No. **1**, in **E** (Unit)

located **2175** feet from the **North** line and **250** feet from the

**West**

line of Section **14**, T. **8-S**, R. **36-E**, NMPM.

(GIVE LOCATION FROM SECTION LINE) **Undesignated** Pool, **Roosevelt** County

If State Land the Oil and Gas Lease is No.

If patented land the owner is **J. C. Alnsworth (Minerals)**

Address **Milnesand, New Mexico**

We propose to drill well with drilling equipment as follows:

**Rotary tools from surface to total depth**

The status of plugging bond is **Statewide**

Drilling Contractor **Pioneer Well Services**

We intend to complete this well in the **Salado** formation at an approximate depth of **2800** feet.

**CASING PROGRAM**

We propose to use the following strings of Casing and to cement them as indicated:

Size of Hole	Size of Casing	Weight per Foot	New or Second Hand	Depth	Sacks Cement
17"	13-3/8"	48#	New	30'	15
12"	9-5/8"	36#	New	2350' *	Circulate
		* In top of salt			

If changes in the above plans become advisable we will notify you immediately.

ADDITIONAL INFORMATION (If recompletion give full details of proposed plan of work.)

To be used as **LPG** storage for **Nearburg & Ingram Bluit Gasoline Plant**, located in **SE/4 NE/4** of Section **15-8S-36E**.

All oil and gas lessors within one-half mile of proposed location have been notified.

Sincerely yours,

**Nearburg & Ingram**

(Company or Operator)

By *John D. Ingram*

**Partner**

Position **Send Communications regarding well to**

Name **Nearburg & Ingram**

Address **P.O. Box 1757 - Roswell, New Mexico**

OIL CONSERVATION COMMISSION

By *John D. Ingram*

FORM NO. 1-62	
DISTRIBUTION	
FILE	
U.S.S.	
LAND OFFICE	
TRANSPORTER	OIL GAS
PRODUCTION OFFICE	
OPERATOR	

# NEW MEXICO OIL CONSERVATION COMMISSION

FORM C-128  
Revised 5/1/57

## WELL LOCATION AND ACREAGE DEDICATION PLAT

SEE INSTRUCTIONS FOR COMPLETING THIS FORM ON THE REVERSE SIDE

### SECTION A

Operator Nearburg & Ingram			Lease LPG		Well No. 1
Unit Letter E	Section 15	Township 8-S	Range 36-E	County Roosevelt	
Actual Footage Location of Well: 2175 feet from the north line and 250 feet from the west line					
Ground Level Elev.	Producing Formation Salado	Pool Undesignated		Dedicated Acreage: Acres	

1. Is the Operator the only owner in the dedicated acreage outlined on the plat below? YES ☒ NO \_\_\_\_ . ("Owner" means the person who has the right to drill into and to produce from any pool and to appropriate the production either for himself or for himself and another. (65-3-29 (e) NMSA 1935 Comp.)
2. If the answer to question one is "no," have the interests of all the owners been consolidated by communitization agreement or otherwise? YES \_\_\_\_ NO \_\_\_\_ . If answer is "yes," Type of Consolidation \_\_\_\_
3. If the answer to question two is "no," list all the owners and their respective interests below:

Owner	Land Description

### SECTION B

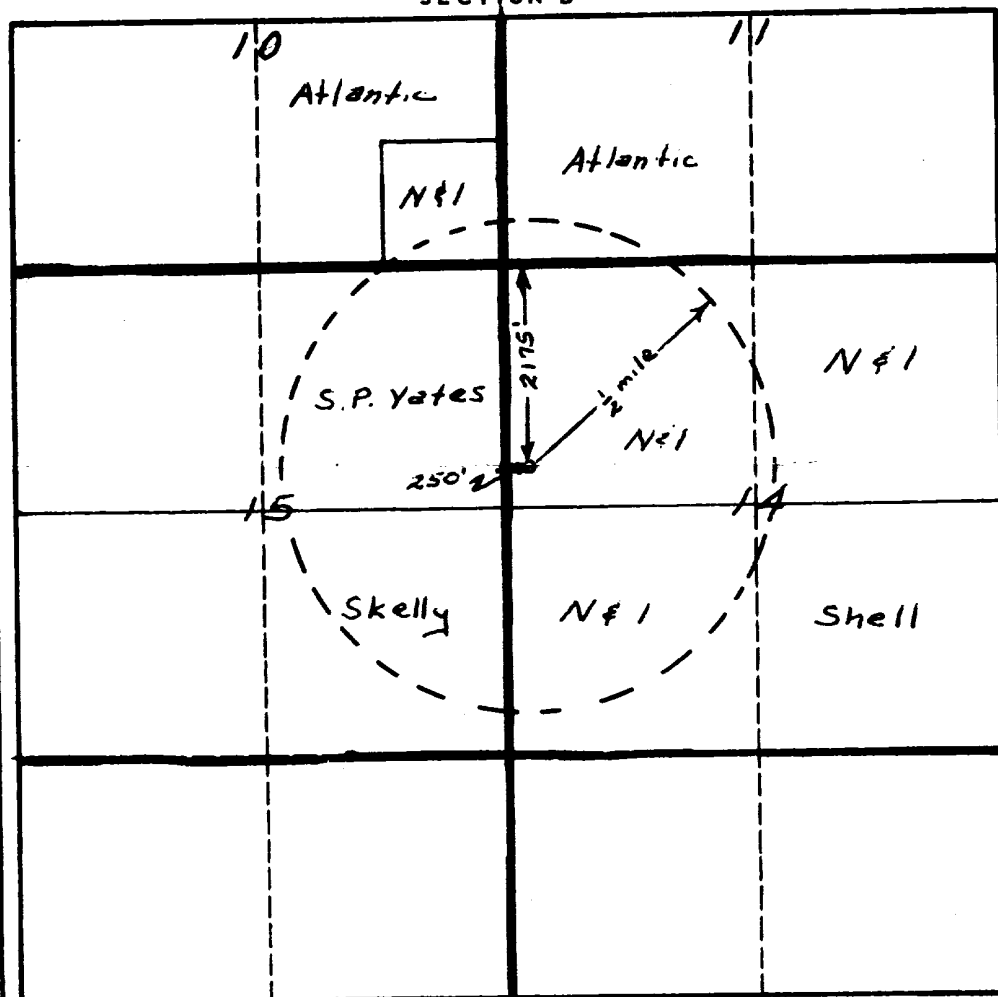

### CERTIFICATION

I hereby certify that the information in SECTION A above is true and complete to the best of my knowledge and belief.

*Tom Ingram*

Name	Partner
Position	Nearburg & Ingram
Company	March 9, 1962
Date	

I hereby certify that the well location shown on the plat in SECTION B was plotted from field notes of actual surveys made by me or under my supervision, and that the same is true and correct to the best of my knowledge and belief.

Date Surveyed	
Registered Professional Engineer and/or Land Surveyor	
Certificate No.	

0 330 660 990 1320 1650 1980 2310 2640 2000 1500 1000 500 0