

(SUBMIT IN TRIPLICATE) **NOB35**

UNITED STATES
DEPARTMENT OF THE INTERIOR
GEOLOGICAL SURVEY

Land Office **New Mexico**
Lease No. **02218**
Unit **7**

RECEIVED
SEP 19 1960

SUNDRY NOTICES AND REPORTS ON WELLS

NOTICE OF INTENTION TO DRILL	<input checked="" type="checkbox"/>	SUBSEQUENT REPORT OF WATER SHUT-OFF	<input type="checkbox"/>
NOTICE OF INTENTION TO CHANGE PLANS <u>LOCATION</u>	<input checked="" type="checkbox"/>	SUBSEQUENT REPORT OF SHOOTING OR ACIDIZING	<input type="checkbox"/>
NOTICE OF INTENTION TO TEST WATER SHUT-OFF	<input type="checkbox"/>	SUBSEQUENT REPORT OF ALTERING CASING	<input type="checkbox"/>
NOTICE OF INTENTION TO RE-DRILL OR REPAIR WELL	<input type="checkbox"/>	SUBSEQUENT REPORT OF RE-DRILLING OR REPAIR	<input type="checkbox"/>
NOTICE OF INTENTION TO SHOOT OR ACIDIZE	<input type="checkbox"/>	SUBSEQUENT REPORT OF ABANDONMENT	<input type="checkbox"/>
NOTICE OF INTENTION TO PULL OR ALTER CASING	<input type="checkbox"/>	SUPPLEMENTARY WELL HISTORY	<input type="checkbox"/>
NOTICE OF INTENTION TO ABANDON WELL	<input type="checkbox"/>		

(INDICATE ABOVE BY CHECK MARK NATURE OF REPORT, NOTICE, OR OTHER DATA)

September 11, 19**60**

King-Davis Federal

Well No. **2** is located **1980** ft. from **[N]** line and **1980** ft. from **[E]** line of sec. **28**

SE 1/4 NW 1/4 Sec. 28
(1/4 Sec. and Sec. No.)

88
(Twp.)

37E
(Range)

(Meridian)

Blair-Penn
(Field)

Roosevelt

(County or Subdivision)

New Mexico
(State or Territory)

The elevation of the derrick floor above sea level is _____ ft.

DETAILS OF WORK

(State names of and expected depths to objective sands; show sizes, weights, and lengths of proposed casings; indicate mudding jobs, cementing points, and all other important proposed work)

Plan to drill a Bough "C" well to a depth of approximately 9,700'. The pipe program is as follows:

13-3/8" to be set at approximately 350' with sufficient cement to circulate to surface.

9-5/8" to be set at approximately 4200' with sufficient cement to circ. to surface.

5-1/2" to be set at approximately 9650' with sufficient cement to obtain 1000' fill.

All casing will be set & cemented in accordance with approved methods.

I understand that this plan of work must receive approval in writing by the Geological Survey before operations may be commenced.

Company **THE OHIO OIL COMPANY**

Address **Box 2107**

Hobbs, New Mexico

By **B. Z. Walters**

Title **Superintendent**

DISTRIBUTION:

U.S.G.S.

Carl B. King

Roger H. Davis

J. A. Grimes

L. H. Shearer

D. V. Kitley

T. A. Steele

T. O. Webb

R. E. Feather

C. M. Lynch

NEW MEXICO OIL CONSERVATION COMMISSION
WELL LOCATION AND ACREAGE DEDICATION PLAT

FORM C-128
 Revised 5/1/57

SEE INSTRUCTIONS FOR COMPLETING THIS FORM ON THE REVERSE SIDE

SECTION A

Operator OHIO OIL COMPANY			Lease KING-DAVIS		Well No. 2
Unit Letter F	Section 28	Township 8 S	Range 37 E	County ROOSEVELT	
Actual Footage Location of Well: 1980 feet from the NORTH line and 1980 feet from the WEST line					
Ground Level Elev.	Producing Formation Bough "C"		Pool Bluitt-Pennsylvanian		Dedicated Acreage: 80 Acres

1. Is the Operator the only owner in the dedicated acreage outlined on the plat below? YES _____ NO **X**. ("Owner" means the person who has the right to drill into and to produce from any pool and to appropriate the production either for himself or for himself and another. (65-3-29 (e) NMSA 1935 Comp.)
2. If the answer to question one is "no," have the interests of all the owners been consolidated by communitization agreement or otherwise? YES **X** NO _____. If answer is "yes," Type of Consolidation **Operating Agreement**
3. If the answer to question two is "no," list all the owners and their respective interests below

Owner	Land Description
	SEP 19 1960 U. S. GEOLOGICAL SURVEY HOBBS, NEW MEXICO

SECTION B

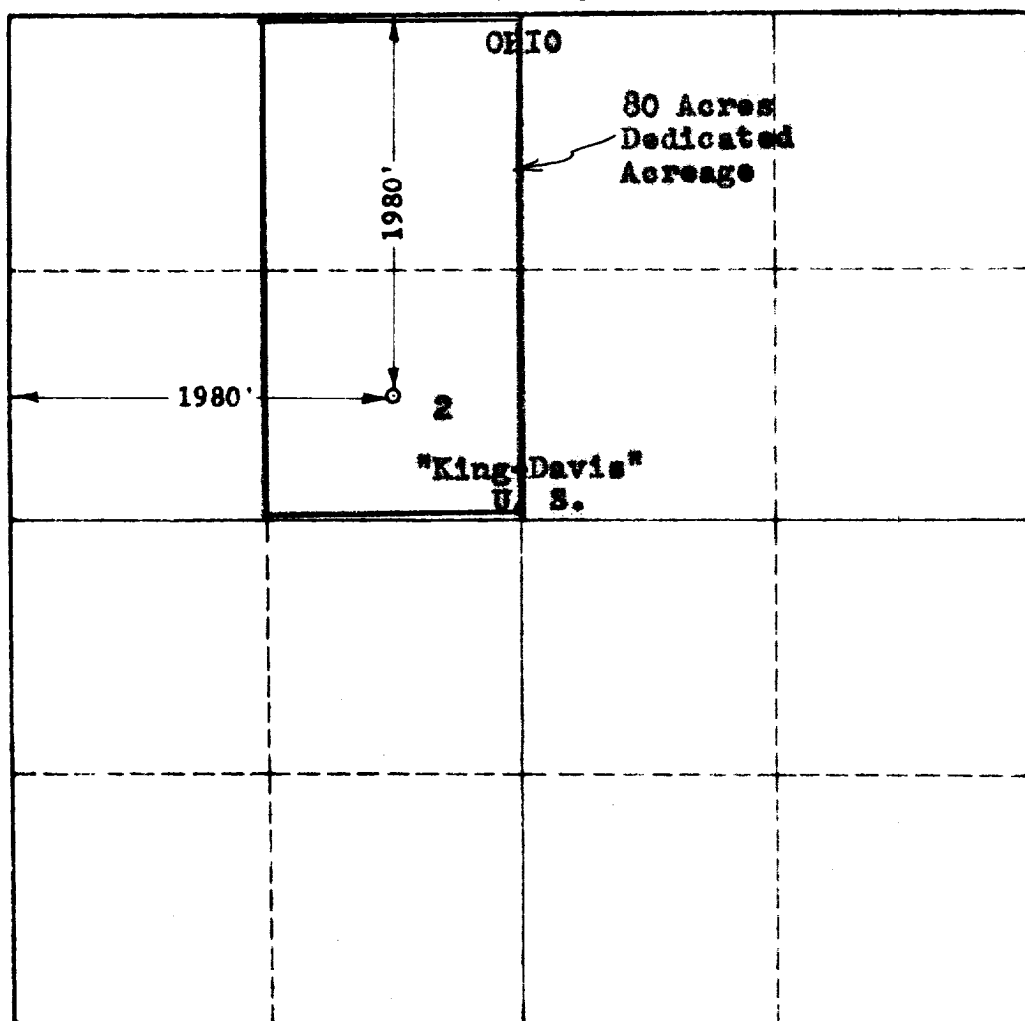

CERTIFICATION

I hereby certify that the information in SECTION A above is true and complete to the best of my knowledge and belief.

Name **T. O. Webb**
 Position **Area Petroleum Engineer**
 Company **The Ohio Oil Company**
 Date **9-16-60**

I hereby certify that the well location shown on the plat in SECTION B was plotted from field notes of actual surveys made by me or under my supervision, and that the same is true and correct to the best of my knowledge and belief.

Date Surveyed **SEP 16 1960**
 Registered Professional Engineer and Land Surveyor, **JOHN W. WEST**
 Certificate No. **676**
 N.M. & L.S. No. **578**
 JOHN W. WEST

0 330 660 990 1320 1650 1980 2310 2640 2000 1500 1000 500 0