

(File the original and 4 copies with the appropriate district office)

CERTIFICATE OF COMPLIANCE AND AUTHORIZATION  
TO TRANSPORT OIL AND NATURAL GAS

Company or Operator The Ohio Oil Company Lease W. A. Maupin Estate

Well No. 2 Unit Letter N S 18 T 8 S R 37 E Pool Blunit-Penn.

County Roosevelt Kind of Lease (State, Fed. or Patented) Patented

If well produces oil or condensate, give location of tanks: Unit F S 19 T 8 S R 37 E

Authorized Transporter of Oil or Condensate McWood Corporation

Address 701 V & J Tower Building, Midland, Texas  
(Give address to which approved copy of this form is to be sent)

Authorized Transporter of Gas None

Address \_\_\_\_\_  
(Give address to which approved copy of this form is to be sent)

If Gas is not being sold, give reasons and also explain its present disposition:

Gas is being flared. No pipeline connection.

Reasons for Filing: (Please check proper box) New Well ☒ (X)

Change in Transporter of (Check One): Oil ( ) Dry Gas ( ) C'head ( ) Condensate ( )

Change in Ownership ( ) Other ( )

Remarks: \_\_\_\_\_ (Give explanation below)

The undersigned certifies that the Rules and Regulations of the Oil Conservation Commission have been complied with.

Executed this the 29 day of August 19 60

Approved \_\_\_\_\_ 19 \_\_\_\_\_  
AUG 30 1960

OIL CONSERVATION COMMISSION

By \_\_\_\_\_

Title \_\_\_\_\_

By D. E. Morris

Title Ast. Superintendent

Company The Ohio Oil Company

Address P. O. Box 2107

Hobbs, New Mexico

**List:**

**H.M.C.C.**

**Mr. J. A. Grimes**  
**Mr. L. H. Shumaker**  
**Mr. D. V. Kitley**  
**Mr. T. A. Steele**  
**Mr. T. O. Webb**  
**Mr. R. L. Fox her**

## NEW MEXICO OIL CONSERVATION COMMISSION

FORM C-103  
(Rev 3-55)DUPLICATE  
(Submit to appropriate District Office as per Commission Rule 1106)

## MISCELLANEOUS REPORTS ON WELLS

HOURS OFFICE OCC

Name of Company <b>The Ohio Oil Company</b>		Address <b>Box 2107, Hobbs, New Mexico</b>				
Lease <b>W. A. Maupin</b>	Well No. <b>2</b>	Unit Letter <b>H</b>	Section <b>18</b>	Township <b>8 S</b>	Range <b>37 E</b>	
Date Work Performed <b>8-23-60</b>	Pool <b>Klutt-Penn.</b>	County <b>Roosevelt</b>				

THIS IS A REPORT OF: (Check appropriate block)

- ☐ Beginning Drilling Operations ☒ Casing Test and Cement Job ☐ Other (Explain):  
☐ Plugging ☐ Remedial Work

Detailed account of work done, nature and quantity of materials used, and results obtained.

23<sup>rd</sup> 26<sup>th</sup> 29<sup>th</sup> - N 50

Drilled 8 3/4" hole to 9504' T.D. Ran 224 Jts. 7" O.D. casing and set at 9472'. Cemented with 200 sacks Trinity Inferno with 3% gel. Top of cement at 8530' by Temp. Survey. W.O.C. 48 hours. Tested 7" casing with 1000# for 30 minutes, held OK.

Witnessed by <b>L. H. Davis</b>	Position <b>Drilling Foreman</b>	Company <b>The Ohio Oil Company</b>
------------------------------------	-------------------------------------	--

## FILL IN BELOW FOR REMEDIAL WORK REPORTS ONLY

## ORIGINAL WELL DATA

D F Elev.	T D	P BTD	Producing Interval	Completion Date
Tubing Diameter	Tubing Depth	Oil String Diameter	Oil String Depth	
Perforated Interval(s)				
Open Hole Interval		Producing Formation(s)		

## RESULTS OF WORKOVER

Test	Date of Test	Oil Production BPD	Gas Production MCFPD	Water Production BPD	GOR Cubic feet/Bbl	Gas Well Potential MCFPD
Before Workover						
After Workover						

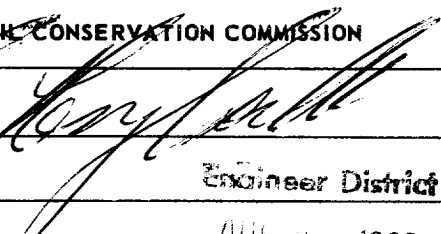
OIL CONSERVATION COMMISSION		I hereby certify that the information given above is true and complete to the best of my knowledge.	
Approved by 	Name <b>D. E. Morris</b>		
Title <b>Engineer District II</b>	Position <b>Asst. Superintendent</b>		
Date <b>NOV 10 1960</b>	Company <b>The Ohio Oil Company</b>		

**List:**

**N.H.D.C.C.**

**Mr. J. A. Graves**

**Mr. L. H. Shearer**

**Mr. D. V. Kitley**

**Mr. T. A. Steele**

**Mr. T. G. Webb**

**Mr. R. E. Feather**

**DUPLICATE**

NEW MEXICO OIL CONSERVATION COMMISSION

FORM C-103  
(Rev 3-55)

MISCELLANEOUS REPORTS ON WELLS

MISSISSIPPI OFFICE OCC

(Submit to appropriate District Office as per Commission Rule 1106)

Name of Company **THE OHIO OIL COMPANY** Address **1960 AUG 17 PM 2:24 Box 2107, Hobbs, New Mexico**

Lease **W. A. Maupin** Well No. **2** Unit Letter **M** Section **18** Township **8S** Range **37 E**

Date Work Performed **7-28-60** Pool **Bluitt-Penn.** County **Roosevelt**

THIS IS A REPORT OF: (Check appropriate block)

- ☐ Beginning Drilling Operations ☒ Casing Test and Cement Job ☐ Other (Explain):  
☐ Plugging ☐ Remedial Work

Detailed account of work done, nature and quantity of materials used, and results obtained.

Drilled 12 $\frac{1}{4}$ " hole to 4221'. Ran 104 jts 9-5/8" casing and set at 4220'. Cemented by 2 plug method with 1600 sxs Trinity Lite-Wate cement followed by 200 sxs Trinity regular with 3% gel. Cement circulated to surface. WOC 48 hours. Tested 9-5/8" casing with 1000# for 30 minutes. Held O.K.

Witnessed by **L. H. Davis** Position **Drilling Foreman** Company **THE OHIO OIL COMPANY**

FILL IN BELOW FOR REMEDIAL WORK REPORTS ONLY

ORIGINAL WELL DATA

D F Elev. TD P BTD Producing Interval Completion Date

Tubing Diameter Tubing Depth Oil String Diameter Oil String Depth

Perforated Interval(s)

Open Hole Interval Producing Formation(s)

RESULTS OF WORKOVER

Test	Date of Test	Oil Production BPD	Gas Production MCFPD	Water Production BPD	GOR Cubic feet/Bbl	Gas Well Potential MCFPD
Before Workover						
After Workover						

OIL CONSERVATION COMMISSION

I hereby certify that the information given above is true and complete to the best of my knowledge.

Approved by **[Signature]** Name **D. E. Morris**

Title **Engineer District V** Position **Asst. Supt.**

Date **AUG 18 1960** Company **THE OHIO OIL COMPANY**

**DISTRIBUTION:**

**WFOCC**

**Mr. J. A. Grimes**  
**Mr. L. H. Shearer**  
**Mr. D. V. Kitlay**  
**Mr. T. A. Steele**  
**Mr. T. O. Webb**  
**Mr. R. E. Feather**

## NEW MEXICO OIL CONSERVATION COMMISSION

FORM C-103  
(Rev 3-55)

## MISCELLANEOUS REPORTS ON WELLS

HOBBS OFFICE OCC

(Submit to appropriate District Office as per Commission Rule 1106)

Name of Company <b>The Ohio Oil Company</b>		Address <b>Box 2107, Hobbs, New Mexico</b>			
Lease <b>W. A. Maupin Estate</b>	Well No. <b>2</b>	Unit Letter <b>N</b>	Section <b>18</b>	Township <b>8 S</b>	Range <b>37 E</b>
Date Work Performed <b>7-20-60</b>	Pool <b>Bluitt - Penn.</b>	County <b>Roosevelt</b>			

THIS IS A REPORT OF: (Check appropriate block)

- ☐ Beginning Drilling Operations ☒ Casing Test and Cement Job ☐ Other (Explain):  
☐ Plugging ☐ Remedial Work

Detailed account of work done, nature and quantity of materials used, and results obtained.

Spudded 17 1/2" hole at 5:00 PM, 7-19-60. Drilled to 420'. Ran 10 fts., 13 3/8", 48# casing and set at 417'. Cemented by 2-plug method with 350 sacks Trinity regular with 3% gel. Cement circulated to surface. W.O.C. 2 1/2 hours. Tested 13 3/8" casing with 1000# for 30 minutes. Held OK. Drilling ahead.

Witnessed by	Position	Company
--------------	----------	---------

## FILL IN BELOW FOR REMEDIAL WORK REPORTS ONLY

## ORIGINAL WELL DATA

D F Elev.	T D	P BTD	Producing Interval	Completion Date
Tubing Diameter	Tubing Depth	Oil String Diameter	Oil String Depth	
Perforated Interval(s)				
Open Hole Interval		Producing Formation(s)		

## RESULTS OF WORKOVER

Test	Date of Test	Oil Production BPD	Gas Production MCFPD	Water Production BPD	GOR Cubic feet/Bbl	Gas Well Potential MCFPD
Before Workover						
After Workover						

## OIL CONSERVATION COMMISSION

I hereby certify that the information given above is true and complete to the best of my knowledge.

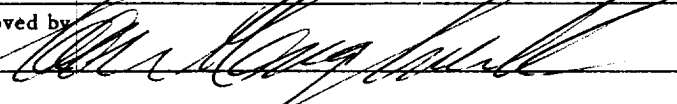
Approved by 	Name <b>R. E. Morris</b>
Title <b>Engineer District I</b>	Position <b>Asst. Superintendent</b>
Date <b>AUG 3 1960</b>	Company <b>The Ohio Oil Company</b>

**Dist:**

**N.M.O.C.C.**

**Mr. J. A. Grimes**

**Mr. L. H. Shearer**

**Mr. D. V. Kitley**

**Mr. T. A. Steele**

**Mr. C. M. Lynch**

**Mr. T. O. Webb**

**Mr. R. E. Feather**



## NEW MEXICO OIL CONSERVATION COMMISSION

FORM C-103  
(Rev 3-55)

## MISCELLANEOUS REPORTS ON WELLS

HOBBS OFFICE 000

(Submit to appropriate District Office as per Commission Rule 1106)

Name of Company <b>The Ohio Oil Company</b>		Address <b>Box 2107, Hobbs, New Mexico</b>				
Lease <b>W. A. Maupin Estate</b>	Well No. <b>2</b>	Unit Letter <b>N</b>	Section <b>18</b>	Township <b>8 S</b>	Range <b>37 E</b>	
Date Work Performed <b>7-20-60</b>	Pool <b>Bluff-Penn.</b>	County <b>Roosevelt</b>				

THIS IS A REPORT OF: (Check appropriate block)

- ☐ Beginning Drilling Operations ☒ Casing Test and Cement Job ☐ Other (Explain):  
☐ Plugging ☐ Remedial Work

Detailed account of work done, nature and quantity of materials used, and results obtained.

Spudded 17 1/2" hole at 5:00 PM, 7-19-60. Drilled to 420'. Ran 10 Jts., 13 3/8", 48# casing and set at 417'. Cemented by 2-plug method with 350 sacks Trinity regular with 3% gel. Cement circulated to Surface. W.O.C. 24 hrs. Tested 13 3/8" casing with 1000# for 30 minutes, held OK. Drilling ahead.

Witnessed by	Position	Company
--------------	----------	---------

## FILL IN BELOW FOR REMEDIAL WORK REPORTS ONLY

## ORIGINAL WELL DATA

D F Elev.	T D	P B T D	Producing Interval	Completion Date
Tubing Diameter	Tubing Depth	Oil String Diameter	Oil String Depth	
Perforated Interval(s)				
Open Hole Interval		Producing Formation(s)		

## RESULTS OF WORKOVER

Test	Date of Test	Oil Production BPD	Gas Production MCFPD	Water Production BPD	GOR Cubic feet/Bbl	Gas Well Potential MCFPD
Before Workover						
After Workover						

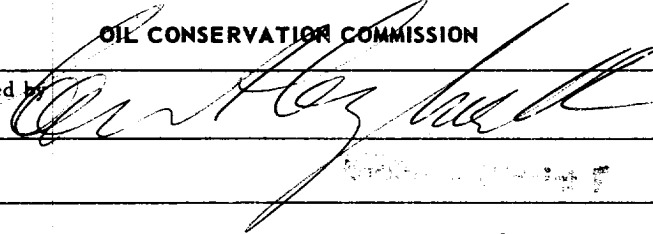
OIL CONSERVATION COMMISSION		I hereby certify that the information given above is true and complete to the best of my knowledge.	
Approved by 	Name <b>D. E. Morris</b>		
Title <b>Asst. Superintendent</b>	Position <b>Asst. Superintendent</b>		
Date <b>12-4</b>	Company <b>The Ohio Oil Company</b>		

Dist:

N.M.O.C.C.

Mr. J. A. Grimes

Mr. L. H. Shearer

Mr. D. V. Kitley

Mr. T. A. Steele

Mr. C. M. Lynch

Mr. T. O. Webb

Mr. R. E. Feather

DUPLICATE

NEW MICO OIL CONSERVATION COMM. ON  
Santa Fe, New Mexico

Form C-101  
Revised (12/1/55)

## NOTICE OF INTENTION TO DRILL

Notice must be given to the District Office of the Oil Conservation Commission and approval obtained before drilling or recompletion begins. If changes in the proposed plan are considered advisable, a copy of this notice showing such changes will be returned to the sender. Submit this notice in QUINTUPPLICATE. One copy will be returned following approval. See additional instructions in Rules and Regulations of the Commission. If State Land submit 6 Copies Attach Form C-128 in triplicate to first 3 copies of form C-101

Hobbs, New Mexico

July 8, 1960

(Place)

(Date)

OIL CONSERVATION COMMISSION  
SANTA FE, NEW MEXICO

Gentlemen:

You are hereby notified that it is our intention to commence the Drilling of a well to be known as

**THE OHIO OIL COMPANY**

(Company or Operator)

**W. A. Maupin Estate**

(Lease)

Well No. **2**

in **N**

The well is

located **660**

feet from the **south**

line and **1980**

feet from the

**west**

line of Section **18**

T. **8S**

R. **37 E**

NMPM.

(GIVE LOCATION FROM SECTION LINE)

**Blount Penn**

Pool,

**Roosevelt**

County

If State Land the Oil and Gas Lease is No.

If patented land the owner is **W. A. Maupin Estate**

Address **c/o Helen L. Maupin, Illinois State Bank of Quincy,**

**Quincy, Illinois**

We propose to drill well with drilling equipment as follows:

**Rotary tools**

The status of plugging bond is **Current**

Drilling Contractor **A. W. Thompson, Inc.**

**Midland, Texas**

We intend to complete this well in the **Bough "C"**

formation at an approximate depth of **9,600'**

feet.

### CASING PROGRAM

We propose to use the following strings of Casing and to cement them as indicated:

Size of Hole	Size of Casing	Weight per Foot	New or Second Hand	Depth	Sacks Cement
17-1/2"	13-3/8"	48#	New	350'	350
12-1/4"	9-5/8"	36# & 40#	"	4,200'	1900
8-3/4"	7"	23, 26 & 29#	"	9,600	1800

If changes in the above plans become advisable we will notify you immediately.

ADDITIONAL INFORMATION (If recompletion give full details of proposed plan of work.)

JUL 10 1960

Approved....., 19.....  
Except as follows:

Sincerely yours,

**THE OHIO OIL COMPANY**

(Company or Operator)

Original Signed By

By **R. G. HOWARD**

Position **Superintendent**

Send Communications regarding well to

Name **The Ohio Oil Company**

Address **Box 2107, Hobbs, New Mexico**

OIL CONSERVATION COMMISSION

By **Fred C. Clemente**

OIL & GAS

**DISTRIBUTION:**

**WMOCC**

**Mr. J. A. Grimes**  
**Mr. L. H. Shearer**  
**Mr. D. V. Kitley**  
**Mr. T. A. Steele**  
**Mr. C. M. Lynch**  
**Mr. T. O. Webb**  
**Mr. R. E. Feather**

# DUPLICATE

## NEW MEXICO OIL CONSERVATION COMMISSION WELL LOCATION AND ACREAGE DEDICATION PLAT

FORM C-128  
Revised 5/1/57

SEE INSTRUCTIONS FOR COMPLETING THIS FORM ON THE REVERSE SIDE

### SECTION A

Operator <b>Ohio Oil Co.</b>		Lease <b>W. A. Maupin Estate</b>		Well No. <b>2</b>
Unit Letter <b>N</b>	Section <b>18</b>	Township <b>8 S</b>	Range <b>37 E</b>	County <b>Roosevelt</b>
Actual Footage Location of Well: <b>1980</b> feet from the <b>West</b> line and <b>660</b> feet from the <b>South</b> line				
Ground Level Elev.	Producing Formation <b>Bough "C"</b>	Pool <b>Bluitt-Pennsylvanian</b>	Dedicated Acreage: <b>80</b> Acres	

1. Is the Operator the only owner in the dedicated acreage outlined on the plat below? YES ☒ NO ☐ ("Owner" means the person who has the right to drill into and to produce from any pool and to appropriate the production either for himself or for himself and another. (65-3-29 (e) NMSA 1935 Comp.)
2. If the answer to question one is "no," have the interests of all the owners been consolidated by communitization agreement or otherwise? YES ☐ NO ☐ If answer is "yes," Type of Consolidation \_\_\_\_\_
3. If the answer to question two is "no," list all the owners and their respective interests below:

Owner	Land Description

### SECTION B

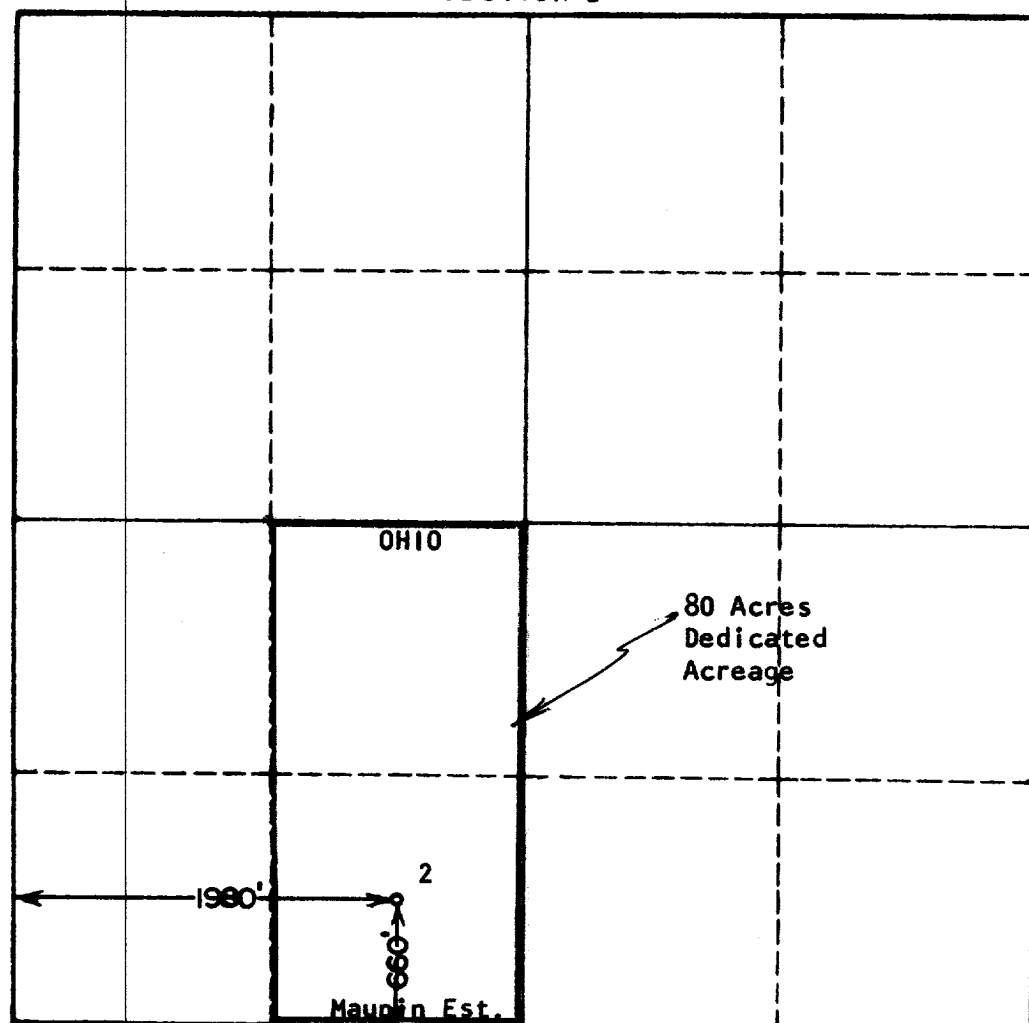

### CERTIFICATION

I hereby certify that the information in SECTION A above is true and complete to the best of my knowledge and belief.

*[Signature]*

Name	<b>T. O. Webb</b>
Position	<b>Area Petroleum Engineer</b>
Company	<b>The Ohio Oil Company</b>
Date	<b>July 11, 1960</b>

I hereby certify that the well location shown on the plat in SECTION B was plotted from field notes of actual surveys made by me or under my supervision, and that the same is true and correct to the best of my knowledge and belief.

**PROF. ENGINEER & LAND SURVEYOR**  
**STATE OF NEW MEXICO**

Date Surveyed  
**July 6, 1960**

Registered Professional Engineer  
and/or Land Surveyor  
**JOHN A. WEST**

Certificate No.  
**N.M. - P.E. & L.S. NO. 676**