

NEW MEXICO OIL CONSERVATION COMMISSION
SANTA FE, NEW MEXICO

Form C-110
Revised 7/1/55

(File the original and 4 copies with the appropriate district office)

CERTIFICATE OF COMPLIANCE AND AUTHORIZATION
TO TRANSPORT OIL AND NATURAL GAS

Company or Operator Shell Oil Company Lease Matthews
Well No. 1 Unit Letter H S 19 T 8S R 37E Pool Huitt-Pennsylvanian
County Roosevelt Kind of Lease (State, Fed. or Patented) Patented
If well produces oil or condensate, give location of tanks: Unit H S 19 T 8S R 37E
Authorized Transporter of Oil or Condensate Melwood Corporation
Address 701 V & J Tower Building, Midland, Texas
(Give address to which approved copy of this form is to be sent)
Authorized Transporter of Gas none
Address _____ Date Connected _____
(Give address to which approved copy of this form is to be sent)
If Gas is not being sold, give reasons and also explain its present disposition:
Gas being vented, no pipeline connection available.

Reasons for Filing: (Please check proper box) New Well ()
Change in Transporter of (Check One): Oil () Dry Gas () C'head () Condensate ()
Change in Ownership () Other (x)
Remarks: _____ (Give explanation below)

**x Change in pool designation from undesignated to Huitt-Pennsylvanian
as per NMOCC Order R-1611.**

The undersigned certifies that the Rules and Regulations of the Oil Conservation Commission have been complied with.

Executed this the 9th day of March 19 60

Approved _____ 19 _____

OIL CONSERVATION COMMISSION

By [Signature]
Title Engineer District

By R. A. Lowery Original Signed By R. A. LOWERY

Title District Exploitation Engineer

Company Shell Oil Company

Address Box 845

Roswell, New Mexico

OIL CONSERVATION COMMISSION
HOBBS, NEW MEXICO

March 3, 1960

Shell Oil Company
Post Office Box 845
Roswell, New Mexico

SUBJECT: Undesignated Well
Placed in Pool

Gentlemen:

In accordance with the provisions of Commission Order No. R- 1611,
your Matthews No. 1 oil well in Unit H of
Section 19, Township 8 South, Range 37 East, currently listed
in the Undesignated Section of the Proration Schedule, will
appear in the BLUITT-PENNSYLVANIAN Pool in the
APRIL Schedule.

Please file Form C-110 with this office showing the change in pool
designation.

Yours very truly,

OIL CONSERVATION COMMISSION

Joe D. Ramey
Proration Manager

JDR:mg
Copy to
NMOCC Nomenclature - Santa Fe

R-37-E

AREA 640 ACRES
LOCATE WELL CORRECTLY

NEW MEXICO OIL CONSERVATION COMMISSION
Santa Fe, New Mexico

DEPT. OF MINES OFFICE OCC
WELL RECORD
1960 FEB 10 AM 10:39

Mail to District Office, Oil Conservation Commission, to which Form C-101 was sent not later than twenty days after completion of well. Follow instructions in Rules and Regulations of the Commission. Submit in QUINTUPLICATE. If State Land submit 6 Copies

Shell Oil Company
(Company or Operator)

Matthews
(Lease)

Well No. 1, in SE $\frac{1}{4}$ of NE $\frac{1}{4}$, of Sec. 19, T. 8S, R. 37E, NMPM.
Huitt-Penn. Pool, Roosevelt County.
Well is 1960 feet from north line and 660 feet from east line
of Section 19. If State Land the Oil and Gas Lease No. is -
Drilling Commenced December 23, 19 59. Drilling was Completed January 30, 19 60
Name of Drilling Contractor A. W. Thompson
Address Room 214, Midland National Bank Building, Midland, Texas
Elevation above sea level at Top of Tubing Head 4039'. The information given is to be kept confidential until not confidential, 19 -

OIL SANDS OR ZONES

No. 1, from 9490' to 9500' No. 4, from - to -
No. 2, from - to - No. 5, from - to -
No. 3, from - to - No. 6, from - to -

IMPORTANT WATER SANDS

Include data on rate of water inflow and elevation to which water rose in hole.

No. 1, from - to - feet.
No. 2, from - to - feet.
No. 3, from - to - feet.
No. 4, from - to - feet.

CASING RECORD

SIZE	WEIGHT PER FOOT	NEW OR USED	AMOUNT	KIND OF SHOE	CUT AND PULLED FROM	PERFORATIONS	PURPOSE
13 3/8"	48#	new	366'				Surface String
8 5/8"	32#	new	4096'				Salt String
5 1/2"	15.5# & 17#	new	9588'	Larkin Float		9490' - 9500'	Oil String

MUDDING AND CEMENTING RECORD

SIZE OF HOLE	SIZE OF CASING	WHERE SET	NO. SACKS OF CEMENT	METHOD USED	MUD GRAVITY	AMOUNT OF MUD USED
17"	13 3/8"	380'	375	Pump & Plug	Cemented to surface	
11"	8 5/8"	4108'	800	Pump & Plug	Cemented to surface	
7 7/8"	5 1/2"	9600'	200	Pump & Plug		

RECORD OF PRODUCTION AND STIMULATION

(Record the Process used, No. of Qts. or Gals. used, interval treated or shot.)

Perforated 9490' - 9500' 4/2-1/2" jet shots per foot.

Result of Production Stimulation On OPT flowed 383 BOPD, no water, (based on 287 BO in 18 hours) thru 16/64" choke. FTP 875 psi. FCP 350 psi.
Depth Cleaned Out 9557'

RECORD OF DRILL-STEM AND SPECIAL TESTS

If drill-stem or other special tests or deviation surveys were made, submit report on separate sheet and attach hereto

TOOLS USED

Rotary tools were used from 0 feet to 9600 feet, and from feet to feet.
Cable tools were used from feet to feet, and from feet to feet.

PRODUCTION

Put to Producing February 6, 1960
OIL WELL: The production during the first 24 hours was 383 barrels of liquid of which 100 % was oil; % was emulsion; % water; and % was sediment. A.P.I. Gravity 50.5 deg.
GAS WELL: The production during the first 24 hours was M.C.F. plus barrels of liquid Hydrocarbon. Shut in Pressure lbs.
Length of Time Shut in

PLEASE INDICATE BELOW FORMATION TOPS (IN CONFORMANCE WITH GEOGRAPHICAL SECTION OF STATE):

Southeastern New Mexico		Northwestern New Mexico	
T. Anhy.	T. Devonian	T. Ojo Alamo	
T. Salt	T. Silurian	T. Kirtland-Fruitland	
B. Salt	T. Montoya	T. Farmington	
T. Yates 2772' (+1278')	T. Simpson	T. Pictured Cliffs	
T. 7 Rivers	T. McKee	T. Menefee	
T. Queen	T. Ellenburger	T. Point Lookout	
T. Grayburg	T. Gr. Wash.	T. Mancos	
T. San Andres 1000' (+50')	T. Granite	T. Dakota	
T. Glorieta	T. Base Red Beds 2240' (+1810')	T. Morrison	
T. Drinkard	T. Yesso 5142' (-1392')	T. Penn.	
T. Tubbs	T. Wolfcamp 8855' (-4805')		
T. Abo 7647' (-3597')	T. Bough 9472' (-5422')		
T. Penn 9409' (-5359')			
T. Miss.			

FORMATION RECORD

From	To	Thickness in Feet	Formation	From	To	Thickness in Feet	Formation
0	210	210	Surface sands & Caliche				
210	2240	2030	Red Beds				
2240	2680	440	Anhydrite & Salt				
2680	4000	1320	Anhydrite, Salt, Sand, Shale				
4000	4750	750	Anhydrite & Dolomite				
4750	5370	620	Dolomite, Sand, Shale				
5370	7690	2320	Dolomite, Shale				
7690	8370	680	Shale w/Dolomite				
8370	8650	280	Dolomite, Shale				
8650	8810	160	Dolomite, Limestone, Shale				
8810	9600	790	Limestone, Shale				
DST # 1: 9486' - 9576' (90' Pennsylvanian). Tool open 1 hour 55 minutes. Gas to surface 5 minutes. Mud to surface 25 minutes. Oil to surface 33 minutes. Cleaned to pits 22 minutes. Flowed 38.1 BO + 9.2 BW in 1 hour through 1/2" choke. GOR 1300. Gr. 49 deg. API. FSP 0 - 25 psi. Reversed out 5.2 BO. Recovered 340' (1.6 bbls.) salt water below circulating sub. Recovered water titrated 87,000 ppmCl ⁻ . Pit mud titrated 132,000 ppmCl ⁻ . 60 minutes IBHP 2923 psi. FBHP 1055 - 2185 psi. 75 minutes FS IBHP 2923 psi. HMH 5195 - 5175 psi. BHT 110 deg. Conclusive Test. (HMC)							

ATTACH SEPARATE SHEET IF ADDITIONAL SPACE IS NEEDED

I hereby swear or affirm that the information given herewith is a complete and correct record of the well and all work done on it so far as can be determined from available records.

February 9, 1960 (Date)
Company or Operator Shell Oil Company Address Box 345, Roswell, New Mexico
Name R. A. Lowery Original Signed By R. A. LOWERY Position or Title District Exploitation Engineer

NEW MEXICO OIL CONSERVATION COMMISSION
Santa Fe, New Mexico

(Form C-104)
Revised 7/1/57

REQUEST FOR (OIL) - (~~GAS~~) ALLOWABLE

New Well
~~Recompletion~~

This form shall be submitted by the operator before an initial allowable will be assigned to any completed Oil or Gas well. Form C-104 is to be submitted in QUADRUPPLICATE to the same District Office to which Form C-101 was sent. The allowable will be assigned effective 7:00 A.M. on date of completion or recompletion, provided this form is filed during calendar month of completion or recompletion. The completion date shall be that date in the case of an oil well when new oil is delivered into the stock tanks. Gas must be reported on 15.025 psia at 60° Fahrenheit.

Roswell, New Mexico

February 9, 1960

(Place)

(Date)

WE ARE HEREBY REQUESTING AN ALLOWABLE FOR A WELL KNOWN AS:

Shell Oil Company
(Company or Operator)

Matthews
(Lease)

Well No. 1, in SE 1/4 NE 1/4,

H

Sec. 19

T. 8S

R. 37E

NMPM.,

Blount-Penn.

Pool

Unit Letter

Roosevelt

County. Date Spudded 12-23-59

Date Drilling Completed 1-30-60

Please indicate location:

R-37-E

D	G	B	A
E	F	G	H X
L	K	J	I
M	N	O	P

Elevation 1050' Total Depth 9600' PBD 9557'

Top Oil/ Gas Pay 9490' Name of Prod. Form. Pennsylvanian

PRODUCING INTERVAL -

Perforations 9490' - 9500'

Open Hole - Depth 9600' Depth 9535'
Casing Shoe Tubing

OIL WELL TEST -

Natural Prod. Test: 287 bbls. oil, - bbls water in 18 hrs, - min. Size 16/64"

Test After Acid or Fracture Treatment (after recovery of volume of oil equal to volume of Choke load oil used): bbls. oil, bbls water in hrs, min. Size

GAS WELL TEST -

Natural Prod. Test: MCF/Day; Hours flowed Choke Size

Tubing, Casing and Cementing Record

Size	Feet	Sax
13 3/8"	366	375
8 5/8"	1096	800
5 1/2"	9588	200
2 1/2"	9524	

Method of Testing (pitot, back pressure, etc.):

Test After Acid or Fracture Treatment: MCF/Day; Hours flowed

Choke Size Method of Testing:

Acid or Fracture Treatment (Give amounts of materials used, such as acid, water, oil, and sand):

Casing Tubing Date first new February 6, 1960
Press. Press. oil run to tanks

Oil Transporter McWood Corporation

Gas Transporter none

Remarks:

I hereby certify that the information given above is true and complete to the best of my knowledge.

Approved: 19

Shell Oil Company

(Company or Operator)

OIL CONSERVATION COMMISSION

By: Engineer District

Title

Original Signed By

R. A. Lowery R. A. LOWERY

(Signature)

Title District Exploitation Engineer

Send Communications regarding well to:

Name Shell Oil Company

Address Box 845, Roswell, New Mexico

NEW MEXICO OIL CONSERVATION COMMISSION
SANTA FE, NEW MEXICO

Form C-110
Revised 7/1/55

(File the original and 4 copies with the appropriate district office) OFFICE OCC

CERTIFICATE OF COMPLIANCE AND AUTHORIZATION
TO TRANSPORT OIL AND NATURAL GAS

1960 FEB 10 AM 10:39

Company or Operator Shell Oil Company Lease Matthews

Well No. 1 Unit Letter H S 19 T 8S R 37E Pool Huitt-Penn.

County Roosevelt Kind of Lease (State, Fed. or Patented) Patented

If well produces oil or condensate, give location of tanks: Unit H S 19 T 8S R 37E

Authorized Transporter of Oil or Condensate McWood Corporation

Address 701 V & J Tower Building, Midland, Texas

(Give address to which approved copy of this form is to be sent)

Authorized Transporter of Gas none

Address _____ Date Connected _____

(Give address to which approved copy of this form is to be sent)

If Gas is not being sold, give reasons and also explain its present disposition:

Gas being vented, no pipeline connection available.

Reasons for Filing: (Please check proper box) New Well Completed 2-6-60 ()

Change in Transporter of (Check One): Oil () Dry Gas () C'head () Condensate ()

Change in Ownership () Other ()

Remarks: _____ (Give explanation below)

The undersigned certifies that the Rules and Regulations of the Oil Conservation Commission have been complied with.

Executed this the 9th day of February 19 60

Approved _____ 19 _____

OIL CONSERVATION COMMISSION

By [Signature]

Title Engineer District I

By R. A. Lowery Original Signed By R. A. LOWERY

Title District Exploitation Engineer

Company Shell Oil Company

Address Box 845

Roswell, New Mexico

NEW MEXICO OIL CONSERVATION COMMISSION

FORM C-103
(Rev 3-55)

MISCELLANEOUS REPORTS ON WELLS

(Submit to appropriate District Office as per Commission Rule 1106)

HOBBS OFFICE OCC

FEB 10 AM 10:39

Name of Company Shell Oil Company		Address Box 888, Hobbs, New Mexico				
Lease Matthews	Well No. 1	Unit Letter H	Section 19	Township 8S	Range 37E	
Date Work Performed 2-3-60 thru 2-6-60	Pool Bluitt-Penn.		County Roosevelt			

THIS IS A REPORT OF: (Check appropriate block)

- ☐ Beginning Drilling Operations ☐ Casing Test and Cement Job ☒ Other (Explain):
☐ Plugging ☐ Remedial Work **Completion**

Detailed account of work done, nature and quantity of materials used, and results obtained.

1. Ran 2 1/2" tubing to 9543' & spotted 500 gallons 15% MCA on bottom.
2. Pulled tubing.
3. Perforated 9490' - 9500' w/2-1/2" jet shots per foot.
4. Ran 307 jts. (9524') 2 1/2", N-80, 8rd thd, new tubing & hung @ 9535'.
2 1/2" Seating Nipple @ 9491'.
5. On OPT flowed 383 BOPD, no water, thru 16/64" choke. (Based on 287 BO in 18 hours)
FTP 875 psi. FCP 350 psi. Gravity 50.5 deg. API.

Witnessed by H. G. Starling	Position Production Foreman	Company Shell Oil Company
---------------------------------------	---------------------------------------	-------------------------------------

FILL IN BELOW FOR REMEDIAL WORK REPORTS ONLY

ORIGINAL WELL DATA

D F Elev.	T D	P B T D	Producing Interval	Completion Date
Tubing Diameter	Tubing Depth	Oil String Diameter	Oil String Depth	
Perforated Interval(s)				
Open Hole Interval		Producing Formation(s)		

RESULTS OF WORKOVER

Test	Date of Test	Oil Production BPD	Gas Production MCFPD	Water Production BPD	GOR Cubic feet/Bbl	Gas Well Potential MCFPD
Before Workover						
After Workover						

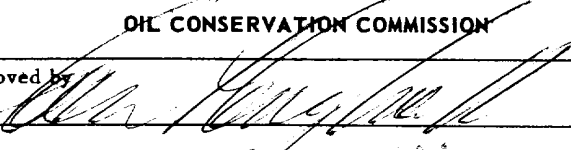
OIL CONSERVATION COMMISSION		I hereby certify that the information given above is true and complete to the best of my knowledge.	
Approved by 	Name R. A. Lowery	Original Signed By R. A. LOWERY	
Title Engineer	Position District Exploitation Engineer		
Date Feb 10 1960	Company Shell Oil Company		

NEW MEXICO OIL CONSERVATION COMMISSION

FORM C-103
(Rev 3-55)

MISCELLANEOUS REPORTS ON WELLS OFFICE OCC

(Submit to appropriate District Office as per Commission Rule 1106)

1960 FEB 11 AM 10:50

Name of Company Shell Oil Company				Address Box 845 Roswell, New Mexico		
Lease Matthews	Well No. 1	Unit Letter H	Section 19	Township 8 S	Range 37 E	
Date Work Performed Jan. 29 thru 2-7-60		Pool Bluitt-Perm.		County Roosevelt		

THIS IS A REPORT OF: (Check appropriate block)

- ☐ Beginning Drilling Operations ☒ Casing Test and Cement Job ☐ Other (Explain):
☐ Plugging ☐ Remedial Work

Detailed account of work done, nature and quantity of materials used, and results obtained.

Ran 9588' of 5½" (O.D., 15½#, J-55, 17#, J & N-80, Youngstown and LoneStar, 8R-R3, with S<&C) casing, and cemented @ 9600' with 200 sacks Incor 4% gel cement. Bumped plug with 1500 psi @ 3:00 p.m. (MST), January 30, 1960. After WOC 30 hours, tested casing with 2500 psi for 30 minutes - no pressure drop.

Witnessed by	Position	Company
--------------	----------	---------

FILL IN BELOW FOR REMEDIAL WORK REPORTS ONLY

ORIGINAL WELL DATA

D F Elev.	T D	P B T D	Producing Interval	Completion Date
Tubing Diameter	Tubing Depth	Oil String Diameter	Oil String Depth	
Perforated Interval(s)				
Open Hole Interval		Producing Formation(s)		

RESULTS OF WORKOVER

Test	Date of Test	Oil Production BPD	Gas Production MCFPD	Water Production BPD	GOR Cubic feet/Bbl	Gas Well Potential MCFPD
Before Workover						
After Workover						

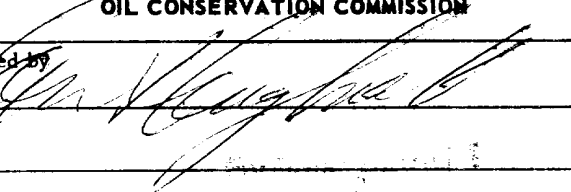
OIL CONSERVATION COMMISSION		I hereby certify that the information given above is true and complete to the best of my knowledge.	
Approved by 		Name R. L. Elkins	ORIGINAL SIGNED BY R. L. ELKINS
Title		Position Division Mechanical Engineer	
Date		Company Shell Oil Company	

NEW MEXICO OIL CONSERVATION COMMISSION

FORM C-103
(Rev 3-55)

MISCELLANEOUS REPORTS ON WELLS

HOBBS OFFICE OCC

(Submit to appropriate District Office as per Commission Rule 1106)

Name of Company Shell Oil Company		Address Box 845 Roswell, New Mexico			
Lease Matthews	Well No. 1	Unit Letter H	Section 19	Township 8 S	Range 37 E
Date Work Performed 12-30 thru 1-4-60	Pool Bluitt-Penn.		County Roosevelt		

THIS IS A REPORT OF: (Check appropriate block)

- ☐ Beginning Drilling Operations ☒ Casing Test and Cement Job ☐ Other (Explain):
☐ Plugging ☐ Remedial Work

Detailed account of work done, nature and quantity of materials used, and results obtained.

Ran 4096' of 8-5/8" (32#, H-40, J-55) casing and cemented @ 4108' with 600 sacks incor mixed with 40% diacel D, and 4% CaCO₃, plus 200 sacks 4% gel. Bumped plug with 1400 psi @ 11:00 a.m. (MST), December 30, 1959. Circulated 65 Sacks. After WOC 32 hours, tested casing with 1500 psi for 30 minutes. No bleed off, test O.K.

Witnessed by		Position		Company	
FILL IN BELOW FOR REMEDIAL WORK REPORTS ONLY					
ORIGINAL WELL DATA					
D F Elev.	T D	P B T D	Producing Interval	Completion Date	
Tubing Diameter		Tubing Depth	Oil String Diameter	Oil String Depth	
Perforated Interval(s)					
Open Hole Interval			Producing Formation(s)		

RESULTS OF WORKOVER

Test	Date of Test	Oil Production BPD	Gas Production MCFPD	Water Production BPD	GOR Cubic feet/Bbl	Gas Well Potential MCFPD
Before Workover						
After Workover						

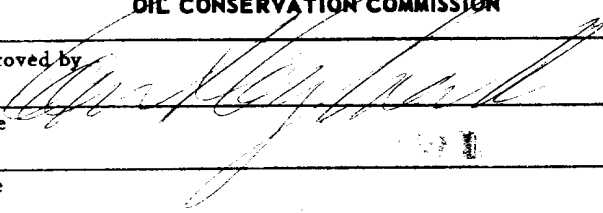
OIL CONSERVATION COMMISSION		I hereby certify that the information given above is true and complete to the best of my knowledge.	
Approved by		Name	ORIGINAL SIGNED BY R. L. ELKINS
Title		Position	Division Mechanical Engineer
Date		Company	Shell Oil Company

NEW MEXICO OIL CONSERVATION COMMISSION

FORM C-103
(Rev 3-55)MISCELLANEOUS REPORTS ~~ON~~ DISTRICT OFFICE OCC

(Submit to appropriate District Office as per Commission Rule 1106)

Name of Company Shell Oil Company		Address Box 845 Roswell, New Mexico				
Lease Matthews	Well No. 1	Unit Letter H	Section 19	Township 8 S	Range 37 E	
Date Work Performed 12-23 thru 26, 1959	Pool Bluitt- Penn.			County Roosevelt County		

THIS IS A REPORT OF: (Check appropriate block)

- ☒ Beginning Drilling Operations
 ☒ Casing Test and Cement Job
 ☐ Other (Explain):
- ☐ Plugging
 ☐ Remedial Work

Detailed account of work done, nature and quantity of materials used, and results obtained.

Spudded 7:45 p.m. (MST), December 23, 1959.

Ran 366' of 13-3/8" (48#, H-40, National, 8R - R3, with ST&C) casing and cemented @ 380' with 375 sacks regular neat cement. Plug down @ 5:50 p.m. (MST), December 24, 1959. Circulated out 30 sacks neat cement. After WOC 24 hours, tested casing with 1500 psi for 30 minutes. No loss in pressure. Test O.K.

Witnessed by	Position	Company
--------------	----------	---------

FILL IN BELOW FOR REMEDIAL WORK REPORTS ONLY

ORIGINAL WELL DATA

D F Elev.	T D	P B T D	Producing Interval	Completion Date
Tubing Diameter	Tubing Depth	Oil String Diameter	Oil String Depth	
Perforated Interval(s)				
Open Hole Interval		Producing Formation(s)		

RESULTS OF WORKOVER

Test	Date of Test	Oil Production BPD	Gas Production MCFPD	Water Production BPD	GOR Cubic feet/Bbl	Gas Well Potential MCFPD
Before Workover						
After Workover						

OIL CONSERVATION COMMISSION

I hereby certify that the information given above is true and complete to the best of my knowledge.	
Approved by 	Name R. L. Elkins
Title Engineer	Position Division Mechanical Engineer
Date JAN 7 1960	Company Shell Oil Company

NEW MEXICO OIL CONSERVATION COMMISSION
Santa Fe, New Mexico

Form C-101
Revised (12/1/55)

NOTICE OF INTENTION TO DRILL

Notice must be given to the District Office of the Oil Conservation Commission and approval obtained before drilling or recompletion begins. If changes in the proposed plan are considered advisable, a copy of this notice showing such changes will be returned to the sender. Submit this notice in QUINTUPPLICATE. One copy will be returned following approval. See additional instructions in Rules and Regulations of the Commission. If State Land submit 6 Copies Attach Form C-128 in triplicate to first 3 copies of form C-101

Roswell, New Mexico
(Place)

December 14, 1959
(Date)

OIL CONSERVATION COMMISSION
SANTA FE, NEW MEXICO

Gentlemen:

You are hereby notified that it is our intention to commence the Drilling of a well to be known as

Shell Oil Company
(Company or Operator)

Matthews
(Lease)

Well No. 1, in H. The well is

located 1980 feet from the north line and 660 feet from the east line of Section 19, T. -8-S, R. -37-E, NMPM.

(GIVE LOCATION FROM SECTION LINE) Blunt-Penn. Pool, Roosevelt County

R-37-E

D	C	B	A
E	F	G	H
L	K	J	I
M	N	O	P

Section 19

If State Land the Oil and Gas Lease is No.

If patented land the owner is J. C. Matthews

Address.

We propose to drill well with drilling equipment as follows: Rotary Tools

The status of plugging bond is Blanket

Drilling Contractor undetermined

We intend to complete this well in the Pennsylvanian formation at an approximate depth of 9600 feet.

CASING PROGRAM

We propose to use the following strings of Casing and to cement them as indicated:

Size of Hole	Size of Casing	Weight per Foot	New or Second Hand	Depth	Sacks Cement
17"	13 3/8"	48#	new	380	380
11"	8 5/8"	32#	new	4120	850
7 7/8"	5 1/2"	17#	new	9600	200

If changes in the above plans become advisable we will notify you immediately.

ADDITIONAL INFORMATION (If recompletion give full details of proposed plan of work.)

Approved....., 19.....
Except as follows:

Sincerely yours,

Shell Oil Company

(Company or Operator) Original Signed By

By R. A. Lowery R. A. LOWERY

Position District Exploitation Engineer

Send Communications regarding well to

Name Shell Oil Company

Address Box 845, Roswell, New Mexico

OIL CONSERVATION COMMISSION

By

NEW MEXICO OIL CONSERVATION COMMISSION

Well Location and Acreage Dedication Plat

Section A.

Date December 14, 1959

Operator Shell Oil Company Lease Matthews
Well No. 1 Unit Letter H Section 19 Township 8S Range 37E NMPM
Located 1980 Feet From north Line, 660 Feet From east Line
County Roosevelt G. L. Elevation not available Dedicated Acreage 80 Acres
Name of Producing Formation Pennsylvanian Pool Mutt-Penn.

1. Is the Operator the only owner* in the dedicated acreage outlined on the plat below?
Yes X No .
2. If the answer to question one is "no," have the interests of all the owners been consolidated by communitization agreement or otherwise? Yes No . If answer is "yes," Type of Consolidation
3. If the answer to question two is "no," list all the owners and their respective interests below:

Owner

Land Description

Section B

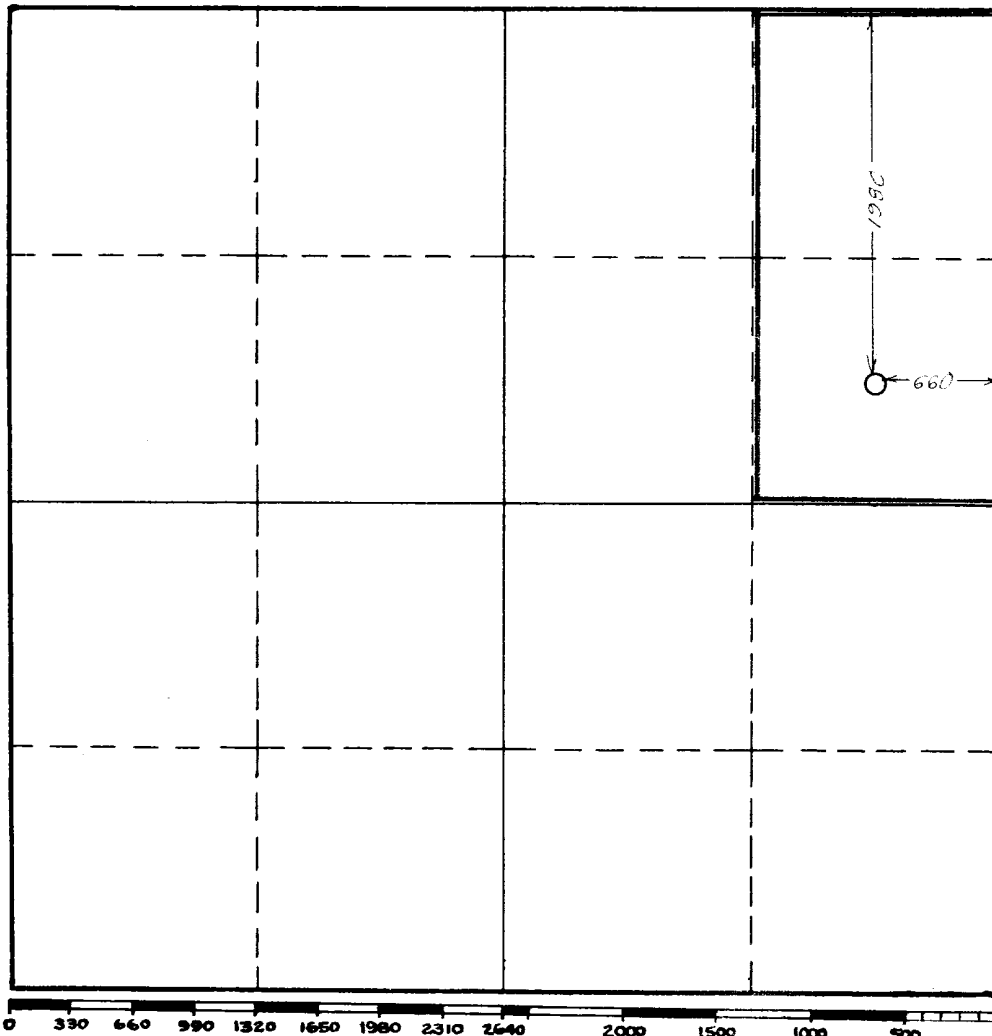

This is to certify that the information in Section A above is true and complete to the best of my knowledge and belief.

Shell Oil Company

(Operator)

Original Signed By

R. A. Lowery R. A. LOWERY
(Representative)

Box 845, Roswell, New Mexico
Address

This is to certify that the well location shown on the plat in Section B was plotted from field notes of actual surveys made by me or under my supervision and that the same is true and correct to the best of my knowledge and belief.

Date Surveyed Dec 8, 1959

S. D. Baur
Registered Professional
Engineer and/or Land Surveyor.

Certificate No. 5068

(See instructions for completing this form on the reverse side)

INSTRUCTIONS FOR COMPLETION:

1. Operator shall furnish and certify to the information called for in Section A.
2. Operator shall outline the dedicated acreage for both oil and gas wells on the plat in Section B.
3. A registered professional engineer or land surveyor registered in the State of New Mexico or approved by the Commission shall show on the plat the location of the well and certify this information in the space provided.
4. All distances shown on the plat must be from the outer boundaries of Section.
5. If additional space is needed for listing owners and their respective interests as required in question 3, Section A, please use space below

* "Owner" means the person who has the right to drill into and to produce from any pool and to appropriate the production either for himself or for himself and another. (65-3-29 (e) NMSA 1953 Comp.)