AREA 640 ACRES
LOCATE WELL CORRECTLY

NEW MEXICO OIL CONSERVATION COMMISSION

Santa Fe, New Mexico

HOME OFFICE 000

WELL RECORD

1960 MAR 7 1 AM 9 137

Mail to District Office, Oil Conservation Commission, to which Form C-101 was sent not later than twenty days after completion of well. Follow instructions in Rules and Regulations of the Commission. Submit in QUINTUPLICATE. If State Land submit 6 Copies

Shell Oil Company

(Company or Operator)

Matthews

(Lease)

Well No. 2, in NW $\frac{1}{4}$ of NE $\frac{1}{4}$, of Sec. 19, T. 8S, R. 37E, NMPM.
undesignated Pool, Roosevelt County.

Well is 660 feet from north line and 1980 feet from east line
of Section 19. If State Land the Oil and Gas Lease No. is -

Drilling Commenced February 16, 19 60 Drilling was Completed March 18, 19 60

Name of Drilling Contractor A. W. Thompson

Address Room 214, Midland National Bank Building, Midland, Texas

Elevation above sea level at Top of Tubing Head 1047'
not confidential The information given is to be kept confidential until
19 60

OIL SANDS OR ZONES

No. 1, from 9454' to 9458' No. 4, from to
No. 2, from 9470' to 9476' No. 5, from to
No. 3, from to No. 6, from to

IMPORTANT WATER SANDS

Include data on rate of water inflow and elevation to which water rose in hole.

No. 1, from to feet.
No. 2, from to feet.
No. 3, from to feet.
No. 4, from to feet.

CASING RECORD

SIZE	WEIGHT PER FOOT	NEW OR USED	AMOUNT	KIND OF SHOE	CUT AND PULLED FROM	PERFORATIONS	PURPOSE
13 3/8"	48#	NEW	363'				Surface String
8 5/8"	32#	NEW	1206'	Baker Float			Salt String
5 1/2"	15.5# & 17#	NEW	9608'	Larkin Float		9454' - 9458' 9470' - 9476'	Oil String

MUDDING AND CEMENTING RECORD

SIZE OF HOLE	SIZE OF CASING	WHERE SET	NO. BAGS OF CEMENT	METHOD USED	MUD GRAVITY	AMOUNT OF MUD USED
17"	13 3/8"	377'	400	Pump & Plug	Cemented to surface	
11"	8 5/8"	1118'	920	Pump & Plug	Cemented to surface	
7 7/8"	5 1/2"	9620'	200	Pump & Plug		

RECORD OF PRODUCTION AND STIMULATION

(Record the Process used, No. of Qts. or Gals. used, interval treated or shot.)

Perforated 5 1/2" casing 9454' - 9458' & 9470' - 9476' w/4-1/2" jet shots per foot.

Treated via tubing w/3000 gallons 15% N. E. Acid.

Result of Production Stimulation On OPT flowed 330 BOPD, cut 0.2% NE, thru 15/64" choke.

FTP 800 psi, GP 0 psi.

Depth Cleaned Out 9595'

RECORD OF DRILL-STEM AND SPECIAL TESTS

If drill-stem or other special tests or deviation surveys were made, submit report on separate sheet and attach hereto

TOOLS USED

Rotary tools were used from 0 feet to 9618 feet, and from feet to feet.
Cable tools were used from feet to feet, and from feet to feet.

PRODUCTION

Put to Producing March 29, 19 60

OIL WELL: The production during the first 24 hours was 330 barrels of liquid of which 99.8% was oil; % was emulsion; % water; and 0.2% was sediment. A.P.I. Gravity. 48.6 deg.

GAS WELL: The production during the first 24 hours was M.C.F. plus barrels of liquid Hydrocarbon. Shut in Pressure lbs.

Length of Time Shut in

PLEASE INDICATE BELOW FORMATION TOPS (IN CONFORMANCE WITH GEOGRAPHICAL SECTION OF STATE):

Southeastern New Mexico

Northwestern New Mexico

T. Anhy.	T. Devonian.	T. Ojo Alamo.
T. Salt.	T. Silurian.	T. Kirtland-Fruitland.
B. Salt.	T. Montoya.	T. Farmington.
T. Yates. 2774' (+1284')	T. Simpson.	T. Pictured Cliffs.
T. 7 Rivers.	T. McKee.	T. Menefee.
T. Queen.	T. Ellenburger.	T. Point Lookout.
T. Grayburg.	T. Gr. Wash.	T. Mancos.
T. San Andres. 3993' (+65')	T. Granite.	T. Dakota.
T. Glorieta.	T. Base Red Beds 2284' (+1774')	T. Morrison.
T. Drinkard.	T. Yase 5423' (-1365')	T. Penn.
T. Tubbs.	T. Wolfcamp 8783' (-4725')	
T. Abo. 7643' (-3585')	T. Bough C 9453' (-5395')	
T. Penn. 9393' (-5335')		
T. Miss.		

FORMATION RECORD

From	To	Thickness in Feet	Formation	From	To	Thickness in Feet	Formation
0	400	400	Surface Sands & Caliche				
400	2284	1884	Red Beds				
2284	2774	490	Anhydrite & Salt				
2774	4015	1241	Sand, Shale, Anhydrite, Salt				
4015	5423	1408	Anhydrite, Dolomite, Sand, Shale				
5423	7600	2177	Dolomite, Shale				
7600	8300	700	Shale w/Dolomite				
8300	8890	590	Dolomite w/Shale				
8890	8950	60	Dolomite, Shale, Limestone				
8950	9620	670	Limestone, Shale				
DST #1A: 9457' - 9487' (30' Penn. Bough C). Packers failed. Misrun.							
DST #1B: 9440' - 9477' (1st packer setting). Fourth & final setting 9447' - 9484'. (packer failed on first 3 settings). (37' Penn. Bough C). Tool open 30 minutes. Opened w/weak blow & died in 11 minutes. Recovered 114' (7.1 bbls.) drilling mud w/no show. All pressures failed. Inconclusive Test. (HOWCO)							
DST # 2: 9566' - 9618' (52' Penn. Bough F). Tool open 1 1/2 hours thru 5/8" BC, 1" TC, 3 1/2" DP. Tool opened w/weak blow continuing throughout test. Recovered 405' (2.4 bbls.) slightly gas cut drilling mud + 180' (0.9 bbl.) heavily sulfur water cut drilling mud. 30 minutes ISIBHP 3290 psi. FBHP 220 + 350 psi. 60 minutes ISIBHP 2785 psi. FBHP 5075 psi. Pit mud titrated 91,500 ppm Cl ⁻ . Recovery mud titrated 69,000 ppm Cl ⁻ . Maximum temperature 145 deg. F. Conclusive Test. (HOWCO)							

ATTACH SEPARATE SHEET IF ADDITIONAL SPACE IS NEEDED

I hereby swear or affirm that the information given herewith is a complete and correct record of the well and all work done on it so far as can be determined from available records.

March 30, 1960

Company or Operator. Shell Oil Company
Original Signed By
Name. R. A. Lowery R. A. LOWERY

Address. Box 845, Roswell, New Mexico
Position Title. District Exploitation Engineer

REQUEST FOR (OIL) - (GAS) ALLOWABLE

New Well
~~Recompletion~~

This form shall be submitted by the operator before an initial allowable will be assigned to any completed Oil or Gas well. Form C-104 is to be submitted in QUADRUPLICATE to the same District Office to which Form C-101 was sent. The allowable will be assigned effective 7:00 A.M. on date of completion or recompletion, provided this form is filed during calendar month of completion or recompletion. The completion date shall be that date in the 1960 FAR of BLM when new oil is delivered into the stock tanks. Gas must be reported on 15.025 psia at 60° Fahrenheit.

Roswell, New Mexico

March 30, 1960

(Place)

(Date)

WE ARE HEREBY REQUESTING AN ALLOWABLE FOR A WELL KNOWN AS:

Shell Oil Company

Matthews

Well No. 2, in NW 1/4 NE 1/4,

(Company or Operator)

(Lease)

B

Sec. 19

T. 8S

R. 37E

NMPM., undesignated

Pool

Unit Letter

Roosevelt

County. Date Spudded 2-16-60

Date Drilling Completed 3-18-60

Please indicate location:

R-37-E

D	G	B	A
		X	
E	F	G	H
L	K	J	I
M	N	O	P

Elevation 4058' DF Total Depth 9620' PBD 9595'

Top Oil/Water Pay 9454' Name of Prod. Form. Penn.

PRODUCING INTERVAL -

Perforations 9454' - 9458' & 9470' - 9476'

Open Hole - Depth Casing Shoe 9620' Depth Tubing 9589'

OIL WELL TEST -

Natural Prod. Test: _____ bbls. oil, _____ bbls water in _____ hrs, _____ min. Size _____

Test After Acid or Fracture Treatment (after recovery of volume of oil equal to volume of load oil used): 330 bbls. oil, _____ bbls water in 24 hrs, _____ min. Size 15/64"

GAS WELL TEST -

Natural Prod. Test: _____ MCF/Day; Hours flowed _____ Choke Size _____

Method of Testing (pitot, back pressure, etc.): _____

Test After Acid or Fracture Treatment: _____ MCF/Day; Hours flowed _____

Choke Size _____ Method of Testing: _____

Acid or Fracture Treatment (Give amounts of materials used, such as acid, water, oil, and sand): 3000 gallons 15% N. E. Acid

Casing Tubing Date first new March 29, 1960

Press. _____ Press. _____ oil run to tanks

Oil Transporter McWood Corporation

Gas Transporter none

Tubing, Casing and Cementing Record

Size	Feet	Sax
13 3/8"	363	100
8 5/8"	4106	920
5 1/2"	9608	200
2 1/2"	9580	

Remarks:

Blunt Penn. Ext. - 86 Ac.

I hereby certify that the information given above is true and complete to the best of my knowledge.

Approved _____, 1960

Shell Oil Company

(Company or Operator) Original Signed By

R. A. Lowery R. A. LOWERY

By:

(Signature)

District Exploitation Engineer

Title:

Send Communications regarding well to:

Shell Oil Company

Name:

Box 845, Roswell, New Mexico

Address:

OIL CONSERVATION COMMISSION

By: _____

Title: _____

NEW MEXICO OIL CONSERVATION COMMISSION
SANTA FE, NEW MEXICO

Form C-110
Revised 7/1/55

(File the original and 4 copies with the appropriate district office)

CERTIFICATE OF COMPLIANCE AND AUTHORIZATION
TO TRANSPORT OIL AND NATURAL GAS

MAR 31 AM 9 35

Company or Operator Shell Oil Company Lease Matthews
Well No. 2 Unit Letter B S 19 T 8S R 37E Pool undesignated
County Roosevelt Kind of Lease (State, Fed. or Patented) Patented
If well produces oil or condensate, give location of tanks: Unit H S 19 T 8S R 37E
Authorized Transporter of Oil or Condensate McWood Corporation
Address 701 V & J Tower Building, Midland, Texas
(Give address to which approved copy of this form is to be sent)
Authorized Transporter of Gas none
Address _____ Date Connected _____
(Give address to which approved copy of this form is to be sent)
If Gas is not being sold, give reasons and also explain its present disposition:
Gas being vented, no pipeline connection available.

Reasons for Filing: (Please check proper box) New Well Completed 3-29-60 (x)
Change in Transporter of (Check One): Oil () Dry Gas () C'head () Condensate ()
Change in Ownership () Other ()
Remarks: _____ (Give explanation below)

The undersigned certifies that the Rules and Regulations of the Oil Conservation Commission have been complied with.

Executed this the 30th day of March 19 60

Original Signed By
R. A. LOWERY

By R. A. Lowery

Approved _____ 19 _____

Title District Exploitation Engineer

OIL CONSERVATION COMMISSION

Company Shell Oil Company

By [Signature]

Address Box 845

Title _____

Roswell, New Mexico

NEW MEXICO OIL CONSERVATION COMMISSION

FORM C-103
(Rev 3-55)

MISCELLANEOUS REPORTS ON WELLS

(Submit to appropriate District Office as per Commission Rule 1106)

Name of Company Shell Oil Company		Address Box 845, Roswell, New Mexico				
Lease Matthews	Well No. 2	Unit Letter B	Section 19	Township 8S	Range 37E	
Date Work Performed 3-25 thru 3-29-60	Pool undesignated			County Roosevelt		

THIS IS A REPORT OF: (Check appropriate block)

- ☐ Beginning Drilling Operations ☐ Casing Test and Cement Job ☒ Other (Explain):
☐ Plugging ☐ Remedial Work **Completion**

Detailed account of work done, nature and quantity of materials used, and results obtained.

1. Ran 2 1/2" tubing to PBD & spotted 300 gallons 15% Spearhead acid on bottom.
2. Pulled tubing.
3. Perforated 5 1/2" casing 9470' - 9476' & 9454' - 9458' w/4-1/2" jet shots per foot.
4. Ran 302 jts. (9580') 2 1/2", EUE, N-80, 8rd thd tubing & hung @ 9589'. Seating Nipple @ 9539'. McGaffey Taylor tubing anchor @ 9441'.
5. Treated via tubing w/3000 gallons 15% N. E. Acid.
6. Recovered load.
7. On OPT flowed 330 BOPD, cut 0.2% BS, thru 15/64" choke.
FTP 800 psi. CP 0 psi.

Witnessed by H. G. Starling	Position Production Foreman	Company Shell Oil Company
---------------------------------------	---------------------------------------	-------------------------------------

FILL IN BELOW FOR REMEDIAL WORK REPORTS ONLY

ORIGINAL WELL DATA

D F Elev.	T D	P B T D	Producing Interval	Completion Date
Tubing Diameter	Tubing Depth	Oil String Diameter	Oil String Depth	
Perforated Interval(s)				
Open Hole Interval		Producing Formation(s)		

RESULTS OF WORKOVER

Test	Date of Test	Oil Production BPD	Gas Production MCFPD	Water Production BPD	GOR Cubic feet/Bbl	Gas Well Potential MCFPD
Before Workover						
After Workover						

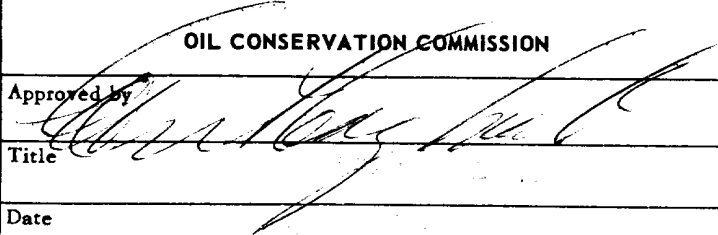
OIL CONSERVATION COMMISSION		I hereby certify that the information given above is true and complete to the best of my knowledge.	
Approved by 	Name R. A. Lowery	Original Signed By R. A. LOWERY	
Title	Position District Exploitation Engineer		
Date	Company Shell Oil Company		

NEW MEXICO OIL CONSERVATION COMMISSION

FORM C-103
(Rev 3-55)

MISCELLANEOUS REPORTS ON WELLS

(Submit to appropriate District Office as per Commission Rule 1106)

Name of Company Shell Oil Company		Address Box 845 Roswell, New Mexico			
Lease Matthews	Well No. 2	Unit Letter B	Section 19	Township 8 S	Range 37 E
Date Work Performed 3-21 thru 27-60	Pool Bluitt-Penn.		County Roosevelt		

THIS IS A REPORT OF: (Check appropriate block)

- ☐ Beginning Drilling Operations ☒ Casing Test and Cement Job ☐ Other (Explain):
☐ Plugging ☐ Remedial Work

Detailed account of work done, nature and quantity of materials used, and results obtained.

Ran 9608' of 5½" (17#, N-80, 17#, J-55, Republic, National and Youngston, 8R, R3, with ST&C and LT&C) casing and cemented @ 9620' with 200 sacks class C plug 4% gel. Bumped plug with 1750 psi @ 4:55 p.m. (MST), March 22, 1960. Temperature survey indicated cement top of cement at 8510'. After WOC 30 hours, tested casing with 3000 psi for 30 minutes - no pressure drop.

Witnessed by	Position	Company
--------------	----------	---------

FILL IN BELOW FOR REMEDIAL WORK REPORTS ONLY

ORIGINAL WELL DATA

D F Elev.	T D	P BTD	Producing Interval	Completion Date
Tubing Diameter	Tubing Depth	Oil String Diameter	Oil String Depth	
Perforated Interval(s)				
Open Hole Interval		Producing Formation(s)		

RESULTS OF WORKOVER

Test	Date of Test	Oil Production BPD	Gas Production MCFPD	Water Production BPD	GOR Cubic feet/Bbl	Gas Well Potential MCFPD
Before Workover						
After Workover						

OIL CONSERVATION COMMISSION

I hereby certify that the information given above is true and complete to the best of my knowledge.

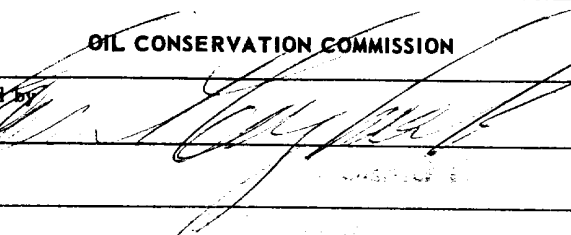
Approved by 	Name R. L. Elkins
Title Division Mechanical Engineer	Position Division Mechanical Engineer
Date	Company Shell Oil Company

NEW MEXICO OIL CONSERVATION COMMISSION

FORM C-103
(Rev 3-55)

MISCELLANEOUS REPORTS ON WELLS

(Submit to appropriate District Office as per Commission Rule 17040 37)

Name of Company Shell Oil Company		Address Box 845 Roswell, New Mexico				
Lease Matthews	Well No. 2	Unit Letter B	Section 19	Township 8 S	Range 37 E	
Date Work Performed 2-22 thru 25-60	Pool Bluitt-Penn.			County Roosevelt		

THIS IS A REPORT OF: (Check appropriate block)

- ☐ Beginning Drilling Operations ☒ Casing Test and Cement Job ☐ Other (Explain):
☐ Plugging ☐ Remedial Work

Detailed account of work done, nature and quantity of materials used, and results obtained.

Ran 4106' of 8-5/8" (O.D., 32#, H&J, Lonestar, Youngstown, 8R-R3, with ST&C) casing and cemented @ 4118' with 670 sacks Incor 40% Diacel D + 4% CaCl₂ and 250 sacks 4% gel regular cement. Bumped plug with 1500 psi @ 11:40 p.m. (MST), February 22, 1960. Circulated out 117 sacks. After WOC 36 hours, tested casing with 1000 psi for 30 minutes - no pressure drop.

Witnessed by	Position	Company
--------------	----------	---------

FILL IN BELOW FOR REMEDIAL WORK REPORTS ONLY

ORIGINAL WELL DATA

D F Elev.	T D	P BTD	Producing Interval	Completion Date
Tubing Diameter	Tubing Depth	Oil String Diameter	Oil String Depth	
Perforated Interval(s)				
Open Hole Interval		Producing Formation(s)		

RESULTS OF WORKOVER

Test	Date of Test	Oil Production BPD	Gas Production MCFPD	Water Production BPD	GOR Cubic feet/Bbl	Gas Well Potential MCFPD
Before Workover						
After Workover						

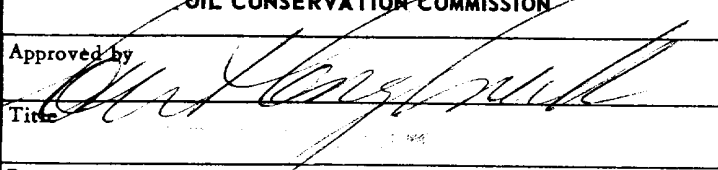
OIL CONSERVATION COMMISSION		I hereby certify that the information given above is true and complete to the best of my knowledge.	
Approved by 	Name R. L. Elkins	ORIGINAL SIGNED BY R. L. ELKINS	
Title	Position Division Mechanical Engineer		
Date	Company Shell Oil Company		

NEW MEXICO OIL CONSERVATION COMMISSION

FORM C-103
(Rev 3-55)

MISCELLANEOUS REPORTS ON WELLS HOBBS OFFICE OCC

(Submit to appropriate District Office as per Commission Rule 1106)

1960 FEB 24 PM 3:44

Name of Company Shell Oil Company			Address Box 845 Roswell, New Mexico			
Lease Matthews	Well No. 2	Unit Letter B	Section 19	Township 8 S	Range 37 E	
Date Work Performed 2-16 thru 18-1960	Pool Bluitt - Penn.			County Roosevelt		

THIS IS A REPORT OF: (Check appropriate block)

- ☒ Beginning Drilling Operations ☒ Casing Test and Cement Job ☐ Other (Explain):
☐ Plugging ☐ Remedial Work

Detailed account of work done, nature and quantity of materials used, and results obtained.

Spudded 5:30 p.m. (MST), February 16, 1960.

Ran 363' of 13-3/8" (O.D., National, 48#, H-40) casing and cemented @ 377' with 400 sacks regular neat cement. Circulated 22 sacks cement. Plug down 11:00 a.m. (MST), February 17, 1960. After WOC 18 hours, tested casing with 500 psi for 30 minutes - no pressure drop.

Witnessed by	Position	Company
--------------	----------	---------

FILL IN BELOW FOR REMEDIAL WORK REPORTS ONLY

ORIGINAL WELL DATA

D F Elev.	T D	P BTD	Producing Interval	Completion Date
Tubing Diameter	Tubing Depth	Oil String Diameter	Oil String Depth	
Perforated Interval(s)				
Open Hole Interval		Producing Formation(s)		

RESULTS OF WORKOVER

Test	Date of Test	Oil Production BPD	Gas Production MCFPD	Water Production BPD	GOR Cubic feet/Bbl	Gas Well Potential MCFPD
Before Workover						
After Workover						

OIL CONSERVATION COMMISSION		I hereby certify that the information given above is true and complete to the best of my knowledge.	
Approved by 	Name R. L. Elkins	ORIGINAL SIGNED BY R. L. ELKINS	
Title	Position Division Mechanical Engineer		
Date	Company Shell Oil Company		

NEW MEXICO OIL CONSERVATION COMMISSION
Santa Fe, New Mexico

Form C-101
Revised (12/1/55)

NOTICE OF INTENTION TO DRILL

HOBBS OFFICE OCC

Notice must be given to the District Office of the Oil Conservation Commission and approval obtained before drilling or recompletion begins. If changes in the proposed plan are considered advisable, a copy of this notice showing such changes will be returned to the sender. Submit this notice in QUINTUPPLICATE. One copy will be returned following approval. See additional instructions in Rules and Regulations of the Commission. If State Land submit 6 Copies Attach Form C-128 in triplicate to first 3 copies of Form C-101

Roswell, New Mexico

January 29, 1960

(Place)

(Date)

OIL CONSERVATION COMMISSION
SANTA FE, NEW MEXICO

Gentlemen:

You are hereby notified that it is our intention to commence the Drilling of a well to be known as

Shell Oil Company

(Company or Operator)

Matthews

(Lease)

Well No. 2, in B. The well is

located 660 feet from the north line and 1980 feet from the

east

line of Section 19, T. 8-S, R. 37-E, NMPM.

(GIVE LOCATION FROM SECTION LINE) Bluff-Penn. Pool, Roosevelt County

R-37-E

D	C	K	A
E	F	G	H
L	K	J	I
M	N	O	P

Section 19

If State Land the Oil and Gas Lease is No. -

If patented land the owner is J. C. Matthews

Address. -

We propose to drill well with drilling equipment as follows: Rotary Tools

The status of plugging bond is Blanket

Drilling Contractor undetermined

We intend to complete this well in the Pennsylvanian

formation at an approximate depth of 9650 feet.

CASING PROGRAM

We propose to use the following strings of Casing and to cement them as indicated:

Size of Hole	Size of Casing	Weight per Foot	New or Second Hand	Depth	Sacks Cement
17"	13 3/8"	148#	new	380	380
11"	8 5/8"	32#	new	4120	850
7 7/8"	5 1/2"	17# & 20#	new	9650	200

If changes in the above plans become advisable we will notify you immediately.

ADDITIONAL INFORMATION (If recompletion give full details of proposed plan of work.)

Approved. _____, 19_____
Except as follows:

Sincerely yours,

Shell Oil Company

(Company or Operator)

By R. A. Lowery Original Signed By R. A. LOWERY

Position District Exploitation Engineer

Send Communications regarding well to

Name Shell Oil Company

Address Box 845, Roswell, New Mexico

OIL CONSERVATION COMMISSION

By

MEXICO OIL CONSERVATION COMMISSION

Well Location and Acreage Dedication Plat

Section A.

HOBBS OFFICE OCC
Date January 29, 1960

Operator Shell Oil Company Lease Matthews 1 AM 9:42
Well No. 2 Unit Letter B Section 19 Township 8S Range 37E NMPM
Located 660 Feet From north Line, 1980 Feet From east Line
County Reagan G. L. Elevation not available Dedicated Acreage 80 Acres
Name of Producing Formation Pennsylvanian Pool Bluff-Penn.

1. Is the Operator the only owner* in the dedicated acreage outlined on the plat below?
Yes x No .
2. If the answer to question one is "no," have the interests of all the owners been consolidated by communitization agreement or otherwise? Yes No . If answer is "yes," Type of Consolidation
3. If the answer to question two is "no," list all the owners and their respective interests below:

Owner

Land Description

Section B

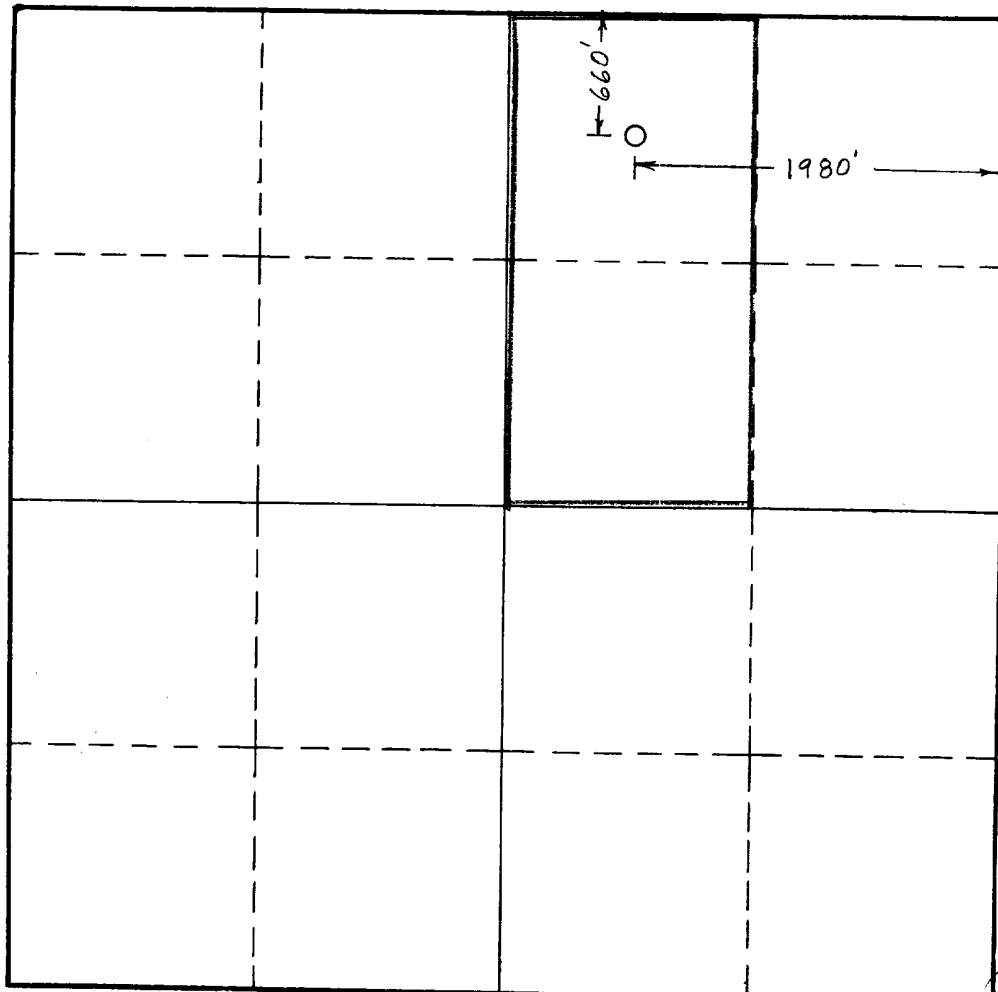

This is to certify that the information in Section A above is true and complete to the best of my knowledge and belief.

Shell Oil Company
(Operator)

Original Signed By
R. A. Lowery R. A. LOWERY
(Representative)

District Exploitation Engineer
Address

This is to certify that the well location shown on the plat in Section B was plotted from field notes of actual surveys made by me or under my supervision and that the same is true and correct to the best of my knowledge and belief.

Date Surveyed 1-29-60

John W. West
Registered Professional
Engineer and/or Land Surveyor.

Certificate No. 676

(See instructions for completing this form on the reverse side)

INSTRUCTIONS FOR COMPLETION:

1. Operator shall furnish and certify to the information called for in Section A.
2. Operator shall outline the dedicated acreage for both oil and gas wells on the plat in Section B.
3. A registered professional engineer or land surveyor registered in the State of New Mexico or approved by the Commission shall show on the plat the location of the well and certify this information in the space provided.
4. All distances shown on the plat must be from the outer boundaries of Section.
5. If additional space is needed for listing owners and their respective interests as required in question 3, Section A, please use space below

* "Owner" means the person who has the right to drill into and to produce from any pool and to appropriate the production either for himself or for himself and another. (65-3-29 (e) NMSA 1953 Comp.)