

NEW MEXICO OIL CONSERVATION COMMISSION
Santa Fe, New Mexico

NOTICE OF INTENTION TO DRILL OR RECOMPLETE

Notice must be given to the District Office of the Oil Conservation Commission and approval obtained before drilling or recompletion begins. If changes in the proposed plan are considered advisable, a copy of this notice showing such changes will be returned to the sender. Submit this notice in QUINTUPLICATE. One copy will be returned following approval. See additional instructions in Rules and Regulations of the Commission.

Hobbs, New Mexico
(Place)

May 8, 1961
(Date)

OIL CONSERVATION COMMISSION
SANTA FE, NEW MEXICO

Gentlemen:

You are hereby notified that it is our intention to commence the (Drilling) (Recompletion) of a well to be known as

Sunray Mid-Continent Oil Company

(Company or Operator)

N. M. State "AA"

(Lease)

Well No. 1, in H The well is

(Unit)

located 1980 feet from the north line and 660 feet from the east line of Section 36, T. 8S, R. 36E, NMPM.

(GIVE LOCATION FROM SECTION LINE)

Allison-Penn Pool, Roosevelt County

36E

If State Land the Oil and Gas Lease is No. E-8876

If patented land the owner is

Address

We propose to drill well with drilling equipment as follows: Rotary Tools to 9700'

The status of plugging bond is Approved

Drilling Contractor Will furnish later

We intend to complete this well in the Rough "C" Penn formation at an approximate depth of 9650 feet.

CASING PROGRAM

We propose to use the following strings of Casing and to cement them as indicated:

Size of Hole	Size of Casing	Weight per Foot	New or Second Hand	Depth	Sacks Cement
17 1/2"	13 3/8"	48#	New	300	325 to circ
11"	8 5/8"	24 & 32#	New	4250	1300 to circ
7 7/8"	4 1/2"	11.6#	New	9700	150

If changes in the above plans become advisable we will notify you immediately.

ADDITIONAL INFORMATION (If recompletion give full details of proposed plan of work.)

Approved....., 19.....
Except as follows:

OIL CONSERVATION COMMISSION

By.....
Title.....

Sincerely yours,

SUNRAY MID-CONTINENT OIL COMPANY

(Company or Operator)

By.....
Position.....
Name.....
Address.....

NEW MEXICO OIL CONSERVATION COMMISSION

FORM C-128
Revised 5/1/57

WELL LOCATION AND ACREAGE DEDICATION PLAT

SEE INSTRUCTIONS FOR COMPLETING THIS FORM ON THE REVERSE SIDE

SECTION A

Operator Sunray MidContinent Oil Company		Lease State "AA"		Well No. 1
Unit Letter H	Section 36	Township 8 South	Range 36 East	County Roosevelt
Actual Footage Location of Well: 660 feet from the east line and 1980 feet from the north line				
Ground Level Elev. 4057.0	Producing Formation Penn Bush "G"	Pool Allison-Penn	Dedicated Acreage 80 Acres	

1. Is the Operator the only owner in the dedicated acreage outlined on the plat below? YES ☒ NO ☐ ("Owner" means the person who has the right to drill into and to produce from any pool and to appropriate the production either for himself or for himself and another. 165-3-29 (e) NMSA 1935 (Comp.)
2. If the answer to question one is "no," have the interests of all the owners been consolidated by communitization agreement or otherwise? YES ☐ NO ☐ If answer is "yes," Type of Consolidation _____
3. If the answer to question two is "no," list all the owners and their respective interests below.

Owner	Land Description

SECTION B

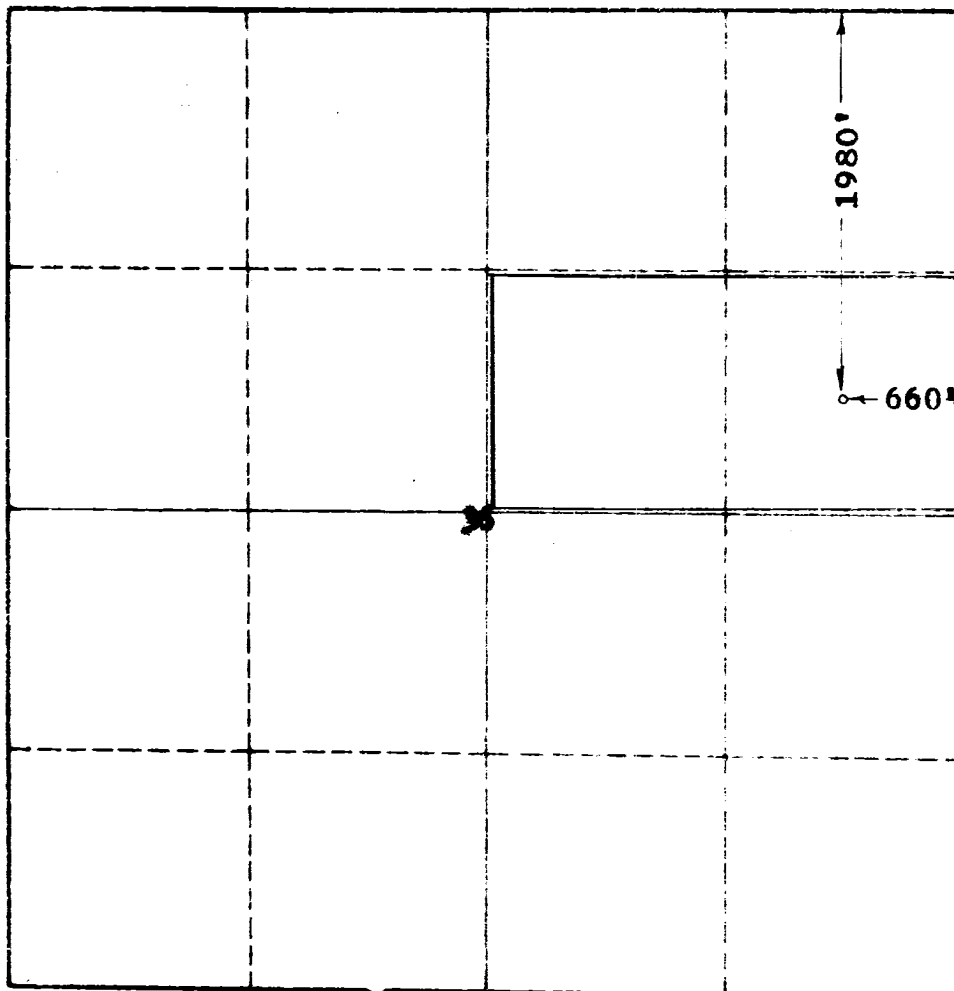

CERTIFICATION

I hereby certify that the information in SECTION A above is true and complete to the best of my knowledge and belief.

Name *R. E. Station*
Position **R. E. Station**
District Engineer
Company
Sunray Mid-Continent Oil Co.
Date
May 8, 1961

I hereby certify that the location shown on the plat in SECTION B was plotted from field notes of actual survey made by **676** under my supervision, and that the same is true and correct to the best of my knowledge and belief.

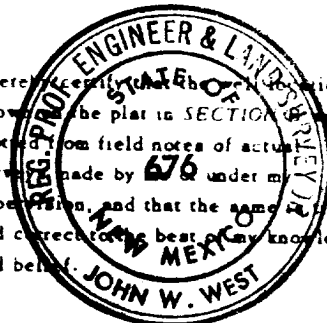

Date Surveyed
May 6, 1961
Registered Professional Engineer
and/or Land Surveyor, **JOHN W. WEST**
John W. West
Certificate No.
N.M. - P.E. & L.S. NO. 676