

FEB 3 1962

Budget Bureau No. 42-R358.4.  
Approval expires 12-31-60.

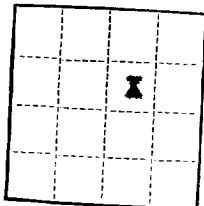

E. W. STANDLEY  
DISTRICT ENGINEER

(SUBMIT IN TRIPLICATE)

UNITED STATES  
DEPARTMENT OF THE INTERIOR  
GEOLOGICAL SURVEY

Land Office **Las Cruces**

Lease No. **062178**

Unit **0**

SUNDRY NOTICES AND REPORTS ON WELLS

NOTICE OF INTENTION TO DRILL	<input checked="" type="checkbox"/>	SUBSEQUENT REPORT OF WATER SHUT-OFF	
NOTICE OF INTENTION TO CHANGE PLANS		SUBSEQUENT REPORT OF SHOOTING OR ACIDIZING	
NOTICE OF INTENTION TO TEST WATER SHUT-OFF		SUBSEQUENT REPORT OF ALTERING CASING	
NOTICE OF INTENTION TO RE-DRILL OR REPAIR WELL		SUBSEQUENT REPORT OF RE-DRILLING OR REPAIR	
NOTICE OF INTENTION TO SHOOT OR ACIDIZE		SUBSEQUENT REPORT OF ABANDONMENT	
NOTICE OF INTENTION TO PULL OR ALTER CASING		SUPPLEMENTARY WELL HISTORY	
NOTICE OF INTENTION TO ABANDON WELL			

(INDICATE ABOVE BY CHECK MARK NATURE OF REPORT, NOTICE, OR OTHER DATA)

N. M. Federal #7\*

February 2

19 62

Well No. **5** is located **1980** ft. from **[N]** line and **1980** ft. from **[E]** line of sec. **13**

**SW/4 of NE/4**

(1/4 Sec. and Sec. No.)

**88**

(Twp.)

**34E**

(Range)

(Meridian)

**Wilkesand San Andres**

(Field)

**Roosevelt**

(County or Subdivision)

**New Mexico**

(State or Territory)

The elevation of the derrick floor above sea level is **4210** ft. (est)

DETAILS OF WORK

(State names of and expected depths to objective sands; show sizes, weights, and lengths of proposed casings; indicate mudding jobs, cementing points, and all other important proposed work)

1. Set 8 5/8" 21# csg @ 350' and circ out. Pressure test csg to 1000 psi for 30 min.
2. Set 4 1/2" 9.5# csg @ 4700'. Out with 200 sx out. Pressure test csg to 1000 psi for 30 min.
3. Perforate San Andres and sand oil frac w/20,000 gallons refined oil and sand in 4 stages using rubber balls.
4. Run tubing and put well on production.

I understand that this plan of work must receive approval in writing by the Geological Survey before operations may be commenced.

Company **Sunray Mid-Continent Oil Company**

Address **Box 123**

**Hobbs, New Mexico**

By

*C. J. Bond*

Title

**C. J. Bond  
Staff Engineer**

NEW MEXICO OIL CONSERVATION COMMISSION  
WELL LOCATION AND ACREAGE DEDICATION PLAT

FORM C-128  
Revised 5/1/57

SEE INSTRUCTIONS FOR COMPLETING THIS FORM ON THE REVERSE SIDE

SECTION A

Operator <b>SunRay-Midcontinent Oil Co.</b>		Lease <b>New Mexico-Federal</b> <b>npw</b>		Well No. <b>3</b>
Unit Letter <b>G</b>	Section <b>13</b>	Township <b>8 South</b>	Range <b>34 East</b>	County <b>Roosevelt</b>
Actual Footage Location of Well: <b>1980</b> feet from the <b>north</b> line and <b>1980</b> feet from the <b>east</b> line				
Ground Level Elev. <b>4240 (est)</b>	Producing Formation <b>San Andres</b>	Pool <b>Milnesand San Andres</b>	Dedicated Acreage: <b>10</b> Acres	

1. Is the Operator the only owner in the dedicated acreage outlined on the plat below? YES ☒ NO ☐ ("Owner" means the person who has the right to drill into and to produce from any pool and to appropriate the production either for himself or for himself and another. (65-3-29 (e) NMSA 1935 Comp.)
2. If the answer to question one is "no," have the interests of all the owners been consolidated by communication agreement or otherwise? YES ☐ NO ☐ If answer is "yes," Type of Consolidation **Partnership - Seaboard Oil Company**
3. If the answer to question two is "no," list all the owners and their respective interests below:

Owner	Land Description

SECTION B

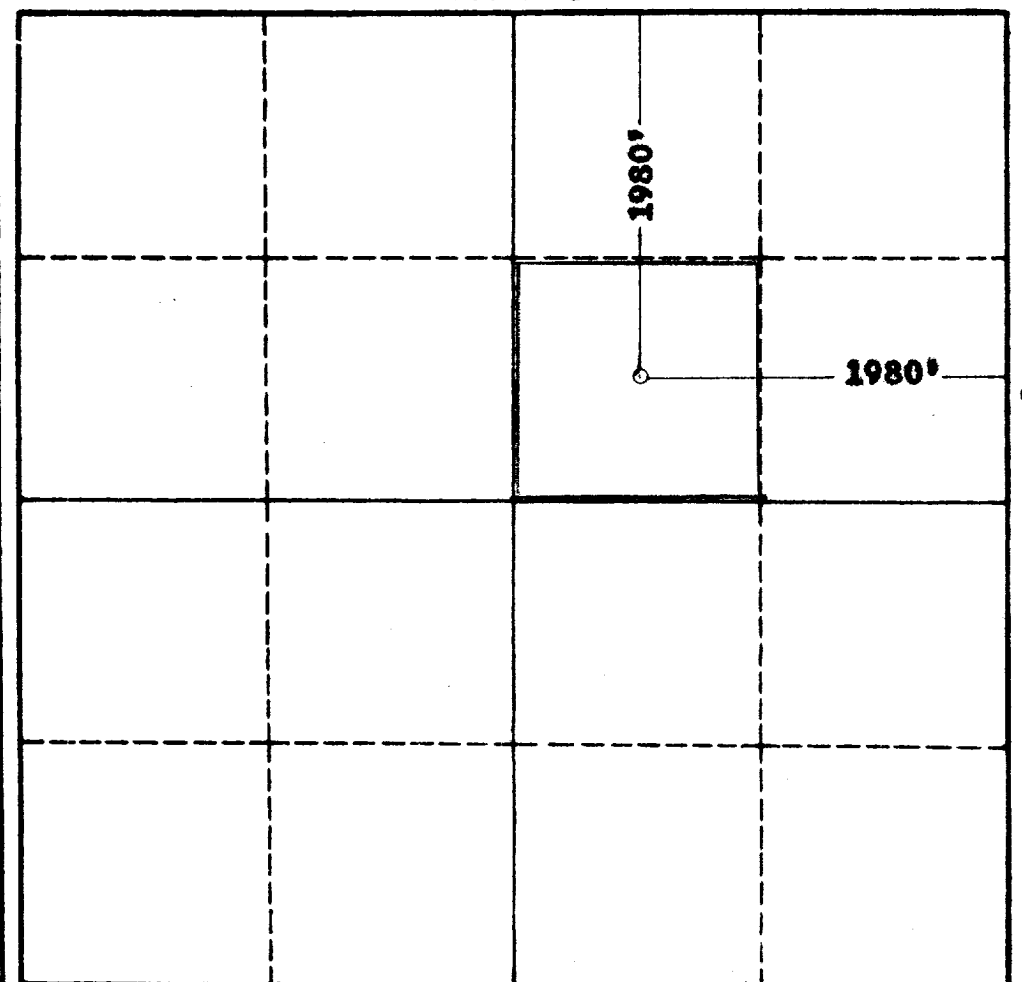

CERTIFICATION

I hereby certify that the information in SECTION A above is true and complete to the best of my knowledge and belief.

Name **Charlie J. Bord**  
Position **Chief Engineer**  
**Sunray Mid-Continent Oil Co.**  
**February 2, 1962**

I hereby certify that the well location shown on the plat in SECTION B was plotted from field notes of actual surveys made by me or under my supervision, and that the same is true and correct to the best of my knowledge and belief.

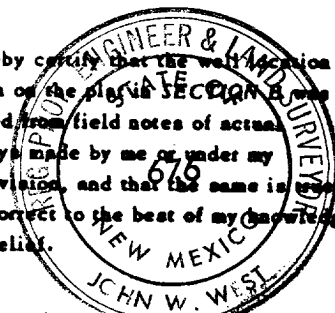

Date Surveyed **Feb. 2, 1962**  
Registered Professional Engineer and/or Land Surveyor, **JOHN W. WEST**

**John W. West**  
Certificate No. **676**  
N.M. - P.E. & L.S. NO. 676