



IN REPLY REFER TO:

UNITED STATES  
DEPARTMENT OF THE INTERIOR  
GEOLOGICAL SURVEY  
P.O. Box 128  
Hobbs, New Mexico

January 14, 1957

Sunray Mid-Continent Oil Company  
Box 128  
Hobbs, New Mexico

Re: Lease Las Cruces 062178

Gentlemen:

Receipt is acknowledged of "Notice of Intention to Drill" dated January 7, 1957, covering your well No. 1 New Mexico Lease at "F" on the subject leasehold in the E1/4 Sec. 13, T. 2 S., R. 3 E., S. 34 N., E. 34 W., Roosevelt County, New Mexico.

Your proposed work is approved subject to compliance with the provisions of the "Oil and Gas Operating Regulations" revised May 25, 1942, copy of which will be furnished you on request, and subject to the following condition:

1. Drilling operations so authorized are subject to the attached sheet (revised February, 1956) for general conditions of approval.

Very truly yours,

H. A. Durant  
District Engineer

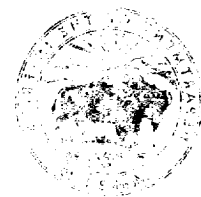

UNITED STATES  
DEPARTMENT OF THE INTERIOR  
GEOLOGICAL SURVEY

IN REPLY REFER TO:

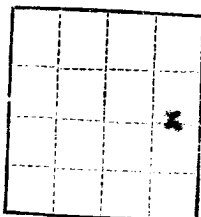

(SUBMIT IN TRIPLICATE)

UNITED STATES  
DEPARTMENT OF THE INTERIOR  
GEOLOGICAL SURVEY

Land Office 1.25 OFFICE

Lease No. 104170

Unit 1

SUNDRY NOTICES AND REPORTS ON WELLS

NOTICE OF INTENTION TO DRILL	<input checked="" type="checkbox"/>	SUBSEQUENT REPORT OF WATER SHUT-OFF	
NOTICE OF INTENTION TO CHANGE PLANS		SUBSEQUENT REPORT OF SHOOTING OR ACIDIZING	
NOTICE OF INTENTION TO TEST WATER SHUT-OFF		SUBSEQUENT REPORT OF ALTERING CASING	
NOTICE OF INTENTION TO RE-DRILL OR REPAIR WELL		SUBSEQUENT REPORT OF RE-DRILLING OR REPAIR	
NOTICE OF INTENTION TO SHOOT OR ACIDIZE		SUBSEQUENT REPORT OF ABANDONMENT	
NOTICE OF INTENTION TO PULL OR ALTER CASING		SUPPLEMENTARY WELL HISTORY	
NOTICE OF INTENTION TO ABANDON WELL			

(INDICATE ABOVE BY CHECK MARK NATURE OF REPORT, NOTICE, OR OTHER DATA)

U.S. Federal "F"

January 7, 1957

Well No. 1 is located 1980 ft. from N line and 660 ft. from E line of sec. 13

SE/4 of T4/4  
(1/4 Sec. and Sec. No.)

6-3  
(Twp.)

34-E  
(Range)

(Meridian)

Undesignated  
(Field)

Roosevelt  
(County or Subdivision)

(County or Subdivision)

New Mexico  
(State or Territory)

The elevation of the derrick floor above sea level is \_\_\_\_\_ ft.

DETAILS OF WORK

(State names of and expected depths to objective sands; show sizes, weights, and lengths of proposed casings; indicate mudding jobs, cementing points, and all other important proposed work)

Proposed 10,000' Ferno-Penn Test as follows:

- To set 450' 13 3/8" surface casing and cement to surface.
- To set 4800' 9 5/8" intermediate casing and cement to surface.
- To set 10,000' 5 1/2" oil string with sufficient cement to reach at least 500' above pay zone.
- To perforate selected zones, using acid and frac job if necessary during completion.

I understand that this plan of work must receive approval in writing by the Geological Survey before operations may be commenced.

Company Sunray Mid-Continent Oil Company

Address Box 128

Hobbs, New Mexico

By

Title Hobbs Area Superintendent

NEW MEXICO  
OIL CONSERVATION COMMISSION

Form C-128

Well Location and/or Gas Proration Plat

Date 1-4-57

Operator Sunray Mid-Continent Oil Co. Lease New Mexico Federal F

Well No. 1 Section 13 Township 8 South Range 34 East NMPM

Located 1980 Feet From North Line, 660 Feet From East Line,

Roosevelt County, New Mexico. G. L. Elevation \_\_\_\_\_

Name of Producing Formation Permo-Penn Pool Undesignated Dedicated Acreage 40

(Note: All distances must be from outer boundaries of Section)

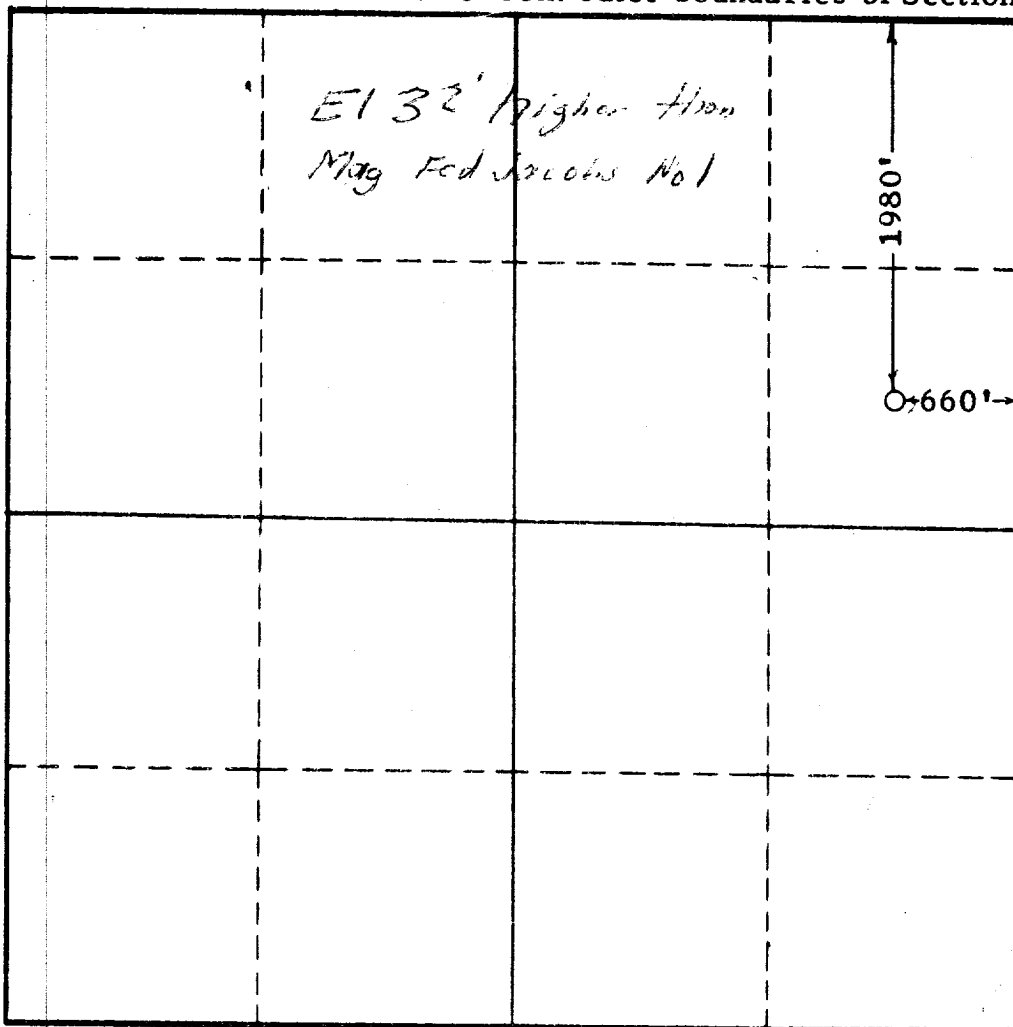

RECORDED  
JAN 13 1957  
U. S. DEPT. OF THE INTERIOR  
BUREAU OF LAND MANAGEMENT

1. Is this Well a Dual Comp. ? Yes No ~~X~~
2. If the answer to Question 1 is yes, are there any other dually completed wells within the dedicated acreage ? Yes \_\_\_\_\_ No \_\_\_\_\_

This is to certify that the above plat was prepared from field notes of actual surveys made by me or under my supervision and that the same are true and correct to the best of my knowledge and belief.

5:00 Pm

Date Surveyed 1-4-57

Name \_\_\_\_\_  
Position Hobbs Area Superintendent  
Representing Sunray Mid-Continent Oil Co.  
Address Box 128 - Hobbs, New Mexico

Registered John W. White  
Professional Engineer and/or  
Land Surveyor