

APPROVED

COPY TO O. C. C.

Form 9-331a
(Feb. 1961)Budget Bureau No. 42-R368.4.
Approval expires 12-31-60.

NOV 22 1961

(SUBMIT IN TRIPLICATE)

Land Office **Santa Fe.**Lease No. **NS 03283**

Unit _____

Lot No. **2**

NOV 22 1961

U. S. GEOLOGICAL SURVEY
HOBBS, NEW MEXICO

SUNDRY NOTICES AND REPORTS ON WELLS

NOTICE OF INTENTION TO DRILL.....	<input checked="" type="checkbox"/>	SUBSEQUENT REPORT OF WATER SHUT-OFF.....	
NOTICE OF INTENTION TO CHANGE PLANS.....		SUBSEQUENT REPORT OF SHOOTING OR ACIDIZING.....	
NOTICE OF INTENTION TO TEST WATER SHUT-OFF.....		SUBSEQUENT REPORT OF ALTERING CASING.....	
NOTICE OF INTENTION TO RE-DRILL OR REPAIR WELL.....		SUBSEQUENT REPORT OF RE-DRILLING OR REPAIR.....	
NOTICE OF INTENTION TO SHOOT OR ACIDIZE.....		SUBSEQUENT REPORT OF ABANDONMENT.....	
NOTICE OF INTENTION TO PULL OR ALTER CASING.....		SUPPLEMENTARY WELL HISTORY.....	
NOTICE OF INTENTION TO ABANDON WELL.....			

(INDICATE ABOVE BY CHECK MARK NATURE OF REPORT, NOTICE, OR OTHER DATA)

November 17, 1961

Well No. **2** is located **1874** ft. from **N** line and **1874** ft. from **W** line of sec. **33**
33 (1/4 Sec. and Sec. No.) **33** (Twp.) **37 E** (Range) **N.M.P.M.** (Meridian)
Allison-Penn (Field) **Donnovolt** (County or Subdivision) **New Mexico** (State or Territory)

The elevation of the derrick floor above sea level is _____ ft.

DETAILS OF WORK

(State names of and expected depths to objective sands; show sizes, weights, and lengths of proposed casings; indicate mudding jobs, cementing points, and all other important proposed work)

1. Proposal is to drill 15" hole to approximately 400' and set 10 1/4" casing at 400'. Cement will be circulated.
2. 9 7/8" hole will be drilled to approximately 4250' and 7 1/2" casing will be set at 4250' and cemented to top of salt.
3. 6 3/4" hole will be drilled to approximately 9700' or to a depth to adequately test the Rough "C" Zone.
4. 4 1/2" casing will be set & cemented at total depth.

I understand that this plan of work must receive approval in writing by the Geological Survey before operations may be commenced.

Company **S. P. YATES**Address **309 Carter Building****Artesia, New Mexico**

By

Drig. Supt.

Title

NEW MEXICO OIL CONSERVATION COMMISSION

WELL LOCATION AND ACREAGE DEDICATION PLAT

FORM C-128
Revised 5/1/57

SEE INSTRUCTIONS FOR COMPLETING THIS FORM ON THE REVERSE SIDE

SECTION A

Operator S.P. Yates		Lease LMY 25 MI 9 20		Well No. 2
Unit Letter F	Section 33	Township 8 South	Range 37 East	County Roosevelt
Actual Footage Location of Well: 1874 feet from the North line and 1874 feet from the West line				
Ground Level Elev.	Producing Formation	Pool	Dedicated Acreage: Acres	

1. Is the Operator the only owner in the dedicated acreage outlined on the plat below? (If "yes," "Owner" means the person who has the right to drill into and to produce from any pool and to appropriate the production either for himself or for himself and another. (65-3-29 (e) NMSA 1935 Comp.)
2. If the answer to question one is "no," have the interests of all the owners been considered by communitization agreement or otherwise? YES _____ NO _____. If answer is "yes," Type of Communitization _____
3. If the answer to question two is "no," list all the owners and their respective interests below.

Owner	and Dev. Int.

SECTION B

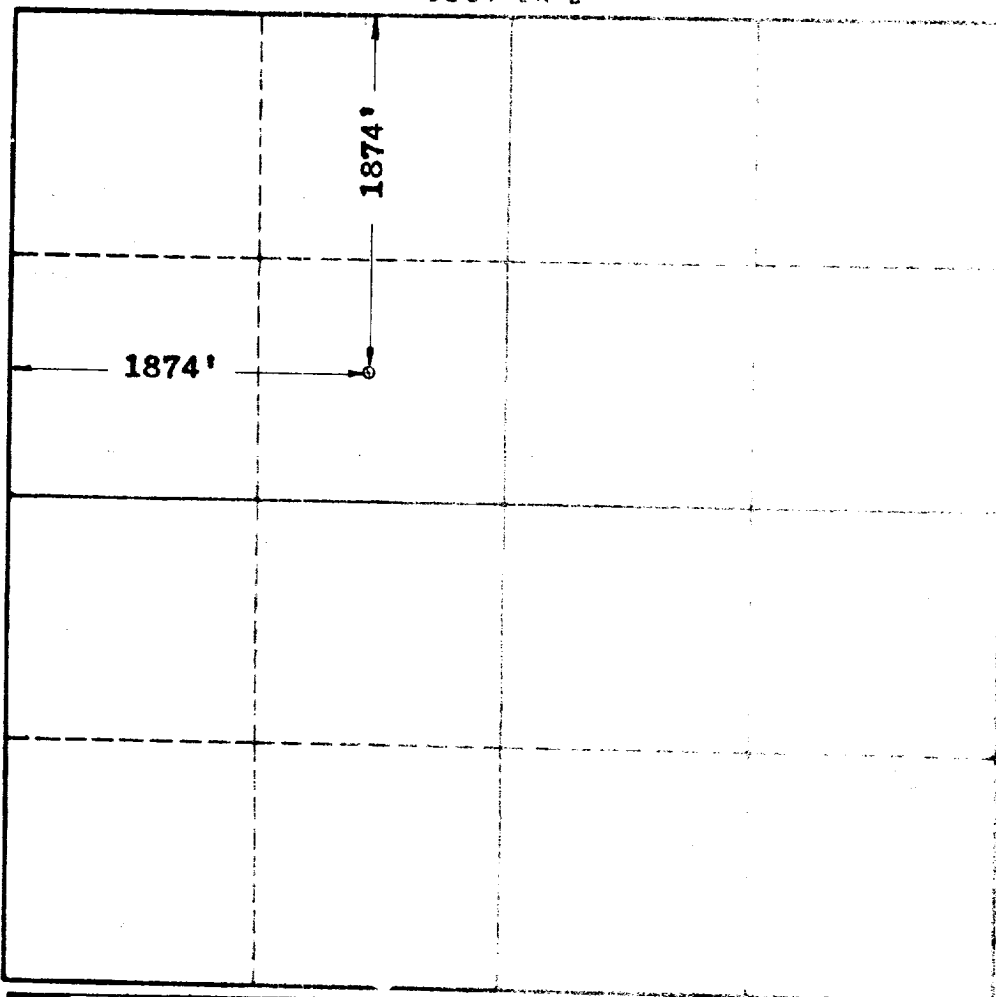

CERTIFICATION

I hereby certify that the information in SECTION A above is true and complete to the best of my knowledge and belief.

Calvin J. Smith
Dir. Dept.

S. P. YATES
Nov. 20, 1961

I hereby certify that the well location shown on the plat in SECTION B was plotted from field notes of actual surveys made by me or under my supervision, and that the same is true and correct to the best of my knowledge and belief.

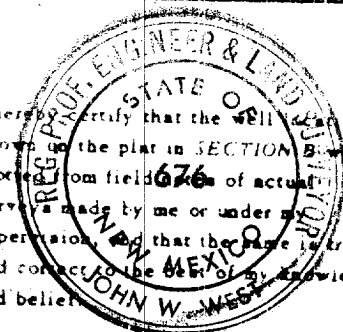

Date Surveyed
11-17-61
Registered Professional Engineer
and/or Land Surveyor, **JOHN W. WEST**
John W. West
Certificate No.
N.M. P.E. & L.S. NO. 676

0 330 660 990 1320 1650 1980 2310 2640 2970 3300 3630 3960 4290 4620 4950