

COPIES RECEIVED	
DISTRIBUTION	
SANTA FE	
FILE	
U.S.O.	
LAND OFFICE	
TRANSPORTER	OIL GAS
PRODUCTION OFFICE	
OPERATOR	

NEW MEXICO OIL CONSERVATION COMMISSION
SANTA FE, NEW MEXICO
CERTIFICATE OF COMPLIANCE AND AUTHORIZATION
TO TRANSPORT OIL AND NATURAL GAS

FORM C-110
 (Rev. 7-60)

FILE THE ORIGINAL AND 4 COPIES WITH THE APPROPRIATE OFFICE

Company or Operator Yates Drilling Company				Lease Lillie M. Yates		Well No. 3	
Unit Letter F	Section 31	Township 8 S	Range 37 E	County Roosevelt			
Pool Allison-Penn.				Kind of Lease (State, Fed Fee) Federal			
If well produces oil or condensate give location of tanks			Unit Letter M	Section 31	Township 8 S	Range 37 E	
Authorized transporter of oil <input checked="" type="checkbox"/> or condensate <input type="checkbox"/> Mobil Oil Company				Address (give address to which approved copy of this form is to be sent) Box 1072, Midland, Texas			

Is Gas Actually Connected? Yes ☒ No ☐

Authorized transporter of casing head gas <input checked="" type="checkbox"/> or dry gas <input type="checkbox"/> Hearburg and Ingram		Date Connected 9-1-61	Address (give address to which approved copy of this form is to be sent) Box 1757, Roswell, New Mexico
---	--	---------------------------------	--

If gas is not being sold, give reasons and also explain its present disposition:

REASON(S) FOR FILING (please check proper box)

- | | |
|--|--|
| New Well <input type="checkbox"/> | Change in Ownership <input type="checkbox"/> |
| Change in Transporter (check one) | Other (explain below) |
| Oil <input type="checkbox"/> Dry Gas <input type="checkbox"/> | |
| Casing head gas <input type="checkbox"/> Condensate <input type="checkbox"/> | |

Remarks

Started Processing Gas 10-1-61.

The undersigned certifies that the Rules and Regulations of the Oil Conservation Commission have been complied with.

Executed this the **4th** day of **October**, 19 **61**.

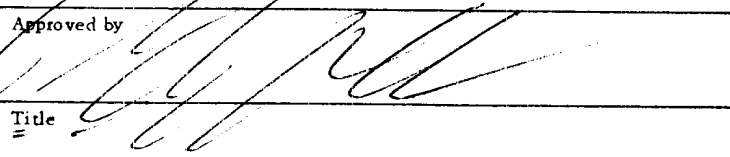
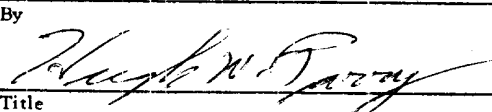
OIL CONSERVATION COMMISSION		By
Approved by 		
Title		Secretary-Treasurer
Date		Company Yates Drilling Company
		Address 309 Carper Bldg., Artesia, New Mexico

1. The first part of the document is a list of names.

2. The second part is a list of dates.

3. The third part is a list of locations.

4. The fourth part is a list of events.

5. The fifth part is a list of people.

6. The sixth part is a list of organizations.

7. The seventh part is a list of countries.

8. The eighth part is a list of cities.

9. The ninth part is a list of states.

10. The tenth part is a list of counties.

11. The eleventh part is a list of towns.

12. The twelfth part is a list of villages.

13. The thirteenth part is a list of hamlets.

14. The fourteenth part is a list of parishes.

15. The fifteenth part is a list of manors.

16. The sixteenth part is a list of estates.

17. The seventeenth part is a list of lands.

18. The eighteenth part is a list of tenements.

19. The nineteenth part is a list of houses.

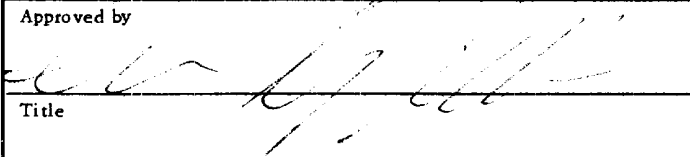
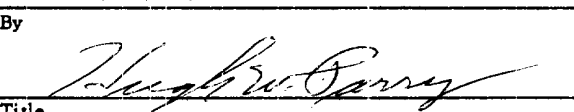
NUMBER OF COPIES RECEIVED DISTRIBUTION SANTA FE FILE U.S.G.S. LAND OFFICE TRANSPORTER OIL GAS PRORATION OFFICE OPERATOR		NEW MEXICO OIL CONSERVATION COMMISSION SANTA FE, NEW MEXICO CERTIFICATE OF COMPLIANCE AND AUTHORIZATION TO TRANSPORT OIL AND NATURAL GAS		FORM C-110 (Rev. 7-60)
FILE THE ORIGINAL AND 4 COPIES WITH THE APPROPRIATE OFFICE				
Company or Operator YATES DRILLING COMPANY		Lease Lillie M. Yates		Well No 3
Unit Letter F	Section 31	Township 8 S	Range 37 E	County Roosevelt
Pool Allison-Penn			Kind of Lease (State, Fed, Fee) Federal	
If well produces oil or condensate give location of tanks		Unit Letter H	Section 31	Township 8 S
Authorized transporter of oil <input type="checkbox"/> or condensate <input type="checkbox"/> Mobil Pipeline Company		Address (give address to which approved copy of this form is to be sent) Box 1073, Midland, Texas		
Is Gas Actually Connected? Yes <input checked="" type="checkbox"/> No <input type="checkbox"/>				
Authorized transporter of casing head gas <input type="checkbox"/> or dry gas <input type="checkbox"/> HEARDURG & INGRAM		Date Connected 9-1-61	Address (give address to which approved copy of this form is to be sent) Box 1757, Roswell, New Mexico	
If gas is not being sold, give reasons and also explain its present disposition:				
REASON(S) FOR FILING (please check proper box)				
New Well <input type="checkbox"/> Change in Ownership <input type="checkbox"/> Change in Transporter (check one) Other (explain below) Oil <input checked="" type="checkbox"/> Dry Gas <input type="checkbox"/> Casing head gas . <input checked="" type="checkbox"/> Condensate.. <input type="checkbox"/>				
Remarks				
The undersigned certifies that the Rules and Regulations of the Oil Conservation Commission have been complied with.				
Executed this the 1st day of September , 19 1961				
OIL CONSERVATION COMMISSION Approved by  Title Date		By  Title Agent Company Yates DRILLING COMPANY Address 309 Carper Bldg., Artesia, N.M.		

NUMBER OF COPIES RECEIVED	
DISTRIBUTION	
SANTA FE	
FILE	
U.S.G.S.	
LAND OFFICE	
TRANSPORTER	OIL
	GAS
PRODUCTION OFFICE	
OPERATOR	

NEW MEXICO OIL CONSERVATION COMMISSION
SANTA FE, NEW MEXICO

CERTIFICATE OF COMPLIANCE AND AUTHORIZATION TO TRANSPORT OIL AND NATURAL GAS

FORM C-110
(Rev. 7-60)

FILE THE ORIGINAL AND 4 COPIES WITH THE APPROPRIATE OFFICE

Company or Operator Yates Drilling Company				Lease Lillie M. Yates		Well No. 3	
Unit Letter F	Section 31	Township 8S	Range 37E	County Roosevelt			
Pool Allison-Pennsylvanian				Kind of Lease (State, Fed, Fee) Federal			
If well produces oil or condensate give location of tanks		Unit Letter	Section	Township	Range		
Authorized transporter of oil <input checked="" type="checkbox"/> or condensate <input type="checkbox"/> Mobil Pipeline Company				Address (give address to which approved copy of this form is to be sent) Box 1073, Midland, Texas			
Is Gas Actually Connected? Yes <input type="checkbox"/> No <input checked="" type="checkbox"/>							
Authorized transporter of casing head gas <input type="checkbox"/> or dry gas <input type="checkbox"/>		Date Connected	Address (give address to which approved copy of this form is to be sent)				

If gas is not being sold, give reasons and also explain its present disposition:

Small Amount of Gas is being vented. No Market yet.

REASON(S) FOR FILING (please check proper box)

New Well ☐ Change in Ownership ☐
 Change in Transporter (check one) Other (explain below)
 Oil ☐ Dry Gas ☐
 Casing head gas . ☐ Condensate... ☐

Placing Undesignated well in pool.

Remarks

The undersigned certifies that the Rules and Regulations of the Oil Conservation Commission have been complied with.

Executed this the **12th** day of **July**, 19 **61**.

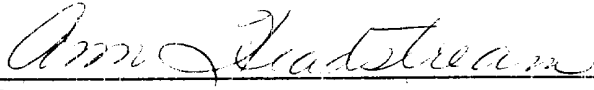
OIL CONSERVATION COMMISSION		By
Approved by		
Title		Production Clerk
Date	Company	Yates Drilling Company
	Address	309 Carper Building Artesia, New Mexico

OIL CONSERVATION COMMISSION

HOBBS, NEW MEXICO

June 15, 1961

Yates Drilling Company
309 Carper Building
Artesia, New Mexico

SUBJECT: Undesignated Well
Placed in Pool

Gentlemen:

In accordance with the provisions of Commission Order No. R- 1981 ,
your Lillie M. Yates No. 3 oil well in Unit F of
Section 31 , Township 8 South, Range 37 East, currently listed
in the Undesignated Section of the Proration Schedule, will
appear in the ALLISON-PENNSYLVANIAN Pool in the
AUGUST Schedule.

Please file Form C-110 with this office showing the change in pool
designation.

Yours very truly,

OIL CONSERVATION COMMISSION

Joe D. Ramey
Proration Manager

JDR:mg
Copy to
NMOCC Nomenclature - Santa Fe

NUMBER OF COPIES RECEIVED	
DISTRIBUTION	
SANTA FE	
FILE	
U.S.G.S.	
LAND OFFICE	
TRANSPORTER	OIL GAS
PRORATION OFFICE	
OPERATOR	

NEW MEXICO OIL CONSERVATION COMMISSION

(Form C-104)
Revised 7/1/57

Santa Fe, New Mexico

REQUEST FOR (OIL) - (GAS) ALLOWABLE

New Well
Recompletion

This form shall be submitted by the operator before an initial allowable will be assigned to any completed Oil or Gas well. Form C-104 is to be submitted in QUADRUPLICATE to the same District Office to which Form C-101 was sent. The allowable will be assigned effective 7:00 A.M. on date of completion or recompletion, provided this form is filed during calendar month of completion or recompletion. The completion date shall be that date in the case of an oil well when new oil is delivered into the stock tanks. Gas must be reported on 15.025 psia at 60° Fahrenheit.

Artesia, N. M. March 30, 1961
(Place) (Date)

WE ARE HEREBY REQUESTING AN ALLOWABLE FOR A WELL KNOWN AS:

Yates Drilling Co. Lillie M. Yates No. 3, in SE 1/4 NW 1/4,
(Company or Operator) (Lease)

P, Sec. 31, T. 8S, R. 37E, NMPM, Allison-Penn. Pool
Unit Letter

Roosevelt

Please indicate location:

D	C	B	A
E	F	G	H
L	K	J	I
M	N	O	P

County. Date Spudded 2-16-61 Date Drilling Completed 3-29-61

Elevation 4062.4 Total Depth 9730 PBD 9671

Top Oil/Gas Pay 9640 Name of Prod. Form. Penn (Bough "C")

PRODUCING INTERVAL -

Perforations 9640-9660

Open Hole Depth Casing Shoe 9721 Depth Tubing 9635

OIL WELL TEST -

Natural Prod. Test: no test bbls. oil, bbls water in hrs, min. Size Choke

Test After Acid or Fracture Treatment (after recovery of volume of oil equal to volume of

load oil used): 260 bbls. oil, no bbls water in 24 hrs, min. Size 18/64

GAS WELL TEST -

Natural Prod. Test: MCF/Day; Hours flowed Choke Size

Method of Testing (pitot, back pressure, etc.):

Test After Acid or Fracture Treatment: MCF/Day; Hours flowed

Choke Size Method of Testing:

Acid or Fracture Treatment (Give amounts of materials used, such as acid, water, oil, and sand): 500 gals. spearhead acid plus 5000 gals. 15% reg. acid

Casing Tubing Date first new
Press. 250 Press. 1150 oil run to tanks March 29, 1961

Oil Transporter Mobil Pipeline Company

Gas Transporter No market

Remarks: Allison-Penn. Pool

I hereby certify that the information given above is true and complete to the best of my knowledge.

Approved: 19

Yates Drilling Company
(Company or Operator)

OIL CONSERVATION COMMISSION

By: Ken Reynolds
(Signature)

By:

Title: Drilling Superintendent
Send Communications regarding well to:

Title:

Name: Yates Drilling Company
Address: 309 Carper Building
Artesia, New Mexico

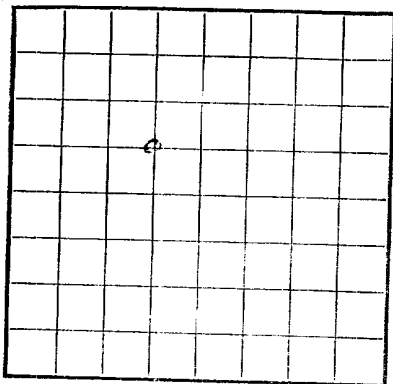

LOCATE WELL CORRECTLY

NOTED

MAR 30 1961

STANDLEY

UNITED STATES

DEPARTMENT OF THE INTERIOR

GEOLOGICAL SURVEY

U. S. LAND OFFICE

New Mexico

SERIAL NUMBER

03283

LEASE OR PERMIT TO PROSPECT

Lillie M. Yates

LOG OF OIL OR GAS WELL

Company **Yates Drilling Company** Address **309 Carper Bldg., Artesia, N. M.**
Lessor or Tract **Lillie M. Yates** Field **Allison-Penn** State **New Mexico**
Well No. **3** Sec. **31** T. **8S** R. **37E** Meridian **NMPH** County **Roosevelt**
Location **1980** ft. **N** of **N** Line and **1924** ft. **W** of **W** Line of **Sec. 31** Elevation **4062.4**
(Derrick floor relative to sea level)

The information given herewith is a complete and correct record of the well and all work done thereon so far as can be determined from all available records.

Signed

Date **March 30, 1961**Title **Drilling Superintendent**

The summary on this page is for the condition of the well at above date.

Commenced drilling **2-16**, 19 **61** Finished drilling **3-29**, 19 **61**

OIL OR GAS SANDS OR ZONES

(Denote gas by G)

No. 1, from **9640** to **9660** No. 4, from _____ to _____
No. 2, from _____ to _____ No. 5, from _____ to _____
No. 3, from _____ to _____ No. 6, from _____ to _____

IMPORTANT WATER SANDS

No. 1, from _____ to _____ No. 3, from _____ to _____
No. 2, from _____ to _____ No. 4, from _____ to _____

CASING RECORD

Size casing	Weight per foot	Threads per inch	Make	Amount	Kind of shoe	Cut and pulled from	Perforated		Purpose
							From—	To—	
13 3/8	44	8	API	120	API	Surface			Surface
8 5/8	32	8	API	100	API	Intermediate			Intermediate
4 1/2	17.50	8	API	921	API	Oil string			Oil string

MUDDING AND CEMENTING RECORD

Size casing	Where set	Number sacks of cement	Method used	Mud gravity	Amount of mud used
13 3/8	340	275 sx. req.	pump		2% gel
8 5/8	4175	150 req. & 100 units req. 400	pump		Same
4 1/2	9721	400 sx. req.	pump		2% gel

PLUGS AND ADAPTERS

Heaving plug—Material _____ Length _____ Depth set _____
Adapters—Material _____ Size _____

SHOOTING RECORD

Size	Shell used	Explosive used	Quantity	Date	Depth shot	Depth cleaned out
		see history				

TOOLS USED

Rotary tools were used from **0** feet to **9730** feet, and from _____ feet to _____ feet
Cable tools were used from _____ feet to _____ feet, and from _____ feet to _____ feet

DATES

March 30, 19 **61** Put to producing **March 29**, 19 **61**

The production for the first 24 hours was **260** barrels of fluid of which **100**% was oil; _____% emulsion; _____% water; and _____% sediment.

Gravity, °Bé. **48°**

If gas well, cu. ft. per 24 hours _____

Gallons gasoline per 1,000 cu. ft. of gas _____

Rock pressure, lbs. per sq. in. _____

EMPLOYEES

Ed Sanford, Driller**G. J. Williams**

Driller

LOG OF OIL OR GAS WELL

UNITED STATES
DEPARTMENT OF THE INTERIOR
GEOLOGICAL SURVEY

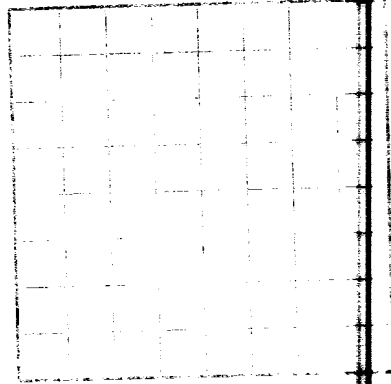

Yates Drilling Company
Address: 308 Barber Bldg., Amarillo, N. M.
Field: Allison-Penn State, New Mexico
County: Garfield
T. 38 R. 37 E. Meridian
S. 31 of line and 1/2 sec. 31
The information given herewith is a complete and correct record of the well and all work done thereon.
Signed: _____
Date: March 30, 1961

OIL OR GAS SANDS OR ZONES

IMPORTANT WATER SANDS

CASING RECORD

HISTORY OF OIL OR GAS WELL

MUDDING AND CEMENTING RECORD

PLUGS AND ADAPTERS

SHOOTING RECORD

TOOLS USED

DATES

EMPLOYEES

WATER

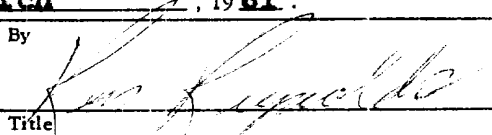
NUMBER OF COPIES RECEIVED DISTRIBUTION SANTA FE FILE U.S.G.S. LAND OFFICE TRANSPORTER PRODUCTION OFFICE OPERATOR		NEW MEXICO OIL CONSERVATION COMMISSION SANTA FE, NEW MEXICO CERTIFICATE OF COMPLIANCE AND AUTHORIZATION TO TRANSPORT OIL AND NATURAL GAS			FORM C-110 (Rev. 7-60)	
FILE THE ORIGINAL AND 4 COPIES WITH THE APPROPRIATE OFFICE						
Company or Operator Yates Drilling Company				Lease Lillie M. Yates		Well No. 3
Unit Letter F	Section 31	Township 8S	Range 37E	County Roosevelt		
Pool Allison-Penn.				Kind of Lease (State, Fed, Fee) Federal		
If well produces oil or condensate give location of tanks		Unit Letter M	Section 31	Township 8S	Range 37E	
Authorized transporter of oil <input checked="" type="checkbox"/> or condensate <input type="checkbox"/> Mobil Pipeline Company				Address (give address to which approved copy of this form is to be sent) Box 1073, Midland, Texas		
Is Gas Actually Connected? Yes _____ No <input checked="" type="checkbox"/>						
Authorized transporter of casing head gas <input type="checkbox"/> or dry gas <input type="checkbox"/>		Date Connected	Address (give address to which approved copy of this form is to be sent)			
If gas is not being sold, give reasons and also explain its present disposition: Small amount of gas is being vented, no market as yet.						
REASON(S) FOR FILING (please check proper box)						
New Well <input checked="" type="checkbox"/> Change in Ownership <input type="checkbox"/> Change in Transporter (check one) Other (explain below) Oil <input type="checkbox"/> Dry Gas <input type="checkbox"/> Casing head gas . <input type="checkbox"/> Condensate . . <input type="checkbox"/>						
Remarks						
The undersigned certifies that the Rules and Regulations of the Oil Conservation Commission have been complied with.						
Executed this the 30th day of March , 19 61 .						
OIL CONSERVATION COMMISSION				By		
Approved by						
Title				Drilling Superintendent		
Date				Company Yates Drilling Company		
				Address 309 Carper Building Artesia, New Mexico		

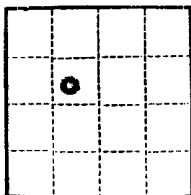
COPY TO O. O. C.
(SUBMIT IN TRIPLICATE)UNITED STATES
DEPARTMENT OF THE INTERIOR
GEOLOGICAL SURVEY

HOBB

Budget Bureau No. 42-R358.4
Approval expires 12-31-60.Land Office **New Mexico**
Lease No. **03203**
Unit **Lillie N. Yates**

SUNDRY NOTICES AND REPORTS ON WELLS

NOTICE OF INTENTION TO DRILL.....	<input checked="" type="checkbox"/>	SUBSEQUENT REPORT OF WATER SHUT-OFF.....
NOTICE OF INTENTION TO CHANGE PLANS.....		SUBSEQUENT REPORT OF SHOOTING OR ACIDIZING.....
NOTICE OF INTENTION TO TEST WATER SHUT-OFF.....		SUBSEQUENT REPORT OF ALTERING CASING.....
NOTICE OF INTENTION TO RE-DRILL OR REPAIR WELL.....		SUBSEQUENT REPORT OF RE-DRILLING OR REPAIR.....
NOTICE OF INTENTION TO SHOOT OR ACIDIZE.....		SUBSEQUENT REPORT OF ABANDONMENT.....
NOTICE OF INTENTION TO PULL OR ALTER CASING.....		SUPPLEMENTARY WELL HISTORY.....
NOTICE OF INTENTION TO ABANDON WELL.....		

(INDICATE ABOVE BY CHECK MARK NATURE OF REPORT, NOTICE, OR OTHER DATA)

February 6, 1961

Well No. 3 is located 1980 ft. from N line and 1924.6 ft. from W line of sec. 31

NW 31 88 37E TMPM
($\frac{1}{4}$ Sec. and Sec. No.) (Twp.) (Range) (Meridian)

Allison Penn. Roosevelt New Mexico
(Field) (County or Subdivision) (State or Territory)

The elevation of the derrick floor above sea level is 4062.4 ft.

DETAILS OF WORK

(State names of and expected depths to objective sands; show sizes, weights, and lengths of proposed casings; indicate mudding jobs, cementing points, and all other important proposed work)

We propose to drill with rotary tools to test the Allison-Penn. Field pay to expected top at approximately 9600 feet. Intend to set approx. 350 feet $13\frac{3}{8}$ " N-40 8R-R1 casing, cemented to surface. Intermediate string of 8 $5/8$ " J-55, 32# to 24# 8R-R2 & J casing, cemented to 4200 feet with cement back to base of salt section. Oil string of $4\frac{1}{2}$ ", 11.6#, J-55 & N-80 ss 8R-R2, casing will be set at total depth and sufficient cement will be used to protect all shallower zones of interest. Electric log will be furnished and we intend to abide by the rules and regulations of the Department.

I understand that this plan of work must receive approval in writing by the Geological Survey before operations may be commenced.

Company YATES DRILLING COMPANYAddress 309 Carper BuildingArtesia, New MexicoBy [Signature]Title Drilling Superintendent

NEW MEXICO OIL CONSERVATION COMMISSION
WELL LOCATION AND ACREAGE DEDICATION PLAT

FORM C-128
Revised 5/1/57

SEE INSTRUCTIONS FOR COMPLETING THIS FORM ON THE REVERSE SIDE

SECTION A

Operator Yates Drilling Co.		Lease Lillie M. Yates		Well No. 3
Unit Letter P.	Section 31	Township 8 South	Range 37 East	County Roosevelt
Actual Footage Location of Well: 1980 feet from the North line and 1924.6 feet from the West line				
Ground Level Elev. 4052.4	Producing Formation		Pool	Dedicated Acreage: Acres

1. Is the Operator the only owner in the dedicated acreage outlined on the plat below? YES _____ NO _____. ("Owner" means the person who has the right to drill into and to produce from any pool and to appropriate the production either for himself or for himself and another. (65-3-29 (e) NMSA 1935 Comp.)
2. If the answer to question one is "no," have the interests of all the owners been consolidated by communitization agreement or otherwise? YES _____ NO _____. If answer is "yes," Type of Consolidation _____
3. If the answer to question two is "no," list all the owners and their respective interests below:

Owner	Land Description

SECTION B

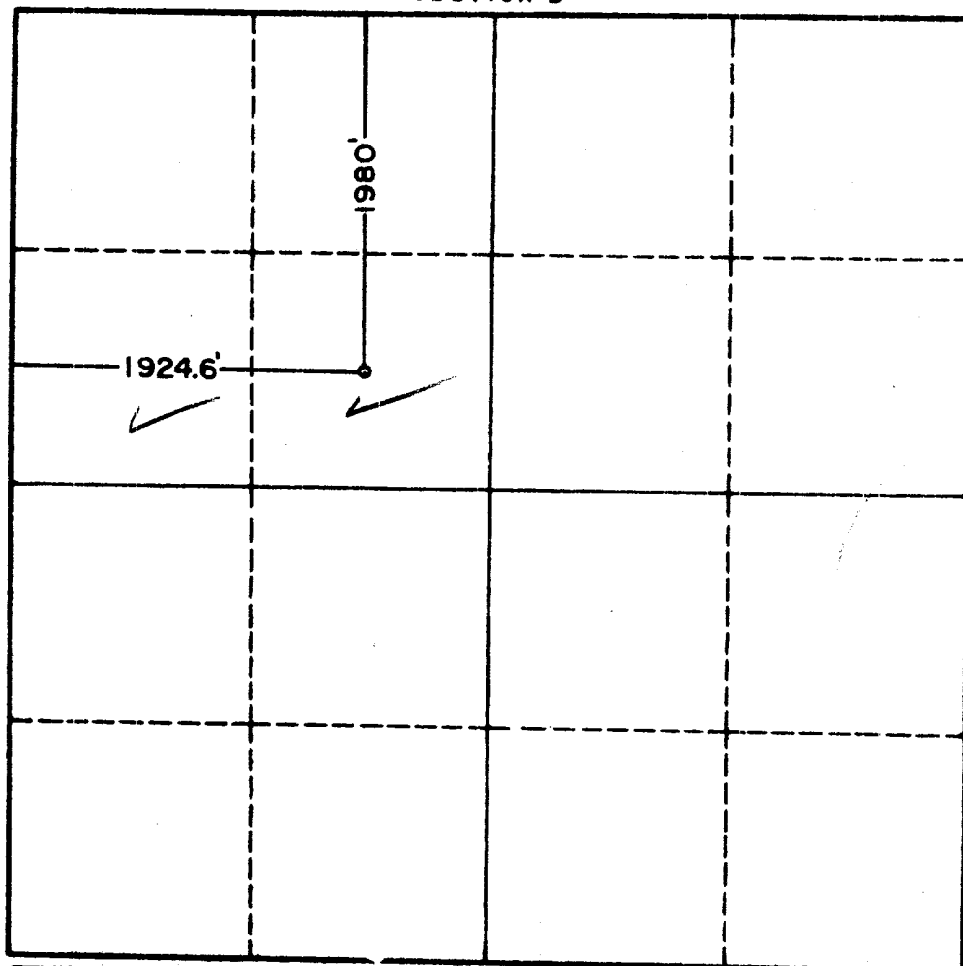

0 330 660 990 1320 1650 1980 2310 2640 2000 1600 1200 800

CERTIFICATION

I hereby certify that the information in SECTION A above is true and complete to the best of my knowledge and belief.

R.W. Landenberger, Jr.
Name
R.W. Landenberger, Jr.

Position
Geologist

Company
Yates Drilling Co.

Date
1/20/61

I hereby certify that the well location shown on the plat in SECTION B was plotted from field notes of actual surveys made by me or under my supervision and that the same is true and correct to the best of my knowledge and belief.

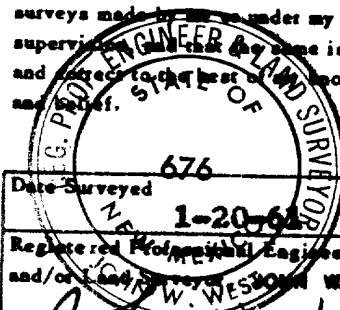

Date Surveyed
1-20-61
Registered Professional Engineer
and/or Land Surveyor
JOHN W. WEST
Certificate No.
N.M. - P.E. & L.S. NO. 676

