

	X		

E. W. STANDLEY
DISTRICT ENGINEER

(SUBMIT IN TRIPLICATE)

UNITED STATES
DEPARTMENT OF THE INTERIOR
GEOLOGICAL SURVEY

Land Office **Las Cruces**

Lease No. **L.C. 062949-A**

Uni

SUNDRY NOTICES AND REPORTS ON WELLS

NOTICE OF INTENTION TO DRILL	<input checked="" type="checkbox"/>	SUBSEQUENT REPORT OF WATER SHUT-OFF
NOTICE OF INTENTION TO CHANGE PLANS	<input type="checkbox"/>	SUBSEQUENT REPORT OF SHOOTING OR ACIDIZING
NOTICE OF INTENTION TO TEST WATER SHUT-OFF	<input type="checkbox"/>	SUBSEQUENT REPORT OF ALTERING CASING
NOTICE OF INTENTION TO RE-DRILL OR REPAIR WELL	<input type="checkbox"/>	SUBSEQUENT REPORT OF RE-DRILLING OR REPAIR
NOTICE OF INTENTION TO SHOOT OR ACIDIZE	<input type="checkbox"/>	SUBSEQUENT REPORT OF ABANDONMENT
NOTICE OF INTENTION TO PULL OR ALTER CASING	<input type="checkbox"/>	SUPPLEMENTARY WELL HISTORY
NOTICE OF INTENTION TO ABANDON WELL	<input type="checkbox"/>	

(INDICATE ABOVE BY CHECK MARK NATURE OF REPORT, NOTICE, OR OTHER DATA)

December 4, 1962

1 Ohio Federal

Well No. _____ is located **660** ft. from $\begin{matrix} \text{N} \\ \text{S} \end{matrix}$ line and **1980** ft. from $\begin{matrix} \text{E} \\ \text{W} \end{matrix}$ line of sec. **26**

SW/4 Sec. 26
($\frac{1}{4}$ Sec. and Sec. No.)

T-3-S
(Twp.)

R-34-E

(Meridian)

Undesignated
(Field)

Roosevelt

New Mexico

The elevation of the derrick floor above sea level is **4256** ft.

DETAILS OF WORK

(State names of and expected depths to objective sands; show sizes, weights, and lengths of proposed casings; indicate mudding jobs, cementing points, and all other important proposed work)

Drill 17" hole to 400 feet. Set 13 3/8" surface casing and circulate cement. Drill 12 1/4" and 11" hole 4000 feet. Set 8 5/8", 24# and 32# J-55 casing at 4000 feet and cement with 150 sacks cement. Drill 7 7/8" hole to approximately 9600 feet to test Baugh C. Set 4 1/2", 10.5# and 11.6# casing to total depth and cement with 150 sacks cement.

I understand that this plan of work must receive approval in writing by the Geological Survey before operations may be commenced.

Company Tom Brown Drilling Company, Inc.

Address **% Albritton & Meyer**

P. O. Box 324

Midland, Texas

Bv

Title **Agent**

NEW MEXICO OIL CONSERVATION COMMISSION
WELL LOCATION AND ACREAGE DEDICATION PLAT

FORM C-128
Revised 5/1/57

SEE INSTRUCTIONS FOR COMPLETING THIS FORM ON THE REVERSE SIDE

SECTION A

Operator TOM BROWN DRILLING COMPANY, INC.		Lease OHIO FEDERAL		Well No. 1
Unit Letter N	Section 26	Township 8 SOUTH	Range 34 EAST	County ROOSEVELT
Actual Footage Location of Well: 660 feet from the SOUTH line and 1980 feet from the WEST line				
Ground Level Elev. 4246.2	Producing Formation Bough C	Pool Undesignated	Dedicated Acreage: 80 Acres	

1. Is the Operator the only owner in the dedicated acreage outlined on the plat below? YES X NO ____ . ("Owner" means the person who has the right to drill into and to produce from any pool and to appropriate the production either for himself or for himself and another. (65-3-29 (e) NMSA 1935 (comp.))
2. If the answer to question one is "no," have the interests of all the owners been consolidated by communitization agreement or otherwise? YES ____ NO ____ . If answer is "yes," Type of Consolidation _____
3. If the answer to question two is "no," list all the owners and their respective interests below:

Owner Tom Brown Drilling Co., Inc.	Land Description E/2 SW/4
Sec. 26, T-8-S, R-34-E	

SECTION B

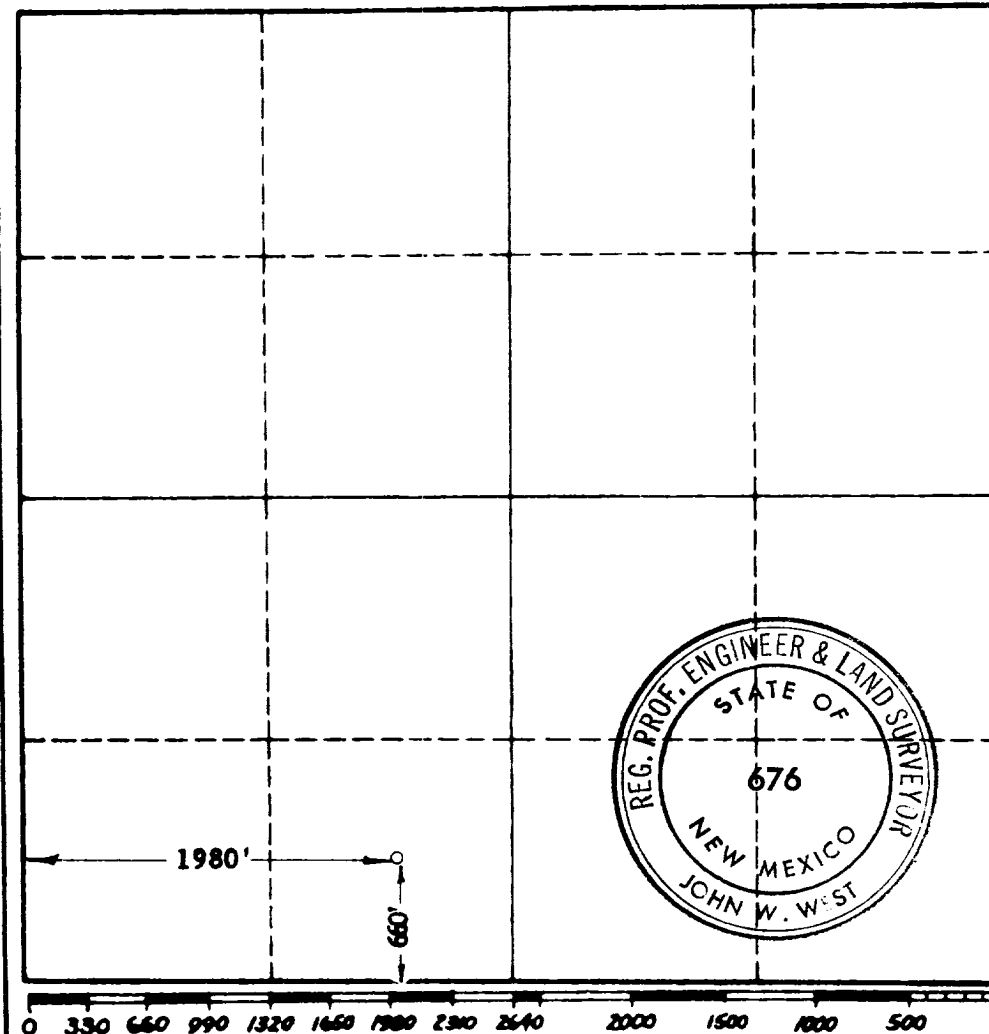

CERTIFICATION

I hereby certify that the information in SECTION A above is true and complete to the best of my knowledge and belief.

Name
Agent
Position
Tom Brown Drlg.Co., Inc.
Company
12-4-62
Date

I hereby certify that the well location shown on the plat in SECTION B was plotted from field notes of actual surveys made by me or under my supervision, and that the same is true and correct to the best of my knowledge and belief.

Date Surveyed
12-3-62
Registered Professional Engineer and/or Land Surveyor, **JOHN W. WEST**
Certificate No.
N.M. - P.E. & L.S. NO. 676