

NUMBER OF COPIES RECEIVED	
DISTRIBUTION	
SANTA FE	
FILE	
U.S.G.S.	
LAND OFFICE	
TRANSPORTER	OIL GAS
PRORATOR OFFICE	
OPERATOR	

Form C-101
Revised 12/1/55

NEW MEXICO OIL CONSERVATION COMMISSION

Santa Fe, New Mexico

HOBBS OFFICE O. C. C.

NOTICE OF INTENTION TO DRILL

APR 23 2 44 PM '64

Notice must be given to the District Office of the Oil Conservation Commission and approval obtained before drilling or recompletion begins. If changes in the proposed plan are considered advisable, a copy of this notice showing such changes will be returned to the sender. Submit this notice in QUINTUPLICATE. One copy will be returned following approval. See additional instructions in Rules and Regulations of the Commission. If State Land submit 6 Copies. Attach Form C-128 in triplicate to first 3 copies of Form C-101.

Hobbs, New Mexico

April 23, 1964

(Place)

(Date)

OIL CONSERVATION COMMISSION
SANTA FE, NEW MEXICO

Gentlemen:

You are hereby notified that it is our intention to commence the Drilling of a well to be known as

Cities Service Oil Company

(Company or Operator)

Pate A

, Well No. **6**

in **H**

The well is

(Lease)

(Unit)

located **1980'** feet from the **North** line and **660'** feet from the

East

line of Section **7**, T **8S**, R **35E**, NMPM.

(GIVE LOCATION FROM SECTION LINE)

Undesignated Pool, **Roosevelt** County

D	C	B	A
E	F	G	H
L	K	J	I
M	N	O	P

If State Land the Oil and Gas Lease is No.

If patented land the owner is **Cecil Pate**

Address **Milnesand, New Mexico**

We propose to drill well with drilling equipment as follows: **Rotary**

The status of plugging bond is **approved**

Drilling Contractor **Cactus Drilling Company**
San Angelo, Texas

We intend to complete this well in the **San Andres** formation at an approximate depth of **4700** feet.

CASING PROGRAM

We propose to use the following strings of Casing and to cement them as indicated:

Size of Hole	Size of Casing	Weight per Foot	New or Second Hand	Depth	Sacks Cement
11"	8-5/8"	24#	New	400'	Circulate
7-7/8"	4 1/2"	9.5#	New	4700'	300

If changes in the above plans become advisable we will notify you immediately.

ADDITIONAL INFORMATION (If recompletion give full details of proposed plan of work.)

Approved _____, 19____
Except as follows:

Sincerely yours,

Cities Service Oil Company

(Company or Operator)

By **C. R. Houston**

Position **District Clerk**

Send Communications regarding well to

Name **Mr. E. Y. Wilder**

Address **Box 69, Hobbs, New Mexico**

By **[Signature]**
OIL CONSERVATION COMMISSION

NEW MEXICO OIL CONSERVATION COMMISSION
WELL LOCATION AND ACREAGE DEDICATION

HOBBS OFFICE O. C. C. FORM C-128
Revised 5/1/57

APR 23 4 44 PM '64

SEE INSTRUCTIONS FOR COMPLETING THIS FORM ON THE REVERSE SIDE

SECTION A

Operator CITIES SERVICE OIL CO.		Lease PATE "A"		Well No. 6
Unit Letter H	Section 7	Township 8 SOUTH	Range 35 EAST	County ROOSEVELT
Actual Footage Location of Well: 1980 feet from the NORTH line and 660 feet from the EAST line				
Ground Level Elev.	Producing Formation San Andres		Pool Undesignated	Dedicated Acreage: 40 Acres

1. Is the Operator the only owner in the dedicated acreage outlined on the plat below? YES ☒ NO ____ ("Owner" means the person who has the right to drill into and to produce from any pool and to appropriate the production either for himself or for himself and another. (65-3-29 (e) NMSA 1935 Comp.)
2. If the answer to question one is "no," have the interests of all the owners been consolidated by communitization agreement or otherwise? YES ____ NO ____ . If answer is "yes," Type of Consolidation ____
3. If the answer to question two is "no," list all the owners and their respective interests below:

Owner	Land Description

SECTION B

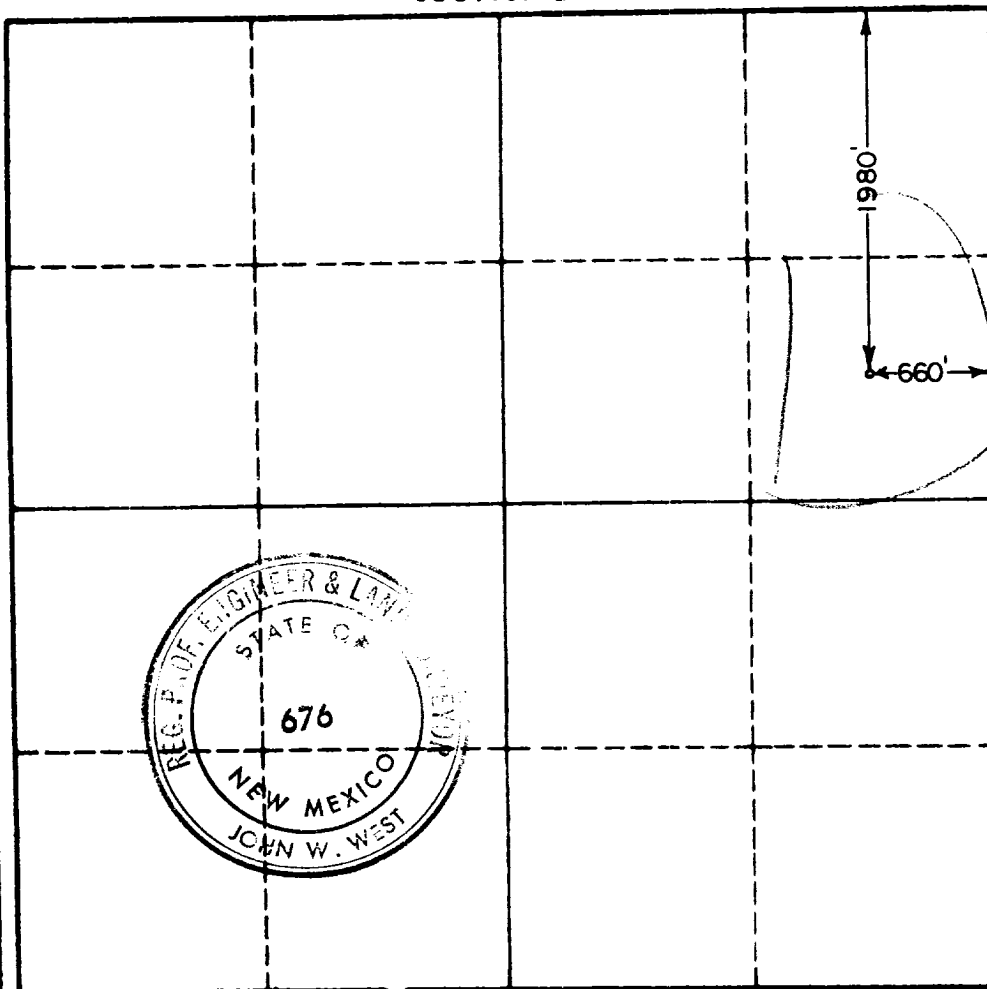

CERTIFICATION

I hereby certify that the information in SECTION A above is true and complete to the best of my knowledge and belief.

Name <i>C. D. Robertson</i>
Position District Clerk
Company Cities Service Oil Co.
Date April 23, 1964

I hereby certify that the well location shown on the plat in SECTION B was plotted from field notes of actual surveys made by me or under my supervision, and that the same is true and correct to the best of my knowledge and belief.

Date Surveyed 4-20-64
Registered Professional Engineer and/or Land Surveyor, JOHN W. WEST
Certificate No. W. M. - P. E. & L. S. NO. 676

0 330 660 990 1320 1650 1980 2310 2640 2970 3300 3630 3960 4290 4620 4950 5280 5610 5940 6270 6600