

NEW MEXICO OIL CONSERVATION COMMISSION
Santa Fe, New Mexico

(Form C-101)
(Rev. 11/52)

HOODS OFFICE
1962 DEC 3 AM 8

NOTICE OF INTENTION TO DRILL OR RECOMPLETE

Notice must be given to the District Office of the Oil Conservation Commission and approval obtained before drilling or recompletion begins. If changes in the proposed plan are considered advisable, a copy of this notice showing such changes will be returned to the sender. Submit this notice in **QUINTUPPLICATE**. One copy will be returned following approval. See additional instructions in Rules and Regulations of the Commission.

Midland, Texas

November 30, 1962

(Place)

(Date)

OIL CONSERVATION COMMISSION
SANTA FE, NEW MEXICO

Gentlemen:

You are hereby notified that it is our intention to commence the (Drilling) (Recompletion) of a well to be known as

Robert A. Dean

(Company or Operator)

G. W. Weathersby

(Lease)

Well No. **3**

in **F**

(Unit)

located **1980** feet from the **North** line and **1980** feet from the

West line of Section **24**, T. **-8-S**, R. **-34-E**, NMPM.

(GIVE LOCATION FROM SECTION LINE) **Milnesand San Andres** Pool, **Roosevelt** County

If State Land the Oil and Gas Lease is No.

If patented land the owner is

Address

We propose to drill well with drilling equipment as follows: **Rotary rig**

The status of plugging bond is **Blanket bond approved**

Drilling Contractor **I. W. Lovelady**
ABC Building
Odessa, Texas

We intend to complete this well in the **San Andres** formation at an approximate depth of **4600** feet.

CASING PROGRAM

We propose to use the following strings of Casing and to cement them as indicated:

Size of Hole	Size of Casing	Weight per Foot	New or Second Hand	Depth	Sacks Cement
10-3/4"	8-5/8"	28#	Used	450'	Circ. to surf.
7-1/8"	5-1/2"	15.5#	Used	4650'	250 sx

If changes in the above plans become advisable we will notify you immediately.

ADDITIONAL INFORMATION (If recompletion give full details of proposed plan of work.)

Approved _____, 19____
Except as follows:

OIL CONSERVATION COMMISSION

By _____
Title _____

Sincerely yours,

Robert A. Dean

(Company or Operator)

By _____

Position **Agent**

Send Communications regarding well to

Name **%V. Pickett**
Address **901 Midland Savings Bldg.**
Midland, Texas

NEW MEXICO OIL CONSERVATION COMMISSION
WELL LOCATION AND ACREAGE DEDICATION PLAT

FORM NO. 128
Revised 5/50

1962 DEC 3

SEE INSTRUCTIONS FOR COMPLETING THIS FORM ON THE REVERSE SIDE

SECTION A

Operator ROBERT A. DEAN		Lease G. W. WEATHERSBY		Well No. 3	
Unit Letter F	Section 24	Township 8 SOUTH	Range 34 EAST	County ROOSEVELT	
Actual Footage Location of Well: 1980 feet from the NORTH line and 1980 feet from the WEST line					
Ground Level Elev. 4236.3	Producing Formation San Andres		Pool Milnesand San Andres		Dedicated Acreage 40 Acres

1. Is the Operator the only owner in the dedicated acreage outlined on the plat below? YES XX NO ____ ("Owner" means the person who has the right to drill into and to produce from any pool and to appropriate the production either for himself or for himself and another. (65-3-29 (e) NMSA 1955 Comp.)
2. If the answer to question one is "no," have the interests of all the owners been consolidated by communitization agreement or otherwise? YES ____ NO ____ . If answer is "yes," Type of Consolidation ____
3. If the answer to question two is "no," list all the owners and their respective interests below.

Owner	Land Description

SECTION B

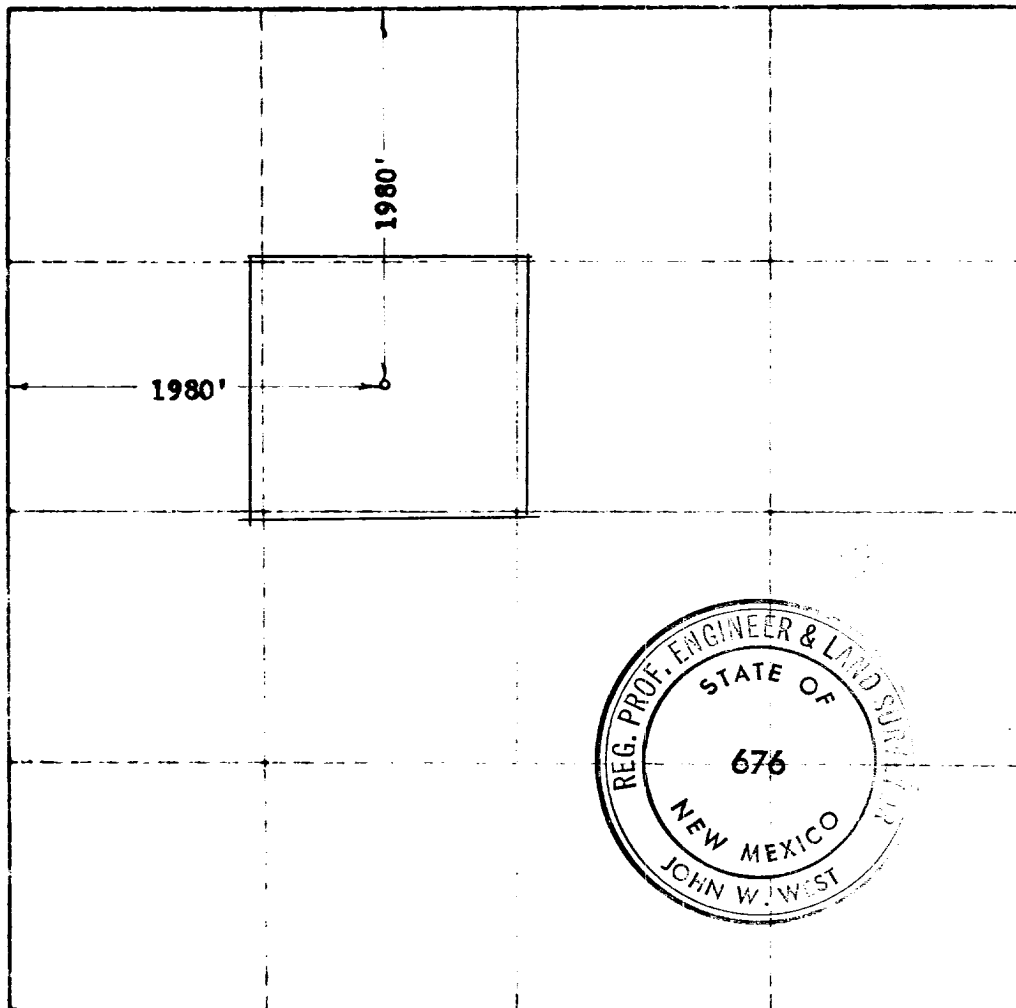

CERTIFICATION

I hereby certify that the information in SECTION A above is true and complete to the best of my knowledge and belief.

Name	<i>Robert A. Dean</i>
Position	Agent
Company	Robert A. Dean
Date	November 30, 1962

I hereby certify that the well location shown on the plat in SECTION B was plotted from field notes of actual surveys made by me or under my supervision, and that the same is true and correct to the best of my knowledge and belief.

Date Surveyed	NOVEMBER 20, 1962
Registered Professional Engineer and or Land Surveyor,	JOHN W. WEST
Certificate No.	<i>John W. West</i>
N.M. - P.E. & L.S. NO. 676	

0 330 660 990 1320 1650 1980 2310 2640 2000 1500 1000 500 0