

COPIES RECEIVED	
DISTRIBUTION	
SAN. A. F.	
FILE	
U.S.G.	
LAND OFFICE	
TRANSPORTER	OIL GAS
PHORATION OFFICE	
OPERATOR	

NEW ME OIL CONSERVATION COMMISS
Santa Fe, New Mexico

Form C-101
Revised (12/1/55)

NOTICE OF INTENTION TO DRILL

Notice must be given to the District Office of the Oil Conservation Commission and approval obtained before drilling or recompletion begins. If changes in the proposed plan are considered advisable, a copy of this notice showing such changes will be returned to the sender. Submit this notice in QUINTUPPLICATE. One copy will be returned following approval. See additional instructions in Rules and Regulations of the Commission. If State Land submit 6 Copies Attach Form C-128 in triplicate to first 3 copies of form C-101

Hobbs, New Mexico

August 13, 1963

(Place)

(Date)

OIL CONSERVATION COMMISSION
SANTA FE, NEW MEXICO

Gentlemen:

You are hereby notified that it is our intention to commence the Drilling of a well to be known as
El Chorro Exploration, Inc.

(Company, or Operator)

D. Hefflefinger

(Lease)

, Well No. **7**, in **B** (Unit) The well is

located **660** feet from the **North** line and **1980** feet from the **East** line of Section **18**, T. **8 S**, R. **35 E**, NMPM.

(GIVE LOCATION FROM SECTION LINE) **Milnesand-San Andres** Pool, **Roosevelt** County

If State Land the Oil and Gas Lease is No.

If patented land the owner is **O. A. Pruitt**

Address **Dora, New Mexico**

We propose to drill well with drilling equipment as follows: **Rotary**

The status of plugging bond is **Blanket bond**

Drilling Contractor **Verna Drilling Company**
Dallas, Texas

We intend to complete this well in the **San Andres** formation at an approximate depth of **4750** feet.

CASING PROGRAM

We propose to use the following strings of Casing and to cement them as indicated:

Size of Hole	Size of Casing	Weight per Foot	New or Second Hand	Depth	Sacks Cement
11	8 5/8	24#	New	350	Circulated
7 7/8	4 1/2	10.5#	New	4750	200

If changes in the above plans become advisable we will notify you immediately.

ADDITIONAL INFORMATION (If recompletion give full details of proposed plan of work.)

Approved....., 19.....
Except as follows:

Sincerely yours,

El Chorro Exploration, Inc.

(Company or Operator)

By **A. L. Smith**

Position **Agent**

Send Communications regarding well to

Name **El Chorro Exploration, Inc.**

Address **BOX 765 HOBBS, NEW MEX**

OIL CONSERVATION COMMISSION

By **[Signature]**

NEW MEXICO OIL CONSERVATION COMMISSION
WELL LOCATION AND ACREAGE DEDICATION PLAT

FORM C-128
Revised 5/1/57

RECORDS OFFICE OCC

SEE INSTRUCTIONS FOR COMPLETING THIS FORM ON THE REVERSE SIDE

SECTION A

1963 AUG 13 AM 8:59

Operator EL CHORRO EXPLORATION, INC.		Lease D. HEFFLEFINGER		Well No. 7
Unit Letter B	Section 18	Township 8 SOUTH	Range 35 EAST	County ROOSEVELT

Actual Footage Location of Well:

660 feet from the NORTH line and 1980 feet from the EAST line

Ground Level Elev. 4238.00	Producing Formation San Andres	Pool Milnesand-San Andres	Dedicated Acreage: 10 Acres
-------------------------------	-----------------------------------	------------------------------	--------------------------------

1. Is the Operator the only owner in the dedicated acreage outlined on the plat below? YES ☒ NO ____ . ("Owner" means the person who has the right to drill into and to produce from any pool and to appropriate the production either for himself or for himself and another. (65-3-29 (a) NMSA 1955 Comp.)
2. If the answer to question one is "no," have the interests of all the owners been consolidated by communitization agreement or otherwise? YES ____ NO ____ . If answer is "yes," Type of Consolidation ____
3. If the answer to question two is "no," list all the owners and their respective interests below:

Owner	Land Description

SECTION B

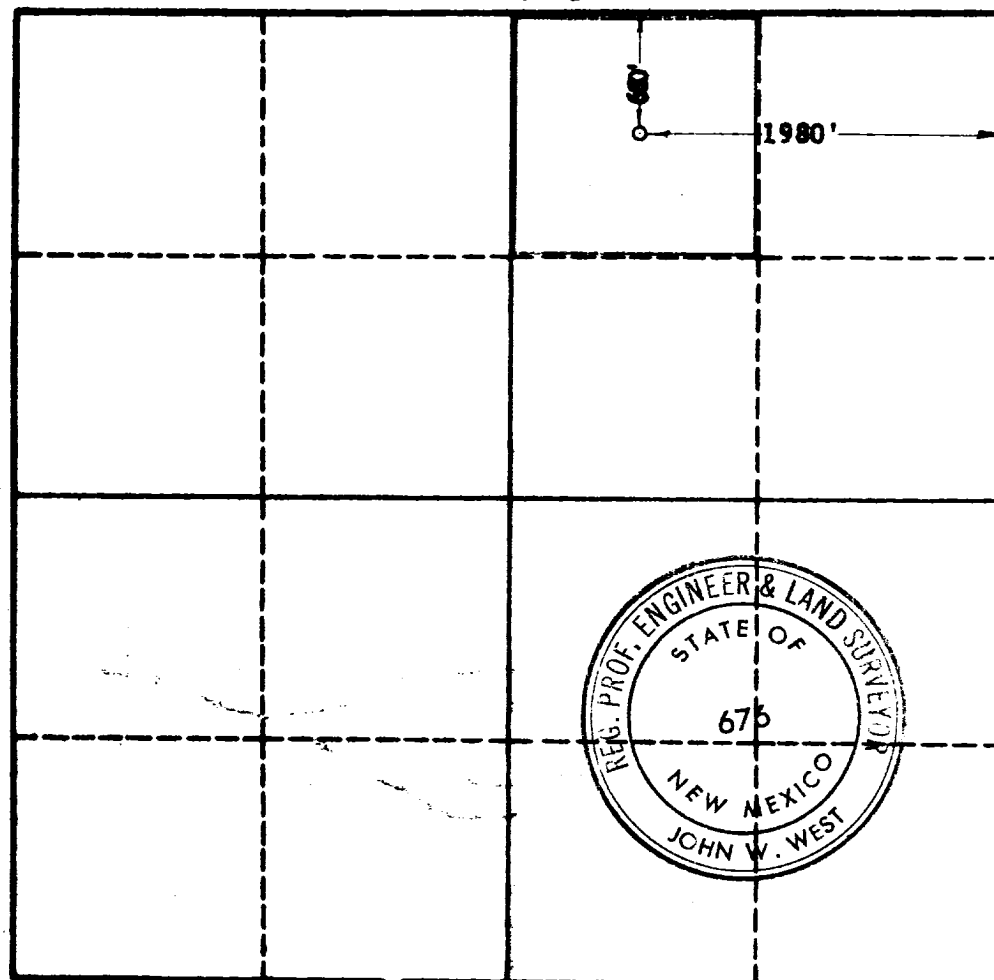

CERTIFICATION

I hereby certify that the information in SECTION A above is true and complete to the best of my knowledge and belief.

Name H. L. Smith
Position Agent
Company El Chorro Exploration, Inc.
Date August 13, 1963

I hereby certify that the well location shown on the plat in SECTION B was plotted from field notes of actual surveys made by me or under my supervision, and that the same is true and correct to the best of my knowledge and belief.

Date Surveyed 8-9-63
Registered Professional Engineer and/or Land Surveyor, JOHN W. WEST
Certificate No. N. M. - P. E. & L. S. NO. 675

0 350 600 950 1300 1650 1980 2340 2600 2950 3300 0