

(SUBMIT IN TRIPLICATE)

E. G. H. H. H.

 UNITED STATES
 DEPARTMENT OF THE INTERIOR
 GEOLOGICAL SURVEY

Land Office

Lease No. LC-060978

Unit D E F F

SUNDRY NOTICES AND REPORTS ON WELLS

NOTICE OF INTENTION TO DRILL	<input checked="" type="checkbox"/>	SUBSEQUENT REPORT OF WATER SHUT-OFF
NOTICE OF INTENTION TO CHANGE PLANS		SUBSEQUENT REPORT OF SHOOTING OR ACIDIZING
NOTICE OF INTENTION TO TEST WATER SHUT-OFF		SUBSEQUENT REPORT OF ALTERING CASING
NOTICE OF INTENTION TO RE-DRILL OR REPAIR WELL		SUBSEQUENT REPORT OF RE-DRILLING OR REPAIR
NOTICE OF INTENTION TO SHOOT OR ACIDIZE		SUBSEQUENT REPORT OF ABANDONMENT
NOTICE OF INTENTION TO PULL OR ALTER CASING		SUPPLEMENTARY WELL HISTORY
NOTICE OF INTENTION TO ABANDON WELL		

(INDICATE ABOVE BY CHECK MARK NATURE OF REPORT, NOTICE, OR OTHER DATA)

March 21, 1963

Jacobs Federal

Well No. 9 is located 1980 ft. from $\begin{matrix} N \\ \text{X} \end{matrix}$ line and 624.3 ft. from $\begin{matrix} E \\ W \end{matrix}$ line of sec. 19SW/4 NW/4 Section 19
(1/4 Sec. and Sec. No.)S S
(Twp.)35 E
(Range)14PM
(Meridian)Undesignated
(Field)Roosevelt
(County or Subdivision)New Mexico
(State or Territory)

The elevation of the derrick floor above sea level is _____ ft.

DETAILS OF WORK

(State names of and expected depths to objective sands; show sizes, weights, and lengths of proposed casings; indicate mudding jobs, cementing points, and all other important proposed work)

It is proposed to drill with rotary tools to approximately 4750 feet for San Andres production.

Casing program:

8 5/8" 24# J-55 New Set at 350 feet, cement circulated.

4 1/2" 10.5# J-55 New Set at total depth with 200 sacks cement.

I understand that this plan of work must receive approval in writing by the Geological Survey before operations may be commenced.

Company El Chorro Exploration, Inc.

Address c/o Oil Reports & Gas Services

Box 763

Hobbs, New Mexico

By

A. L. Smith

Title Agent

NEW MEXICO OIL CONSERVATION COMMISSION
WELL LOCATION AND ACREAGE DEDICATION PLAT

FORM C-128
Revised 5/1/57

SEE INSTRUCTIONS FOR COMPLETING THIS FORM ON THE REVERSE SIDE

SECTION A

Operator EL CHORRO EXPLORATION, INC.		Lease JACOBS FEDERAL		Well No. 9	
Unit Letter E	Section 19	Township 8 SOUTH	Range 35 EAST	County ROOSEVELT	
Actual Footage Location of Well: 1980 feet from the NORTH line and 624.3 feet from the WEST line					
Ground Level Elev. 4238.9	Producing Formation San Andres		Pool Undesignated		Dedicated Acreage: 37.81 Acres

1. Is the Operator the only owner in the dedicated acreage outlined on the plat below? YES X NO ____ . ("Owner" means the person who has the right to drill into and to produce from any pool and to appropriate the production either for himself or for himself and another. (65-3-29 (a) NMSA 1935 Comp.)
2. If the answer to question one is "no," have the interests of all the owners been consolidated by communitization agreement or otherwise? YES ____ NO ____ . If answer is "yes," Type of Consolidation ____
3. If the answer to question two is "no," list all the owners and their respective interests below:

Owner	Land Description

SECTION B

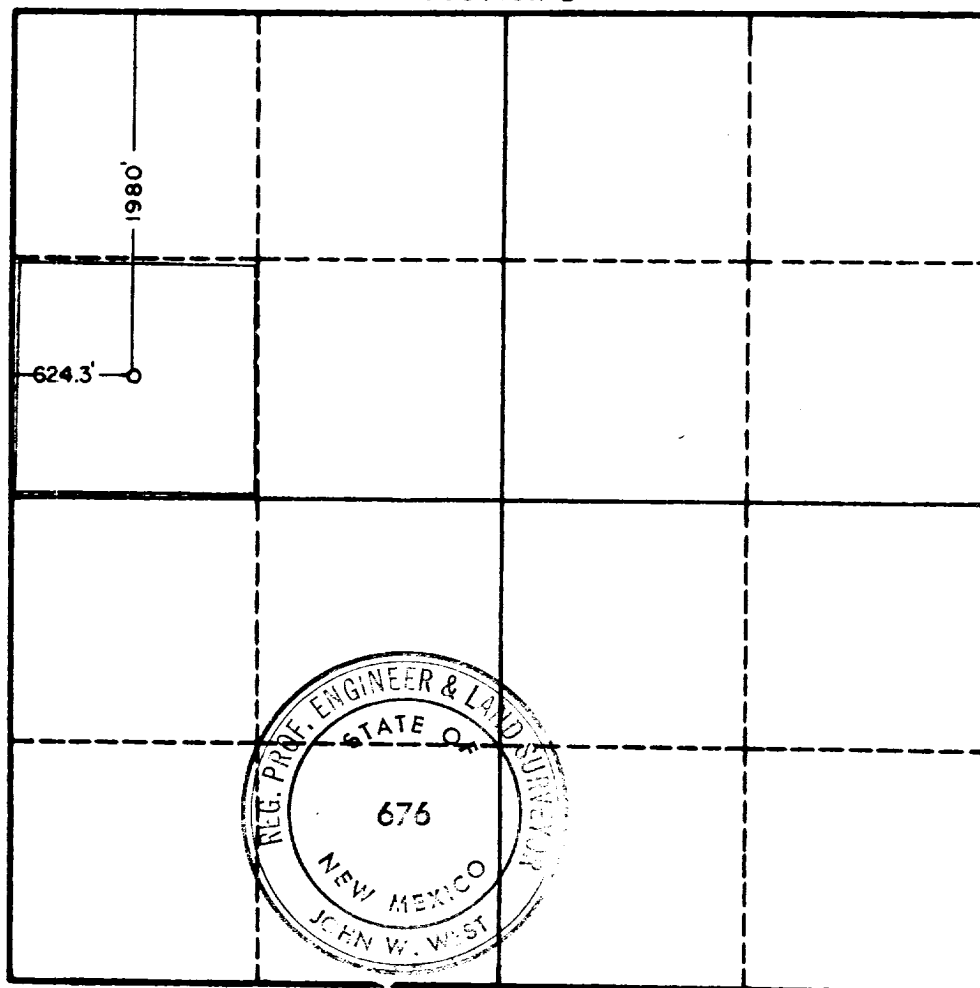

CERTIFICATION

I hereby certify that the information in SECTION A above is true and complete to the best of my knowledge and belief.

Name H. L. Smith
Position
Agent
Company
El Chorro Exploration, Inc.
Date
March 21, 1963

I hereby certify that the well location shown on the plat in SECTION B was plotted from field notes of actual surveys made by me or under my supervision, and that the same is true and correct to the best of my knowledge and belief.

Date Surveyed
3-16-63
Registered Professional Engineer and/or Land Surveyor, **JOHN W. WEST**
John W. West
Certificate No.
N. M. - P. E. & L. S. NO. 676

0 330 660 990 1320 1650 1980 2310 2640 2000 1600 1200 800 0