

		<b>X</b>

(SUBMIT IN TRIPLICATE)

Land Office \_\_\_\_\_  
Lease No. **LC-060978**  
Unit \_\_\_\_\_

UNITED STATES  
DEPARTMENT OF THE INTERIOR  
GEOLOGICAL SURVEY

**SUNDRY NOTICES AND REPORTS ON WELLS**

NOTICE OF INTENTION TO DRILL	<b>X</b>	SUBSEQUENT REPORT OF WATER SHUT-OFF	
NOTICE OF INTENTION TO CHANGE PLANS		SUBSEQUENT REPORT OF SHOOTING OR ACIDIZING	
NOTICE OF INTENTION TO TEST WATER SHUT-OFF		SUBSEQUENT REPORT OF ALTERING CASING	
NOTICE OF INTENTION TO RE-DRILL OR REPAIR WELL		SUBSEQUENT REPORT OF RE-DRILLING OR REPAIR	
NOTICE OF INTENTION TO SHOOT OR ACIDIZE		SUBSEQUENT REPORT OF ABANDONMENT	
NOTICE OF INTENTION TO PULL OR ALTER CASING		SUPPLEMENTARY WELL HISTORY	
NOTICE OF INTENTION TO ABANDON WELL			

(INDICATE ABOVE BY CHECK MARK NATURE OF REPORT, NOTICE, OR OTHER DATA)

**August 13, 1963**

**Jacobs Federal**

Well No. **11** is located **660** ft. from **N** line and **1980** ft. from **E** line of sec. **19**

**NW/4 NE/4 Sec. 19** **S 5** **35 E** **NMPM**  
(1/4 Sec. and Sec. No.) (Twp.) (Range) (Meridian)

**Undesignated (Milnesand-SA)** **Roosevelt** **New Mexico**  
(Field) (County or Subdivision) (State or Territory)

The elevation of the derrick floor above sea level is \_\_\_\_\_ ft.

**DETAILS OF WORK**

(State names of and expected depths to objective sands; show sizes, weights, and lengths of proposed casings; indicate mudding jobs, cementing points, and all other important proposed work)

**It is proposed to drill with rotary tools to approximately 4750 feet for San Andres production.**

**Casing program:**

**2 5/8" New 24# J-55 set at 350 feet, cement circulated.**  
**4 1/2" New 10.5# J-55 set at total depth with 200 sacks cement.**

I understand that this plan of work must receive approval in writing by the Geological Survey before operations may be commenced.

Company **El Chorro Exploration, Inc.**

Address **c/o Oil Reports & Gas Services**

**Box 763**

**Hobbs, New Mexico**

By

*A. L. Smith*

Title

**Agent**

NEW MEXICO OIL CONSERVATION COMMISSION  
WELL LOCATION AND ACREAGE DEDICATION PLAT

FORM C-128  
Revised 5/1/57

SEE INSTRUCTIONS FOR COMPLETING THIS FORM ON THE REVERSE SIDE

SECTION A

Operator <b>EL CHorro EXPLORATION, INC.</b>		Lease <b>FM 3-56</b>		Well No. <b>11</b>	
Unit Letter <b>B</b>	Section <b>19</b>	Township <b>8 SOUTH</b>	Range <b>35 EAST</b>	County <b>ROOSEVELT</b>	
Actual Footage Location of Well: <b>660</b> feet from the <b>NORTH</b> line and <b>1980</b> feet from the <b>EAST</b> line					
Ground Level Elev. <b>4232.7</b>	Producing Formation <b>San Andres</b>		Pool <b>Undesignated (Wilkinson-SA)</b>		Dedicated Acreage: <b>40</b> Acres

1. Is the Operator the only owner in the dedicated acreage outlined on the plat below? YES ☒ NO ☐ ("Owner" means the person who has the right to drill into and to produce from any pool and to appropriate the production either for himself or for himself and another. (65-3-29 (e) NMSA 1955 Comp.)
2. If the answer to question one is "no," have the interests of all the owners been consolidated by communitization agreement or otherwise? YES ☐ NO ☐ If answer is "yes," Type of Consolidation \_\_\_\_\_
3. If the answer to question two is "no," list all the owners and their respective interests below:

Owner	Land Description

SECTION B

CERTIFICATION

I hereby certify that the information in SECTION A above is true and complete to the best of my knowledge and belief.

Name <b>H. L. Smith</b>
Position <b>Agent</b>
Company <b>El Chorro Exploration, Inc.</b>
Date <b>August 13, 1963</b>

I hereby certify that the well location shown on the plat in SECTION B was plotted from field notes of actual surveys made by me or under my supervision, and that the same is true and correct to the best of my knowledge and belief.

Date Surveyed <b>8-9-63</b>
Registered Professional Engineer and/or Land Surveyor, <b>JOHN W. WEST</b>
Certificate No. <b>N. M. - P. E. &amp; L. S. NO. 676</b>

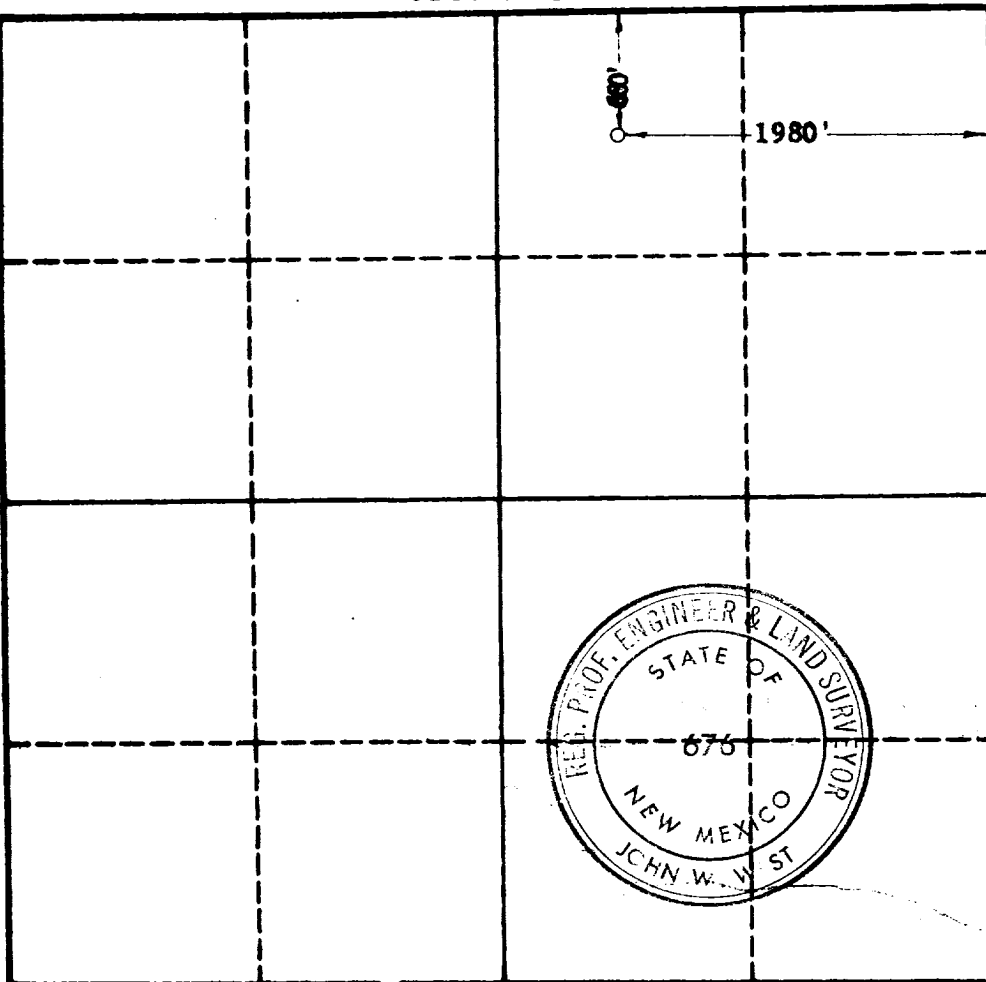

0 330 660 990 1320 1650 1980 2310 2640 2970 3300 3630 3960 4290 4620 4950 5280 5610 5940 6270 6600 6930 7260 7590 7920 8250 8580 8910 9240 9570 9900 10230 10560 10890 11220 11550 11880 12210 12540 12870 13200 13530 13860 14190 14520 14850 15180 15510 15840 16170 16500 16830 17160 17490 17820 18150 18480 18810 19140 19470 19800 20130 20460 20790 21120 21450 21780 22110 22440 22770 23100 23430 23760 24090 24420 24750 25080 25410 25740 26070 26400 26730 27060 27390 27720 28050 28380 28710 29040 29370 29700 30030 30360 30690 31020 31350 31680 32010 32340 32670 33000