

UNITED STATES  
DEPARTMENT OF THE INTERIOR  
GEOLOGICAL SURVEY

## APPLICATION FOR PERMIT TO DRILL, DEEPEN, OR PLUG BACK

1a. TYPE OF WORK DRILL <input checked="" type="checkbox"/> DEEPEN <input type="checkbox"/> PLUG BACK <input type="checkbox"/>		5. LEASE DESIGNATION AND SERIAL NO. Federal NM 016658
b. TYPE OF WELL OIL WELL <input type="checkbox"/> GAS WELL <input checked="" type="checkbox"/> OTHER <input type="checkbox"/> SINGLE ZONE <input type="checkbox"/> MULTIPLE ZONE <input type="checkbox"/>		6. IF INDIAN, ALLOTTEE OR TRIBE NAME
2. NAME OF OPERATOR OLEN F. FEATHERSTONE II TRUST		7. UNIT AGREEMENT NAME NO NE
3. ADDRESS OF OPERATOR 236 Petroleum Building, Roswell, New Mexico 88201		8. FARM OR LEASE NAME Federal M-23
4. LOCATION OF WELL (Report location clearly and in accordance with any State requirements.)* At surface T7S, R35E, Section 23, 990' FSL & FWL Unit M Roosevelt County At proposed prod. zone Same As Above		9. WELL NO. #1
14. DISTANCE IN MILES AND DIRECTION FROM NEAREST TOWN OR POST OFFICE* 3-1/4 Mi North of Milnesand		10. FIELD AND POOL, OR WILDCAT Todd-San Andres
15. DISTANCE FROM PROPOSED LOCATION TO NEAREST PROPERTY OR LEASE LINE, FT. (Also to nearest drlg. unit line, if any) Not Applicable	16. NO. OF ACRES IN LEASE 2385.72 ac	11. SEC., T., R., M., OR BLK. AND SURVEY OR AREA 23-T7S, R35E
18. DISTANCE FROM PROPOSED LOCATION TO NEAREST WELL, DRILLING, COMPLETED, OR APPLIED FOR, ON THIS LEASE, FT. Not Applicable	19. PROPOSED DEPTH 4250'	12. COUNTY OR PARISH Roosevelt
21. ELEVATIONS (Show whether DF, RT, GR, etc.) 4150' GR		13. STATE N. Mexico
22. APPROX. DATE WORK WILL START* 2-26-65 3-1-65		

23.

## PROPOSED CASING AND CEMENTING PROGRAM

SIZE OF HOLE	SIZE OF CASING	WEIGHT PER FOOT	SETTING DEPTH	QUANTITY OF CEMENT
11"	7"	17.0#	250	150 sx Reg. w/2% CaCl <sub>2</sub>
7-7/8"	4-1/2"	9.5#	T.D.	150 sx Prem w/2% CaCl <sub>2</sub>

Will Circulate Cement on Surface String.  
WOC 18 hrs., after setting surface casing.  
WOC 24 hours after production string (If Producer indicated). Run GK-Acoustic log and if producer indicated, run 4-1/2" production string, perforate acidize, and complete. Will take 50' core in Slaughter Zone at about 4150'

IN ABOVE SPACE DESCRIBE PROPOSED PROGRAM: If proposal is to deepen or plug back, give data on present productive zone and proposed new productive zone. If proposal is to drill or deepen directionally, give pertinent data on subsurface locations and measured and true vertical depths. Give blowout preventer program, if any.

24. SIGNED Rex Alcorn TITLE Geologist DATE 2/23/65  
Rex Alcorn

(This space for Federal or State office use)

PERMIT NO. \_\_\_\_\_ APPROVAL DATE \_\_\_\_\_

APPROVED BY \_\_\_\_\_ TITLE \_\_\_\_\_  
CONDITIONS OF APPROVAL, IF ANY:

\*See Instructions On Reverse Side

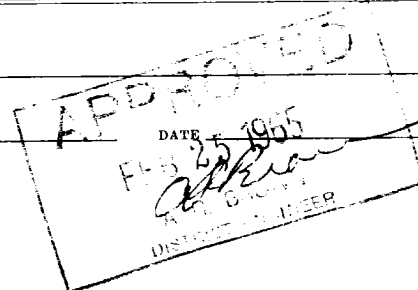

NEW MEXICO OIL CONSERVATION COMMISSION  
WELL LOCATION AND ACREAGE DEDICATION PLAT

FORM C-120  
Revised 5/1/57

SEE INSTRUCTIONS FOR COMPLETING THIS FORM ON THE REVERSE SIDE

Operator <b>OLEN F. FEATHERSTONE II TRUST</b>		SECTION A Lease <b>FEDERAL M-23</b>		MAR 2 10 57 AM '65 Well No. <b>1</b>	
Unit Letter <b>M</b>	Section <b>23</b>	Township <b>7 SOUTH</b>	Range <b>35 EAST</b>	County <b>ROOSEVELT</b>	

Actual Footage Location of Well:

990 feet from the **SOUTH** line and 990 feet from the **WEST** line

Ground Level Elev. <b>4191.6</b>	Producing Formation	Pool	Dedicated Acreage: <b>320 Acres</b> Acres
-------------------------------------	---------------------	------	--

1. Is the Operator the only owner in the dedicated acreage outlined on the plat below? YES \_\_\_\_\_ NO \_\_\_\_\_ ("Owner" means the person who has the right to drill into and to produce from any pool and to appropriate the production either for himself or for himself and another. (63-3-29 (e) NMSA 1935 Comp.)
2. If the answer to question one is "no," have the interests of all the owners been consolidated by communitization agreement or otherwise? YES \_\_\_\_\_ NO \_\_\_\_\_. If answer is "yes," Type of Consolidation \_\_\_\_\_
3. If the answer to question two is "no," list all the owners and their respective interests below:

Owner	Land Description

SECTION B

CERTIFICATION

I hereby certify that the information in SECTION A above is true and complete to the best of my knowledge and belief.

Name  
**Rex Aleora**

Position  
**Geologist**

Company  
**OLEN F. FEATHERSTONE II TRUST**

Date  
**February 23, 1965**

I hereby certify that the well location shown on the plat in SECTION B was plotted from field notes of actual surveys made by me or under my supervision, and that the same is true and correct to the best of my knowledge and belief.

Date Surveyed  
**2-18-65**

Registered Professional Engineer and/or Land Surveyor, **JOHN W. WEST**

Certificate No.  
**N. M. - P. E. & L. S. NO. 676**

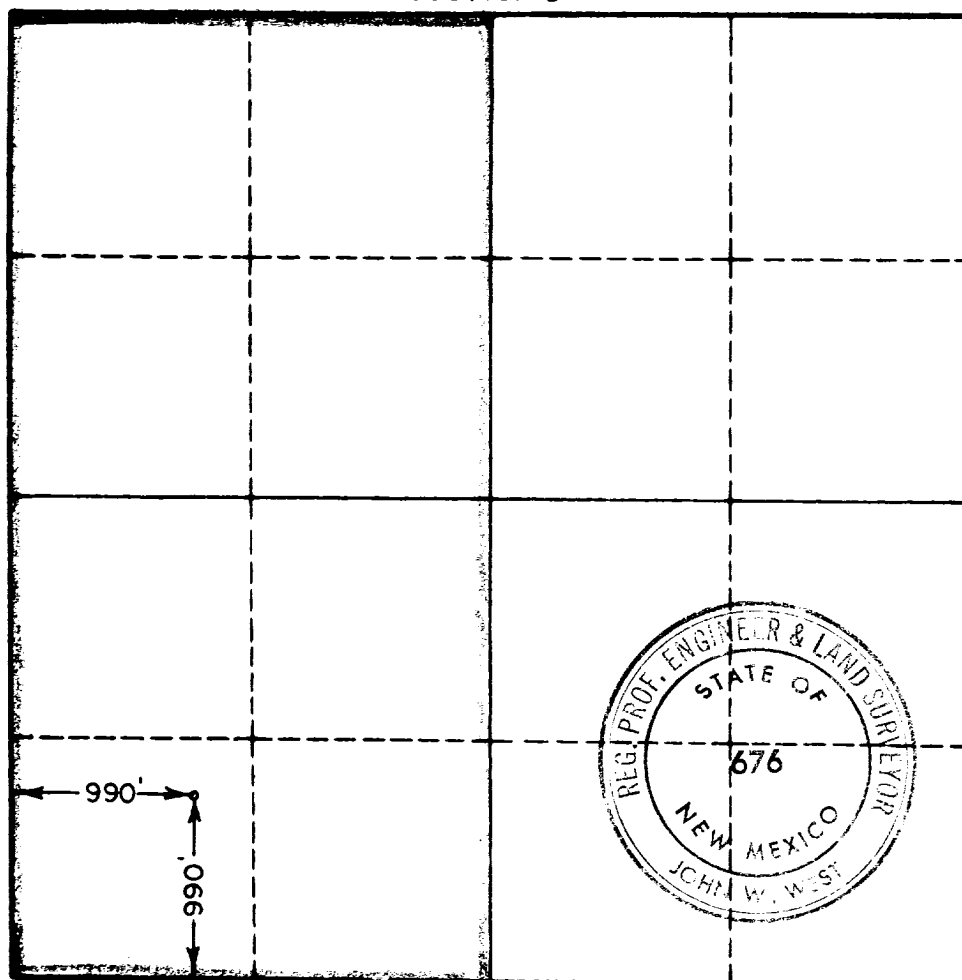

0 330 660 990 1320 1650 1980 2310 2640 2970 3300 3630 3960 4290 4620 4950 5280 5610 5940 6270 6600