

NEW MEXICO OIL CONSERVATION COMMISSION
WELL LOCATION AND ACREAGE DEDICATION PLAT

FORM C-128
Revised 5/1/57

SEE INSTRUCTIONS FOR COMPLETING THIS FORM ON THE REVERSE SIDE

SECTION A

Operator FEATHERSTONE TRUST		Lease FED. H-27		Well No. 1
Unit Letter H	Section 27	Township 7 SOUTH	Range 35 EAST	County ROOSEVELT
Actual Footage Location of Well: 1650 feet from the NORTH line and 990 feet from the EAST line				
Ground Level Elev. 4190.6	Producing Formation San Andres	Pool Todd - San Andres	Dedicated Acreage: 320 Acres	
E 1/2 Sec. 27-75-35E				
1. Is the Operator the only owner in the dedicated acreage outlined on the plat below? YES <input checked="" type="checkbox"/> NO <input type="checkbox"/> ("Owner" means the person who has the right to drill into and to produce from any pool and to appropriate the production either for himself or for himself and another. (65-3-29 (e) NMSA 1935 Comp.)				
2. If the answer to question one is "no," have the interests of all the owners been consolidated by communitization agreement or otherwise? YES <input type="checkbox"/> NO <input type="checkbox"/> If answer is "yes," Type of Consolidation _____				
3. If the answer to question two is "no," list all the owners and their respective interests below:				

Owner	Land Description

SECTION B

CERTIFICATION

I hereby certify that the information in SECTION A above is true and complete to the best of my knowledge and belief.

Name Rex Alcorn
Position Geologist
Company Olen F. Featherstone II Trust
Date November 23, 1964

I hereby certify that the well location shown on the plat in SECTION B was plotted from field notes of actual surveys made by me or under my supervision, and that the same is true and correct to the best of my knowledge and belief.

Date Surveyed
NOV. 19, 1964
Registered Professional Engineer and/or Land Surveyor, JOHN W. WEST
Certificate No. John W. West
N. M. - P. E. & L. S. NO. 676

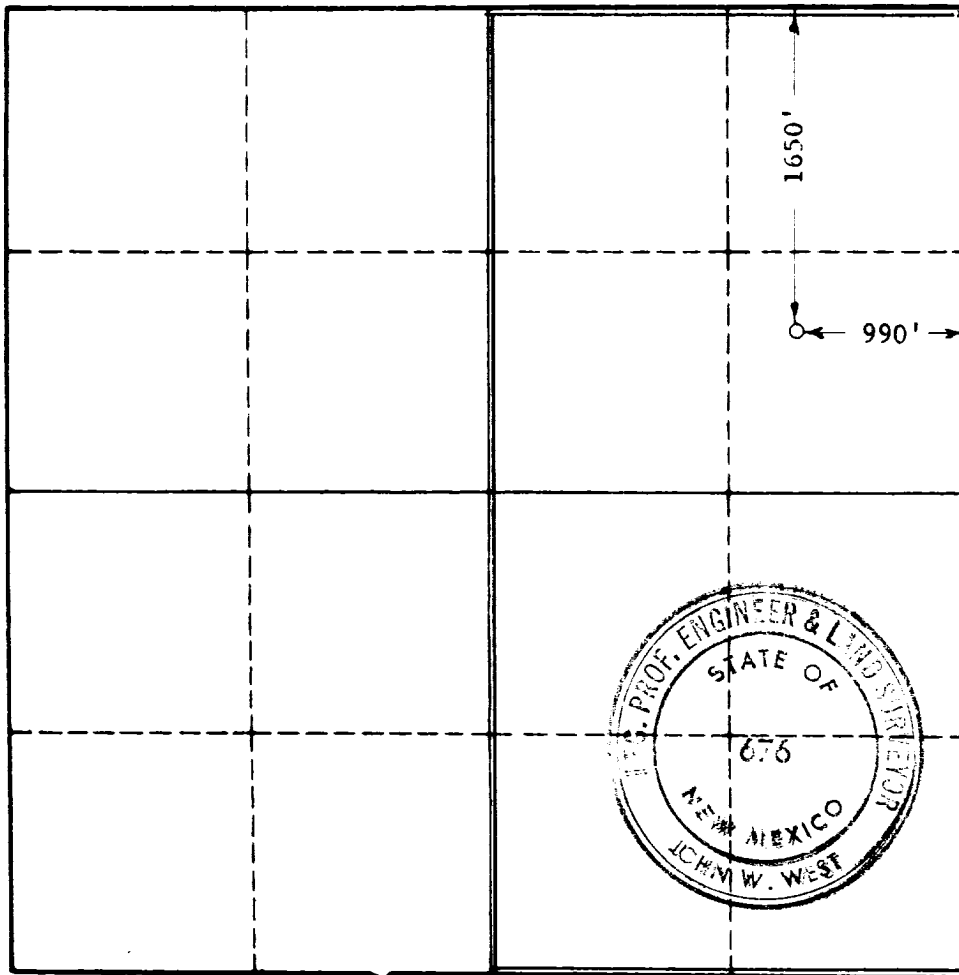

0 330 660 990 1320 1650 1980 2310 2640 2970 3300 3630