

NEW MEXICO OIL CONSERVATION COMMISSION
WELL LOCATION AND ACREAGE DEDICATION PLAT

FORM C-120
 Revised 5/1/57

SEE INSTRUCTIONS FOR COMPLETING THIS FORM ON THE REVERSE SIDE

SECTION A

| | | | | | |
|---|--|----------------------------|--------------------------------|----------------------------|--|
| Operator FEATHERSTONE TRUST | | | Lease FED. H-27 | | Well No. 1 |
| Unit Letter H | Section 27 | Township 7 SOUTH | Range 35 EAST | County ROOSEVELT | |
| Actual Footage Location of Well: 1650 feet from the NORTH line and 990 feet from the EAST line | | | | | |
| Ground Level Elev. 4190.6 | Producing Formation San Andres | | Pool Todd-San Andres | | Dedicated Acreage: 320 Acres |

1. Is the Operator the only owner in the dedicated acreage outlined on the plat below? YES XX NO ____ ("Owner" means the person who has the right to drill into and to produce from any pool and to appropriate the production either for himself or for himself and another. (65-3-29 (a) NMSA 1935 Comp.)
2. If the answer to question one is "no," have the interests of all the owners been consolidated by communitization agreement or otherwise? YES ____ NO ____ . If answer is "yes," Type of Consolidation _____
3. If the answer to question two is "no," list all the owners and their respective interests below:

| Owner | Land Description |
|-------|------------------|
| | |
| | |

SECTION B

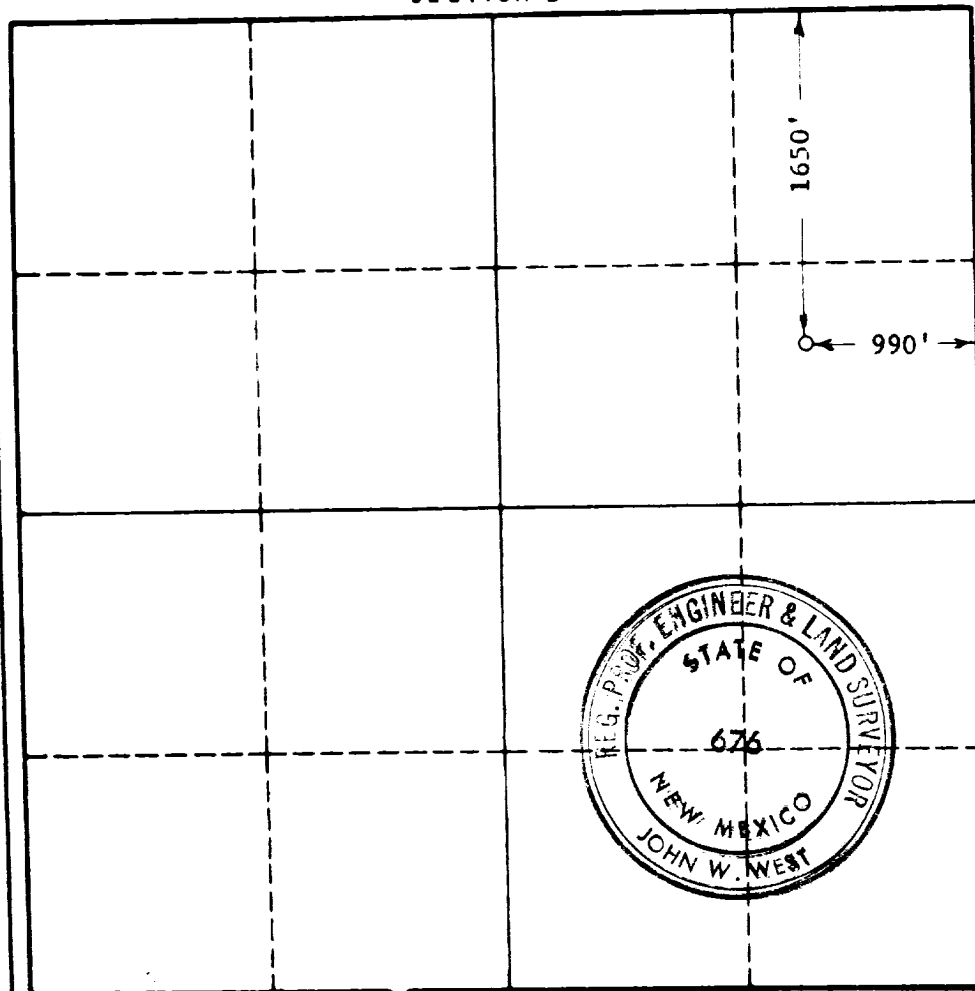

CERTIFICATION

I hereby certify that the information in SECTION A above is true and complete to the best of my knowledge and belief.

Rex Alcorn
 Name

Rex Alcorn

Position
Geologist

Company **OLEN F. FEATHERSTONE II TRUST**

Date
Nov. 23, 1964

I hereby certify that the well location shown on the plat in SECTION B was plotted from field notes of actual surveys made by me or under my supervision, and that the same is true and correct to the best of my knowledge and belief.

| |
|--|
| Date Surveyed NOV. 19, 1964 |
| Registered Professional Engineer and/or Land Surveyor, JOHN W. WEST |
| <i>John W. West</i> Certificate No. N. M. - P. E. & L. S. NO. 676 |

0 330 660 990 1320 1650 1980 2310 2640 2970 3300 3630 3960 4290 4620 4950 5280 5610 5940 6270 6600

| | | | | | | | | |
|------------------------|--|--|-------|---------|--|-----------|-------------------------|-----------|
| COUNTY | ROOSEVELT | | FIELD | Todd-SA | | STATE | NM | |
| OPR | FEATHERSTONE TRUST | | | | | MAP | | |
| | 1 Federal H-27 | | | | | | | |
| | Sec. 27, T-7-S, R-35-E | | | | | CO-ORD | | |
| | 1650' fr N Line & 990' fr E Line of Sec. | | | | | | | |
| | Spud 11-28-64 | | | | | CLASS | EL 4200 4200 | |
| | Comp 1-6-65 | | | | | FORMATION | DATUM | FORMATION |
| CSG & SX - TUBING | LOG: | | | | | | | |
| | SA 3438 | | | | | | | |
| 8 5/8" 242' 150 | Slaughter | | | | | | | |
| 4 1/2" 4257' 150 | 4080 | | | | | | | |
| | | | | | | | | |
| | | | | | | | | |
| LOGS EL GR RA IND HC A | | | | | | | | |
| | TD 4260', PBD 4257' | | | | | | | |

IP San Andres Perfs 4088-4224' CAOF 10,200 MCFGPD. Pot. Based on 4-point test, GOR dry, 72 hr SIWHP 1065#.

Distribution limited and publication prohibited by subscribers' agreement.
Reproduction rights reserved by Williams & Lee Scouting Service, Inc.

| | | | |
|-------|------------|-------|------|
| CONT. | PROP DEPTH | 4400' | TYPE |
| DATE | | | |

F.R. 11-27-64
 PD 4400' - SA
 12-7-64 Drlg. 4100'.
 12-14-64 TD 4260', prep to Ac.
 Cored 4100-50', rec 50' anhy & dolo., w/scatt PPP, BO from scatt zones.
 Cored 4150-4201', rec 51' being:
 15½' anhy dolo., w/PPP & BW; 6' dolo., w/NS;
 7' dolo., w/scatt PPP & BW; 11½' anhy; 5' Anhy Dolo., w/NS; 6' dolo., w/BW.
 Cored 4201-26', rec 25' being:
 6½' dolo., w/scatt PPP & BO; 7½' dolo, w/scatt PP & Vuggy Poro., BO; 2' dolo., w/NS; 6½' dolo. anhy., w/PP & Vuggy Poro., BO; 2½' dolo., w/scatt PPP.
 Perf @ 4088', 4109', 4150', 4158', 4196', 4204', 4209', 4212', 4214', 4220', 4224' W/1 SPI.

12-21-64 TD 4260', tstg.
Ac. 2000 gals. 4088-4224
Flwd est. 4827 MCFGPD, TI 700#.
1-4-65 TD 4260', PBD 4257', WO Potential.
1-11-65 TD 4260', PBD 4257', WO Potential.
Flwd 10,000 MCFGPD
1-18-65 TD 4260', PBD 4257', WO Potential.
1-25-65 TD 4260', PBD 4257', COMPLETED.

FOUR-POINT GAUGES:

| <u>MCFGPD</u> | <u>Time</u> | <u>TP</u> |
|---------------|-------------|-----------|
| 852 | 1 hr | 1046# |
| 1476 | 1 hr | 1016# |
| 2169 | 1 hr | 960# |
| 2751 | 1 hr | 912# |

(The above gauges through various chokes)