

NEW MEXICO OIL CONSERVATION COMMISSION
WELL LOCATION AND ACREAGE DEDICATION PLAT

FORM C-128
Revised 5/1/57

SEE INSTRUCTIONS FOR COMPLETING THIS FORM ON THE REVERSE SIDE

SECTION A

Operator FRANKLIN, ASTON & FAIR		Lease MARK FEDERAL		Well No. 4
Unit Letter G	Section 23	Township 7 SOUTH	Range 3 EAST	County ROOSEVELT
Actual Footage Location of Well: 1650 feet from the NORTH line and 1650 feet from the EAST line				
Ground Level Elev. 4181.4	Producing Formation San Andres		Point T-000	Dedicated Acreage: 320 Acres

1. Is the Operator the only owner in the dedicated acreage outlined on the plat below? YES ☒ NO ☐ "Owner" means the person who has the right to drill into and to produce from any pool and to appropriate the production either for himself or for himself and another. (65-3-29, N.M.S.A. 1935 Comp.)
2. If the answer to question one is "no," have the interests of all the owners been consolidated by communitization agreement or otherwise? YES ☐ NO ☐ If answer is "yes," Type of Consolidation _____
3. If the answer to question two is "no," list all the owners and their respective interests below.

Owner	Land Description E ₁ , Sec. 25, T-7S, R-35E, NMMP
-------	---

SECTION B

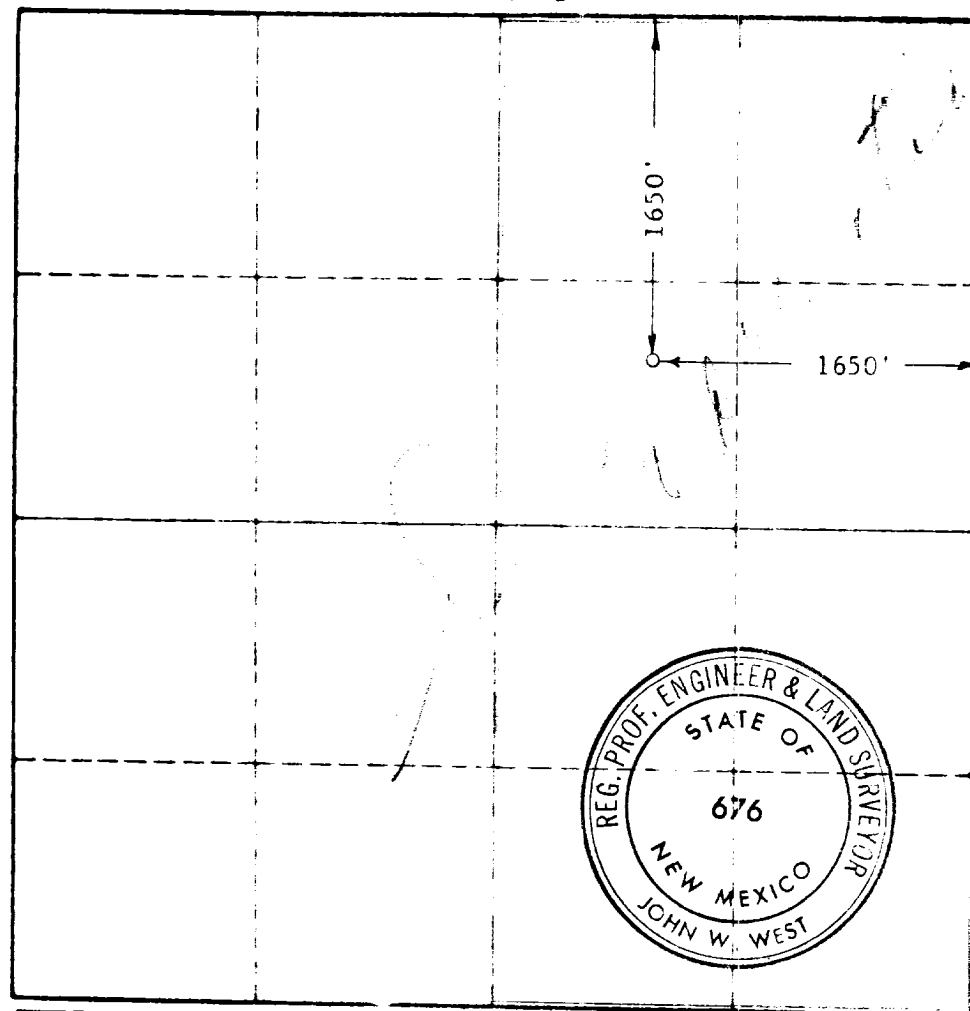

CERTIFICATION

I hereby certify that the information in SECTION A above is true and complete to the best of my knowledge and belief.

Grant M. Smith
Name

GRANT M. SMITH

Position

Geologist

Company

Franklin, Aston & Fair, Inc.

Date

May 13, 1965

I hereby certify that the well location shown on the plat in SECTION B was plotted from field notes of actual surveys made by me or under my supervision, and that the same is true and correct to the best of my knowledge and belief.

Date Surveyed

MAY 11, 1965

Registered Professional Engineer and/or Land Surveyor, JOHN W. WEST

John W. West
Certificate No.
N.M. - P.E. & L.S. NO. 676