

NEW MEXICO OIL CONSERVATION COMMISSION  
WELL LOCATION AND ACREAGE DEDICATION PLAT

FORM C-128  
Revised 5/1/57

SEE INSTRUCTIONS FOR COMPLETING THIS FORM ON THE REVERSE SIDE

SECTION A

Operator FRANKLIN, ASTON & FAIR, INC.		Lease CUNNINGHAM-MARK-FEDERAL		Well No. 3
Unit Letter G	Section 26	Township 7 SOUTH	Range 35 EAST	County ROOSEVELT
Actual Footage Location of Well: 1650 feet from the NORTH line and 1650 feet from the EAST line				
Ground Level Elev. 4187.1	Producing Formation San Andres	Pool Todd San Andres	Dedicated Acreage 320 Acres	

1. Is the Operator the only owner in the dedicated acreage outlined on the plat below? YES \_\_\_\_\_ NO X ("Owner" means the person who has the right to drill into and to produce from any pool and to appropriate the production either for himself or for himself and another. (65-3-29 (e) NMSA 1935 Comp.)
2. If the answer to question one is "no," have the interests of all the owners been consolidated by communitization agreement or otherwise? YES \_\_\_\_\_ NO \_\_\_\_\_. If answer is "yes," Type of Consolidation Communitization
3. If the answer to question two is "no," list all the owners and their respective interests below:

Owner Franklin, Aston & Fair, Inc.	Lead Description <u>1/2</u> Sec. 26, T. 7 S., R. 35 E., N.M.P.M.
---------------------------------------	---

SECTION B

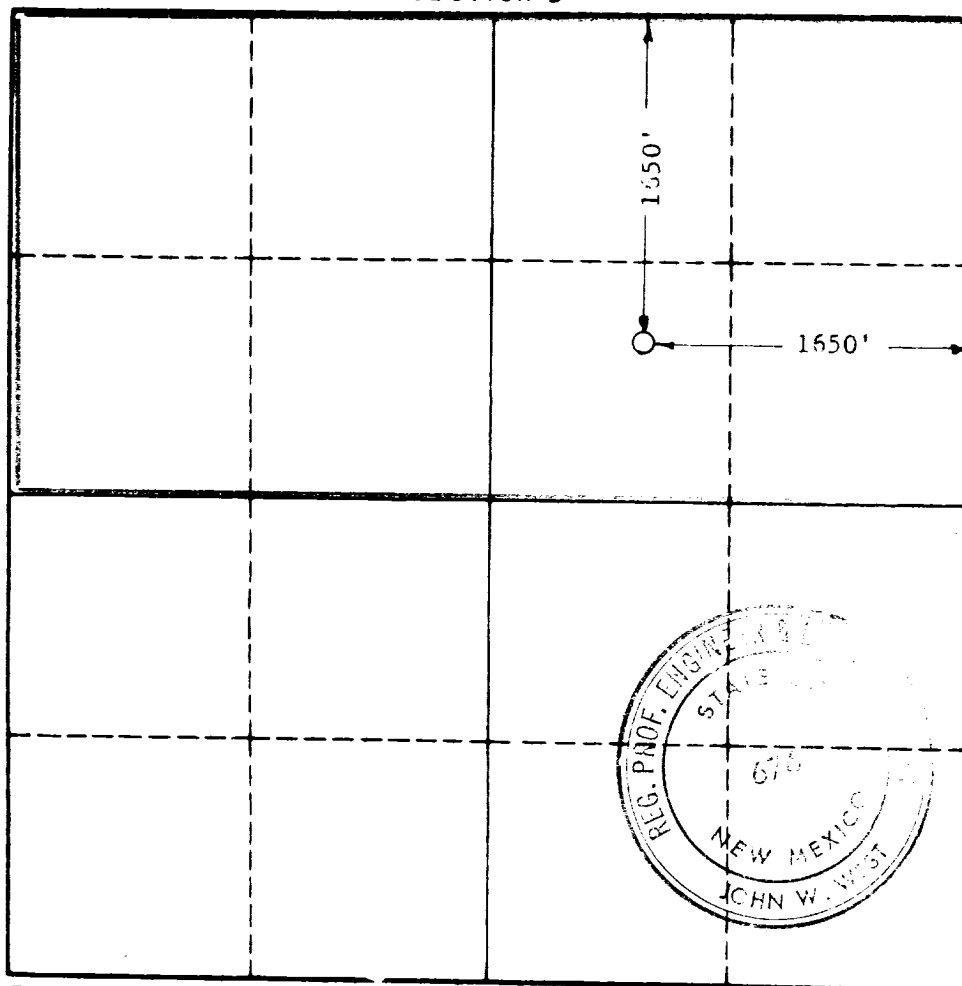

CERTIFICATION

I hereby certify that the information in SECTION A above is true and complete to the best of my knowledge and belief.

Name  
Tom P. Stephens  
Position  
Treasurer & Office Manager  
Company  
Franklin, Aston & Fair, Inc.  
Date  
Dec. 31, 1964

I hereby certify that the well location shown on the plat in SECTION B was plotted from field notes of actual surveys made by me or under my supervision, and that the same is true and correct to the best of my knowledge and belief.

Date Surveyed  
DEC. 30, 1964  
Registered Professional Engineer  
and/or Land Surveyor, JOHN W. WEST  
John W. West  
Certificate No.  
N. M. - P. E. & L. S. NO. 676