

(SUBMIT IN TRIPLICATE)

UNITED STATES
DEPARTMENT OF THE INTERIOR
GEOLOGICAL SURVEY

Land Office New Mexico

Lease No. NM-078798

Unit _____

SUNDRY NOTICES AND REPORTS ON WELLS

NOTICE OF INTENTION TO DRILL	<input checked="" type="checkbox"/>	SUBSEQUENT REPORT OF WATER SHUT-OFF
NOTICE OF INTENTION TO CHANGE PLANS		SUBSEQUENT REPORT OF SHOOTING OR ACIDIZING
NOTICE OF INTENTION TO TEST WATER SHUT-OFF		SUBSEQUENT REPORT OF ALTERING CASING
NOTICE OF INTENTION TO RE-DRILL OR REPAIR WELL		SUBSEQUENT REPORT OF RE-DRILLING OR REPAIR
NOTICE OF INTENTION TO SHOOT OR ACIDIZE		SUBSEQUENT REPORT OF ABANDONMENT
NOTICE OF INTENTION TO PULL OR ALTER CASING		SUPPLEMENTARY WELL HISTORY
NOTICE OF INTENTION TO ABANDON WELL		

(INDICATE ABOVE BY CHECK MARK NATURE OF REPORT, NOTICE, OR OTHER DATA)

October 26, 1964

Well No. 1 is located 1980 ft. from N line and 1980 ft. from W line of sec. 4

NW/4 Sec 4
(1/4 Sec and Sec. No.)

8S
(Twp.)

35E
(Range)

NMPM
(Meridian)

Wildest
(Field)

Roosevelt
(County or Subdivision)

New Mexico
(State or Territory)

The elevation of the derrick floor above sea level is later ft.

DETAILS OF WORK

(State names of and expected depths to objective sands; show sizes, weights, and lengths of proposed casings; indicate mudding jobs, cementing points, and all other important proposed work)

It is proposed to drill to approximately 4800' with Rotary Tools and complete in the San Andres formation. Casing program is as follows:

Size of Hole	Casing Size	Wt/Ft.	New or SH	Depth	Cement
11"	8 5/8" OD	28#	New	425'	250 sx
6 3/4"	4 1/2" OD	9.50#	New	4800'	250 sx

I understand that this plan of work must receive approval in writing by the Geological Survey before operations may be commenced.

Company Gulf Oil Corporation

Address P.O. Box 98

Andrews, Texas

By

E. J. Allen

Engineer

Title

Area ~~XXXXXXXXXXXX~~

NEW MEXICO OIL CONSERVATION COMMISSION
WELL LOCATION AND ACREAGE DEDICATION PLAT

FORM C-128
 Revised 5/1/57

SEE INSTRUCTIONS FOR COMPLETING THIS FORM ON THE REVERSE SIDE

Operator GULF OIL CORP.		Section 4		Township 8 SOUTH		Range 35 EAST		County ROOSEVELT		Well No. 1
Actual Footage Location of Well: 1980 feet from the NORTH line and 1980 feet from the WEST line										
Ground Level Elev.		Producing Formation San Andres		Pool Wildcat		Dedicated Acreage: Acres				

1. Is the Operator the only owner in the dedicated acreage outlined on the plat below? YES ☒ NO ☐ ("Owner" means the person who has the right to drill into and to produce from any pool and to appropriate the production either for himself or for himself and another. (65--3--29 (e) NMSA 1935 Comp.)
2. If the answer to question one is "no," have the interests of all the owners been consolidated by communitization agreement or otherwise? YES ☐ NO ☐ If answer is "yes," Type of Consolidation _____
3. If the answer to question two is "no," list all the owners and their respective interests below:

Owner	Land Description

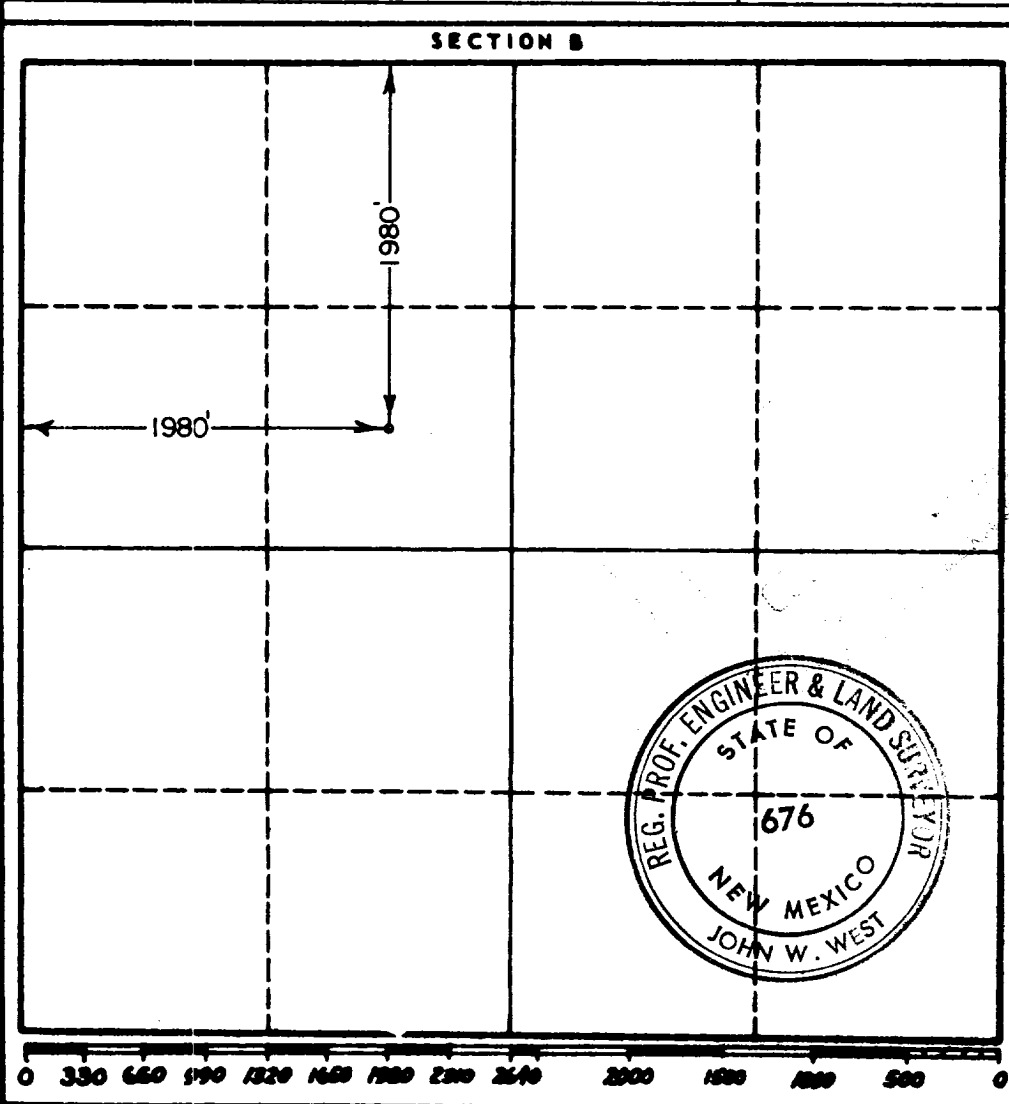

CERTIFICATION

I hereby certify that the information in **SECTION A** above is true and complete to the best of my knowledge and belief.

Name <i>E. L. ...</i>
Position Area Engineer
Company Gulf Oil Corporation
Date October 26, 1964

I hereby certify that the well location shown on the plat in **SECTION B** was plotted from field notes of actual surveys made by me or under my supervision, and that the same is true and correct to the best of my knowledge and belief.

Date Surveyed 10-23-35
Registered Professional Engineer and/or Land Surveyor, JOHN W. WEST
 Certificate No. N.M. - P.E. & L.S. NO. 676

RECEIVED
OCT 10 1968
AUSTIN, TEXAS